



FIRE ALARM BOX WITH MOUNTING PLATE, 3 1/2" BOX DEPTH

CATALOG NUMBER

TB435FB



nVent CADDY Fire Alarm Box with Mounting Plate is a powder coated adjustable depth box for mounting fire alarm devices and strobes, designed for on-stud and between stud applications. With two screws inside the box, installers can easily adjust to different depths after installation of drywall or ceiling tiles.

Available in three different options, designed for a wide range of applications. The TB425FB is for 2.5" stud depths. The TB435FB is for stud depths 3 5/8" and greater. The four-square box with 1/2" offset design is a ready-to-install assembly for devices and strobes that do not require a mud ring.

The TB425FBS option is for stud depths 3 5/8" and greater. The four-square box with no offset design allows for a mud ring to be used for mounting smaller devices for both single- and double-layer drywall.

CERTIFICATIONS



FEATURES

Used for mounting fire alarm devices and strobes

Snap-on installation to Heavy Duty Telescoping Bracket allows for easy positioning along bracket

Can also be mounted directly to metal studs

For between stud applications use with Heavy Duty Telescoping Bracket

For overhead applications use with Heavy Duty Telescoping Bracket and T-Grid Clip (sold separately)

Easily adjusts for different depth wall and ceiling applications

Screws inside fire alarm box allow for adjustment after drywall or ceiling tile installation, providing confidence to adapt to any situation

Includes multiple knockouts on each side of the box

Design provides built in far side support for minimum stub depths

Powder coated inside and outside of box

Includes depth stamps marked directly on the product for easy positioning

Drop-wire attachment point

PRODUCT ATTRIBUTES

Material: Steel
Finish: Pregalvanized; Powder Coated
Color: Red
Stud Wall Depth: 3.625"
Box Size: 4"
Box Depth: 3 1/2
Knockout Sizes: 1/2", 3/4
Far Side Support Depth: 3.62"
A: 12.7 – 38.1"
Length: 6.2"
Height: 7.36"
Thickness: 2.36"
Unit Weight: 1.4 lb

DIAGRAMS

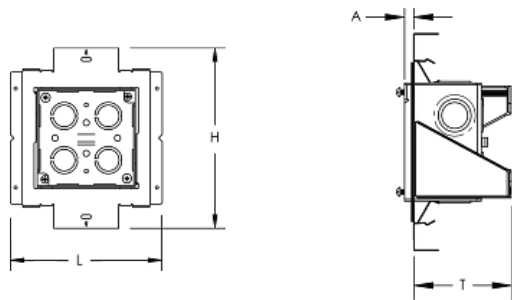

WARNING

nVent products shall be installed and used only as indicated in nVent's product instruction sheets and training materials. Instruction sheets are available at www.nvent.com and from your nVent customer service representative. Improper installation, misuse, misapplication or other failure to completely follow nVent's instructions and warnings may cause product malfunction, property damage, serious bodily injury and death and/or void your warranty.

North America
+1.800.753.9221
Option 1 – Customer Care
Option 2 – Technical Support

Europe
Netherlands:
+31 800-0200135
France:
+33 800 901 793

Europe
Germany:
800 1890272
Other Countries:
+31 13 5835404

APAC
Shanghai:
+ 86 21 2412 1618/19
Sydney:
+61 2 9751 8500



Our powerful portfolio of brands:
nVent.com CADDY ERICO HOFFMAN RAYCHEM SCHROFF
TRACER