



SNAP CLOSE CONDUIT CLAMP WITH NAIL BRACKET, 1/2", 3/4" EMT, 1/2", 3/4" RIGID

CATALOG NUMBER

CNB812M



CERTIFICATIONS



FEATURES

Used to attach conduit to wood, steel or concrete

Eliminates need for offset bending conduit

Works with power tools, screw guns or nails

May be attached after positioning conduit

PRODUCT ATTRIBUTES

Material: Spring Steel

Finish: nVent CADDY Armour

EMT Conduit Size: 1/2";3/4"

Rigid Conduit Size: 1/2";3/4"

Outer Diameter: 0.71 – 1.18"

Hole Size: 3/16"

ADDITIONAL PRODUCT DETAILS

No load rating, for positioning only.

DIAGRAMS

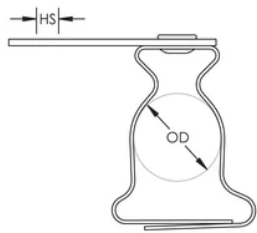

WARNING

nVent products shall be installed and used only as indicated in nVent's product instruction sheets and training materials. Instruction sheets are available at www.nvent.com and from your nVent customer service representative. Improper installation, misuse, misapplication or other failure to completely follow nVent's instructions and warnings may cause product malfunction, property damage, serious bodily injury and death and/or void your warranty.

North America
+1.800.753.9221
Option 1 – Customer Care
Option 2 – Technical Support

Europe
Netherlands:
+31 800-0200135
France:
+33 800 901 793

Europe
Germany:
800 1890272
Other Countries:
+31 13 5835404

APAC
Shanghai:
+ 86 21 2412 1618/19
Sydney:
+61 2 9751 8500



Our powerful portfolio of brands:
nVent.com CADDY ERICO HOFFMAN RAYCHEM SCHROFF
TRACER