

HINGED-COVER, TYPE 1



INDUSTRY STANDARDS

UL 50, 50E Listed; Type 1; File No. E27567
 cUL Listed per CSA C22.2 No 40; Type 1; File No. E27567

NEMA/EEMAC Type 1
 CSA, File 42184: Type 1
 IEC 60529, IP30

APPLICATION

These boxes feature a recessed, slotted flush latch for security as well as knockouts on all four sides, making them suitable for a wide variety of applications.

FEATURES

- Various sizes of easily removable concentric knockouts on all four sides
- Butt hinges
- Mounting holes on back of box
- Provision for grounding

SPECIFICATIONS

- 16 or 14 gauge steel

FINISH

ANSI 61 gray polyester powder paint finish inside and out over pretreated surfaces. Unless otherwise specified, all custom cutout boxes are finished with ANSI 61 gray polyester paint.

ACCESSORIES

See *Accessories*.
 T-Handle Latch and Keyed Cylinder Lock Kits
 Grounding Device
 Touch-Up Paint

BULLETIN: A90HC

Standard Product

| Catalog Number | AxBxC in. | AxBxC mm | Knockout Pattern along "A" Sides | Knockout Pattern along "B" Sides |
|----------------|----------------------|-----------------|----------------------------------|----------------------------------|
| AHE6X4X4 | 6.00 x 4.00 x 4.00 | 152 x 102 x 102 | B-C-D | B-C |
| AHE6X6X4 | 6.00 x 6.00 x 4.00 | 152 x 152 x 102 | B-C-D | B-C-D |
| AHE8X6X4 | 8.00 x 6.00 x 4.00 | 203 x 152 x 102 | F-G-H-I | B-C-D |
| AHE8X8X4 | 8.00 x 8.00 x 4.00 | 203 x 203 x 102 | F-G-H-I | F-G-H-I |
| AHE10X8X4 | 10.00 x 8.00 x 4.00 | 254 x 203 x 102 | F-G-H-I | F-G-H-I |
| AHE10X10X4 | 10.00 x 10.00 x 4.00 | 254 x 254 x 102 | F-G-H-I | C-D-E-F-G |
| AHE12X8X4 | 12.00 x 8.00 x 4.00 | 305 x 203 x 102 | C-D-E-F-G | F-G-H-I |
| AHE12X10X4 | 12.00 x 10.00 x 4.00 | 305 x 254 x 102 | C-D-E-F-G | C-D-E-F-G |
| AHE12X12X4 | 12.00 x 12.00 x 4.00 | 305 x 305 x 102 | C-D-E-F-G | C-D-E-F-G |
| AHE16X12X4 | 16.00 x 12.00 x 4.00 | 406 x 305 x 102 | B-C-D-E-F-G-H | C-D-E-F-G |
| AHE18X12X4 | 18.00 x 12.00 x 4.00 | 457 x 305 x 102 | A-B-C-D-E-F-G-H-I | C-D-E-F-G |
| AHE6X6X6 | 6.00 x 6.00 x 6.00 | 152 x 152 x 152 | B-C-D | B-C-D |
| AHE8X8X6 | 8.00 x 8.00 x 6.00 | 203 x 203 x 152 | F-G-H-I | F-G-H-I |
| AHE10X8X6 | 10.00 x 8.00 x 6.00 | 254 x 203 x 152 | F-G-H-I | F-G-H-I |
| AHE10X10X6 | 10.00 x 10.00 x 6.00 | 254 x 254 x 152 | F-G-H-I | C-D-E-F-G |
| AHE12X10X6 | 12.00 x 10.00 x 6.00 | 305 x 254 x 152 | C-D-E-F-G | C-D-E-F-G |
| AHE12X12X6 | 12.00 x 12.00 x 6.00 | 305 x 305 x 152 | C-D-E-F-G | C-D-E-F-G |
| AHE16X12X6 | 16.00 x 12.00 x 6.00 | 406 x 305 x 152 | B-C-D-E-F-G-H | C-D-E-F-G |
| AHE16X16X6 | 16.00 x 16.00 x 6.00 | 406 x 406 x 152 | B-C-D-E-F-G-H | B-C-D-E-F-G-H |
| AHE18X12X6 | 18.00 x 12.00 x 6.00 | 457 x 305 x 152 | A-B-C-D-E-F-G-H-I | C-D-E-F-G |
| AHE18X18X6 | 18.00 x 18.00 x 6.00 | 457 x 457 x 152 | A-B-C-D-E-F-G-H-I | A-B-C-D-E-F-G-H-I |
| AHE24X18X6 | 24.00 x 18.00 x 6.00 | 610 x 457 x 152 | A-B-C-D-E-F-G-H-I | A-B-C-D-E-F-G-H-I |
| AHE24X24X6 | 24.00 x 24.00 x 6.00 | 610 x 610 x 152 | A-B-C-D-E-F-G-H-I | A-B-C-D-E-F-G-H-I |
| AHE30X24X6 | 30.00 x 24.00 x 6.00 | 762 x 610 x 152 | A-B-C-D-E-F-G-H-I | A-B-C-D-E-F-G-H-I |
| AHE36X24X6 | 36.00 x 24.00 x 6.00 | 914 x 610 x 152 | A-B-C-D-E-F-G-H-I | A-B-C-D-E-F-G-H-I |
| AHE36X24X8 | 36.00 x 24.00 x 8.00 | 914 x 610 x 203 | A-B-C-D-E-F-G-H-I | A-B-C-D-E-F-G-H-I |

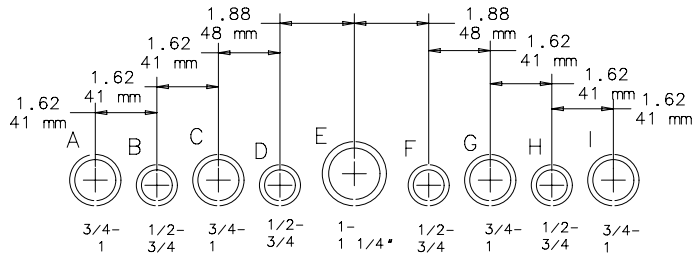
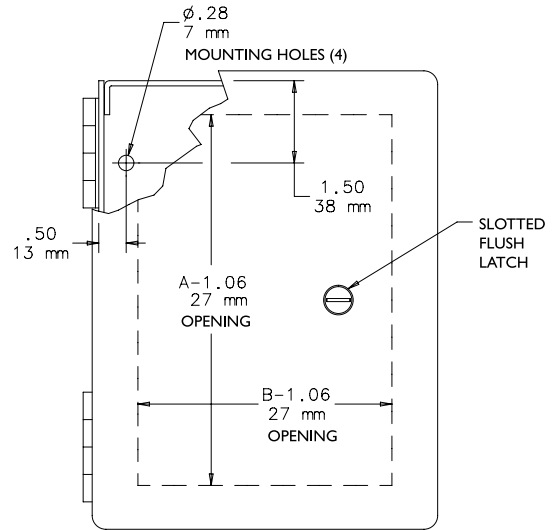
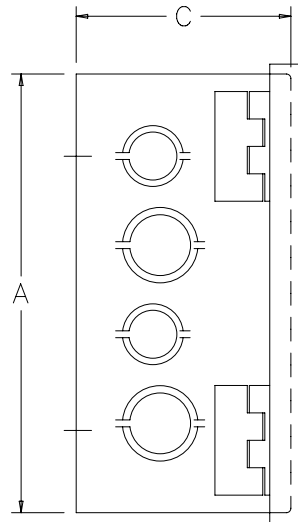

CONDUIT SIZES
Knockout Pattern
 (from outside of box)

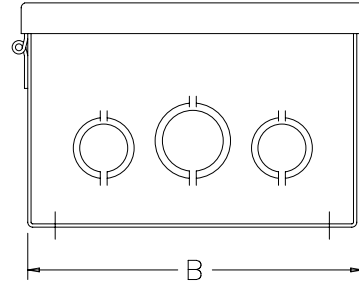

C2571-C

NOTE: Refer to table for applicable knockout pattern.