

TYPE MT-25

Features

- Dieless single indent compressor
- Steel adjusting knob
- UL Listed terminals and splices
- Broad wire range
- Mounting hole for bench mounting applications

Benefits

- Reduces installed cost by having no separate dies to purchase, change or lose
- Provides fast and easy setting. Simply align the line on the die nest with the wire size gauge for proper crimping results.
- Ensures reliability. ILSCO's standard line of connectors are UL Listed when crimped with the MT-25 tool
- Convenience

Specifications

Length: 22.65"
Weight: 6 lbs.
Depth: 4.86"
Width: 1.12"
Conductor Range: 4/0-8 AL
250kcmil-8 CU



For Use with

Aluminum Connectors	Copper Connectors
ACL, ACN 4/0-8	CLN4, CLN9, CLND,
2ACL, 2ACN 4/0-8	CLNF, CLNN, CLNS,
AS 4/0-8	CLNU, CLW4, CLW9,
Series:ALNS, ALND, ASN,	CLWD, CLWF, CLWN,
ALNN thru 4/0	CLWS, CSN4, CSN9,
	CSND, CSNF, CSNN,
	CSNS, CSW4, CSW9,
	CSWD, CSWF, CSWN,
	CSWS thru 250kcmil
	CCL, CRAM

All wire sizes, unless noted otherwise, are American Wire Gauge (AWG)

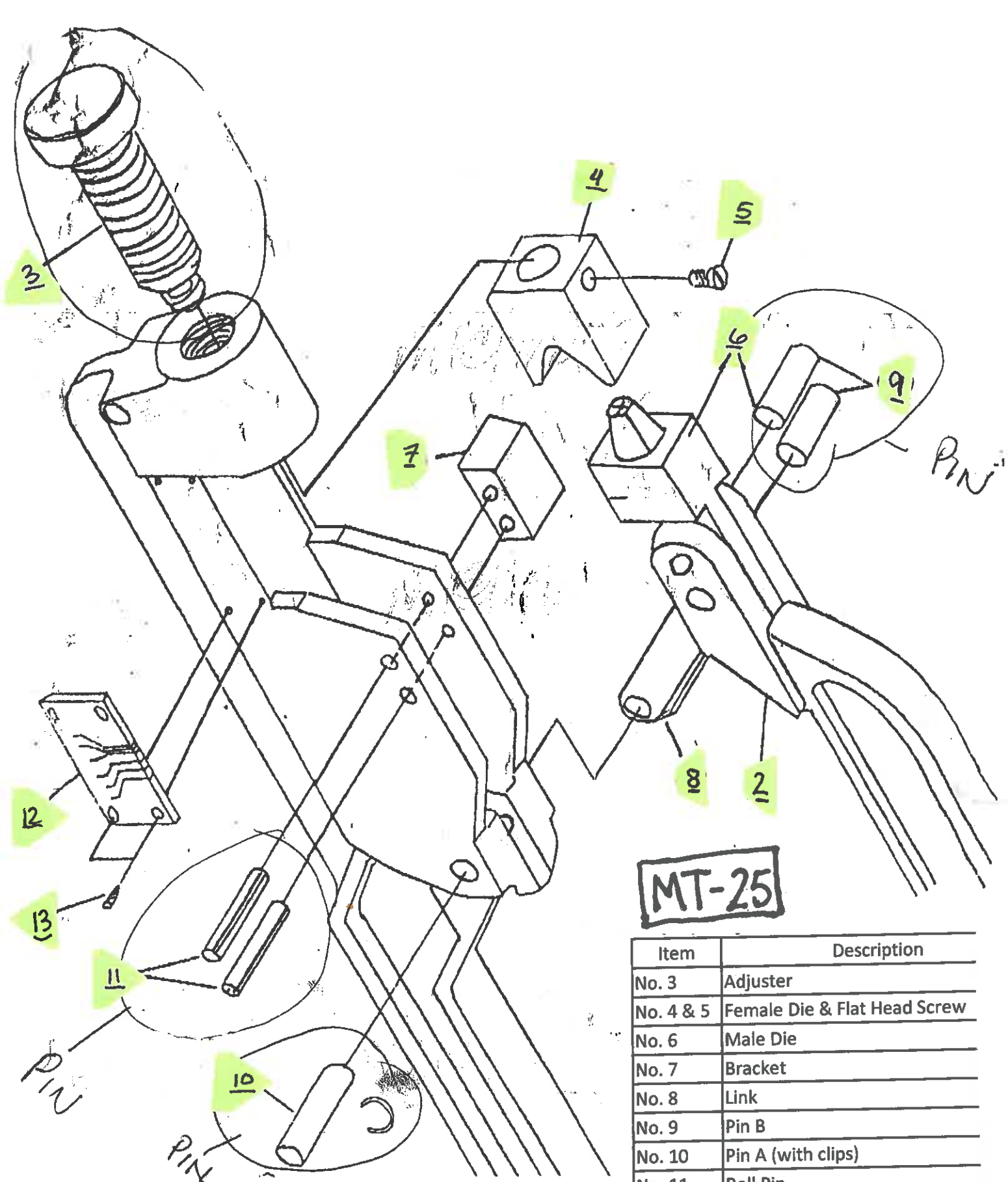

MT-25

Item	Description
No. 3	Adjuster
No. 4 & 5	Female Die & Flat Head Screw
No. 6	Male Die
No. 7	Bracket
No. 8	Link
No. 9	Pin B
No. 10	Pin A (with clips)
No. 11	Roll Pin
No. 12	Graduated Plate (2pcs/set)
No. 13	Rivet