

Industrial Control Transformers

SDN-PMBRK2 Panel Mount Brackets Installation Manual



P/N: 272-38176-10
REV. 05 (05/16)
©2016 Appleton Grp LLC d/b/a Appleton Group
All rights reserved. Specifications
subject to change without notice.

Caution
*Make sure all power is off
before any wiring is started.*

Dimensions in Inches

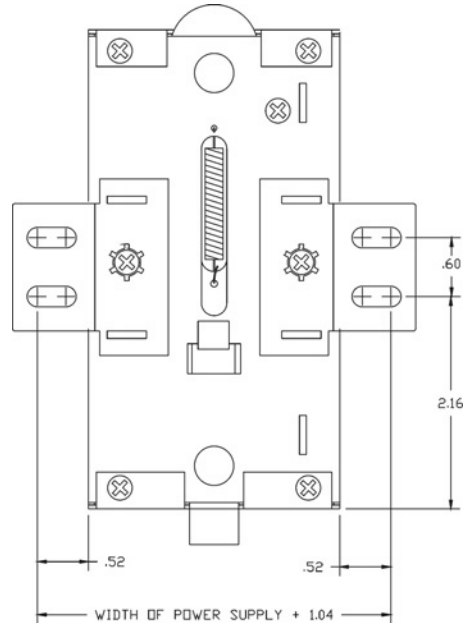

Chassis Mounting

The Sola SDN/SLR/STV can also be screw mounted by means of the panel mount bracket set SDN-PMBRK2.

This set consists of two steel brackets, which replace the existing two DIN mounting brackets at the back of the unit.

Included: Two brackets
Two lock washers

Not Included: Two M3 x 6mm screws (reused after removing existing bracket)
Four 8-32 x .5" screws for mounting unit to panel
Four 8-32 flat washers

Exchanging the Brackets

a. At the unit:

1. Remove the screw from the DIN bracket. (Retain screws to use on panel mount bracket).
2. Pull the bracket outwards to remove.

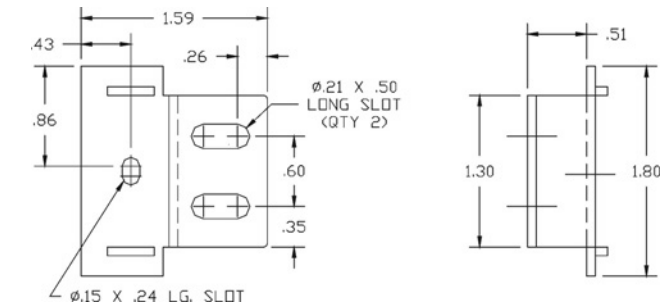
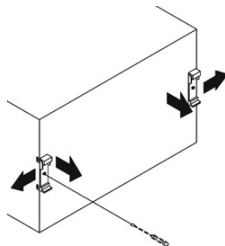

- b. Push the SDN-PMBRK2 bracket into the groove as far as possible. Slide upwards and secure with screw and lock washer.

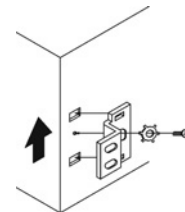

Note the orientation:

The bracket fits into the groove only as shown here.

