

LIGHTING

VM2&4LB, VM2&4LC SERIES



HIGH WATTAGE – INTRODUCTION



VM2LB with Globe/
Guard



VM4LB with Globe/
Guard



VM4LC with Flat Lens



Class I, Div. 2, Groups A, B, C, D
Class I, Zone 2, Groups IIC, IIB, IIA
Class II, Div. 1 & 2, Groups E, F, G
Class III
Suitable for wet locations
Type 3, 4X
IP66
Marine Rated (US only)

CSUS Certified - File LR11713

IECEx Rated Models (VM4L with IEx suffix)
Ex nA IIC T4, Gc / Ex tb IIIC T83°C Db
Tamp -40°C ≤Ta ≤+65°C, IP66

IECEx Certificate
QPS 15.0006

INMETRO Certificate
IEx 16.0137

ATEX Certificate
CML 15ATEX4101X(nA)
&
CML 15ATEX3102X(tb)

Contact Factory for other certification details



Consult website
for current list of
approved luminaires

CERTILITE[®] V LED

FEATURES-SPECIFICATIONS

Applications

CERTILITE[®] V VM4L LED fixtures are designed for installations where moisture, dirt, dust, corrosion and vibration may be present, or Type 3 and 4X areas where wind, water, snow or high ambients can be expected. They can be used in locations made hazardous by the presence of flammable vapors or gases or combustible dusts as defined by the NEC/CEC/IECEX/ATEX & INMETRO.

Typical applications include manufacturing plants, food processing, certain chemical and petrochemical processing facilities, sewage treatment plants, off-shore and dockside installations, garages and storage facilities.

Compliances

- UL-8750 for LED lighting
- UL-844 Standard for lighting fixtures for hazardous locations, Class I, Division 2; Class II, Divisions 1 and 2; Class III
- CSA C22.2 no. 137-M1981 electric luminaires for use in hazardous locations
- Enclosed and gasketed
- Type 3, 4X
- IP66 & Marine
- Self-testing per NFPA 101[®] Life Safety Code

Materials

- Housing, splice box and cast guards corrosion resistant copper-free aluminum alloy
- Baked powder epoxy/polyester finish, electrostatically applied for complete, uniform corrosion protection
- All external hardware – stainless steel
- Reflectors – Polyester reinforced fiber glass or aluminum

LED Luminaire Features and Standards

Supplemental **20KA/10KV Surge Protection** is **standard** (for 120-277 VAC models)
10KA/10KV Surge Protection (for 347-480 VAC)

- Traditional Industrial Appearance, Suitability, and Photometric Performance
- Wide variety of optics including globes, globes with reflectors, all-glass refractors, spin-top refractors and flat lens
- Swing-Barrel Nut patented tank mounting system
- Optional Mounting arrangements including Pendant, Wall, Ceiling, Stanchion and others
- VM4L LED Housings can be retrofitted to existing VM splice boxes; upgrade from HID sources
- **VM2Lx housing is 1.56" shallower for low ceilings**
- Crisp White Light for Excellent Color Rendering – Chromaticity 5000 K (CCT range); approx. 70 CRI
- Energy Savings – less than 130 Watts of Power
- LED Array Life – 100,000+ hours with 70% initial lumens
- Long Fixture Life – 50,000 - 55,000 maintenance free hours
- Ambient suitability -40°C to 65°C (see tables). **-20°C to 50°C Ambient suitability for Emergency models.**
- Instant On – Including after power interruption
- World Voltage 120 – 277VAC 50/60Hz
- Solder-LESS LED Board Connections – Vibration Resistant
- Dual Driver Option (DDR) – For additional energy savings, half of the fixture can be turned off.
- Two LED internal heat sink styles
 - » Bulb VM2LB/VM4LB
 - » Concave VM2LC/VM4LC

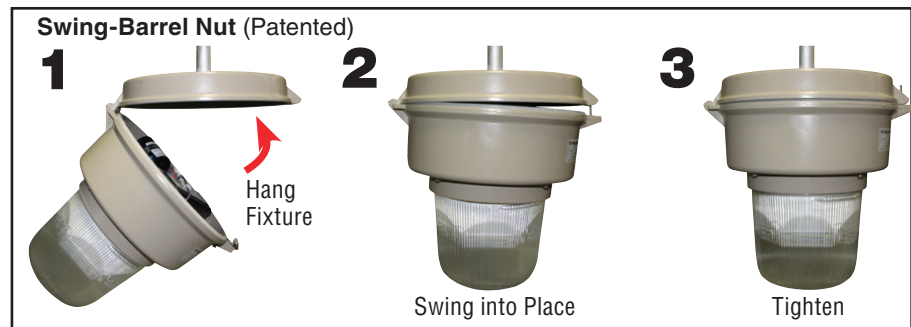



HIGH WATTAGE – CATALOG LOGIC

CERTILITE[®]V LED

Killark high efficiency LED Luminaries require NO external heat sink which adds weight and collects dust and other contaminants



CertiLite[®]V LED Catalog Number Logic

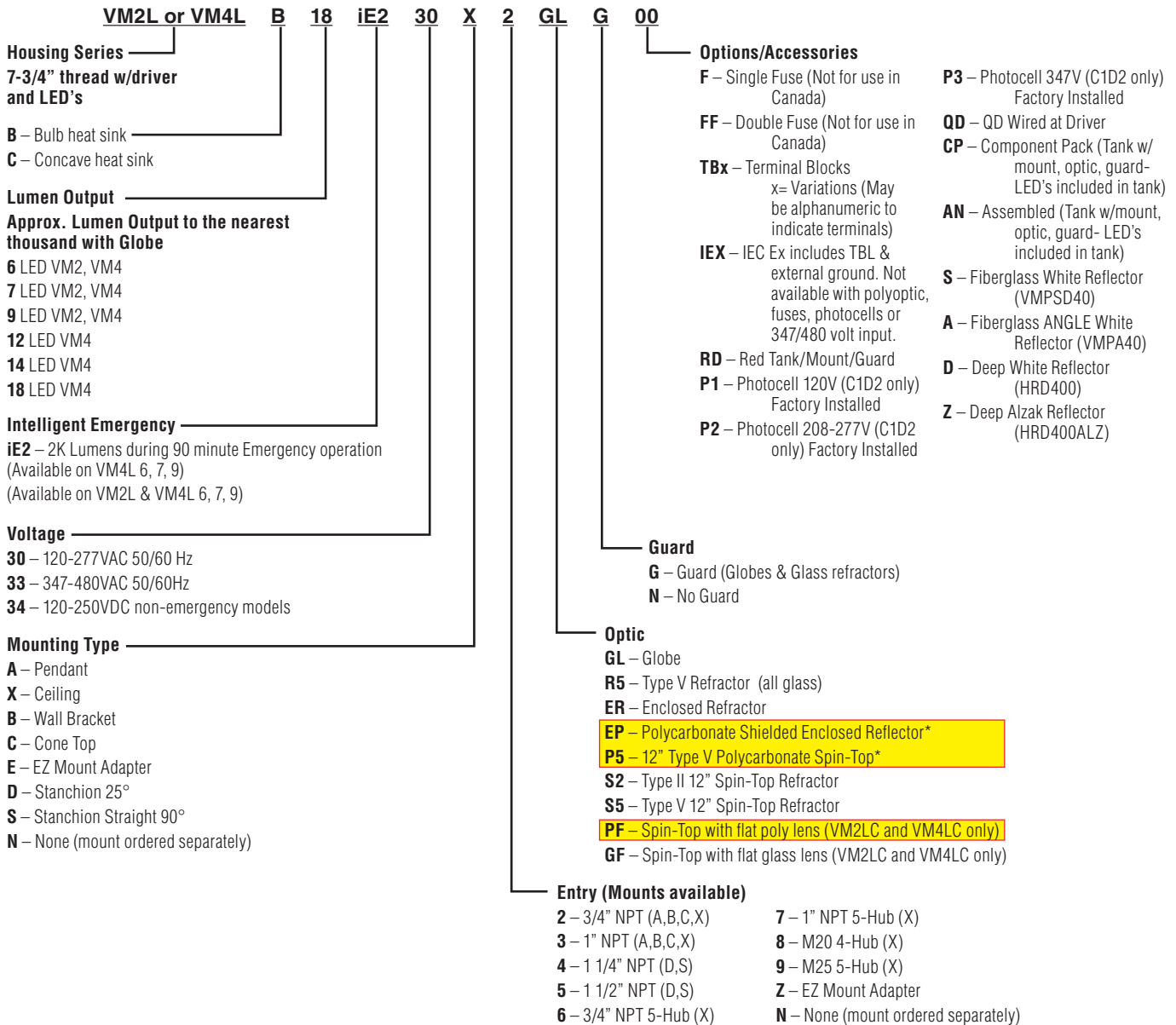

*Non-glass Group G Food Processing Suitability

LIGHTING

VM2&4LB, VM2&4LC SERIES



HIGH WATTAGE – OPTICS AND ACCESSORIES

CATALOG NUMBER	DELIVERED LUMENS								
	VMG25	VMR255	VMER40	VMEP40	VZRP175B	VZRG4020	VZRG4050	VZRPF12	VZRGF12
	GL	R5	ER	EP	P5	S2	S5	PF	GF
VM4LB6(XX)(YY)N	6278	5915	4575	4336	4692	4771	4879		
VM4LC6(XX)(YY)N	6223	5127	4645	4041	4880	4989	4914	5570	5644
VM4LB7(XX)(YY)N	7437	6996	5589	5210	5846	5968	5973		
VM4LC7(XX)(YY)N	7344	6026	5491	4776	5757	5892	5830	6563	6679
VM4LB9(XX)(YY)N	9692	9084	7465	6933	7928	8090	8078		
VM4LC9(XX)(YY)N	9453	7746	6973	6093	7420	7671	7482	8492	8647
VM4LB12(XX)(YY)N	12750	12020	9804	9168	10410	10550	9168		
VM4LC12(XX)(YY)N	12300	10380	9470	8165	9969	10190	10030	11370	11570
VM4LB14(XX)(YY)N	14760	13810	11240	10430	11890	12110	12010		
VM4LC14(XX)(YY)N	14120	11980	10910	9417	11460	11810	11520	13080	13300
VM4LB18(XX)(YY)N	17710	16700	14080	13050	14910	15050	15140		
VM4LC18(XX)(YY)N	17820	14530	13380	11480	13970	14390	14190	15940	16270

(XX) = VOLTAGE
(YY) = MOUNT



VMG25



VMR255



VMER40



VMEP40



VZRP175B



VZRG4020



VZRG4050



VZRPF/VZRGF

TYPICAL WEIGHTS (LBS./KG) W/STANDARD GLOBE AND GUARD - VM4LB/C SERIES			
Pendant 33.4/15.2	Ceiling 33.0/15.0	Wall 37.9/17.2	Stanchion 34.3/15.6

ORDERING INFORMATION AND AMBIENT SUITABILITY					C1D2			C2D1		
CATALOG NO. ②	TYPICAL TANK ONLY WEIGHT LBS./KG	WATTS	VOLTAGE	AMPS ①	40°C	55°C	65°C	40°C	55°C	65°C
VM4L(Y)630	18.90 / 8.57	40	120-277 VAC	0.35-0.16	T4A	T4A	T4	EFG		
VM4L(Y)633		40	347-480VAC	0.12-0.09						
VM4L(Y)634		40	120-250VDC	0.33-0.16						
VM4L(Y)730		50	120-277 VAC	0.43-0.21	T4A	T4A	T4	EFG		
VM4L(Y)733		50	347-480VAC	0.15-0.12						
VM4L(Y)734		50	120-250VDC	0.42-0.20						
VM4L(Y)930		65	120-277 VAC	0.56-0.24	T4A	T4A	T4	EFG		
VM4L(Y)933		65	347-480VAC	0.19-0.14						
VM4L(Y)934		65	120-250VDC	0.54-0.26						
VM4L(Y)1230		90	120-277 VAC	0.77-0.33	T4A	T4	-	EFG	-	
VM4L(Y)1233		90	347-480VAC	0.27-0.19						
VM4L(Y)1234		90	120-250VDC	0.75-0.36	T4A	T4	-	EFG	-	
VM4L(Y)1430		105	120-277 VAC	0.89-0.39						
VM4L(Y)1433		105	347-480VAC	0.31-0.23						
VM4L(Y)14834		105	120-250VDC	0.88-0.42	T4A	T4	-	EFG	-	
VM4L(Y)1830		130	120-277 VAC	1.10-0.46						
VM4L(Y)1833		130	347-480 VAC	0.38-0.27						

ORDERING INFORMATION AND AMBIENT SUITABILITY					C1D2			C2D1		
CATALOG NO. ②	TYPICAL TANK ONLY WEIGHT LBS./KG	WATTS	VOLTAGE	AMPS ①	40°C	55°C	65°C	40°C	55°C	65°C
VM2L(Y)630	17.65 / 8.00	40	120-277 VAC	0.35-0.16	T4A	T4A	T4	EFG		
VM2L(Y)633		40	347-480VAC	0.12-0.09						
VM2L(Y)634		40	120-250VDC	0.33-0.16						
VM2L(Y)730		50	120-277 VAC	0.43-0.21	T4A	T4A	T4	EFG		
VM2L(Y)733		50	347-480VAC	0.15-0.12						
VM2L(Y)734		50	120-250VDC	0.42-0.20						
VM2L(Y)930		65	120-277 VAC	0.56-0.24	T4A	T4A	T4	EFG		
VM2L(Y)933		65	347-480VAC	0.19-0.14						
VM2L(Y)934		65	120-250VDC	0.54-0.26						

① For a given wattage current values are the same, regardless of tank type VM2LB/C or VM4LB/C.

② Replace (Y) with heat sink style B or C.



HIGH WATTAGE SELF-TESTING EMERGENCY

Electronics Includes:

- Self-diagnostics monitors LED status, LED driver circuit, battery capacity and charger function and displays any fault detection by means of a flashing code
- Self-Test feature automatically runs a 1 minute test once a month and an alternating 30-60 minute test once every 6 months. LED indicator provides visible fault detection and charging status
- User initiated 1, or 90-minute system test feature
- 15 minute re-transfer delay
- Automatic unit transfer in brown-out conditions (below 80% of nominal AC input voltage)

INDICATOR STATUS SIGNAL	DESCRIPTION OF STATUS SIGNAL
0.5s ON and 0.5s OFF	Battery disconnected.
2.5s ON and 2.5s OFF	LED load disconnected.
4.5s ON and 0.5s OFF	Driver in self-diagnostic mode.
1.5s ON and 3.5s OFF	Battery needs to be replaced.
0.5s ON and 4.5s OFF	Damaged driver. Replace
ON	Normal/Charging.
OFF (LED Load ON)	Discharging / Emergency Operation

LED Emergency Lighting Design

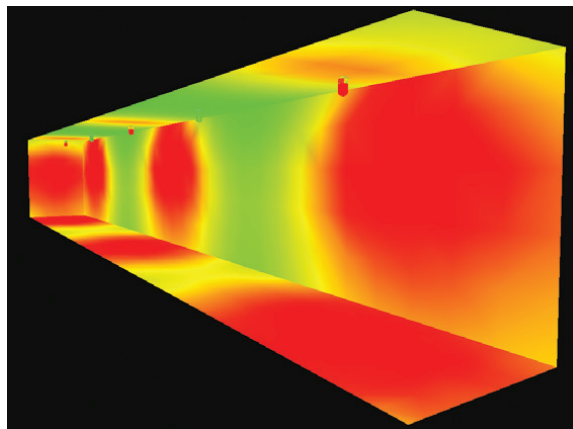

HIGH WATTAGE – COMPONENTS



CERTILITE® VM MOUNTING SPLICE BOXES

HUB SIZE	CATALOG NUMBER						
	PENDANT	CEILING 4 HUB	CEILING 5 HUB	WALL	CONE TOP	25 DEGREE STANCHION	STRAIGHT STANCHION
3/4"	VMA2B	VMX2B	VMX6B	VMB2B	VMC2B	—	—
1"	VMA3B	VMX3B	VMX7B	VMB3B	VMC3B	—	—
1-1/4"	—	—	—	—	—	VMD4B	VMS4B
1-1/2"	—	—	—	—	—	VMD5B	VMS5B
M-20	—	VMX8B	VMX9B	VMB8B	—	—	—
M-25	—	—	—	VMB10B	—	—	—

LIGHTING

VM2&4LB, VM2&4LC SERIES



HIGH WATTAGE – COMPONENTS & RATINGS



“EZ” Mount Adapter
For easy fixture relocation or to repair fixture on ‘bench top’.



VMEZA adapter is used between a driver tank and EZ mount ordered separately.



Pendant



Ceiling



Wall Bracket



25° Stanchion

MOUNTING BOXES				
CATALOG NUMBER				HUB SIZE
PENDANT	CEILING	BRACKET	STANCHION	
EZA2	EZX2	EZB3	—	3/4"
EZA3	EZX3	EZB3	—	1"
—	—	—	EZD4A	1-1/4" / 1/2"*

*1-1/2" furnished with 1-1/2"-1-1/4" reducer and extension.

Competitive Adapters

Designed to ease upgrading of other manufacturer’s fixtures to KILLARK LEDs where removal of existing mounting screws and conduit would be difficult and time consuming.

VM2L/VM4L LED OPTICS AND ACCESSORIES		
DESCRIPTION	OPTIC LOGIC	GUARD
Flat Lens (glass spin top) “C” tank only	VZRGF12 (GF)	VZRF12GRD
Flat Lens (polycarbonate spin top) “C” tank only	VZRPF12 (PF)	VZRF12GRD
Globe (glass)	VMG25 (GL)	VMAG25S
Reflector (all glass) Type V	VMR255 (R5)	VMAG25S
Enclosed Reflector	VMER40 (ER)	VMERG
Enclosed Reflector with polycarbonate Lens	VMEP40 (EP)	—
Reflector (polycarbonate spin top) 12” Type V	VZRP175B (P5)	VMRWGS
Reflector (glass spin top) 12” Type V	VZRG4050 (S5)	VMRWGS



VMAG25S



VMRWGS

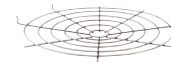

VMERG



VMAGBC



VMPSD40
Standard Dome, Fiberglass
White Reflector, Dia: 16”



VMPA40
30° Angle, Fiberglass
White Reflector, Dia:16”



HRD400
Deep Aluminum, White
Reflector, Dia: 21”



HRD400ALZ
Deep Aluminum, Anodized
Reflector, Dia: 21”



VEXA400
Fixture not included



VMFSPC

VM2L/VM4L LED REFLECTORS AND ACCESSORIES	
DOME REFLECTOR (Polyester reinforced fiberglass)	VMPSD40
ANGLE REFLECTOR (Polyester reinforced fiberglass)	VMPA40
DEEP DOME REFLECTOR (White Painted Aluminum)	HRD400
DEEP DOME REFLECTOR (Anodized Aluminum)	HRD400ALZ
120VAC Photocell with FS Style Cover	VMFSPC1
208-277VAC Photocell with FS Style Cover	VMFSPC2
Bottom Closure for VMAG25S	VMAGBC
4-sided EXIT Accessory (use without guard)	VEXA400



FIXTURE ADAPTERS



VMCHVM-DEEP



VMCHVM

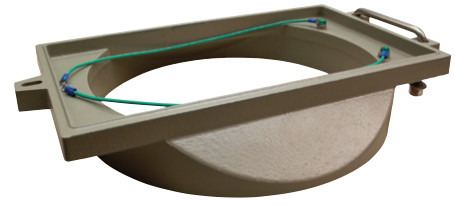

VMGEH2

CERTIFIED LED

FEATURES-SPECIFICATIONS

Applications

The Killark VM adapters are designed to ease upgrading of other manufacturer's fixtures to KILLARK LEDs where removal of existing mounting screws and conduit would be difficult and time consuming.

Adapters are used with the Killark Fixture Housing, Globe, guard (if applicable) and the competitive fixture splicebox. The Killark fixtures when used with the Killark adapters and appropriate competitive adapter.

Features

- Fixture and competitive mount are certified together
- Baked powder epoxy/polyester finish, electrostatically applied to match the Killark VM tank
- All external hardware – Stainless Steel

Class I, Div. 2, Groups A, B, C, D
Class II, Div. 1, Groups E, F, G
Class III
Type 4X



VM SERIES COMPETITIVE ADAPTERS		
CATALOG NUMBER	DESCRIPTION	EXAMPLE OF MODEL UTILIZED OR REPLACED
VMCHVM	Tank adapter to Crouse-Hinds® VM Series mounts	VMV S2 C 050 R5
VMCHVM-DEEP	Tank adapter to CH (70's era wall mount with deep box)	VMV S2 TW 050 R5
VMM2LP	Tank adapter to Appleton® MERCMaster II mounts	LPCL 50 75 J
VMM3KP	Tank adapter to Appleton® MERCMaster III mounts	KPCL 50 75 J5 MT
VMHLDS	Tank adapter to Hazlux®3 mounts	DS015 H040-TGL-P2 E1 F
VMHPP2	Tank adapter mount to Holophane® Petrolux™	PETL 250HP 27 S25 CD
VMGEH2	Tank adapter H2 mount to GE® H2 Filtr-gard™	H2 4 05L 3C GG

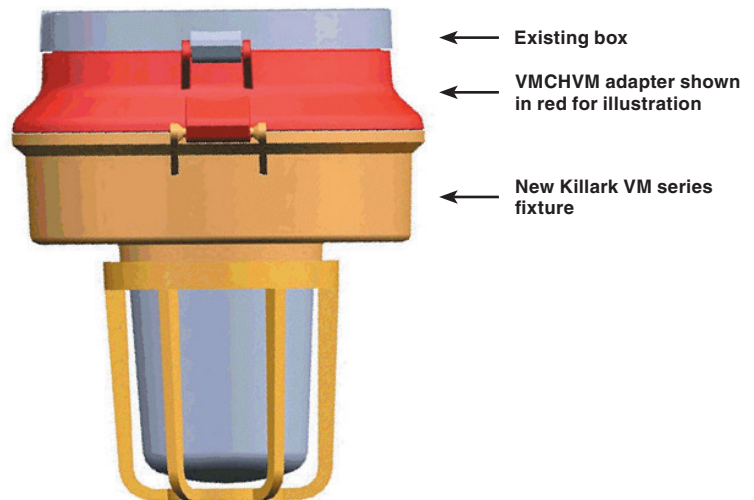
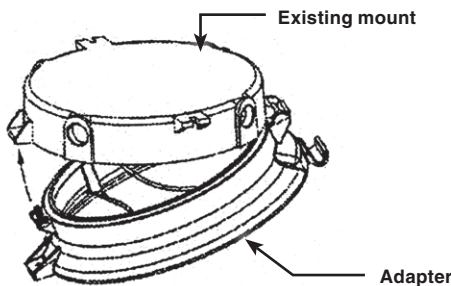

LIGHTING

VM2&4LB, VM2&4LC SERIES



HIGH WATTAGE – DIMENSIONS & WEIGHTS

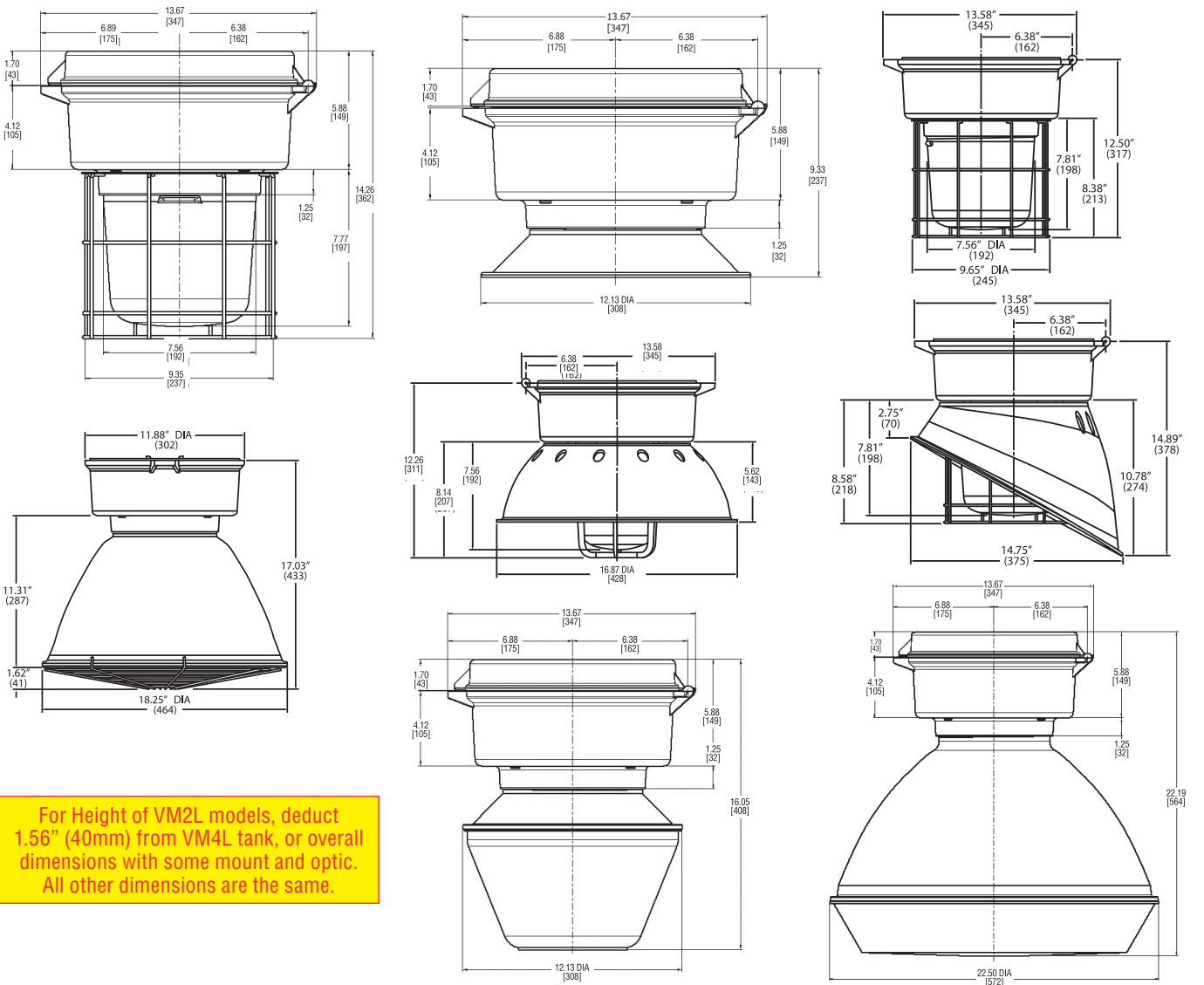
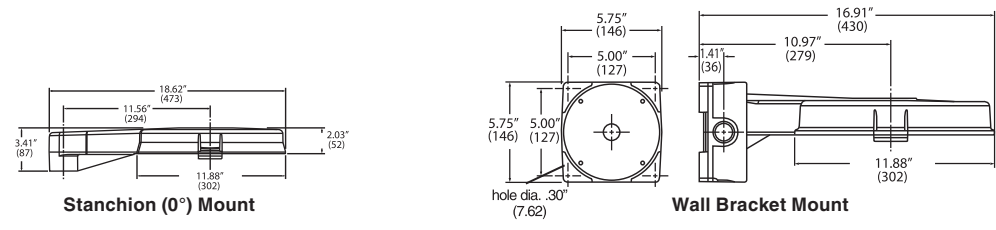
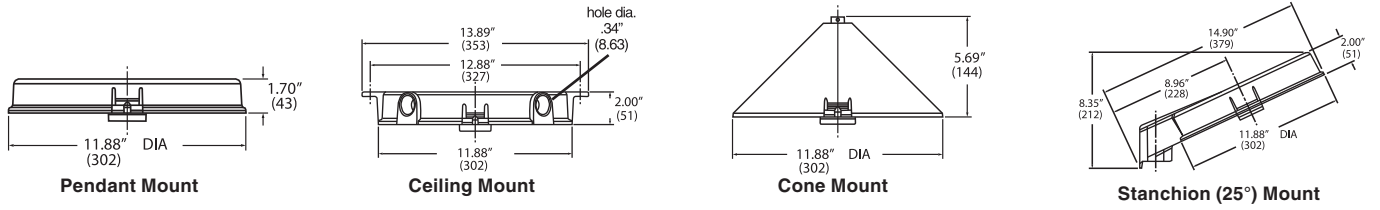

For Height of VM2L models, deduct 1.56" (40mm) from VM4L tank, or overall dimensions with some mount and optic. All other dimensions are the same.