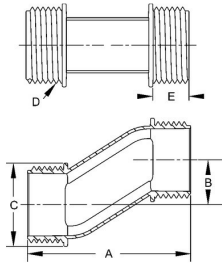

**NIPPLES****Offset Nipples Die Cast Zinc**
N/A**B90**

Catalog #: 1454

APPLICATIONSFor use when connecting two boxes or panels when the knockouts are not in line.
N/A**PRODUCT FEATURES**Creates a 3/4 inch offset connection.
Rugged metallic construction provides mechanical protection for the conductors.**UL LISTED**

Standard 514B, File E195969

CSA

C22.2 No. 18

GENERAL PRODUCT INFORMATION

Trade Size: 1 in.

DRAWING DIMENSIONSDimension A: 2-23/32 in.
Dimension B: 3/4 in.
Dimension C: 1-25/64 in.
Dimension D: 1 in. - 11/12 NPSM
Dimension E: 39/64 in.**PACKAGING**Package Type: Carton
Ship Carton Qty.: 15
Product UPC-A Labeled: No
Weight (Lbs. Per/C): 20.40
Ship Carton Length (in.): 7.45
Ship Carton Width (in.): 5.37
Ship Carton Height (in.): 5.45
Ctn Weight (Lbs.): 3.06
UPC Number: 050169014547
I2of5: 50050169014542