

**EMT COMPRESSION CONNECTORS**

Compression Connectors, Steel

B05

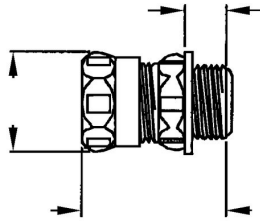

Catalog #: 2905US

**APPLICATIONS**

For use to bond EMT conduit to a box or enclosure.  
 RACO Compression connectors are suitable for applications above 600V.

**PRODUCT FEATURES**

1/2 in. to 4 in. connectors provide concrete-tight connections  
 All steel construction ensures mechanical protection for the raceway  
 All components are zinc electroplated for corrosion protection  
 UPC bar coded fittings are individually polybagged with a preprinted UPC-A bar code, and packaged in pre-scored tear top cartons for an attractive presentation.

**CULUS**

Standard 514B, UL Listed E195970, C22.2 No. 1

**COMPLIANCES**

MSDS  
[www.hubbell-rtb.com/certifications/Hubbell-RACO\\_MSDS\\_for\\_WP\\_Boxes\\_and\\_Fittings,January\\_2015.pdf](http://www.hubbell-rtb.com/certifications/Hubbell-RACO_MSDS_for_WP_Boxes_and_Fittings,January_2015.pdf)

**GENERAL PRODUCT INFORMATION**

Sub Class: Uninsulated  
 Trade Size: 1-1/4 in.

**DRAWING DIMENSIONS**

Dimension A: 2.10 in.  
 Dimension B: .65 in.  
 Dimension C: 2.04 in.

**PACKAGING**

Package Type: Carton  
 Std. Pkg.: 5  
 Ship Carton Qty.: 25  
 Product UPC-A Labeled: No  
 Weight (Lbs. Per/C): 30.00  
 Ship Carton Length (in.): 12.88  
 Ship Carton Width (in.): 8.75  
 Ship Carton Height (in.): 5.63  
 Ctn Weight (Lbs.): 11.28  
 UPC Number: 050169570333  
 I2of5: 50050169570338