



# HALO Commercial

## HC4

4-inch LED Downlight & Wall Wash



# HC4

## 4-inch LED Downlight and Wall Wash

Versatile 4-inch commercial downlight optimized for lumen efficiency and optical performance. Reflectors offered in narrow, medium, wide distribution for efficiency in lumen delivery. Value priced and contractor installation friendly with connected lighting options available.

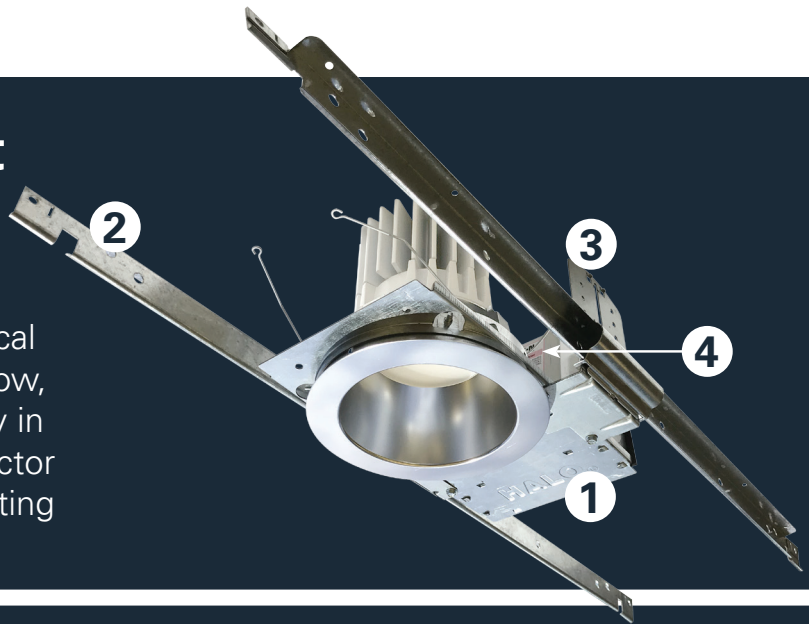

### Standard Features

#### 1. Housing Frame

- a. 4" Boat-shaped galvanized steel frames with die-formed aperture
- b. New construction or remodeling installation with boat shaped frame
- c. Plaster lip collar pre-set to 1/2" and adjusts for ceilings up to 1-1/2" thick

#### 2. No Fuss Bar Hangers

- a. Pre-installed and centered mounting bars
- b. Bars lock to tee grid with screwdriver or pliers
- c. Centering marks on the bar bracket

#### 3. Adjustable Mounting Brackets

- a. Bar brackets adjust 2" vertically from above the ceiling or through the aperture
- b. Brackets for use with the included "No Fuss" mounting bars or with 1/2" EMT
- c. Brackets are removable for remodel installation from below the ceiling

#### 4. Junction Box

- a. Listed for (8) #12 AWG 90° C conductors (4-in/4-out)
- b. Listed for feed through branch wiring
- c. (3) 1/2" and (2) 3/4" trade size pry-outs
- d. Low voltage barrier section for 0-10V dimming wires
- e. (3) 4-port push wire nuts (1-port is fixture connection)

### LED Modules



**HM4 Low Lumen LED Module**  
Lumens  
1000 | 1500 | 2000

**HM4 High Lumen LED Module**  
Lumens  
3000 | 4000

The HC4 LED modules are available in a range of correlated color temperatures (CCT). The user can choose from a range of four 80 or 90 CRI color temperatures 2700K, 3000K, 3500K and 4000K.

#### Color temperature

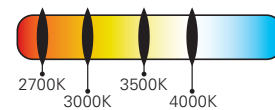

#### Lumen options

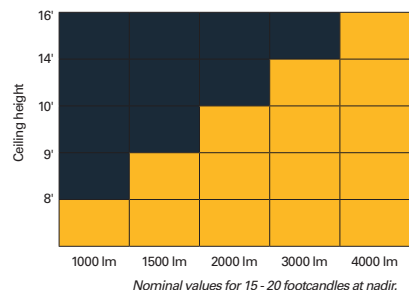

### Reflectors



#### Beam distribution options\*

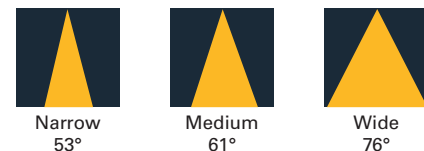

Beam Distribution*			
Code	Distribution	Spacing Criteria	Beam Angle
ND	Narrow	0.84	53°
MD	Medium	1.0	61°
WD	Wide	1.2	76°

\* Nominal values may vary depending on selected CRI/CCT and reflector finish.

# 4" HC4 LED Downlight & Wall Wash

4-inch aperture LED downlight offered in narrow, medium, wide, and wall wash distributions ideal for general area lighting. Lumen options range from 1000 to 4000 lumens in color temperatures of 2700K, 3000K, 3500K, and 4000K; in 80 or 90CRI. Luminaire is airtight and can be installed in new construction or below the finished ceiling in remodeling applications. Intended for office spaces, healthcare, hospitality, and institutional uses.

**Sample Number:** HC410D010REM7 - HM412830 - 41NDC

A complete luminaire consists of a mounting frame, LED module, and reflector (order separately)

120-277VAC, 0-10V analog dimming			
Mounting Frame	Lumens	Driver	Options <sup>1</sup>
<b>HC4</b> = 4" new construction and remodeler frame  <b>HC4CP</b> = 4" new construction and remodeler housing, CCEA Chicago Plenum rated	<b>Fixed, Factory Set</b> <b>10</b> = 1000 lumens (nominal), use with HM412 module <b>15</b> = 1500 lumens (nominal), use with HM412 module <b>20</b> = 2000 lumens (nominal), use with HM412 module <b>30</b> = 3000 lumens (nominal), use with HM434 module <b>40</b> = 4000 lumens (nominal), use with HM434 module	<b>D010</b> =120-277VAC 50/60Hz 0-10V analog 1% - 100% dimming <b>D010347</b> = 347VAC 50/60Hz 0-10V analog 1%-100% dimming (Canada only) <sup>1</sup>	<b>REM7</b> = 7 watt emergency module with remote test / indicator light, use with D010 only <b>REM14</b> = 14 watt emergency module with remote test / indicator light, use with D010 only <b>IEM7</b> = integral 7 watt emergency module with integral test / indicator light, use with D010 only <b>IEM14</b> = integral 14 watt emergency module with integral test / indicator light, use with D010 only <b>BOD7ST</b> = 7.5 watt Bodine self-test diagnostic emergency module with remote test / indicator light, use with D010 only <b>WTA</b> =Factory installed WaveLinX sensor Kit <sup>5</sup> <b>WTK</b> = Factory installed WaveLinX Lite Sensor Kit <sup>6</sup>
		<b>DLV</b> =distributed low voltage dimming (1%-100%) driver <sup>1</sup>  For use with DLVP system only. Refer to DLVP system specifications for details.	<b>REM7V</b> = 7 watt emergency module with remote test / indicator light, use with DLV only <sup>2</sup> <b>REM14V</b> = 14 watt emergency module with remote test / indicator light, use with DLV only <sup>2</sup> <b>IEM7V</b> = integral 7 watt emergency module with integral test / indicator light, use with DLV only <sup>2</sup> <b>IEM14V</b> = integral 14 watt emergency module with integral test / indicator light, use with DLV only <sup>2</sup>

LED Module	Lumens	CRI/CCT	Accessories
<b>HM4</b> = 4" LED module  Use with 41 & 42 series reflectors. Compatible with HC4 & HC4R frames.	<b>12</b> =1000, 1500, 2000 lumens (nominal). For use with HC410*, HC415*, HC420* frames. <b>34</b> =3000, 4000 lumens (nominal). For use with HC430* and HC440* frames.	<b>827</b> =80CRI / 2700K <b>830</b> =80CRI / 3000K <b>835</b> =80CRI / 3500K <b>840</b> =80CRI / 4000K <b>927</b> =90CRI / 2700K <b>930</b> =90CRI / 3000K <b>935</b> =90CRI / 3500K <b>940</b> =90CRI / 4000K	<b>HB128APK</b> = L channel hanger bar, 26", pair (replacement) <b>RMB22</b> = Adjustable wood joist mounting bars, pair, extend to 22" long <b>H347</b> = 347 to 120V step down transformer, 75VA <b>H347200</b> = 347 to 120V step down transformer, 200VA <b>WTA</b> =Field installed WaveLinX sensor Kit (1) (5) <b>WTK</b> = Field installed WaveLinX Lite Sensor Kit (6)
<b>Notes:</b> <b>1.</b> Not available with CP version <b>2.</b> ULus for U.S. only <b>5.</b> WTA = WaveLinX tile mount sensor kit for daylight dimming, PIR motion sensing, and optional RLTS - RealTime Location Services, use with D010 only (Refer to WaveLinX system specifications) <b>6.</b> WTK = WaveLinX Lite tile mount sensor kit for daylight dimming, PIR motion sensing, use with D010 only (Refer to WaveLinX Lite system specifications)			



Precision formed 4-inch reflectors designed to deliver narrow, medium and wide beam distributions. A non-conductive polymer reflector may be used to meet 'dead-front' requirements.

Reflector	Beam Distribution <sup>3</sup>	Finish	Flange	Accessories
<b>41</b> = 4" conical reflector	<b>ND</b> = narrow (53°, 0.84 SC) <b>MD</b> = medium (61°, 1.00 SC) <b>WD</b> = wide (76°, 1.24 SC) <b>RWW</b> = rotatable wall wash with linear spread lens	<b>C</b> = Specular clear <b>H</b> = Semi-specular clear (haze) <b>W</b> = Matte white (white flange)	<b>Blank</b> = Polished flange on C, H reflectors <b>Blank</b> = White flange on W reflectors <b>WF</b> = White flange option for C & H reflectors	<b>41RWWPK</b> = 4" rotatable wall wash insert, replacement part kit
Baffle	Beam Distribution <sup>3</sup>	Finish	Flange	Accessories
<b>41</b> = 4" baffle reflector	<b>WD</b> = wide (75°, 1.24 SC) <b>RWW</b> = rotatable wall wash with linear spread lens	<b>BB</b> =black baffle (white flange) <b>WB</b> =white baffle (white flange)	<b>Blank</b> = White flange on BB & WB <b>BF</b> = Black flange option available with BB	<b>41RWWPK</b> = 4" rotatable wall wash insert, replacement part kit
IEM Reflector	Beam Distribution <sup>3</sup>	Finish	Flange	Integral Emergency
<b>41</b> = 4" conical reflector for integral emergency only	<b>ND</b> = narrow (53°, 0.84 SC) <b>MD</b> = medium (61°, 1.00 SC) <b>WD</b> = wide (76°, 1.24 SC)	<b>C</b> = Specular clear <b>H</b> = Semi-specular clear (haze) <b>W</b> = Matte white (white flange)	<b>Blank</b> = Polished flange on C, H reflectors <b>Blank</b> = White flange on W reflectors <b>WF</b> = White flange option for C & H reflectors	<b>IEM</b> = Reflector for integral emergency only
IEM Baffle	Beam Distribution <sup>3</sup>	Finish	Flange	Integral Emergency
<b>41</b> = 4" conical reflector for integral emergency only	<b>WD</b> = wide (76°, 1.24 SC)	<b>BB</b> =black baffle (white flange) <b>WB</b> =white baffle (white flange)	<b>Blank</b> = White flange on BB & WB <b>BF</b> = Black flange option available with BB	<b>IEM</b> = Reflector for integral emergency only
Reflector	Beam Distribution <sup>3</sup>	Finish	Flange	
<b>41PS</b> = 4" non-conductive polymer 'dead-front' conical reflector <sup>4</sup>	<b>MD</b> = medium (61°, 1.00 SC)	<b>W</b> = Matte white (white flange)	<b>Blank</b> = White flange on W reflector	

**1.** Not available with CP version **2.** ULus for U.S. only **3.** Values are nominal for white reflector, others may vary. **4.** 41PS reflector only available in NON-IC environments and up to 3000 lumens.

# Energy Data - HC4 Series

Nominal Lumens Model Number	1000 lumen HC410		1500 lumen HC415		2000 lumen HC420		3000 lumen HC430		4000 lumen HC440	
LED Module	Low Lumen Module		Low Lumen Module		Low Lumen Module		High Lumen Module		High Lumen Module	
Input Voltage 120-277VAC	120V	277V	120V	277V	120V	277V	120V	277V	120V	277V
Current (A)	0.085	0.042	0.119	0.055	0.176	0.082	0.228	0.102	0.345	0.15
Power (W)	10.1	10.9	14.2	14.9	21.1	21.4	27.2	27	41.3	40.7
In-rush (A)	0.644	1.95	0.212	0.85	0.588	0.624	0.898	1.7	1.05	2.23
In-rush Duration (ms)	0.125	0.24	0.28	0.32	0.3	0.38	0.36	0.38	0.32	0.34
THD (%)	8.6	15.6	7.8	16.3	8.8	11.2	9.7	9.3	10.06	14.01
PF ≥	≥ 0.90									
Minimum starting temperature	-40 C (-40 F)									

# Dimensions - HC4 Series

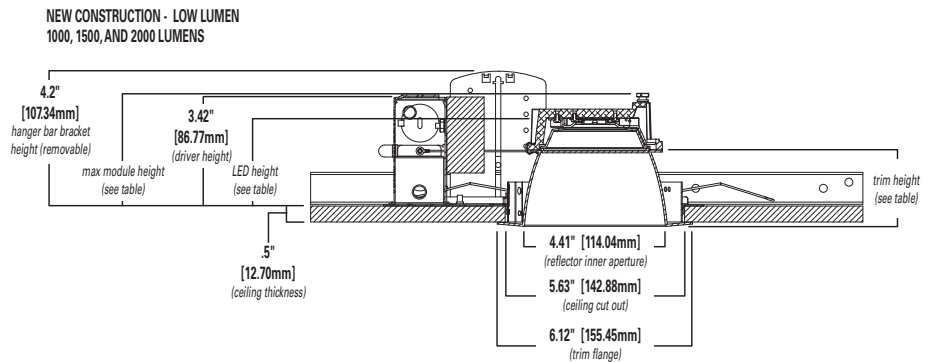
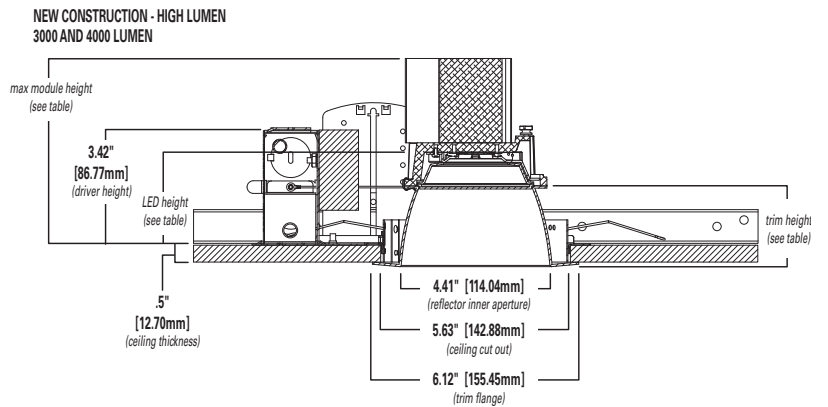
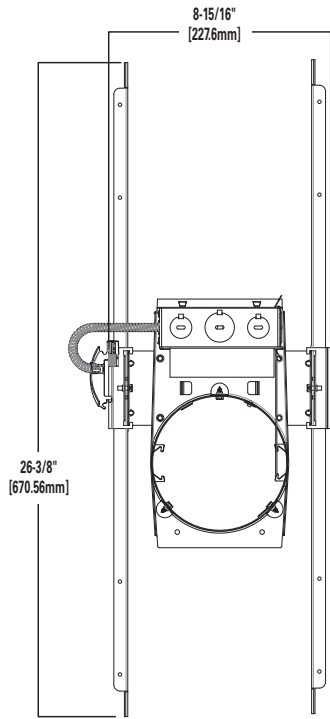

High Lumen (3000 & 4000 Lumens)

Distribution	Max. Module Height	Trim Height	LED Height
Narrow	5.6"	2.5"	2.9"
Medium	5.7"	2.6"	3.0"
Wide	5.5"	2.4"	2.8"
Baffle	5.5"	2.4"	2.8"

Low Lumen (1000, 1500 & 2000 Lumens)\*

Max. Module Height	Trim Height	LED Height
3.6"	2.5"	2.7"
3.7"	2.6"	2.8"
3.5"	2.4"	2.6"
3.1"	2.4"	2.6"

\*Max. height w/hanger bar bracket 4.2"

# 4" HC4R LED Retrofit Downlight

4-inch aperture LED retrofit downlight is designed for installation into other 4.75" (4-3/4") to 4.875" (4-7/8") nominal aperture commercial housings. The retrofit reflector offered in medium distribution is ideal for general area lighting. Lumen packages range 1000 to 4000 lumens (nominal) in color temperatures of 2700K, 3000K, 3500K, and 4000K; in 80 or 90CRI. Installs from below the ceiling into existing open frame recessed housings. Applications include office spaces, healthcare, hospitality, and other institutional uses.

**Sample Number:** HC410D010REM7 - HM412830 - 41NDC

A complete luminaire consists of a mounting frame, LED module, and reflector (order separately)

## 120-277VAC, 0-10V analog dimming

Mounting Frame	Lumens	Driver	Options
<b>HC4R</b> = 4" retrofit kit for 4.75" (4-3/4") to 4.875" (4-7/8") nominal aperture existing open frame commercial housings	<b>Fixed, Factory Set</b> <b>10</b> = 1000 lumens (nominal), use with HM412 module <b>15</b> = 1500 lumens (nominal), use with HM412 module <b>20</b> = 2000 lumens (nominal), use with HM412 module <b>30</b> = 3000 lumens (nominal), use with HM434 module <b>40</b> = 4000 lumens (nominal), use with HM434 module	<b>D010</b> =120-277VAC 50/60Hz 0-10V analog 1% - 100% dimming <b>D010347</b> = 347VAC 50/60Hz 0-10V analog 1%-100% dimming (Canada only)	<b>REM7</b> = integral 7 watt emergency module with remote test / indicator light, for use with D010 only <b>REM14</b> = integral 14 watt emergency module with remote test / indicator light, for use with D010 only <b>BOD7ST</b> = 7.5 watt Bodine self-test diagnostic emergency module with remote test / indicator light, use with D010 only <b>WTA</b> =Factory installed WaveLinX sensor Kit <sup>2</sup> <b>WTK</b> = Factory installed WaveLinX Lite Sensor Kit <sup>3</sup>

LED Module	Lumens	CRI/CCT	Accessories
<b>HM4</b> = 4" LED module  Compatible with HC4 & HC4R frames.	<b>12</b> =1000, 1500, 2000 lumens (nominal). For use with HC4R10*, HC4R15*, HC4R20* frames. <b>34</b> =3000, 4000 lumens (nominal). For use with HC4R30* and HC4R40* frames.	<b>827</b> =80CRI / 2700K <b>830</b> =80CRI / 3000K <b>835</b> =80CRI / 3500K <b>840</b> =80CRI / 4000K <b>927</b> =90CRI / 2700K <b>930</b> =90CRI / 3000K <b>935</b> =90CRI / 3500K <b>940</b> =90CRI / 4000K	<b>H347</b> = 347 to 120V step down transformer, 75VA <b>H347200</b> = 347 to 120V step down transformer, 200VA <b>WTA</b> =Field installed WaveLinX sensor Kit <sup>2</sup> <b>WTK</b> = Field installed WaveLinX Lite Sensor Kit <sup>3</sup>

Reflector	Beam Distribution <sup>1</sup>	Finish	Flange
<b>42R</b> = 4" retrofit conical reflector, for use with HC4R frame/ collar only	<b>MD</b> = medium (66°, 1.15 SC)	<b>C</b> = Specular clear <b>H</b> = Semi-specular clear (haze) <b>W</b> = Matte white (white flange)	<b>Blank</b> = Polished flange on C, H reflectors <b>Blank</b> = White flange on W reflectors <b>WF</b> = White flange option for C & H reflectors

1. Values are nominal for white reflector, others may vary.

2. WTA = WaveLinX tile mount sensor kit for daylight dimming, PIR motion sensing, and optional RLTS - Real Time Location Services, use with D010 only (Refer to WaveLinX system specifications)

3. WTK = WaveLinX Lite tile mount sensor kit for daylight dimming, PIR motion sensing, use with D010 only (Refer to WaveLinX Lite system specifications)

## Dimensions - HC4R Series

RETROFIT - LOW LUMEN  
1000, 1500, AND 2000 LUMENS

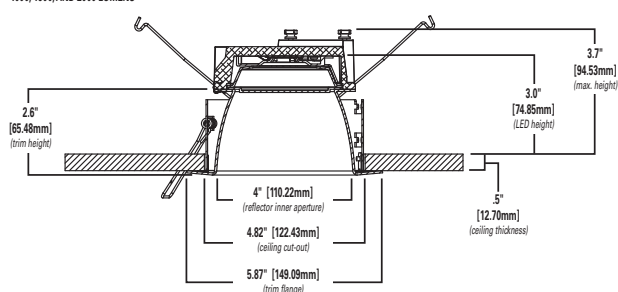

RETROFIT - HIGH LUMEN  
3000 AND 4000 LUMENS

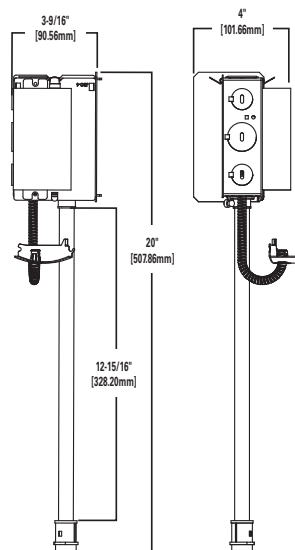
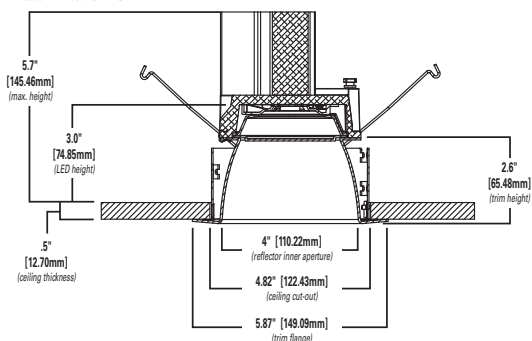

# Connected Systems



## WaveLinX Lite - WTK Tilemount Sensor

- Intuitive Android™ or Apple® iOS® app for basic system code compliant set up and configuration via Bluetooth
- Up to 28 unique areas per project site (WaveLinX Lite Bluetooth network)
- Up to 50 devices for an area, any one of 16 control zones, up to 6 occupancy sets, and custom lighting scenes
- Automatic occupancy or vacancy, sensor sensitivity, daylight dimming, etc. configurable through the app
- Refer to the WaveLinX system specifications for details



### WaveLinX Lite WTK Tilemount Wiring Diagram

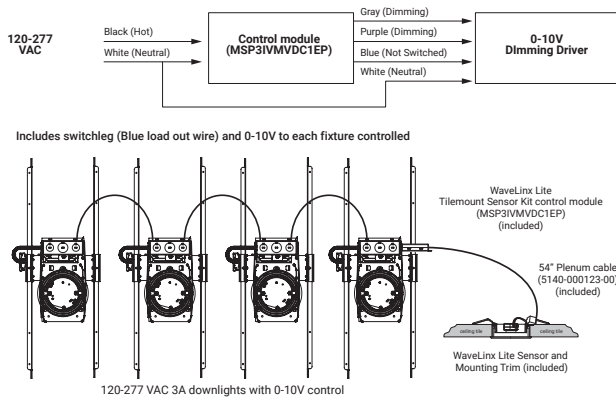

### WaveLinX Lite Bluetooth Enabled System

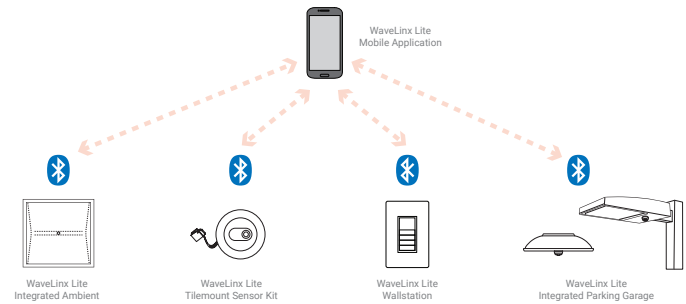

## WaveLinX Wireless – WTA Tilemount Sensor

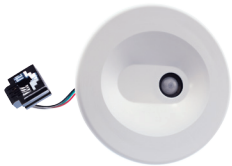

- WaveLinX Wireless functionality configures zones and customizes settings from one secure mobile app
- Automatic code commissioning that meets the strictest codes
- Fixtures and sensors integrate with Wireless Area Controller, Wall Stations, and Control Devices
- Stand-Alone Offices or Entire Building Network Installations



### WaveLinX mobile app settings

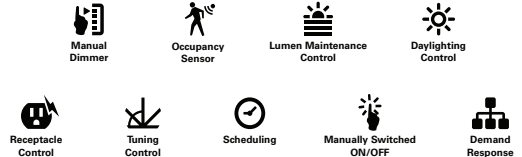

### WaveLinX Lite WTA Tilemount Wiring Diagram

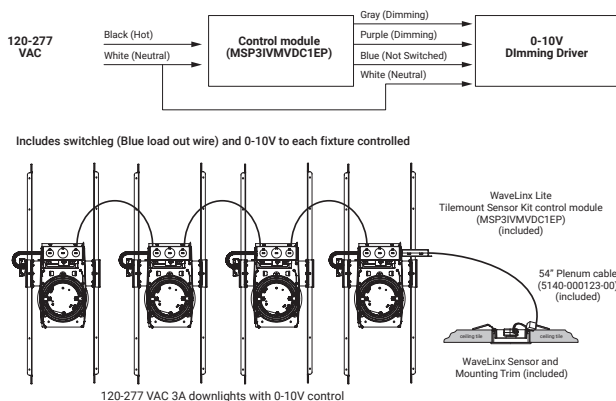

### WaveLinX Wireless Trellix Building Management Integration

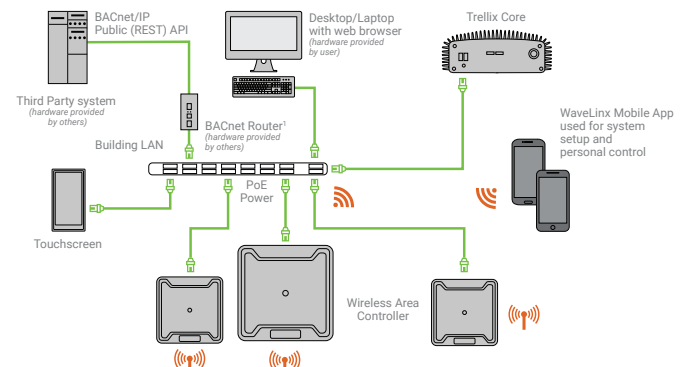



# HALO Commercial



## Efficiency + Value

Halo Commercial achieves the perfect balance of optical control and efficiency to deliver lower watts per square foot in meeting commercial lighting energy codes and provide uniform beam distributions.

Design/build, tenant improvement, hospitality and institutional projects will appreciate the Halo Commercial balance of performance and budget-minded design.

### Contractor and Distributor Friendly

- Housings ship complete with No-Fuss bar hangers (no additional bars or C-channel to assemble)
- No-Fuss bars lock to T-grid by quick bend of a screwdriver or pliers (no screws to secure to grid)
- Boat-shaped plaster frame offers versatility in new construction and "old-work" remodeling
- Oversized junction box with 1/2" and 3/4" trade size pry-outs ships with quick wiring connectors
- Junction box low voltage section provides code-required barrier for 0-10V dimmer wiring
- Plaster lip collar is preset for 1/2" ceiling material, and adjusts up to 1-1/2"

### Performance and Efficiency

- Reflector designs optimized for greater optical efficiency (lumen delivery) and beam distribution
- Greater efficiency allows maximized fixture spacing with good uniformity
- Maximized spacing achieves desired watts per square foot (fewer fixtures = less power)
- Control from industry standard 120V-277V, 0-10V 1% dimmable LED driver
- Optional connected lighting control with Distributed Low Voltage Power system (DLVP) and WaveLinx

### Product Mix

- Mainstream offering meets market demand in 4-inch, 6-inch, and 8-inch downlights
- PR series offers contractors versatility of lumen and LED color select-ability on-site
- HC series offers discrete selection of lumen and LED color for design/build and tenant improvement projects

### Lighting Product Lines

Ametrix  
AtLite  
Corelite  
Ephesus  
Fail-Safe  
HALO  
HALO Commercial  
Invue  
io  
IRiS  
Lumark  
Lumière  
McGraw-Edison  
Metalux  
MWS  
Neo-Ray  
Portfolio  
RSA  
Shaper  
Streetworks  
Sure-Lites

### Controls Product Lines

Greengate

### Connected Lighting Systems

Fifth Light (Canada Only)  
HALO Home  
WaveLinx

### IoT Platform

Trellix



**Cooper Lighting Solutions**  
1121 Highway 74 South  
Peachtree City, GA 30269  
P: 770-486-4800  
[www.cooperlighting.com](http://www.cooperlighting.com)

**Canada Sales**  
5925 McLaughlin Road  
Mississauga, Ontario L5R 1B8  
P: 905-501-3000  
F: 905-501-3172

© 2020 Cooper Lighting Solutions  
All Rights Reserved  
Printed in USA  
Publication No. BR517008EN  
April 13, 2021 1:04 PM

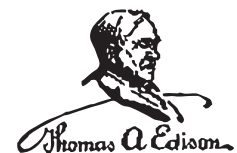

All other trademarks are property of their respective owners.

Product availability, specifications, and compliances are subject to change without notice.