

Project		Catalog #		Type	
Prepared by		Notes		Date	

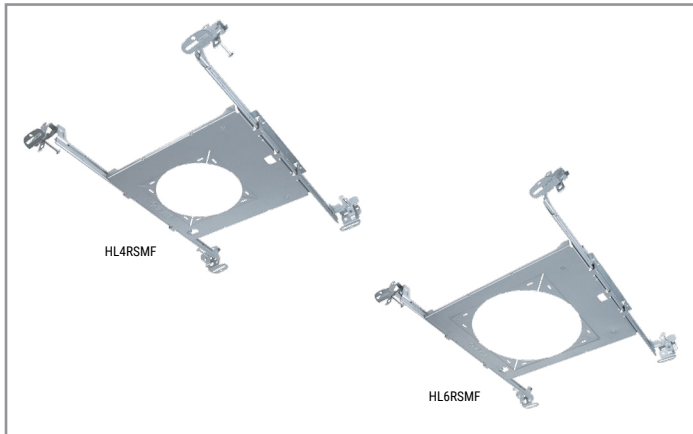

HALO

HL4RSMF | HL6RSMF

4" & 6" Mounting Frame for Round or Square Fixture Fittings

Typical Applications

Office • Healthcare • Hospitality • Institutional • Mixed-Use/Retail • Residential

Interactive Menu

- Order Information page 2
- Photometric Data page 2
- Control Solutions
- Connected Systems
- Product Warranty

Top Product Features

- Mounting frames accept "install from below" fixture fittings
- Reserve the ceiling location, provide routing guidance for the drywall contractor
- Knock-outs allow the frame to accept square fittings
- Use to meet local code requirements where install from below fixtures must be supported directly by building structure

Dimensional and Mounting Details

HL4RSMF

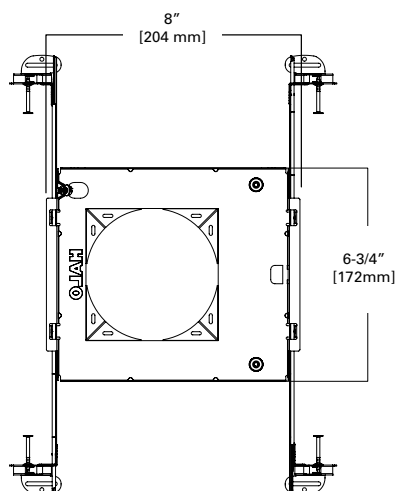

HL6RSMF

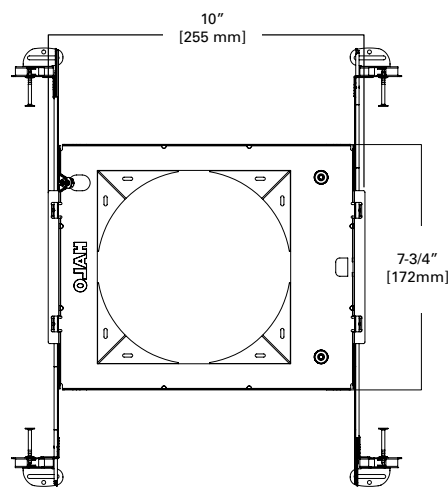

 additional product diagrams

Order Information

Housing	Compatible Fixture Fittings (Sold Separately)
HL4RSMF = 4-inch round or square mounting frame	HALO - HLA4, HLA4S, HLB4, HLB4S, HLB4SP, RL4*DM, H245RICAT
HL6RSMF = 6-inch round or square mounting frame	HALO - HLB6, HLB6S, RL6*DM HALO Commercial - PR6R*, HC56R*

Product Specifications

Mounting Frame

- Galvanized steel mounting frame with offset aperture and integral bar hanger receivers
- Locking screws provide positive horizontal locking
- Provides tool-less attachment of remote driver / junction box
- Break-outs allow the frame to accept square fittings, cannot be reverted to accepting round after the break-outs are removed

Bar Hangers

- GOT NAIL! Gen 3 bar hangers adjust from 8" to 24" wide
- Pass thru feature allows shortening without removal
- Captive nail penetrates standard and engineered lumber
- Mounting flange levels platform with ceiling
- Integral clip attaches directly to tee-bar.

Compliance

- Can be used to meet local code requirements where install from below fixture fittings must be supported directly by building structure

Warranty

- One year limited warranty, consult website for details. www.cooperlighting.com/legal

Dimensional and Mounting Details

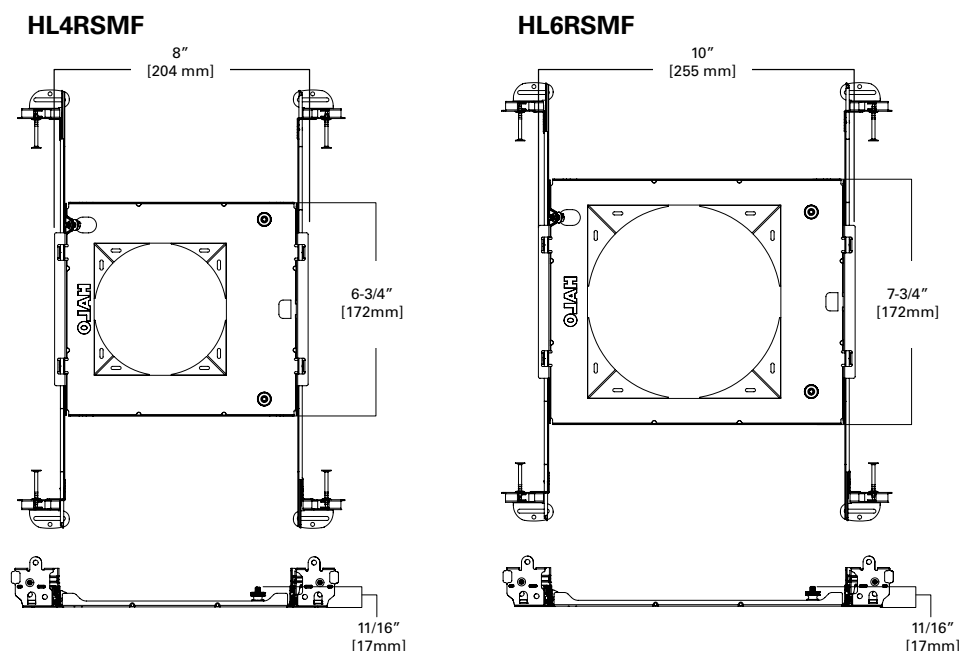

Remote driver / junction box attached

