

DESCRIPTION

The Paralux III Series features recessed aesthetics and the latest in energy efficient technology. The luminaire incorporates a nominal 3" deep precision cell louver into a 4-3/4" deep para-contoured fixture housing. This combination creates a total high performance parabolic optical assembly for optimum performance. The series is compatible with all of today's popular ceiling systems and is available with a number of options and accessories for application versatility. The high performance luminaire is designed to offer maximum efficiency and performance for today's unique interior specifications. The Paralux III series is an excellent choice for commercial office spaces, schools, hospitals or retail merchandising areas.

SPECIFICATION FEATURES

Construction

4-3/4" deep, para-contoured housing, die formed of code gauge, prime cold rolled steel. Die embossed housing has full length die formed stiffeners for added strength. Contoured ballast/wireway cover is easily removed. Die formed captive lampholder bracket fully encloses lampholder wiring permitting easy lampholder replacement. Heavy gauge end plates are securely attached with interlocking tabs and screws. Four auxiliary fixture end suspension points provided. KOs for continuous row wiring. End plates have integral Grid-Lock feature for safety and convenience.

Electrical**

Ballast are CBM/ETL Class "P" and are positively secured by mounting bolts. Pressure lock lampholders. UL/CUL listed. Suitable for damp locations.

Finish

Lighting grade, baked white enamel finish. Multistage, iron phosphate pretreatment ensures maximum bonding and rust inhibition.

Hinging/Latching

Positive spring loaded, self locking, steel latches. Safety lock T-hinges allow hinging and latching from either side.

Louver

Die formed of low iridescent, vertical grain anodized aluminum. Finish is Anodic oxide coating. Accurate precision parabolic cells are held in place with interlocking feature. True-cut mitered corners. Black reveal with integral mechanical light seal around entire perimeter of louver. Louver protected from construction contaminants by polyethylene cover.

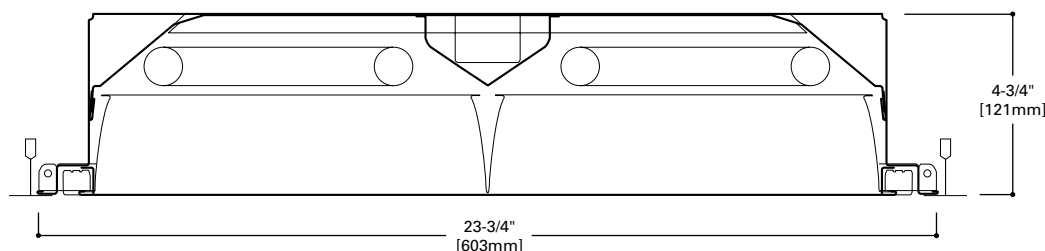

MOUNTING DATA

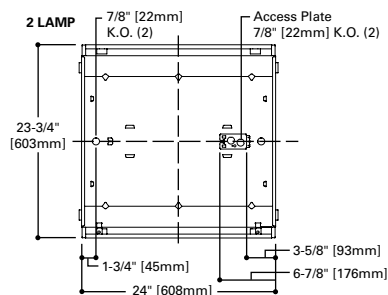

LAMP CONFIGURATIONS

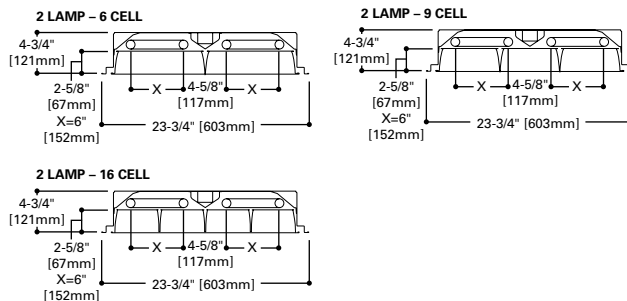

CEILING COMPATIBILITY

G	G	G	F	MZ	Ceiling Type	Trim Type
Grid/Lay-in Standard	Concealed T	Slot Grid	Aluminum Flange Trim With Supporting Swing Gates	Modular Trim With Supporting Swing Gates	Exposed Grid	G
					Concealed T	G
					Slot Grid	G
					Flange	F
					Concealed "T" or "Z"	MZ
					Metal Pan	MZ
					(Verify compatibility/ consult factory.)	



2EP3GAX
2U6T8

6, 9, 16 Cell

2' X 2' PARABOLIC
2-U LAMPS
SEMI-SPECULAR, SPECULAR
OR WHITE PAINTED LOUVER

Paralux III
Recessed Static or Air
Supply Troffer

ENERGY DATA

Input Watts:
EB Ballast & STD Lamps
2U6T8 (61)

Luminaire Efficacy Rating
LER = FP-52
Catalog Number: 2EP3GAX-332
Yearly Cost of 1000 lumens,
3000 hrs at .08 KWH = \$4.62

**Reference the lamp/ballast data in the Technical Section for specific lamp/ballast requirements.

LAMPS CONTAIN MERCURY. DISPOSE ACCORDING TO LOCAL, STATE OR FEDERAL LAWS

LINEAR DISCONNECT

Safe and convenient means of disconnecting power.

PHOTOMETRICS

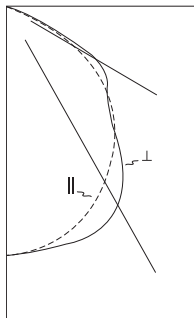

2EP3GAX-2U6T8S23I
Electronic Ballast

FB31T8/35K/6 Lamps
2600 Lumens

Spacing criterion:
(||) 1.2 x mounting
height, (\perp) 1.3 x
mounting height
Efficiency 63.8%

Test Report:
2EP3GAX2U6T8S23LIES

LER = FP-52

Yearly Cost of 1000 lumens, 3000 hrs at .08 KWH = \$4.62

Coefficients of Utilization

Effective floor cavity reflectance										20%									
rc	80%				70%				50%			30%			10%			0%	
rw	70	50	30	10	70	50	30	10	50	30	10	50	30	10	50	30	10	0	
RCR																			
0	76	76	76	76	74	74	74	74	71	71	71	68	68	68	65	65	65	64	
1	71	68	66	64	69	67	65	63	64	62	61	62	60	59	59	58	57	56	
2	65	60	57	53	63	59	56	53	57	54	52	55	53	51	53	51	49	48	
3	60	54	49	45	58	53	48	45	51	47	44	49	46	43	48	45	43	41	
4	55	48	43	39	53	47	42	39	45	41	38	44	40	38	43	40	37	36	
5	51	43	38	34	49	42	37	33	41	36	33	40	36	33	39	35	32	31	
6	47	39	33	29	46	38	33	29	37	32	29	36	32	29	35	31	29	27	
7	43	35	30	26	42	35	30	26	34	29	26	33	29	26	32	28	25	24	
8	40	32	27	23	39	32	27	23	31	26	23	30	26	23	29	26	23	22	
9	38	29	24	21	37	29	24	21	28	24	21	28	24	21	27	23	21	20	
10	35	27	22	19	35	27	22	19	26	22	19	26	22	19	25	21	19	18	

Zonal Lumen Summary

Zone	Lumens	%Lamp	%Fixture
0-30	1067	20.5	32.2
0-40	1717	33.0	51.8
0-60	2984	57.4	90.0
0-90	3317	63.8	100.0
0-180	3317	63.8	100.0

Typical VCP Percentages

Room Size (Ft.)	Height Along		Height Across	
	8.5'	10.0'	8.5'	10.0'
20 x 20	72	67	65	60
30 x 30	79	73	75	69
30 x 60	83	78	79	74
60 x 30	82	78	78	73
60 x 60	85	82	82	78

Candela

Angle	Along II	45°	Across II
0	1314	1314	1314
5	1303	1311	1319
10	1274	1304	1338
15	1234	1300	1371
20	1188	1293	1383
25	1129	1266	1330
30	1066	1210	1174
35	990	1089	998
40	909	920	902
45	812	773	880
50	708	698	924
55	586	647	950
60	422	547	754
65	204	327	327
70	65	102	100
75	21	25	26
80	7	9	10
85	4	4	4
90	0	0	0

ORDERING INFORMATION

SAMPLE NUMBER: 2EP3GAX-2U6T8S23I-UNV-EB81-U

[illegible]

NOTES: ⁽¹⁾ Integral end plate grid lock feature not available in heat removal. ⁽²⁾ An EQ Grid Clip is recommended for all 9/16" ceiling systems. Four required per fixture. ⁽³⁾ Products also available in non-US voltages and frequencies for international markets. ⁽⁴⁾ Not available when specifying emergencies, voltage must be specific. ⁽⁵⁾ Fixtures equipped with "EL" option may require a 5-1/2" housing depth. If installing in field, must use low profile battery pack. ⁽⁶⁾ Louver is recessed by 5/16" in Concealed T or Slot Grid T. ⁽⁷⁾ Specify row configuration, type in catalog number when ordering complete fixture. ⁽⁸⁾ Please specify required voltage, 120V or 277V.

Specifications & dimensions subject to change without notice. Consult your Cooper Lighting Solutions Representative for availability and ordering information.

ACCESSORIES

EQ-CLIP-U=T-BAR Safety Earthquake Clips⁽²⁾

SHIPPING DATA

Catalog No.	Wt.
2EP3GAX-2U6T8S23I	28 lbs.
2EP3GAX-2U6T8S33I	28 lbs.
2EP3GAX-2U6T8S44I	28 lbs.