

DESCRIPTION

Circadian LED nightlights and chart lights bring soft, low level illumination to any environment. Fitting into a standard junction box (single-gang, handy box, 2" minimum inside width) for easy installation, the MSN, MHN and MLN operate on 120-277V, delivering up to 30 lumens of illumination. The MCL Chart Light has an illuminated push-button switch (120V only). Depress the switch to energize the unit. Also, an accessory Thru Wall Junction Box is available, that accommodates wall thickness from 3 1/2" to 6", and uses two Circadian night lights.

SPECIFICATION FEATURES

Mounting / Installation

Fits into standard junction box for easy installation (single-gang, handy box, 2" minimum inside width).

Faceplate

Unique faceplate design distributes light evenly. Die-cast aluminum louvered or scoop faceplates. White painted faceplate standard; black and brushed nickel paint options available. Anti-microbial matte white paint also available.

Lens

MSN/MLN/MHN: 4 lenses accompany each unit and are quickly and easily field-installable. Lenses are 0.040" thick polycarbonate, and are clear, amber, red, and blue colors. Install the lens choice based on the desired color of illumination. MCL: Clear acrylic lens, 0.040" thick. Thru Wall Junction Box Night lights (2) fit into the galvanized steel junction box. Order on a separate line item.

Wattage

<5 input watts.

Labels

- MLN, MHN: Wet location listed.
- MSN: Wet location listed above 4' mounting height.
- MCL: Dry location listed.

MLN

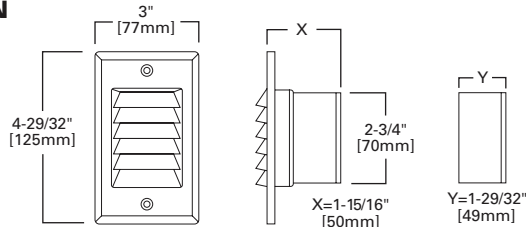

MHN

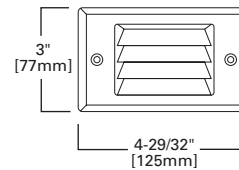

MCL

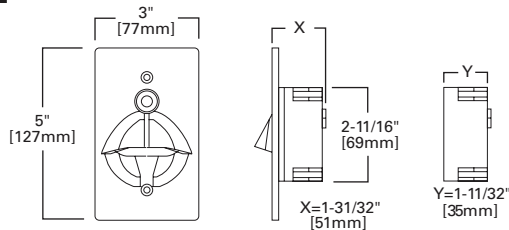

MSN

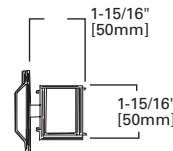
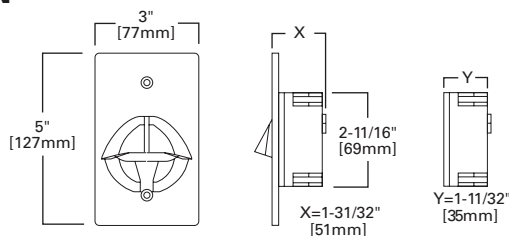

For retrofit applications, check width, height and depth of existing junction box. Requires 2" minimum inside width.

SPECIFICATIONS

	MLN / MHN	MCL / MSN
Illumination	Minimum 30 Lumens	Minimum 30 Lumens
Input Wattage	< 5 Watts	< 5 Watts
Face Plate	Die-cast aluminum	Die-cast aluminum
Code Compliance	UL 1598	UL 1598
Input Voltage	120-277V	MSN - 120-277V MCL - 120V Only
Mounting / Installation	Single-gang junction box (2" minimum inside width)	Single-gang junction box (2" minimum inside width)
Labels	ETL listed	ETL listed - MSN, UL listed - MCL



MLN / MHN (120 - 277V)
(MHN not shown - see line drawing)



MSN (120 - 277V)



MCL (120V only)

CIRCADIAN UNV

LED
Healthcare: Patient

MSN
MCL
MHN
MLN
TWJB

ORDERING INFORMATION

UNIVERSAL VOLTAGE: MHN / MLN / MSN

SAMPLE NUMBER: MSN-UNV-W

UNV			
Product Family MHN = Medical Horizontal Louver ^{1, 2} MLN = Medical Louver Nightlight ^{1, 2} MSN = Medical Scoop Nightlight ^{1, 2}	Voltage UNV =120-277V NOTES: ¹ Wet location standard on MLN, MHN and MSN. ² Product ships standard with white (4000K) LEDs and a clear polycarbonate lens. Colored lenses ship with each fixture, to field-convert the white color to amber, red or blue - by replacing the clear lens with the lens of choice.	Faceplate Finish W =White Paint B =Black Paint BN =Brushed Nickel Paint AMW =Anti-microbial White, Matte Finish Custom Colors available (specify or supply sample - consult factory)	Options TP =Tamper-resistant Screws

MCL ORDERING INFORMATION

120V MCL

SAMPLE NUMBER: MCL-W-120-W

MCL			
Product Family MCL = Medical Chart Nightlight	LED Color W =White A =Amber	Voltage 120 =120V	Faceplate Finish W =White Paint B =Black Paint BN =Brushed Nickel Paint AMW =Anti-microbial White, Matte Finish Custom Colors available (specify or supply sample - consult factory)
Options PHC =Photocell (in place of standard on/off switch) ¹ TP =Tamper-resistant Screws			

NOTES:

¹ The MCL version of Circadian is supplied with a photo optic cell which turns the light source (LED) off when the ambient light rises above the MCL set point or threshold. In a very limited number of applications, where the sustained ambient light is at or near the MCL set point, the user may experience "flickering" of the light. To avoid "flickering", do not install the MCL in areas such as in dark shadows or dark corners. Should flickering occur, relocate the MCL to an area of higher ambient light.

THRU WALL JUNCTION BOX (ORDER ON SEPERATE LINE ITEM)

Order as "TWJB"

Use (1) TWJB with (2) Circadian night lights
 TWJB can be rotated 90° and be used with the MHN

