



Door-coupling rotary operating mechanism IP64 for circuit breaker Size S00...S3, 130 mm shaft as 3RV29260B, but for switch installation rotated by 90° , same position of the cover inscription OFF = left, ON = top

### General technical data:

Product brand name		SIRIUS
Product designation		door-coupling rotary operating mechanism
Size of the circuit-breaker		S00, S0, S2, S3
Design of the product		standard
Control version of the switch operating mechanism		short shaft twisted 90°
Suitability for use		Circuit breaker S00, S0, S2, S3
Protection class IP on the front		IP64
Ambient temperature		
• during storage	°C	-50 ... +80
• during operation	°C	-20 ... +70
Operating frequency maximum	1/h	15
Color of the actuating element		black

### Installation/ mounting/ dimensions:

Mounting position		any
Mounting type		screw fixing
Width	mm	66
Height	mm	66
Depth	mm	50

Length	mm	130
Diameter	mm	22.5
Required spacing for grounded parts		
• forwards	mm	0
• Backwards	mm	0
• upwards	mm	0
• at the side	mm	0
• downwards	mm	0

#### Certificates/ approvals:

Certificate of suitability

CE / UL / CSA

General Product Approval	Shipping Approval	other
--------------------------	-------------------	-------



[Confirmation](#)



#### Further information

Information- and Downloadcenter (Catalogs, Brochures,...)

<http://www.siemens.com/industrial-controls/catalogs>

Industry Mall (Online ordering system)

<http://www.siemens.com/industrymall>

Cax online generator

<http://support.automation.siemens.com/WW/CAXorder/default.aspx?lang=en&mlfb=3RV2926-0BA00>

Service&Support (Manuals, Certificates, Characteristics, FAQs,...)

<https://support.industry.siemens.com/cs/ww/en/ps/3RV2926-0BA00>

Image database (product images, 2D dimension drawings, 3D models, device circuit diagrams, EPLAN macros, ...)

[http://www.automation.siemens.com/bilddb/cax\\_de.aspx?mlfb=3RV2926-0BA00&lang=en](http://www.automation.siemens.com/bilddb/cax_de.aspx?mlfb=3RV2926-0BA00&lang=en)

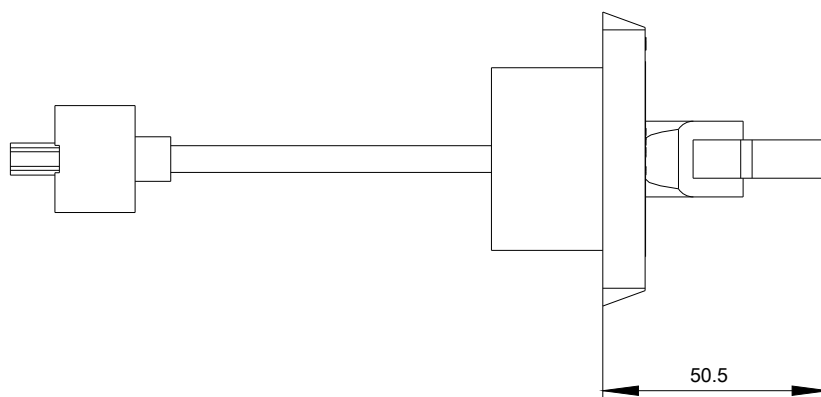
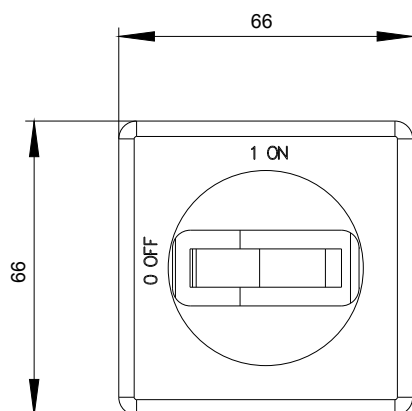

last modified:

10/31/2018