



ASISAFE BASIC SAFETY MONITOR 2 F-RO, 2 ENABLING CIRCUITS, IP20, WITH SCREW-TYPE TERMINALS (REMOVABLE), SAFE OUTPUT RELAY RESPONSE TIME MAX. 40 MS, MONITOR TYPE 2, VERSION 3, APPLICABLE UP TO CATEGORY 4 (EN 954-1), UP TO PL E (EN ISO 13849-1), UP TO SIL 3 (IEC 61508), FOR AS-INTERFACE / AS-I SAFETY AT WORK

General technical data:

Design of the product		safety monitor
Protocol is supported AS-interface protocol		Yes
Type		2 enabling circuits
Number of release circuits		2
Response time max.	ms	40
Type of electrical connection of the inputs and outputs		screw terminal
Rated operational current I_e		
<ul style="list-style-type: none"> • AC-12, 50/60 Hz 250 V 	A	3
<ul style="list-style-type: none"> • AC-15, 50/60 Hz 		
— 115 V	A	3
— 230 V	A	3
<ul style="list-style-type: none"> • DC-12 (DC-1) 24 V 	A	3
<ul style="list-style-type: none"> • DC-13 (DC-11) 		
— 24 V	A	1
— 115 V	A	0.1
— 230 V	A	0.05
Equipment marking acc. to DIN 40719 extended according to IEC 204-2 acc. to IEC 750		A
Equipment marking acc. to DIN EN 61346-2		F

Ambient conditions:

Ambient temperature		
<ul style="list-style-type: none"> • during operation 	°C	-20 ... +60
<ul style="list-style-type: none"> • during storage 	°C	-30 ... +70

Protection class IP		IP20
---------------------	--	------

Mechanical data:

Width	mm	45
Height	mm	108
Depth	mm	120
Mounting type		screws / standard rail

Certificates/ approvals:

General Product Approval	Functional Safety/Safety of Machinery
--------------------------	---------------------------------------



[Type Examination Certificate](#)

Declaration of Conformity	Shipping Approval
---------------------------	-------------------



Shipping Approval	other
-------------------	-------



[Declaration of Conformity](#)

[Environmental Confirmations](#)

[Confirmation](#)

Further information

Information- and Downloadcenter (Catalogs, Brochures,...)

<http://www.siemens.com/industrial-controls/catalogs>

Industry Mall (Online ordering system)

<http://www.siemens.com/industrymall>

Cax online generator

<http://support.automation.siemens.com/WW/CAXorder/default.aspx?lang=en&mlfb=3RK11051BE040CA0>

Service&Support (Manuals, Certificates, Characteristics, FAQs,...)

<https://support.industry.siemens.com/cs/ww/en/ps/3RK11051BE040CA0>

Image database (product images, 2D dimension drawings, 3D models, device circuit diagrams, EPLAN macros, ...)

http://www.automation.siemens.com/bilddb/cax_de.aspx?mlfb=3RK11051BE040CA0&lang=en

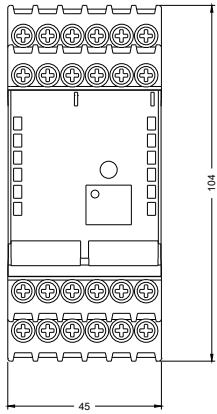

last modified:

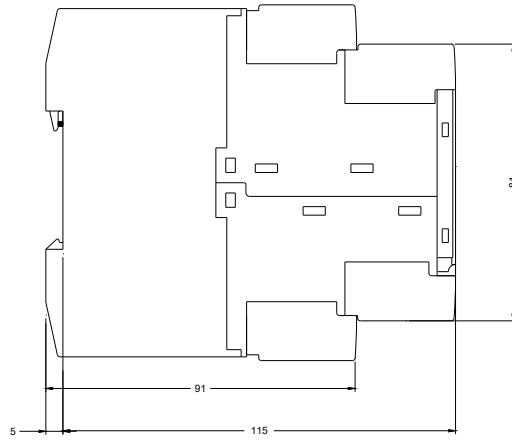

24.04.2015