

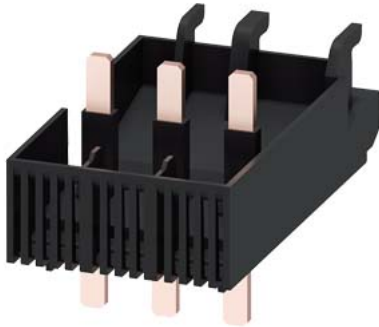





Link module Electrical and mechanical for 3RV2.3 and 3RT2.3. and soft starter 3RW303/3RW403 (individual unit packaging)



product brand name	SIRIUS
product designation	link module
<b>General technical data</b>	
product component bottom wiring module	No
product component top wiring module	No
size of the circuit-breaker	S2
size of contactor	S2
Substance Prohibittance (Date)	03/01/2017
number of poles	3
<b>Installation/ mounting/ dimensions</b>	
fastening method	screw fixing

<b>Approvals Certificates</b>	
<b>General Product Approval</b>	<b>Declaration of Conformity</b>
<a href="#">Confirmation</a> 	  <small>EG-Konf.</small>
	<a href="#">Type Test Certificates/Test Report</a> <a href="#">Special Test Certificate</a>

<b>Marine / Shipping</b>					
					

<b>Marine / Shipping</b>	<b>other</b>	<b>Railway</b>
 	<a href="#">Confirmation</a>	<a href="#">Vibration and Shock</a>

**Further information**

Siemens has decided to exit the Russian market (see here).  
<https://press.siemens.com/global/en/pressrelease/siemens-wind-down-russian-business>

Siemens is working on the renewal of the current EAC certificates.  
 Please contact your local Siemens office on the status of validity of the EAC certification if you intend to import or offer to supply these products to an EAC relevant market (other than the sanctioned EAEU member states Russia or Belarus).

**Information on the packaging**  
<https://support.industry.siemens.com/cs/ww/en/view/109813875>

Information- and Downloadcenter (Catalogs, Brochures,...)

<https://www.siemens.com/ic10>

Industry Mall (Online ordering system)

<https://mall.industry.siemens.com/mall/en/en/Catalog/product?mlfb=3RA2931-1AA00>

Cax online generator

<http://support.automation.siemens.com/WWW/CAXorder/default.aspx?lang=en&mlfb=3RA2931-1AA00>

Service&Support (Manuals, Certificates, Characteristics, FAQs,...)

<https://support.industry.siemens.com/cs/ww/en/ps/3RA2931-1AA00>

Image database (product images, 2D dimension drawings, 3D models, device circuit diagrams, EPLAN macros, ...)

[http://www.automation.siemens.com/bilddb/cax\\_de.aspx?mlfb=3RA2931-1AA00&lang=en](http://www.automation.siemens.com/bilddb/cax_de.aspx?mlfb=3RA2931-1AA00&lang=en)

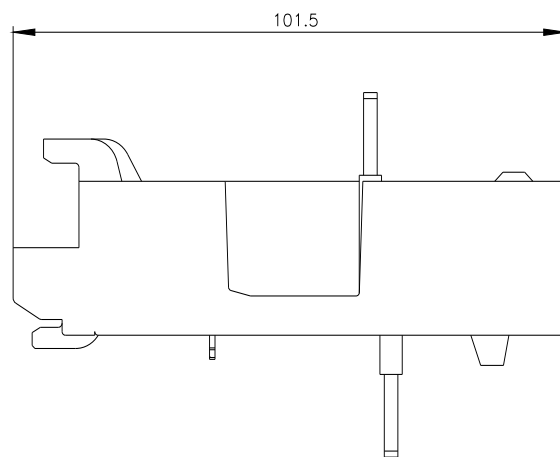
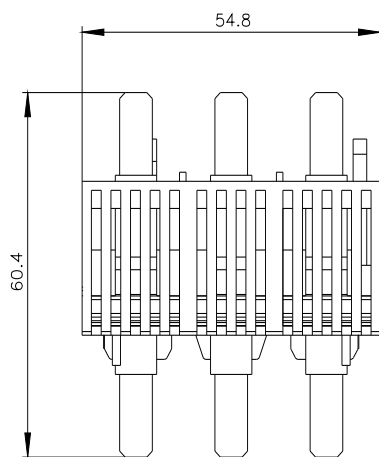

last modified:

6/17/2021 