









Overload relay 32...115 A Electronic For motor protection Size S3, Class 20E Contactor mounting Main circuit: Screw Auxiliary circuit: Screw Manual-Automatic-Reset

product brand name	SIRIUS
product designation	solid-state overload relay
product type designation	3RB3
General technical data	
size of overload relay	S3
size of contactor can be combined company-specific	S3
power loss [W] for rated value of the current at AC in hot operating state	4.6 W
• per pole	1.53 W
insulation voltage with degree of pollution 3 at AC rated value	1 000 V
surge voltage resistance rated value	8 kV
maximum permissible voltage for safe isolation in networks with grounded star point	
• between auxiliary and auxiliary circuit	300 V
• between auxiliary and auxiliary circuit	300 V
• between main and auxiliary circuit	600 V
• between main and auxiliary circuit	690 V
shock resistance	8g / 11 ms
• acc. to IEC 60068-2-27	15g / 11 ms; Signaling contact 97 / 98 in position "Tripped": 8g / 11 ms
vibration resistance	1-6 Hz, 15 mm; 6-500 Hz, 20 m/s ² ; 10 cycles
thermal current	115 A
recovery time after overload trip	
• with automatic reset typical	3 min
• with remote-reset	0 min
• with manual reset	0 min
type of protection according to ATEX directive 2014/34/EU	Ex II (2) G [Ex e] [Ex d] [Ex px] ; Ex II (2) D [Ex t] [Ex p]
certificate of suitability according to ATEX directive 2014/34/EU	PTB 09 ATEX 3001
reference code acc. to IEC 81346-2	F
Substance Prohibition (Date)	01.03.2017 00:00:00
Ambient conditions	
installation altitude at height above sea level maximum	2 000 m
ambient temperature	
• during operation	-25 ... +60 °C
• during storage	-40 ... +80 °C
• during transport	-40 ... +80 °C
temperature compensation	-25 ... +60 °C

relative humidity during operation	10 ... 95 %
Main circuit	
number of poles for main current circuit	3
adjustable current response value current of the current-dependent overload release	32 ... 115 A
operating voltage <ul style="list-style-type: none"> rated value at AC-3 rated value maximum 	1 000 V 1 000 V
operating frequency rated value	50 ... 60 Hz
operational current rated value	115 A
operating power <ul style="list-style-type: none"> for 3-phase motors at 400 V at 50 Hz for AC motors at 500 V at 50 Hz for AC motors at 690 V at 50 Hz 	18.5 ... 55 kW 22 ... 75 kW 30 ... 90 kW
Auxiliary circuit	
design of the auxiliary switch	integrated
number of NC contacts for auxiliary contacts <ul style="list-style-type: none"> note 	1 for contactor disconnection
number of NO contacts for auxiliary contacts <ul style="list-style-type: none"> note 	1 for message "tripped"
number of CO contacts for auxiliary contacts	0
operational current of auxiliary contacts at AC-15 <ul style="list-style-type: none"> at 24 V at 110 V at 120 V at 125 V at 230 V 	4 A 4 A 4 A 4 A 3 A
operational current of auxiliary contacts at DC-13 <ul style="list-style-type: none"> at 24 V at 60 V at 110 V at 125 V at 220 V 	2 A 0.55 A 0.3 A 0.3 A 0.11 A
Protective and monitoring functions	
trip class	CLASS 20E
design of the overload release	electronic
UL/CSA ratings	
full-load current (FLA) for 3-phase AC motor <ul style="list-style-type: none"> at 480 V rated value at 600 V rated value 	115 A 115 A
contact rating of auxiliary contacts according to UL	B600 / R300
Short-circuit protection	
design of the fuse link <ul style="list-style-type: none"> for short-circuit protection of the main circuit <ul style="list-style-type: none"> with type of coordination 1 required with type of assignment 2 required for short-circuit protection of the auxiliary switch required 	gG: 315 A gG: 315 A fuse gG: 6 A
Installation/ mounting/ dimensions	
mounting position	any
fastening method	Contactor mounting
height	106 mm
width	70 mm
depth	124 mm
Connections/ Terminals	
product component removable terminal for auxiliary and control circuit	Yes
type of electrical connection	

<ul style="list-style-type: none">• for main current circuit• for auxiliary and control circuit	screw-type terminals				
arrangement of electrical connectors for main current circuit	screw-type terminals				
type of connectable conductor cross-sections	Top and bottom				
<ul style="list-style-type: none">• for main contacts<ul style="list-style-type: none">— solid— stranded— solid or stranded— finely stranded with core end processing• at AWG cables for main contacts	2x (2.5 ... 16 mm²) 2x 16 mm² 1x (2,5 ... 70 mm²), 2x (2,5 ... 50 mm²) 1x (2,5 ... 50 mm²), 2x (2,5 ... 35 mm²) 1x (10 ... 2/0), 2x (10 ... 1/0)				
type of connectable conductor cross-sections					
<ul style="list-style-type: none">• for auxiliary contacts<ul style="list-style-type: none">— solid— solid or stranded— finely stranded with core end processing• at AWG cables for auxiliary contacts	1x (0.5 ... 4 mm²), 2x (0.5 ... 2.5 mm²) 1x (0,5 ... 4 mm²), 2x (0,5 ... 2,5 mm²) 1x (0.5 ... 2.5 mm²), 2x (0.5 ... 1.5 mm²) 2x (20 ... 14)				
tightening torque					
<ul style="list-style-type: none">• for main contacts with screw-type terminals• for auxiliary contacts with screw-type terminals	4.5 ... 6 N·m 0.8 ... 1.2 N·m				
design of screwdriver shaft	Diameter 5 to 6 mm				
size of the screwdriver tip	Pozidriv PZ 2				
design of the thread of the connection screw					
<ul style="list-style-type: none">• for main contacts• of the auxiliary and control contacts	M6 M3				
Safety related data					
protection class IP on the front acc. to IEC 60529	IP20				
touch protection on the front acc. to IEC 60529	finger-safe, for vertical contact from the front				
Communication/ Protocol					
type of voltage supply via input/output link master	No				
Electromagnetic compatibility					
conducted interference					
<ul style="list-style-type: none">• due to burst acc. to IEC 61000-4-4	2 kV (power ports), 1 kV (signal ports) corresponds to degree of severity 3				
<ul style="list-style-type: none">• due to conductor-earth surge acc. to IEC 61000-4-5• due to conductor-conductor surge acc. to IEC 61000-4-5	2 kV (line to earth) corresponds to degree of severity 3 1 kV (line to line) corresponds to degree of severity 3				
<ul style="list-style-type: none">• due to high-frequency radiation acc. to IEC 61000-4-6	10 V in frequency range 0.15 to 80 MHz, modulation 80 % AM with 1 kHz				
field-based interference acc. to IEC 61000-4-3	10 V/m				
electrostatic discharge acc. to IEC 61000-4-2	6 kV contact discharge / 8 kV air discharge				
Display					
display version for switching status	Slide switch				
Certificates/ approvals					
General Product Approval	EMC	For use in hazardous locations			
					
CSA	CCC	UL		RCM	ATEX
Declaration of Conformity	Test Certificates	Marine / Shipping			



[Special Test Certificate](#)

[Type Test Certificates/Test Report](#)



Marine / Shipping

other



[Confirmation](#)

Further information

Information- and Downloadcenter (Catalogs, Brochures,...)

<https://www.siemens.com/ic10>

Industry Mall (Online ordering system)

<https://mall.industry.siemens.com/mall/en/en/Catalog/product?mlfb=3RB3046-2XB0>

Cax online generator

<http://support.automation.siemens.com/WW/CAXorder/default.aspx?lang=en&mlfb=3RB3046-2XB0>

Service&Support (Manuals, Certificates, Characteristics, FAQs,...)

<https://support.industry.siemens.com/cs/ww/en/ps/3RB3046-2XB0>

Image database (product images, 2D dimension drawings, 3D models, device circuit diagrams, EPLAN macros, ...)

http://www.automation.siemens.com/bilddb/cax_de.aspx?mlfb=3RB3046-2XB0&lang=en

Characteristic: Tripping characteristics, I²t, Let-through current

<https://support.industry.siemens.com/cs/ww/en/ps/3RB3046-2XB0/char>

Further characteristics (e.g. electrical endurance, switching frequency)

<http://www.automation.siemens.com/bilddb/index.aspx?view=Search&mlfb=3RB3046-2XB0&objecttype=14&gridview=view1>

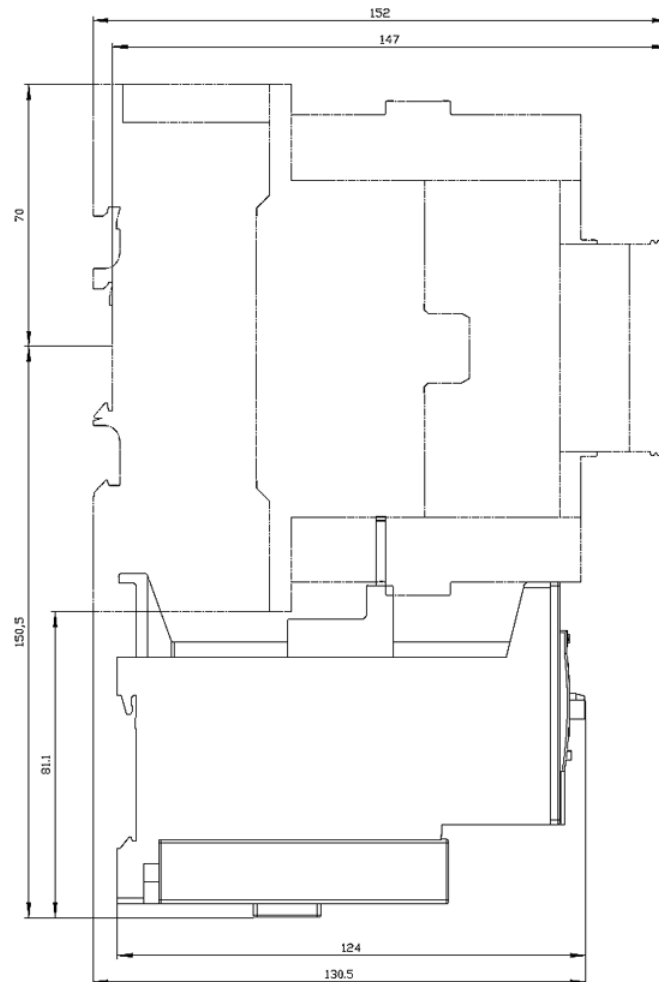
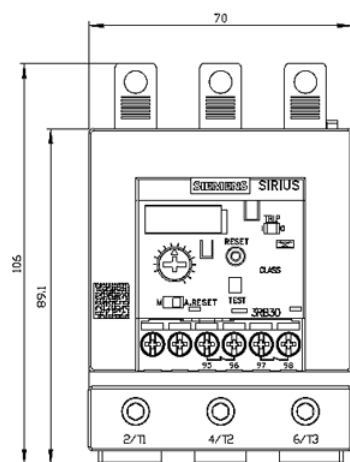

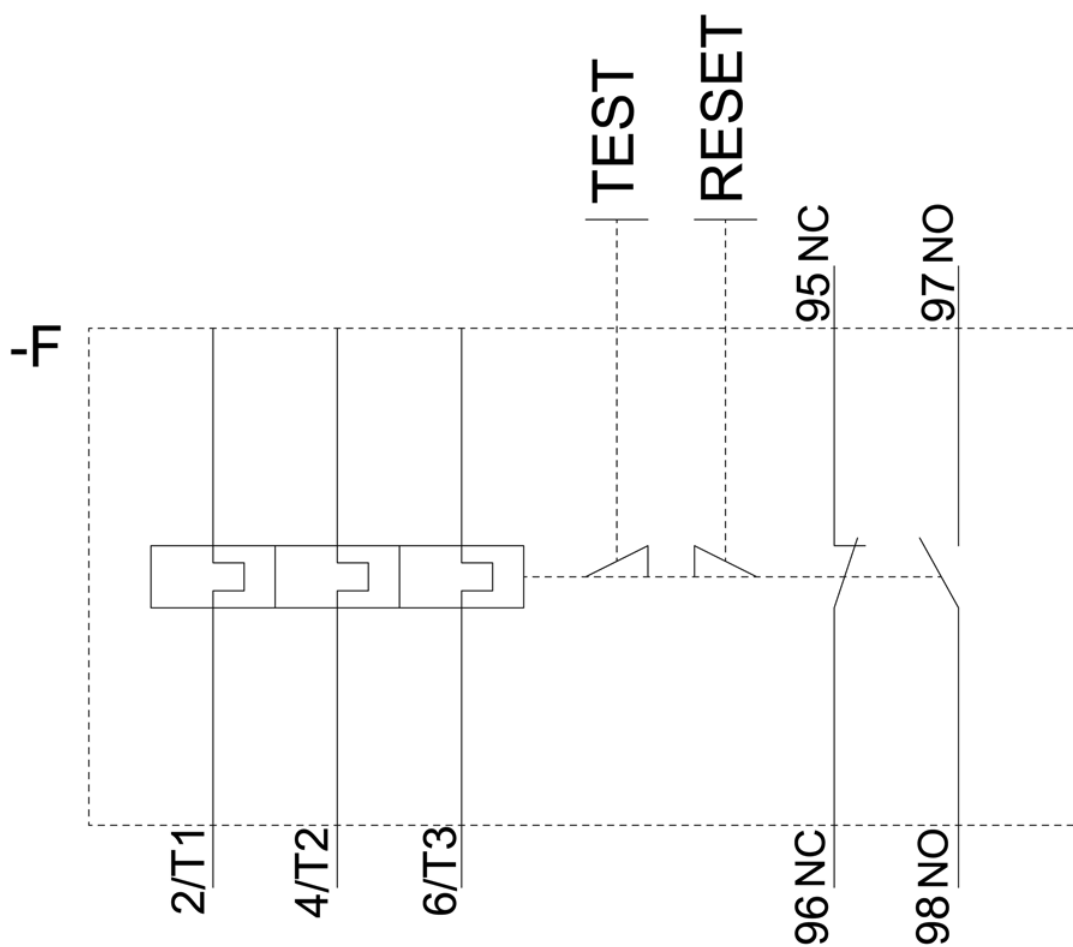

last modified:

12/15/2020 