



Auxiliary switch block, for 3TB52...3TB56, 3TC52, 3TC56, left

General technical data	
<b>suitability for use</b>	Contactor relay and power contactor
<b>protection class IP on the front</b>	IP20
<b>ambient temperature</b>	
• during storage	-55 ... +80 °C
• during operation	-25 ... +55 °C
<b>mechanical service life (switching cycles) typical</b>	10 000 000
<b>insulation voltage with degree of pollution 3 at AC rated value</b>	690 V
<b>surge voltage resistance rated value</b>	6 kV
Auxiliary circuit	
<b>number of NC contacts for auxiliary contacts</b>	
• instantaneous contact	1
• lagging switching	0
<b>number of NO contacts for auxiliary contacts</b>	
• instantaneous contact	1
• leading contact	0
<b>operational current of auxiliary contacts at AC-12</b>	
• at 24 V	10 A
• at 230 V	10 A
• maximum	10 A
<b>operational current</b>	
• of auxiliary contacts	
— at AC-14	
— at 125 V	10 A
— at AC-15	
— at 24 V	10 A
— at 230 V	5.6 A
— at 400 V	3.6 A
<b>operational current</b>	
• of auxiliary contacts at DC-12	
— at 24 V	10 A
— at 110 V	8 A
— at 220 V	2 A
<b>operational current</b>	
• of auxiliary contacts at DC-13	
— at 24 V	10 A
— at 60 V	5 A

— at 110 V	2.4 A
— at 220 V	1.1 A
<b>Installation/ mounting/ dimensions</b>	
<b>fastening method</b>	snap-on mounting
<b>width</b>	14 mm
<b>height</b>	81 mm
<b>depth</b>	72.5 mm
<b>Connections/ Terminals</b>	
<b>type of electrical connection for auxiliary and control circuit</b>	screw-type terminals
<b>type of connectable conductor cross-sections</b>	
<ul style="list-style-type: none"> <li>• for auxiliary contacts <ul style="list-style-type: none"> <li>— finely stranded</li> <li>— with core end processing</li> </ul> </li> <li>• at AWG cables for auxiliary contacts</li> </ul>	2x (0.5 ... 1.0 mm <sup>2</sup> ), 2x (0.75 ... 2.5 mm <sup>2</sup> ) 2x (18 ... 12)
<b>Safety related data</b>	
<b>product function positively driven operation acc. to IEC 60947-5-1</b>	Yes
<b>Certificates/ approvals</b>	
<b>General Product Approval</b>	<b>other</b>



[Confirmation](#)

#### Further information

Information- and Downloadcenter (Catalogs, Brochures,...)

<https://www.siemens.com/ic10>

Industry Mall (Online ordering system)

<https://mall.industry.siemens.com/mall/en/en/Catalog/product?mlfb=3TY6561-1A>

Cax online generator

<http://support.automation.siemens.com/WW/CAXorder/default.aspx?lang=en&mlfb=3TY6561-1A>

Service&Support (Manuals, Certificates, Characteristics, FAQs,...)

<https://support.industry.siemens.com/cs/ww/en/ps/3TY6561-1A>

Image database (product images, 2D dimension drawings, 3D models, device circuit diagrams, EPLAN macros, ...)

[http://www.automation.siemens.com/bilddb/cax\\_de.aspx?mlfb=3TY6561-1A&lang=en](http://www.automation.siemens.com/bilddb/cax_de.aspx?mlfb=3TY6561-1A&lang=en)

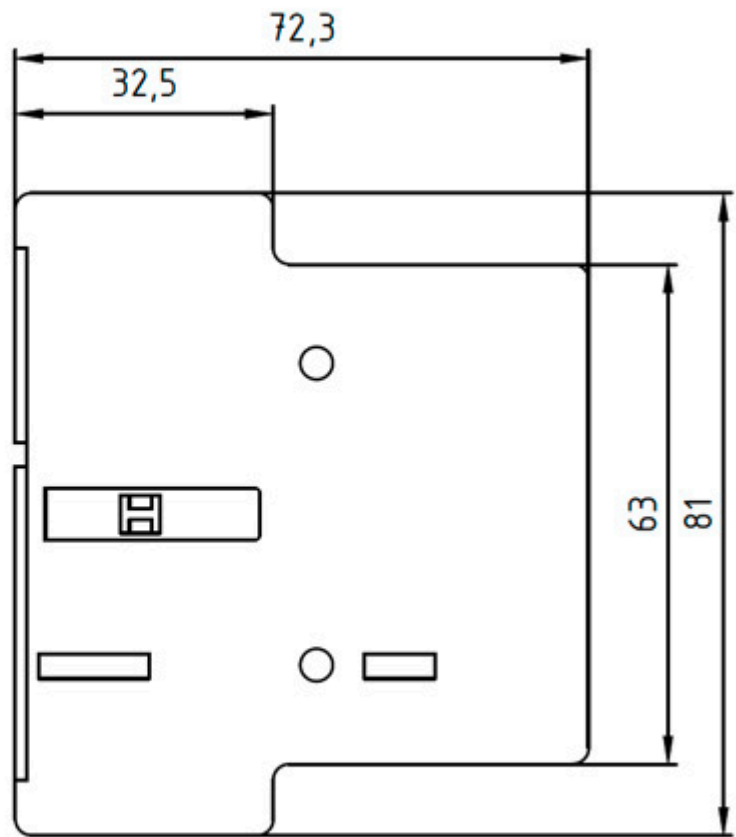
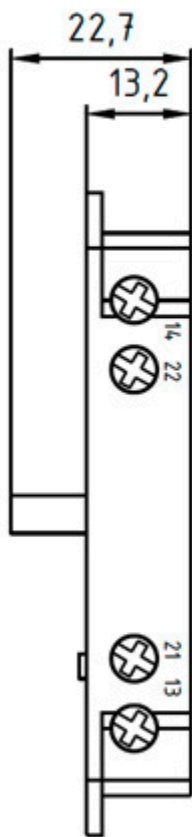

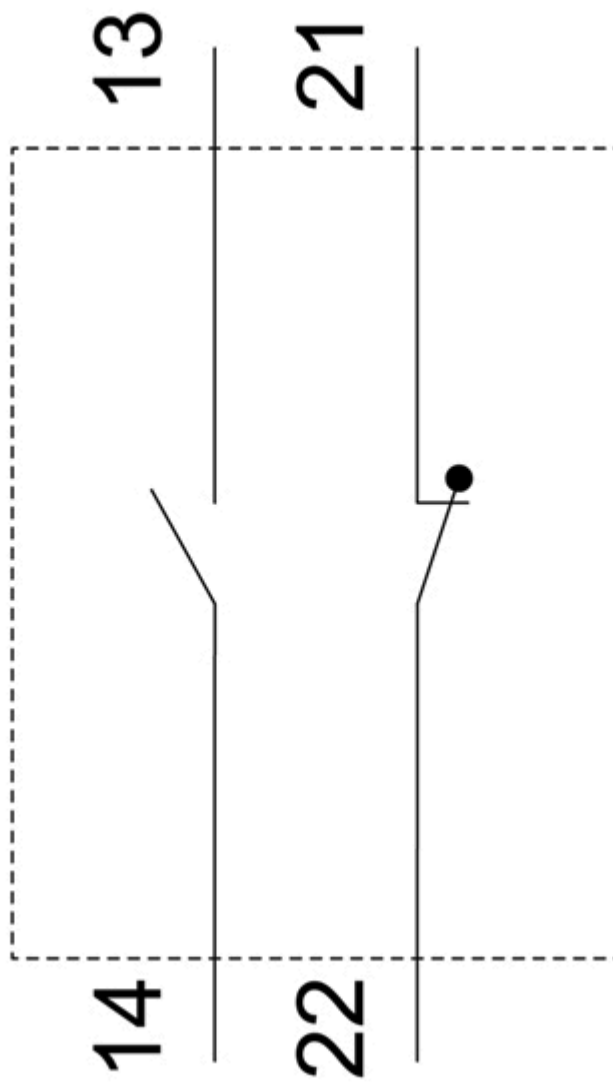

last modified:

12/23/2020 