



Cable-operated switch and lever Metal enclosure, 2 x M25 x 1.5; 2 NO+2 NC, latching according to EN13850 and pushbutton release with LED lamp red DC 24 V, 2-sided operation, for wire lengths up to 2 x 100 m

product brand name	SIRIUS
product designation	cable-operated switch
product type designation	3SE7
General technical data	
product function EMERGENCY STOP function	Yes
product component light source	Yes
insulation voltage rated value	400 V
degree of pollution	class 3
surge voltage resistance rated value	6 kV
protection class IP	IP65
mechanical service life (switching cycles) typical	100 000
thermal current	6 A
reference code acc. to IEC 81346-2	S
continuous current of the DIAZED fuse link gG	6 A
Substance Prohibition (Date)	01.07.2006 00:00:00
number of NC contacts for auxiliary contacts	2
number of NO contacts for auxiliary contacts	2
operational current at AC-15	
• at 240 V rated value	6 A
• at 400 V rated value	6 A
operational current at DC-13	
• at 24 V rated value	3 A
• at 250 V rated value	0.27 A
Enclosure	
material of the enclosure	metal
material of the enclosure cover	Metal
product component EMERGENCY STOP device	No
color	
• of the enclosure	black
• of the enclosure top part	grey
coating of the enclosure	painted
circuit principle	Jump function
material of the contact	Silver
number of switching contacts safety-related	2
Connections/ Terminals	
type of electrical connection	screw-type terminals
type of connectable conductor cross-sections	

- solid 2x (0.5 ... 2.5 mm²)
- finely stranded with core end processing 2x (0.5 ... 2.5 mm²)
- at AWG cables solid 2x (20 ... 14)
- at AWG cables stranded 2x (20 ... 14)

Safety related data

B10 value with high demand rate acc. to SN 31920	100 000
proportion of dangerous failures with high demand rate acc. to SN 31920	50 %
cable entry type	2x M25 x 1,5

Ambient conditions

ambient temperature during operation	-25 ... +70 °C
--------------------------------------	----------------

Supply voltage

type of voltage of the supply voltage of the light source	DC
supply voltage 1 of the light source at DC rated value	24 V
relative negative tolerance of the supply voltage	-15 %
relative positive tolerance of the supply voltage	10 %

Display

product function status display	No
--	----

Lamp

color of the light source	red
----------------------------------	-----

Installation/ mounting/ dimensions

fastening method	screw fixing
height	160 mm
width	127 mm
depth	92 mm

Certificates/ approvals

General Product Approval

Marine / Shipping



Marine / Shipping

other



[Confirmation](#)

Further information

Information- and Downloadcenter (Catalogs, Brochures,...)

<https://www.siemens.com/ic10>

Industry Mall (Online ordering system)

<https://mall.industry.siemens.com/mall/en/en/Catalog/product?mlfb=3SE7160-1AE04>

Cax online generator

<http://support.automation.siemens.com/WW/CAXorder/default.aspx?lang=en&mlfb=3SE7160-1AE04>

Service&Support (Manuals, Certificates, Characteristics, FAQs,...)

<https://support.industry.siemens.com/cs/ww/en/ps/3SE7160-1AE04>

Image database (product images, 2D dimension drawings, 3D models, device circuit diagrams, EPLAN macros, ...)

http://www.automation.siemens.com/bilddb/cax_de.aspx?mlfb=3SE7160-1AE04&lang=en

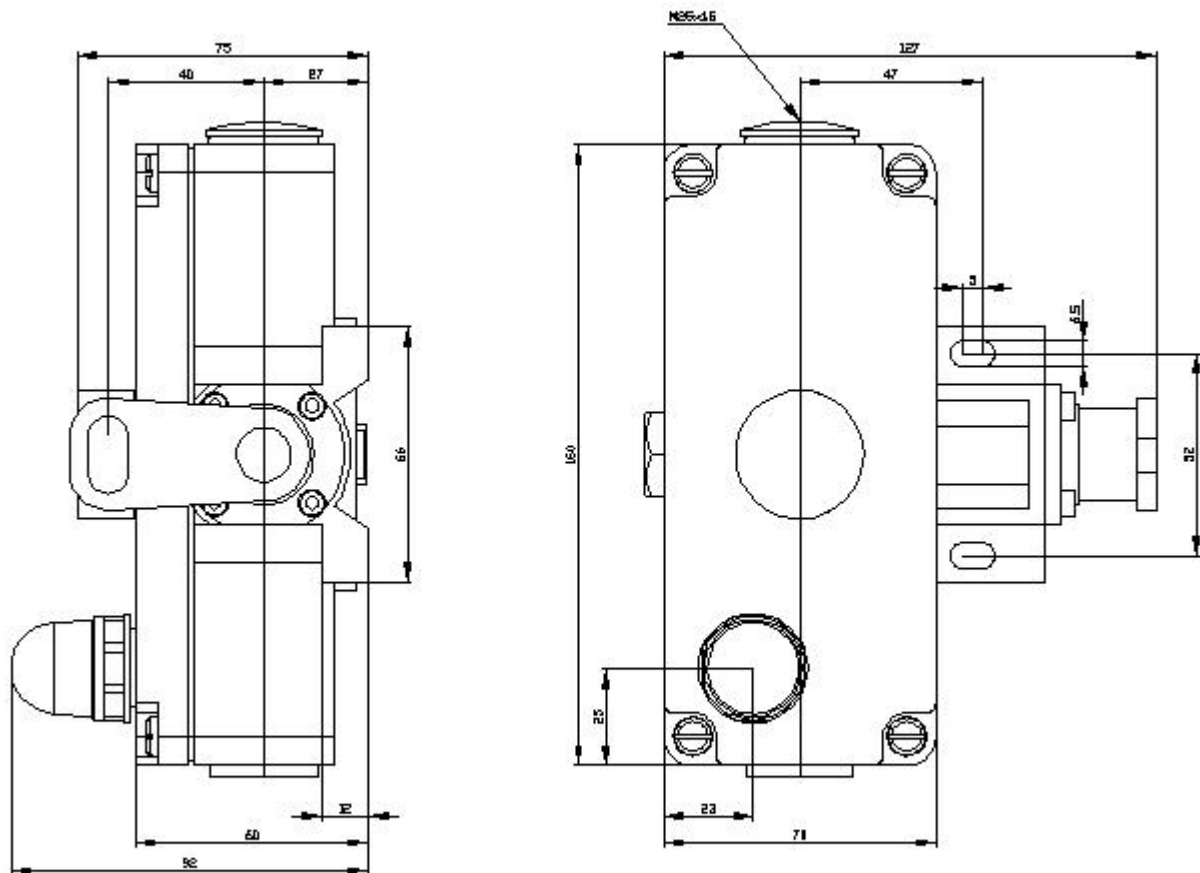

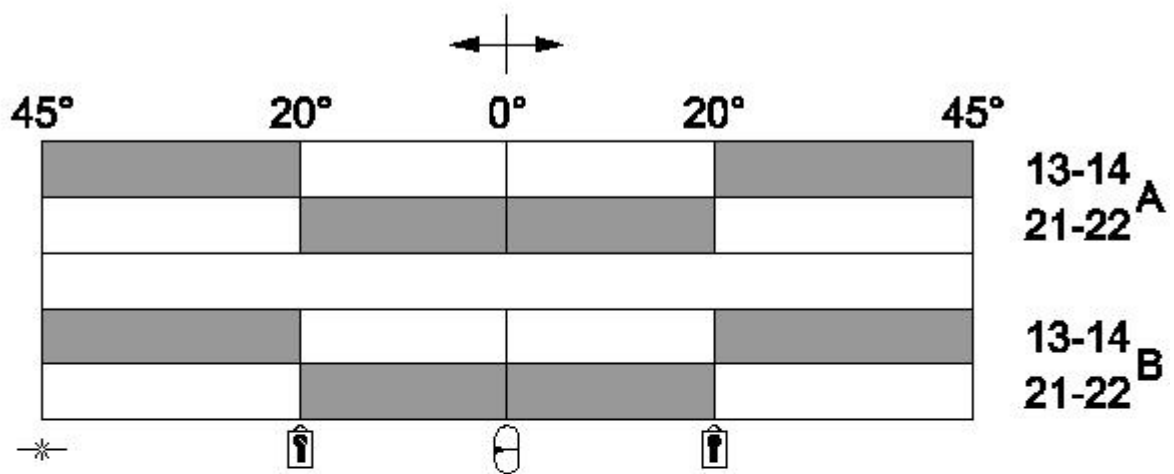

last modified:

12/23/2020