



Continuous light element, with integrated LED, red, 24 V AC/DC, Diameter 50 mm

General technical data			
product brand name	SIRIUS		
product designation	Continuous light element		
design of the optical signal	continous light		
type of voltage of the operating voltage	AC/DC		
operating voltage			
• 1 at DC rated value	24 V		
• 1 at AC at 50 Hz rated value	24 V		
• 1 at AC at 60 Hz rated value	24 V		
relative positive tolerance of the operating voltage	10 %		
relative negative tolerance of the operating voltage	-10 %		
consumed current maximum	30 mA		
service life of LED	100 000 h		
material	PC		
color	red		
fastening method	Bayonet		
reference code			
• acc. to DIN EN 61346-2	P		
• acc. to IEC 81346-2	P		
Mechanical data			
outer diameter of the signal column element	50 mm		
Lamp			
product component light source	Yes		
type of light source	LED		
light intensity	1.51 cd		
light intensity	0.9 ... 2.43 cd		
Ambient conditions			
ambient temperature during operation	-20 ... +50 °C		
protection class IP	IP54		
height	67 mm		
width	52 mm		
Certificates/ approvals			
General Product Approval	EMC	Declaration of Conformity	other



[Miscellaneous](#)

[Confirmation](#)

#### Further information

Information- and Downloadcenter (Catalogs, Brochures,...)

<https://www.siemens.com/ic10>

Industry Mall (Online ordering system)

<https://mall.industry.siemens.com/mall/en/en/Catalog/product?mlfb=8WD4220-5AB>

Cax online generator

<http://support.automation.siemens.com/WW/CAXorder/default.aspx?lang=en&mlfb=8WD4220-5AB>

Service&Support (Manuals, Certificates, Characteristics, FAQs,...)

<https://support.industry.siemens.com/cs/ww/en/ps/8WD4220-5AB>

Image database (product images, 2D dimension drawings, 3D models, device circuit diagrams, EPLAN macros, ...)

[http://www.automation.siemens.com/bilddb/cax\\_de.aspx?mlfb=8WD4220-5AB&lang=en](http://www.automation.siemens.com/bilddb/cax_de.aspx?mlfb=8WD4220-5AB&lang=en)

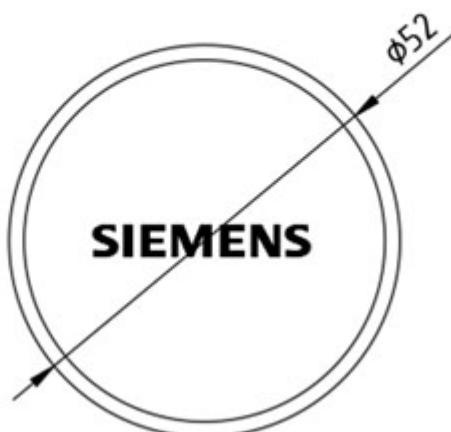
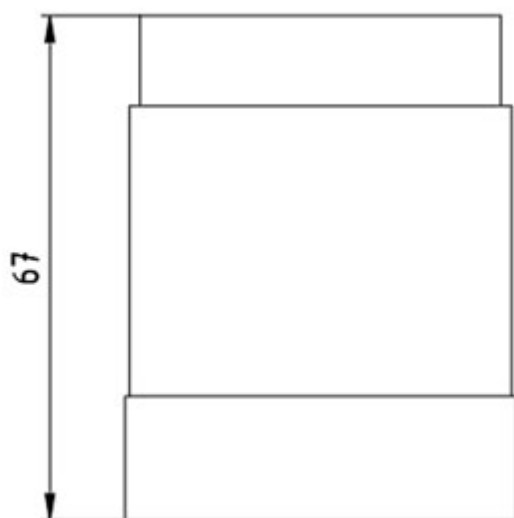

last modified:

12/23/2020