

power contactor, AC-3 25 A, 11 kW / 400 V 1 NO + 1 NC, 400 V AC, 50 Hz, 400-440 V, 60 Hz, 3-pole, Size S0, ring cable lug connection



| | |
|--|-----------------|
| product brand name | SIRIUS |
| product designation | Power contactor |
| product type designation | 3RT2 |
| General technical data | |
| size of contactor | S0 |
| product extension | |
| • function module for communication | No |
| • auxiliary switch | Yes |
| power loss [W] for rated value of the current | |
| • at AC in hot operating state | 4.8 W |
| • at AC in hot operating state per pole | 1.6 W |
| power loss [W] for rated value of the current without load current share typical | 10.5 W |
| surge voltage resistance | |
| • of main circuit rated value | 6 kV |
| • of auxiliary circuit rated value | 6 kV |
| maximum permissible voltage for safe isolation | |
| • between coil and main contacts acc. to EN 60947-1 | 400 V |

| | |
|---|----------------------------|
| protection class IP | |
| • on the front | IP00 |
| • of the terminal | IP00 |
| shock resistance at rectangular impulse | |
| • at AC | 8,3g / 5 ms, 5,3g / 10 ms |
| shock resistance with sine pulse | |
| • at AC | 13,5g / 5 ms, 8,3g / 10 ms |
| mechanical service life (switching cycles) | |
| • of contactor typical | 10 000 000 |
| • of the contactor with added electronics-compatible auxiliary switch block typical | 5 000 000 |
| • of the contactor with added auxiliary switch block typical | 10 000 000 |
| reference code acc. to DIN EN 81346-2 | Q |

| | |
|---|----------------|
| Ambient conditions | |
| • installation altitude at height above sea level maximum | 2 000 m |
| ambient temperature | |
| • during operation | -25 ... +60 °C |
| • during storage | -55 ... +80 °C |

| | |
|---|--------|
| Main circuit | |
| number of poles for main current circuit | 3 |
| number of NO contacts for main contacts | 3 |
| operating voltage | |
| • at AC-3 rated value maximum | 690 V |
| operating current | |
| • at AC-1 at 400 V — at ambient temperature 40 °C rated value | 40 A |
| • at AC-1 — up to 690 V at ambient temperature 40 °C rated value | 40 A |
| — up to 690 V at ambient temperature 60 °C rated value | 35 A |
| • at AC-3 — at 400 V rated value | 25 A |
| — at 500 V rated value | 18 A |
| — at 690 V rated value | 13 A |
| • at AC-4 at 400 V rated value | 15.5 A |
| • at AC-5a up to 690 V rated value | 35.2 A |
| • at AC-5b up to 400 V rated value | 20.7 A |
| • at AC-6a | |

| | |
|--|--------------------|
| — up to 230 V for current peak value n=20 rated value | 20.2 A |
| — up to 400 V for current peak value n=20 rated value | 20.2 A |
| — up to 500 V for current peak value n=20 rated value | 20.2 A |
| — up to 690 V for current peak value n=20 rated value | 12.9 A |
| • at AC-6a | |
| — up to 230 V for current peak value n=30 rated value | 13.5 A |
| — up to 400 V for current peak value n=30 rated value | 13.5 A |
| — up to 500 V for current peak value n=30 rated value | 13.5 A |
| — up to 690 V for current peak value n=30 rated value | 13 A |
| minimum cross-section in main circuit | |
| • at maximum AC-1 rated value | 10 mm ² |
| operating current for approx. 200000 operating cycles at AC-4 | |
| • at 400 V rated value | 9 A |
| • at 690 V rated value | 9 A |
| operating current | |
| • at 1 current path at DC-1 | |
| — at 24 V rated value | 35 A |
| — at 110 V rated value | 4.5 A |
| — at 220 V rated value | 1 A |
| — at 440 V rated value | 0.4 A |
| — at 600 V rated value | 0.25 A |
| • with 2 current paths in series at DC-1 | |
| — at 24 V rated value | 35 A |
| — at 110 V rated value | 35 A |
| — at 220 V rated value | 5 A |
| — at 440 V rated value | 1 A |
| — at 600 V rated value | 0.8 A |
| • with 3 current paths in series at DC-1 | |
| — at 24 V rated value | 35 A |
| — at 110 V rated value | 35 A |
| — at 220 V rated value | 35 A |
| — at 440 V rated value | 2.9 A |
| — at 600 V rated value | 1.4 A |
| operating current | |

| | |
|--|---|
| <ul style="list-style-type: none"> • at 1 current path at DC-3 at DC-5 <ul style="list-style-type: none"> — at 24 V rated value — at 110 V rated value — at 220 V rated value — at 440 V rated value — at 600 V rated value • with 2 current paths in series at DC-3 at DC-5 <ul style="list-style-type: none"> — at 24 V rated value — at 110 V rated value — at 220 V rated value — at 440 V rated value — at 600 V rated value • with 3 current paths in series at DC-3 at DC-5 <ul style="list-style-type: none"> — at 24 V rated value — at 110 V rated value — at 220 V rated value — at 440 V rated value — at 600 V rated value | 20 A 2.5 A 1 A 0.09 A 0.06 A 35 A 15 A 3 A 0.27 A 0.16 A 35 A 35 A 10 A 0.6 A 0.6 A |
| operating power | |
| <ul style="list-style-type: none"> • at AC-3 <ul style="list-style-type: none"> — at 230 V rated value — at 400 V rated value — at 500 V rated value — at 690 V rated value | 5.5 kW 11 kW 11 kW 11 kW |
| operating power for approx. 200000 operating cycles at AC-4 | |
| <ul style="list-style-type: none"> • at 400 V rated value • at 690 V rated value | 4.4 kW 7.7 kW |
| operating apparent output at AC-6a | |
| <ul style="list-style-type: none"> • up to 230 V for current peak value n=20 rated value • up to 400 V for current peak value n=20 rated value • up to 500 V for current peak value n=20 rated value • up to 690 V for current peak value n=20 rated value | 8 kV·A 13.9 kV·A 17.4 kV·A 15.4 kV·A |
| operating apparent output at AC-6a | |
| <ul style="list-style-type: none"> • up to 230 V for current peak value n=30 rated value • up to 400 V for current peak value n=30 rated value | 5.3 kV·A 9.3 kV·A |

| | |
|---|---|
| <ul style="list-style-type: none"> • up to 500 V for current peak value n=30 rated value • up to 690 V for current peak value n=30 rated value | 11.6 kV·A 15.5 kV·A |
| short-time withstand current in cold operating state up to 40 °C <ul style="list-style-type: none"> • limited to 1 s switching at zero current maximum • limited to 5 s switching at zero current maximum • limited to 10 s switching at zero current maximum • limited to 30 s switching at zero current maximum • limited to 60 s switching at zero current maximum | 375 A; Use minimum cross-section acc. to AC-1 rated value 299 A; Use minimum cross-section acc. to AC-1 rated value 200 A; Use minimum cross-section acc. to AC-1 rated value 128 A; Use minimum cross-section acc. to AC-1 rated value 106 A; Use minimum cross-section acc. to AC-1 rated value |
| no-load switching frequency <ul style="list-style-type: none"> • at AC | 5 000 1/h |
| operating frequency <ul style="list-style-type: none"> • at AC-1 maximum • at AC-2 maximum • at AC-3 maximum • at AC-4 maximum | 1 000 1/h 750 1/h 750 1/h 250 1/h |

| Control circuit/ Control | |
|--|-----------------------------|
| type of voltage of the control supply voltage | AC |
| control supply voltage at AC <ul style="list-style-type: none"> • at 50 Hz rated value • at 60 Hz rated value | 400 V 440 V |
| operating range factor control supply voltage rated value of magnet coil at AC <ul style="list-style-type: none"> • at 50 Hz • at 60 Hz | 0.8 ... 1.1 0.85 ... 1.1 |
| apparent pick-up power of magnet coil at AC <ul style="list-style-type: none"> • at 50 Hz • at 60 Hz | 81 V·A 79 V·A |
| inductive power factor with closing power of the coil <ul style="list-style-type: none"> • at 50 Hz • at 60 Hz | 0.72 0.74 |
| apparent holding power of magnet coil at AC <ul style="list-style-type: none"> • at 50 Hz • at 60 Hz | 10.5 V·A 8.5 V·A |
| inductive power factor with the holding power of the coil | |

| | |
|--|------------------|
| <ul style="list-style-type: none"> • at 50 Hz • at 60 Hz | 0.25 0.28 |
| closing delay | |
| <ul style="list-style-type: none"> • at AC | 8 ... 40 ms |
| opening delay | |
| <ul style="list-style-type: none"> • at AC | 4 ... 16 ms |
| arcing time | 10 ... 10 ms |
| control version of the switch operating mechanism | Standard A1 - A2 |

Auxiliary circuit

| | |
|---|--|
| number of NC contacts for auxiliary contacts | |
| <ul style="list-style-type: none"> • instantaneous contact | 1 |
| number of NO contacts for auxiliary contacts | |
| <ul style="list-style-type: none"> • instantaneous contact | 1 |
| operating current at AC-12 maximum | 10 A |
| operating current at AC-15 | |
| <ul style="list-style-type: none"> • at 230 V rated value • at 400 V rated value • at 500 V rated value • at 690 V rated value | 10 A 3 A 2 A 1 A |
| operating current at DC-12 | |
| <ul style="list-style-type: none"> • at 24 V rated value • at 48 V rated value • at 60 V rated value • at 110 V rated value • at 125 V rated value • at 220 V rated value • at 600 V rated value | 10 A 6 A 6 A 3 A 2 A 1 A 0.15 A |
| operating current at DC-13 | |
| <ul style="list-style-type: none"> • at 24 V rated value • at 48 V rated value • at 60 V rated value • at 110 V rated value • at 125 V rated value • at 220 V rated value • at 600 V rated value | 10 A 2 A 2 A 1 A 0.9 A 0.3 A 0.1 A |
| contact reliability of auxiliary contacts | 1 faulty switching per 100 million (17 V, 1 mA) |

UL/CSA ratings

| | |
|--|--------------|
| full-load current (FLA) for three-phase AC motor | |
| <ul style="list-style-type: none"> • at 480 V rated value • at 600 V rated value | 21 A 22 A |
| yielded mechanical performance [hp] | |

| | |
|---|--|
| <ul style="list-style-type: none"> • for single-phase AC motor <ul style="list-style-type: none"> — at 110/120 V rated value — at 230 V rated value • for three-phase AC motor <ul style="list-style-type: none"> — at 200/208 V rated value — at 220/230 V rated value — at 460/480 V rated value — at 575/600 V rated value | 2 hp 3 hp 5 hp 7.5 hp 15 hp 20 hp |
| contact rating of auxiliary contacts according to UL | A600 / P600 |

Short-circuit protection

| | |
|---|---|
| design of the fuse link | |
| <ul style="list-style-type: none"> • for short-circuit protection of the main circuit <ul style="list-style-type: none"> — with type of coordination 1 required — with type of assignment 2 required • for short-circuit protection of the auxiliary switch required | gG: 100 A (690 V, 100 kA), aM: 50 A (690 V, 100 kA), BS88: 100 A (415 V, 80 kA) gG: 35A (690V, 100kA), aM: 20A (690V, 100kA), BS88: 35A (415V, 80kA) gG: 10 A (500 V, 1 kA) |

Installation/ mounting/ dimensions

| | |
|---|--|
| mounting position | +/-180° rotation possible on vertical mounting surface; can be tilted forward and backward by +/- 22.5° on vertical mounting surface |
| mounting type | screw and snap-on mounting onto 35 mm standard mounting rail according to DIN EN 60715 |
| <ul style="list-style-type: none"> • side-by-side mounting | Yes |
| height | 85 mm |
| width | 45 mm |
| depth | 97 mm |
| required spacing | |
| <ul style="list-style-type: none"> • with side-by-side mounting <ul style="list-style-type: none"> — forwards — upwards — downwards — at the side • for grounded parts <ul style="list-style-type: none"> — forwards — upwards — at the side — downwards • for live parts <ul style="list-style-type: none"> — forwards — upwards | 10 mm 10 mm 10 mm 0 mm 10 mm 10 mm 6 mm 10 mm 10 mm 10 mm |

— downwards

10 mm

— at the side

6 mm

Connections/ Terminals

type of electrical connection

- for main current circuit
- for auxiliary and control current circuit
- at contactor for auxiliary contacts
- of magnet coil

Ring cable lug connection

ring cable connection

Ring cable lug connection

Ring cable lug connection

Safety related data

B10 value

- with high demand rate acc. to SN 31920

1 000 000

proportion of dangerous failures

- with low demand rate acc. to SN 31920
- with high demand rate acc. to SN 31920

40 %

73 %

failure rate [FIT]

- with low demand rate acc. to SN 31920

100 FIT

product function

- mirror contact acc. to IEC 60947-4-1

Yes

T1 value for proof test interval or service life acc. to IEC 61508

20 y

suitability for use safety-related switching OFF

Yes

Certificates/ approvals

| General Product Approval | EMC |
|--------------------------|-----|
|--------------------------|-----|



[KC](#)



| Functional Safety/Safety of Machinery | Declaration of Conformity | Test Certificates | Marine / Shipping |
|---------------------------------------|---------------------------|-------------------|-------------------|
|---------------------------------------|---------------------------|-------------------|-------------------|

[Type Examination Certificate](#)



[Miscellaneous](#)

[Type Test Certificates/Test Report](#)

[Special Test Certificate](#)



| Marine / Shipping |
|-------------------|
|-------------------|



| other |
|-------|
|-------|

[Confirmation](#)



| Further information |
|---------------------|
|---------------------|

Information- and Downloadcenter (Catalogs, Brochures,...)

<https://www.siemens.com/ic10>

Industry Mall (Online ordering system)

<https://mall.industry.siemens.com/mall/en/en/Catalog/product?mlfb=3RT2026-4AR60>

Cax online generator

<http://support.automation.siemens.com/WW/CAXorder/default.aspx?lang=en&mlfb=3RT2026-4AR60>

Service&Support (Manuals, Certificates, Characteristics, FAQs,...)

<https://support.industry.siemens.com/cs/ww/en/ps/3RT2026-4AR60>

Image database (product images, 2D dimension drawings, 3D models, device circuit diagrams, EPLAN macros, ...)

http://www.automation.siemens.com/bilddb/cax_de.aspx?mlfb=3RT2026-4AR60&lang=en

Characteristic: Tripping characteristics, I_t, Let-through current

<https://support.industry.siemens.com/cs/ww/en/ps/3RT2026-4AR60/char>

Further characteristics (e.g. electrical endurance, switching frequency)

<http://www.automation.siemens.com/bilddb/index.aspx?view=Search&mlfb=3RT2026-4AR60&objecttype=14&gridview=view1>

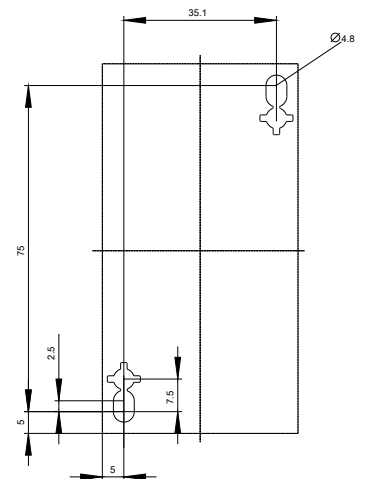
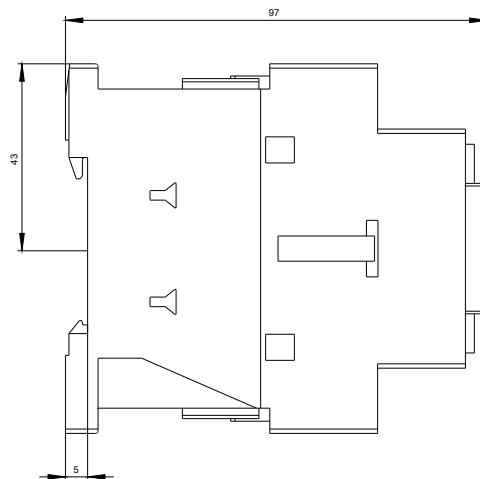
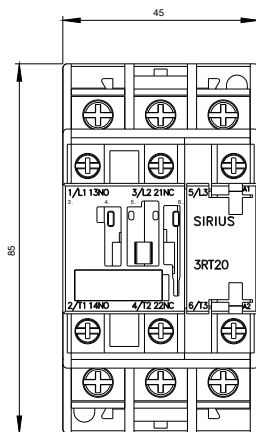

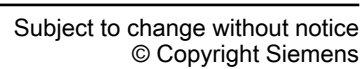

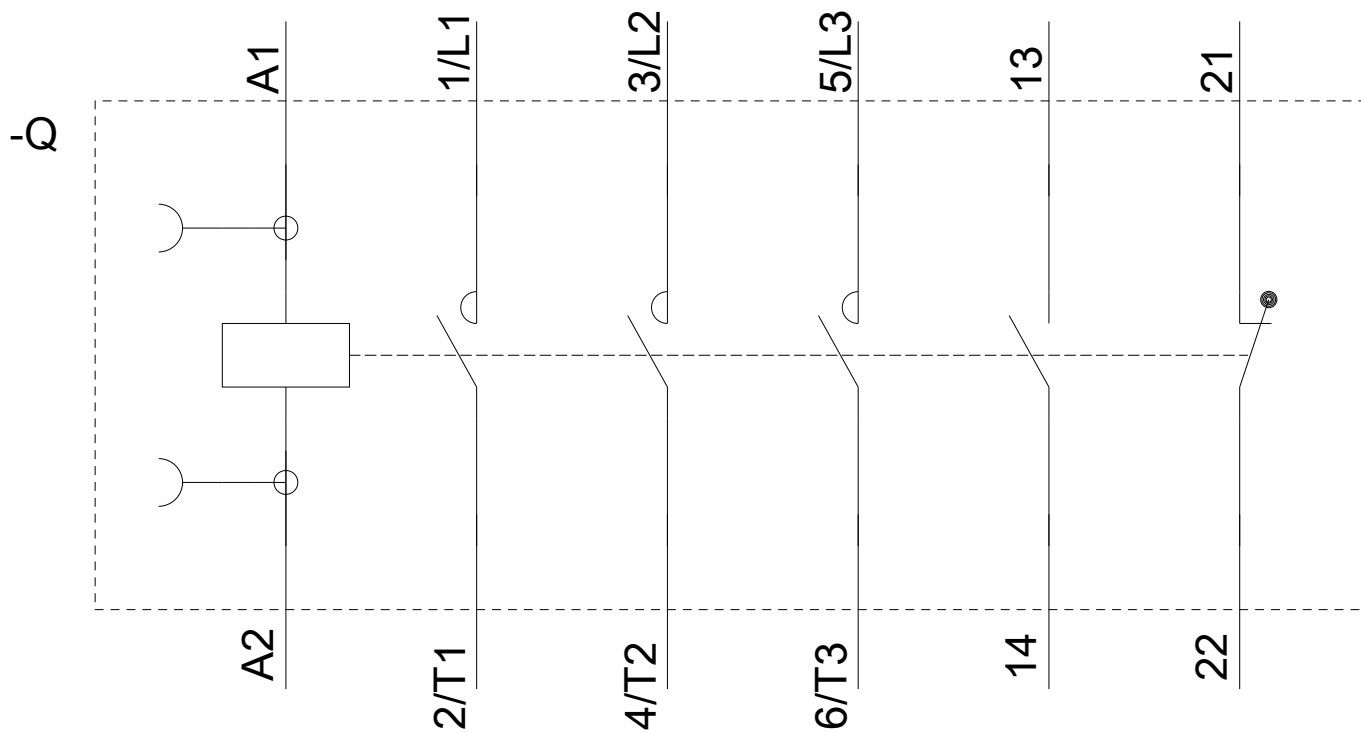

last modified:

09/08/2020