

NEMA SIZE 2 STARTER  
3-POLE POLYPHASE - 600 VAC, 50-60 HZ

NEMA SIZE	CONTINUOUS CURRENT RATINGS
2	45

COIL VOLTAGE CODE (1)	VOLTAGE	
	60 HZ	50 HZ
V01	24	-
V02	120#	110
V08	208	-
V03	240	220
V06	480	440
V07	600	550
V99	SPECIFY	SPECIFY

# = 120 Volt Polyphase starters are wired for separate control.

TYPE CODE (3)	SOLID STATE OVERLOAD RELAY PROTECTION
H10	CLASS 10
H20	CLASS 20
H30	SELECTABLE CLASS 10/20

MOTOR VOLTS	MAX. HP
200	10
230	15
480	25
575	25

ELECTRICAL CLEARANCE/WIRE BENDING SPACE

MINIMUM TO WALL OR BARRIER TO INSURE ADEQUATE WIRE BENDING SPACE TO LUG SURFACE WHEN THE MAXIMUM WIRE SIZE IS USED. REF. NEC 430-10

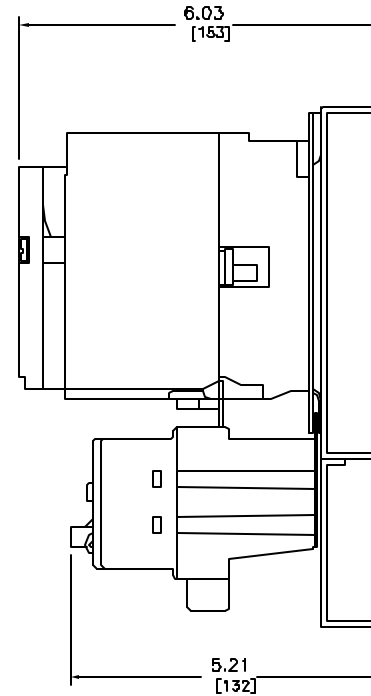
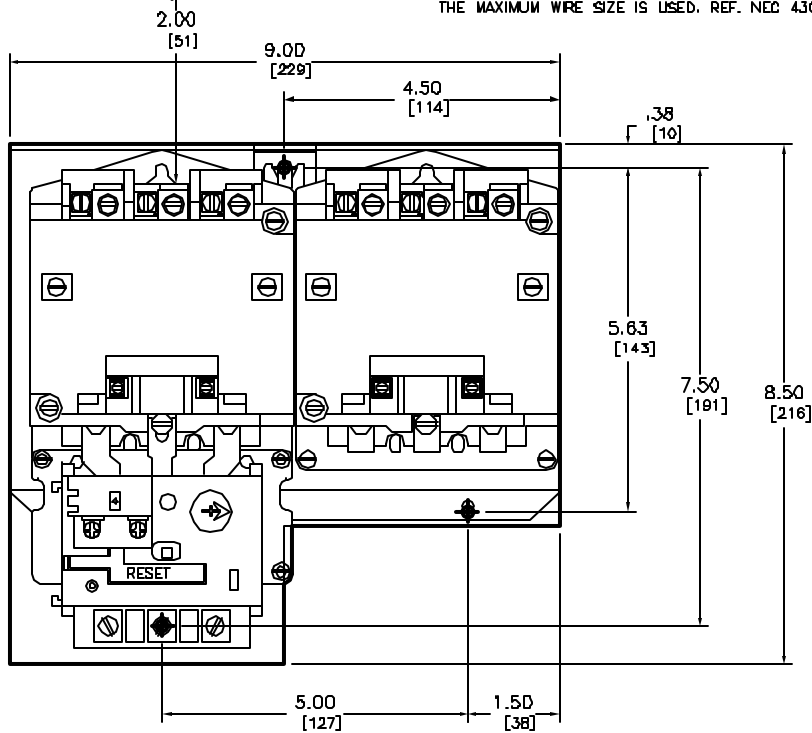

Catalog Number: 8736-S002(1)(3)  
 Ratings: SEE CHART  
 UL File/CCN: NLDX  
 CSA File/Class: 32011-04  
 Meets Standards: -  
 Weight: 12.27 lbs  
 Wire Size: POWER - #14-#4, CONTROL - #10-12  
 Terminal torque: 50 lb./in. (POWER)  
 Mounting Hwd.: (3) #10 screws

DUAL DIMENSIONS: INCHES  
MILLIMETERS

NEMA SIZE 2 REVERSING STARTER W/SSOLR  
CLASS 8736 TYPE S002(1) (3)



DWG# E0320901-01  
NO.