



## Main

Range of Product	Telemecanique Cabling components
Accessory / separate part category	Cabling accessories
Accessory / Separate Part Type	Connector
Electrical connection	Elbowed female connector DIN 43650 A, 4 pins
Status LED	Without
Cable connection	Screw terminal 0.00 in <sup>2</sup> (1.5 mm <sup>2</sup> ) 0.28...0.39 in (7...10 mm)

## Complementary

Cable gland type	Pg 11
Cable connector fixing	Locking screw
[Ue] rated operational voltage	250 V AC
Line Rated Current	16 A
Enclosure Material	Plastic
Minimum insulating resistance	0.1 GΩ
Contact resistance	4000 μOhm
Product Weight	0.08 lb(US) (0.035 kg)

## Environment

IP Degree of Protection	IP65
Ambient Air Temperature for Operation	-40...257 °F (-40...125 °C)

## Ordering and shipping details

Category	22483-MACHINE CABLES
Discount Schedule	DS3
GTIN	3389110833959
Returnability	Yes
Country of origin	DE

## Packing Units

Unit Type of Package 1	PCE
Number of Units in Package 1	1
Package 1 Height	1.18 in (3 cm)
Package 1 Width	3.94 in (10 cm)
Package 1 Length	3.94 in (10 cm)
Package 1 Weight	1.16 oz (33 g)
Unit Type of Package 2	S02
Number of Units in Package 2	50
Package 2 Height	5.91 in (15 cm)
Package 2 Width	11.81 in (30 cm)
Package 2 Length	15.75 in (40 cm)
Package 2 Weight	4.33 lb(US) (1.962 kg)

Offer Sustainability

California proposition 65	WARNING: This product can expose you to chemicals including: Diisononyl phthalate (DINP), which is known to the State of California to cause cancer, and Di-isodecyl phthalate (DIDP), which is known to the State of California to cause birth defects or other reproductive harm. For more information go to <a href="http://www.P65Warnings.ca.gov">www.P65Warnings.ca.gov</a>
REACH Regulation	<a href="#">REACH Declaration</a>
EU RoHS Directive	Pro-active compliance (Product out of EU RoHS legal scope) <a href="#">EU RoHS Declaration</a>
Mercury free	Yes
RoHS exemption information	<a href="#">Yes</a>

Contractual warranty

Warranty	18 months
----------	-----------

## Dimensions

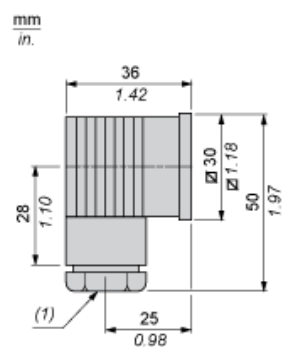

(1) Pg 11 cable gland

---

## Connections and Schemes

---

