

# Product data sheet

Specifications

SQUARE D



Surge protection device, XDSE, 150kA, 120/240 VAC, 1 phase, 3 wire, SPD type 2

SSP01XDSE15A

**To be discontinued on:** 28 February 2023

**To be discontinued**

**Product availability :** Stock - Normally stocked in distribution facility

**Price\* :** 3,200.00 USD

## Main

**Product** Surge protection device

## Complementary

Surge Current	150 A per phase
Voltage Rating	120/240 V AC
Number of Phases	1 phase
Wiring Configuration	3-wire (isolated ground)
MCOV	150 V
Rated Current	20 kA
Input voltage	700 V L-N 700 V L - G 600 V L - L 1000 V N - G
Height	5.98 in (152 mm)
Width	5.98 in (152 mm)
Depth	3.98 in (101 mm)

## Environment

**Enclosure Rating** NEMA 4X

## Ordering and shipping details

Category	08466-SURGE PROTECTION HWA
Discount Schedule	DE1B
GTIN	785901085027
Returnability	Yes
Country of origin	MX

## Packing Units

**Unit Type of Package 1** PCE

\* Price is “List Price” and may be subject to a trade discount – check with your local distributor or retailer for actual price.

Number of Units in Package 1	1
Package 1 Height	5.98 in (15.2 cm)
Package 1 Width	5.98 in (15.2 cm)
Package 1 Length	3.98 in (10.1 cm)
Package 1 Weight	3.91 lb(US) (1.774 kg)

Offer Sustainability

California proposition 65	WARNING: This product can expose you to chemicals including: DINP, which is known to the State of California to cause cancer, and DIDP, which is known to the State of California to cause birth defects or other reproductive harm. For more information go to <a href="http://www.P65Warnings.ca.gov">www.P65Warnings.ca.gov</a>
EU RoHS Directive	Compliant <a href="#">EU RoHS Declaration</a>
Mercury free	Yes
China RoHS Regulation	<a href="#">China RoHS declaration</a> Product out of China RoHS scope. Substance declaration for your information.
RoHS exemption information	<a href="#">Yes</a>

Dimensions

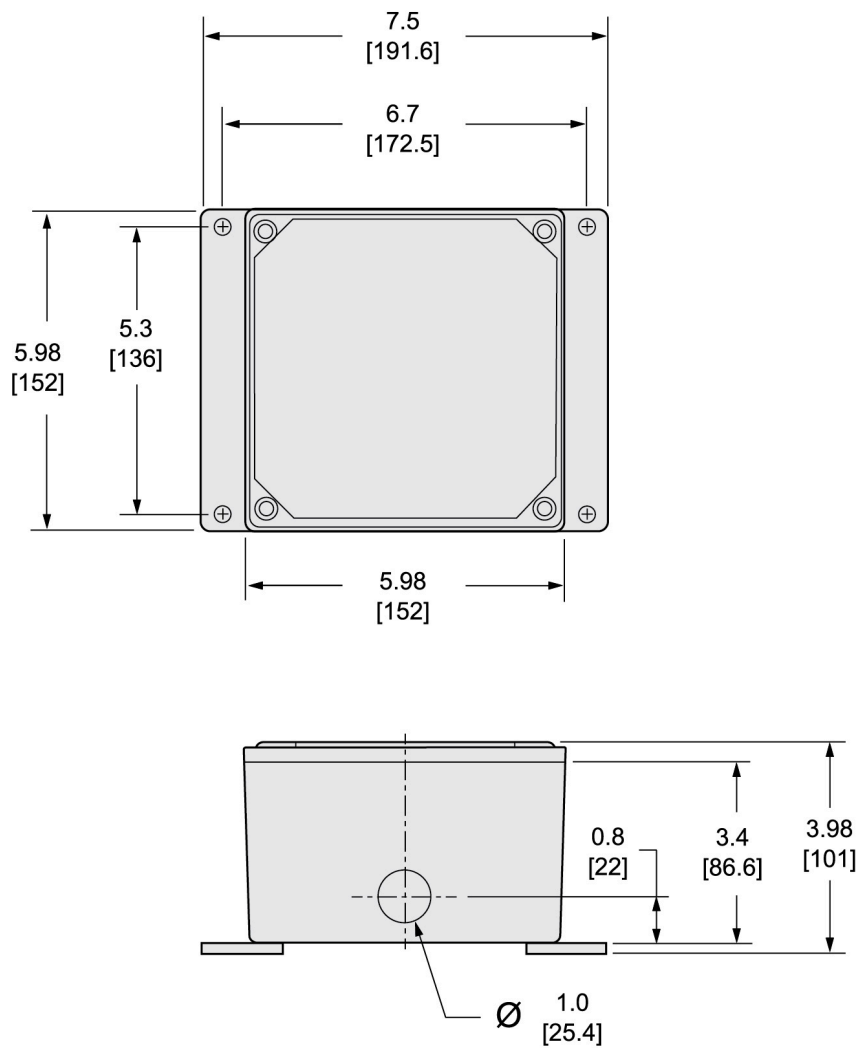

TYPE XDSE

ALL DIMENSIONS ARE APPROXIMATE.  
REFER TO TECHNICAL DRAWINGS AND DOCUMENTATION FOR COMPLETE INFORMATION.

Recommended replacement(s)