

Circularity Profile

TeSys D

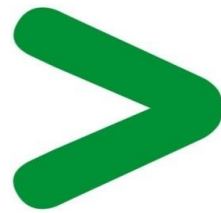

Potential disassembly risks

The Cicularity profile provides information about preparation for re-use and treatment. It identifies the relevant EEE components and materials as well as their location. Safety instructions for product dismantling and depollution are provided into the User manual or maintenance guide.

End of Life Instructions

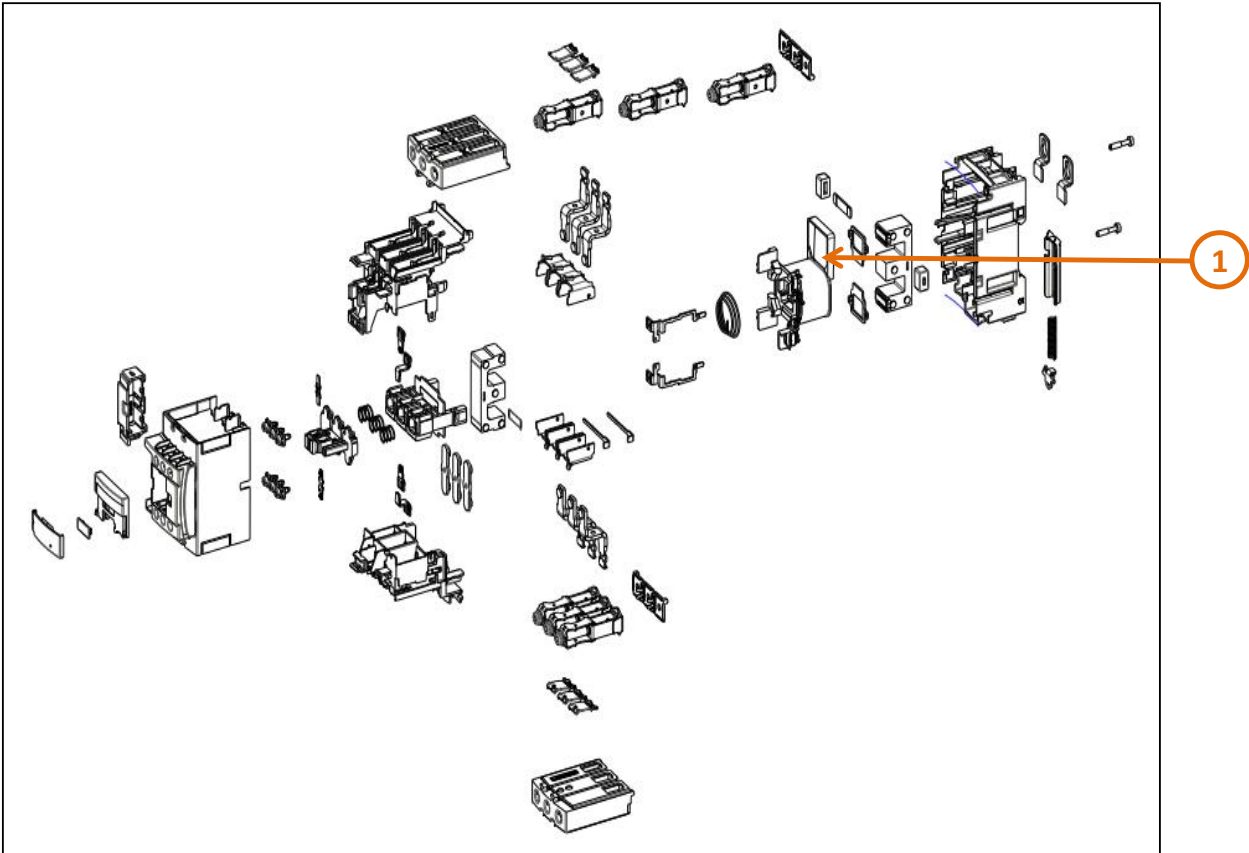

Recommendation	Number on drawing	Component / Material	Weight (in g)	Comment
To be depolluted	1	Plastic parts with brominated FR	17,8 g	



Product description

Manufacturer identification	Schneider Electric Industries SAS
Brand name	Schneider-Electric
Product function	Three-poles contactor for motorized applications from 22kW to 400V. The data used to make this PEP are the most representative of the product studied. No missing data is to be declared.
Product reference	LC1D50AP7
Additional similar product references	LC1D50AP7 LC1D5065M6 LC1D5065M7 LC1D5065SD LC1D5065SW LC1D5065U6 LC1D506B7 LC1D505W6 LC1D505WD LC1D505X6 LC1D505XD LC1D505Y5 LC1D505Z5 LC1D505Z7 LC1D505ZD LC1D40F7S167 LC1D40F7TQ LC1D40FE7S167 LC1D405SD LC1D5065B5 LC1D5065B7 LC1D5065BD LC1D5065BW LC1D5065CW LC1D5065F5 LC1D5065F7 LC1D5065G5 LP1D65004SD LP1D65004TD LC1D40ED LC1D40EW LC1D40F5
Total representative product mass	848 g
Representative product dimensions	118 x 55 x 117
Date of information release	01/2020



Additional information

Legal information	This product family is in the scope of European Union directive 2012/19/EU on Waste Electrical and Electronic Equipment (WEEE). The product family must be disposed according to the legislation of the country. This document is intended for use by end of life recyclers or treatment facilities. It provides the basic information to assure an appropriate end of life treatment for the components and materials of the product.	
Recyclability potential	60%	Based on "ECO'DEEE recyclability and recoverability calculation method" (version V1, 20 Sep. 2008 presented to the French Agency for Environment and Energy Management: ADEME).

Schneider Electric Industries SAS
 ROSELYNE THAI
 roselyne.thai@schneider-electric.com

35, rue Joseph Monier
 CS 30323
 F- 92506 Rueil Malmaison Cedex
 RCS Nanterre 954 503 439
 Capital social 896 313 776 €

www.schneider-electric.com

ENVEOLI1503009

Published by Schneider Electric

© 2019 - Schneider Electric – All rights reserved

01/2020