

# Product End-of-Life Instructions

## Kinos ZART wireless remote control

### Product Range

Kinos ZART wireless remote control

### Marketing Model

ZART8L, ZART8D, ZART12D

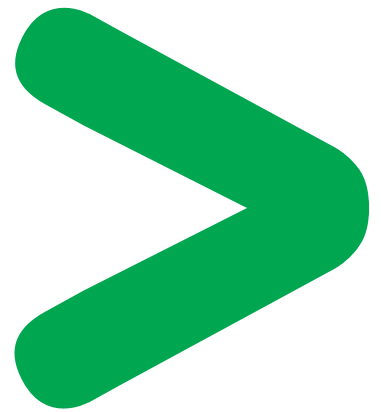

### Size in mm:

H x L x D : 330 x 90 x 80

### Weight (including packaging) in g:

723 (Without the battery : 680)



## Operations recommended for the end of life treatment

There are several steps to process the products at the end of life so as to recover components, materials or energy :

Reuse ⇒ Separation for special treatment ⇒ Other Dismantling ⇒ Shredding

The components of the products that optimize the recycling performances are listed, identified and located hereunder.

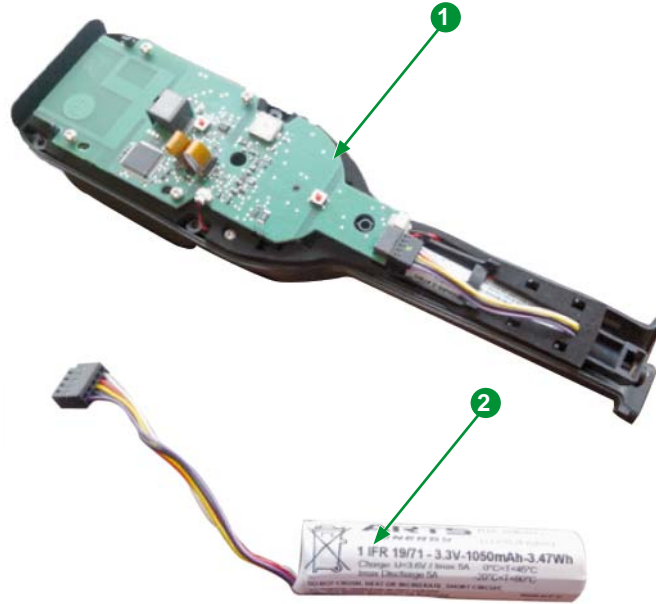

Recommendation	Number on drawing	Components	Weight (g)	Comment
Special treatment	①	Printed circuit board	52	Separate for depollution
	②	Battery	43	–

### Schneider Electric Industries SAS

35, rue Joseph Monier  
CS30323  
F - 92506 Rueil Malmaison Cedex

RCS Nanterre 954 503 439  
Capital social 896 313 776 €  
www.schneider-electric.com

The version of the Guide used to create the document: End of Life Instruction Drafting Guide of Schneider Electric version V1.

Publication : Schneider Electric