

Circularity Profile

TeSys D LC1 D115-D150

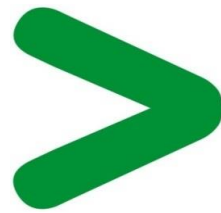

 **Potential disassembly risks**

The Cicularity profile provides information about preparation for re-use and treatment. It identifies the relevant EEE components and materials as well as their location. Safety instructions for product dismantling and depollution are provided into the User manual or maintenance guide.

 **End of Life Instructions**

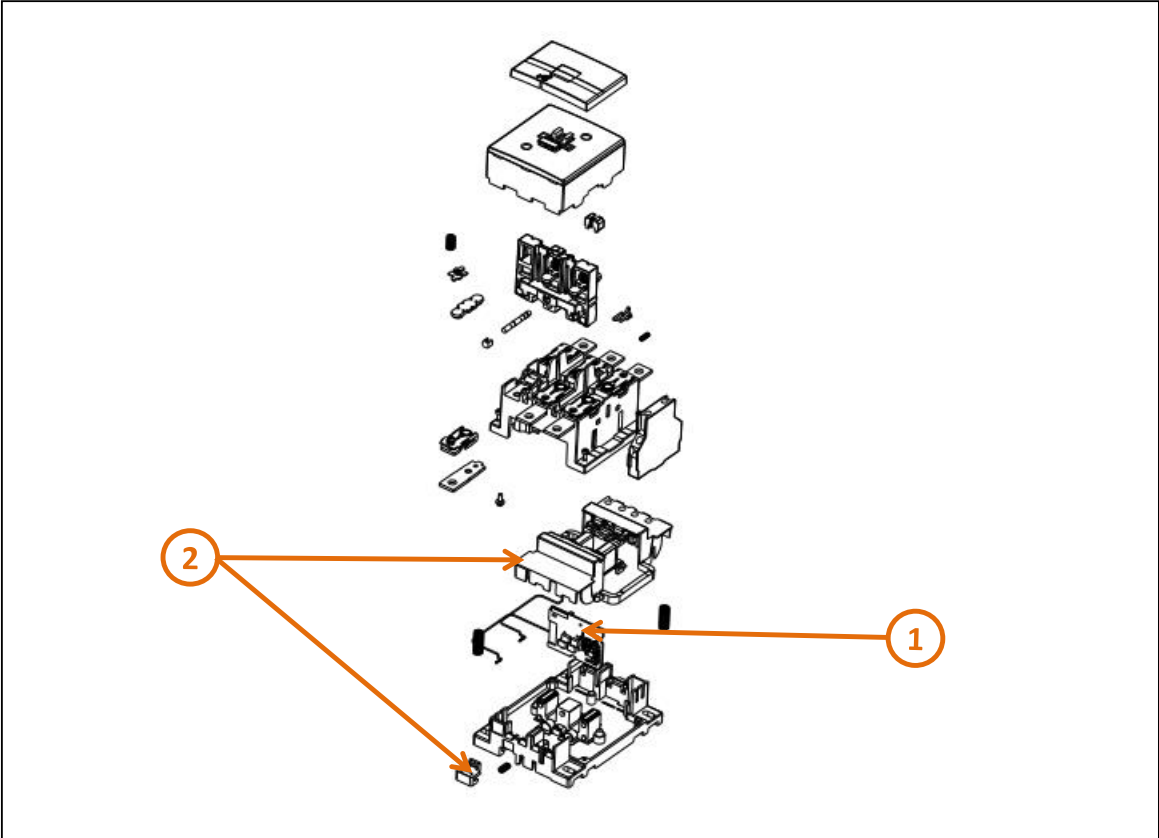

| Recommendation | Number on drawing | Component / Material | Weight (in g) | Comment |
|------------------|-------------------|----------------------------------|---------------|---------|
| To be depolluted | 1 | Electronic Board | 19 g | |
| To be depolluted | 2 | Plastic parts with brominated FR | 149,8 g | |



Product description

| | |
|---------------------------------------|--|
| Manufacturer identification | Schneider Electric Industries SAS |
| Brand name | Schneider-Electric |
| Product function | Three pole contactor for motorized applications up to 55 kW at 400 V. The data used to make this PEP are the most representative of the product studied. No missing data is to be declared. |
| Product reference | LC1D115P7 |
| Additional similar product references | LC1D115P7 CHLKITCONLC4 LC1D1150046B5 LC1D1150046B7 LC1D1150046BD LC1D1150046E5 LC1D1150046E7 LC1D1150046ED LC1D1150046F5 LC1D1150046F7 LC1D1150046FD LC1D1150046FE5 LC1D1150046FE7 LC1D1150046GD LC1D1150046M5 |
| Total representative product mass | 2329 g |
| Representative product dimensions | 158 x 110 x 132 |
| Date of information release | 01/2020 |



Additional information

| | | |
|-------------------------|--|---|
| Legal information | This product family is in the scope of European Union directive 2012/19/EU on Waste Electrical and Electronic Equipment (WEEE). The product family must be disposed according to the legislation of the country. This document is intended for use by end of life recyclers or treatment facilities. It provides the basic information to assure an appropriate end of life treatment for the components and materials of the product. | |
| Recyclability potential | 49% | Based on "ECO'DEEE recyclability and recoverability calculation method" (version V1, 20 Sep. 2008 presented to the French Agency for Environment and Energy Management: ADEME). |

Schneider Electric Industries SAS

ROSELYNE THAI

roselyne.thai@schneider-electric.com

35, rue Joseph Monier

CS 30323

F- 92506 Rueil Malmaison Cedex

RCS Nanterre 954 503 439

Capital social 896 313 776 €

www.schneider-electric.com

Published by Schneider Electric

ENVEOLI100405EN

© 2019 - Schneider Electric – All rights reserved

01/2020