

# Row Expander PDU

## For 220–240 V Countries Installation Guide

### IMPORTANT SAFETY INSTRUCTIONS

**SAVE THESE INSTRUCTIONS** - This safety section contains important instructions that must be followed during installation and maintenance of APC equipment.

Follow these safety and installation instructions to install the Row Expander PDU in a 1070 mm NetShelter® enclosure or rack.



**Electrical  
Hazard**

- This equipment contains potentially hazardous voltages. Do not attempt to disassemble the unit.
- Ensure that the power cord and sockets are in good condition.
- A licensed electrician is required to install permanently wired equipment.



**Caution**

- The branch wiring in the UPS is the disconnect device for this hardwiring accessory. The overcurrent and short-circuit protection is provided by the hardwiring PDU in the UPS. The PDU must be connected to an installation rated 30-amps, 250 volts.
- Illustrations are representative. Your Row Expander PDU may be different from the rack-mount model shown in this guide.

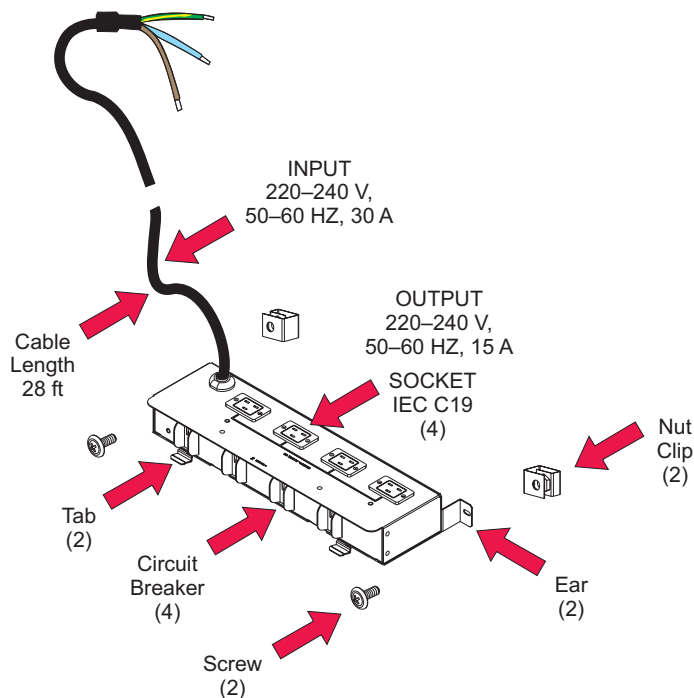

### Overview

The Row Expander PDU unit is designed only for use in a 1070 mm NetShelter or rack and with specific Symmetra products. Contact your APC representative or visit APC's website at [www.apc.com/support](http://www.apc.com/support) for additional information.

If your Row Expander PDU is pre-installed in your system, proceed to the hardwiring instructions contained in this guide.

## Row Expander PDU Installation

1. Slide both nut clips onto the second hole from the bottom U-space in the rack as shown.
2. Secure the Row Expander PDU with the provided screws through the ear holes on the unit and into the nut clips on the rack.



### Note

When using a 1070 NetShelter enclosure, place the Row Expander PDU tabs under the floor mounting panel. If the tabs don't fit in the holes, rest the unit on top of the panel and secure it to the enclosure with the provided screws.

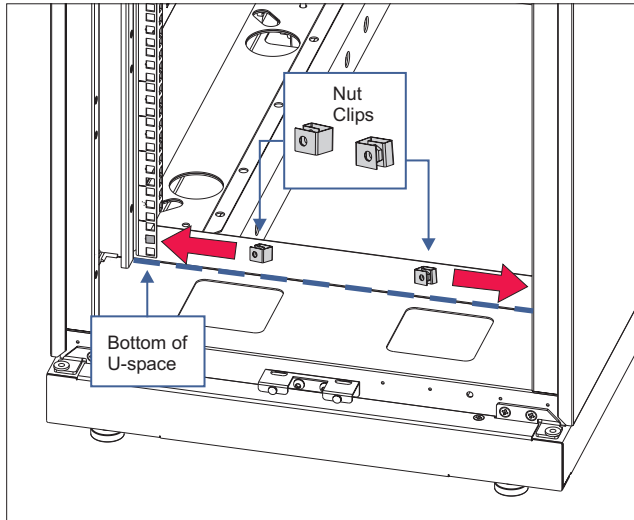

Installing Nut Clips

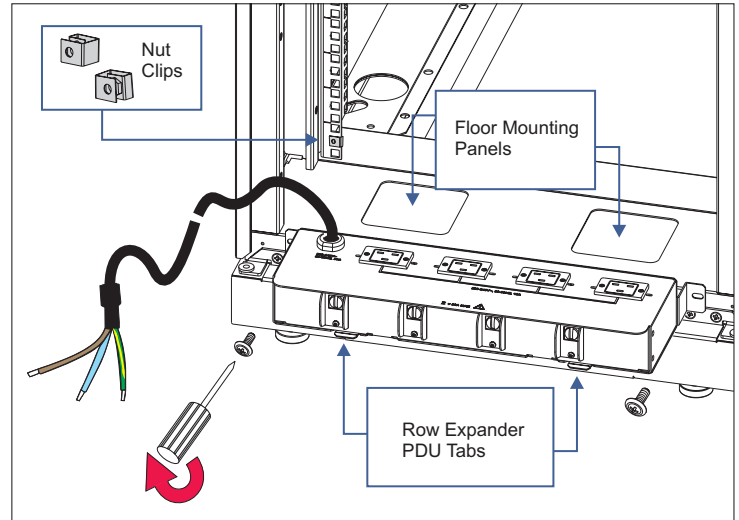

Installing the Row Expander PDU

## Hardwiring Instructions



### Electrical Hazard

- Verify that the hardwire PDU circuit breaker is OFF before installing cables or making connections to the UPS.
- Wiring by a licensed electrician is required.



### Caution

Check national and local codes before wiring.

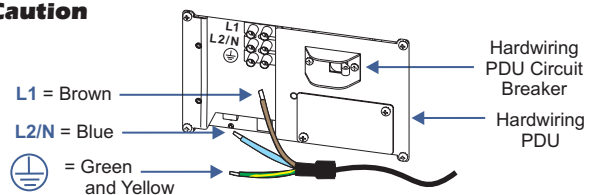

Hardwiring the UPS

1. Verify that the hardwiring PDU circuit breaker for the Row Expander PDU is in the OFF position.
2. Remove the wiring access panel and cable strain relief panel on the hardwiring PDU.
3. Measure the voltage across **L1** to **L2/N**, then  $\oplus$  to **L1**, then  $\oplus$  to **L2/N** to ensure that NO voltage is present.
4. Choose and install the correct strain relief required by national and local codes.
5. Connect the wires to the terminal block as indicated.  
Brown to **L1**    Blue to **L2/N**    Green/Yellow to  $\oplus$
6. Inspect the cable connections to ensure proper installation.
7. Turn ON the UPS hardwiring PDU circuit breaker. If the value does not match your branch voltage (220/230/240), check your wiring for proper connection.
8. Turn OFF the UPS hardwiring PDU circuit breaker and complete the UPS installation by re-installing the wiring access panel and cable strain relief panel. Secure with provided hardware.

