



## Main

Product or component type	Legend holder
Accessory / separate part category	Marking accessory

## Complementary

Material	Plastic
Device composition	Legend holder
Accessory / separate part destination	Ø 22 mm control or signalling unit For built-in-flush head
Range compatibility	Harmony XB5 Harmony XB4
Legend holder size	40 x 60 mm
Sale per indivisible quantity	10
Net Weight	0.00 lb(US) (0.001 kg)

## Ordering and shipping details

GTIN	03606481340641
Nbr. of units in pkg.	1
Package weight(Lbs)	0.07 oz (2 g)

## Packing Units

Unit Type of Package 1	PCE
Package 1 Height	6.69 in (17 cm)
Package 1 width	0.79 in (2 cm)
Package 1 Length	4.72 in (12 cm)
Unit Type of Package 2	BB1
Number of Units in Package 2	10
Package 2 Weight	1.23 oz (35 g)
Package 2 Height	1.18 in (3 cm)
Package 2 width	3.15 in (8 cm)
Package 2 Length	3.94 in (10 cm)
Unit Type of Package 3	S02
Number of Units in Package 3	800
Package 3 Weight	6.60 lb(US) (2.995 kg)
Package 3 Height	5.91 in (15 cm)
Package 3 width	11.81 in (30 cm)
Package 3 Length	15.75 in (40 cm)

## Offer Sustainability

Sustainable offer status	Green Premium product
REACH free of SVHC	Yes
EU RoHS Directive	Pro-active compliance (Product out of EU RoHS legal scope) <a href="#">EU RoHS Declaration</a>
Toxic heavy metal free	Yes
Mercury free	Yes
RoHS exemption information	<a href="#">Yes</a>
China RoHS Regulation	<a href="#">China RoHS Declaration</a>
Environmental Disclosure	<a href="#">Product Environmental Profile</a>
Circularity Profile	<a href="#">End Of Life Information</a>

---

Dimensions

---

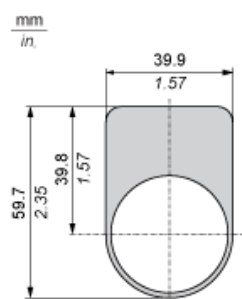

Panel Cut-out for Pushbuttons, Switches and Pilot Lights (Finished Holes, Ready for Installation)

For use on flat surface of a type 4, type 4X, type 12, and type 13

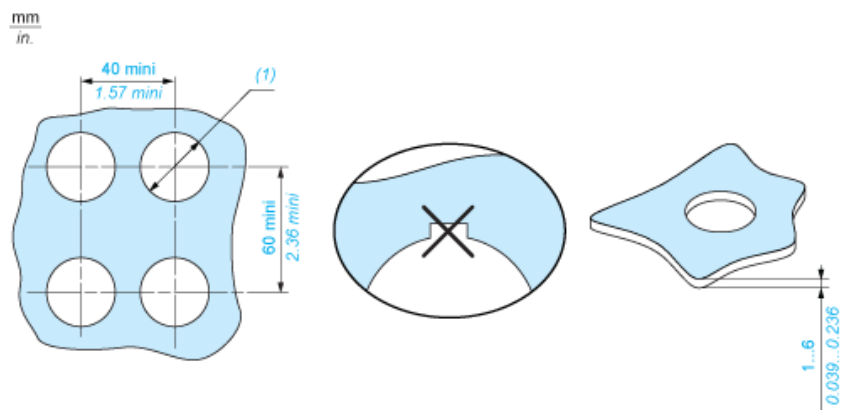

(1) Ø30.75 mm recommended (Ø30.5 mm  $^{+0.5}_0$ ) / Ø1.21 in. recommended (Ø1.20 in.  $^{+0.019}_0$ )