

Depth C inches (mm)		
	With Keypad	Without Keypad
No option card	9.29[236.0]	8.27[210.0]
With 1 option card	10.20[259.0]	9.17[233.0]
With 2 options cards	11.10[282.0]	10.08[256.0]

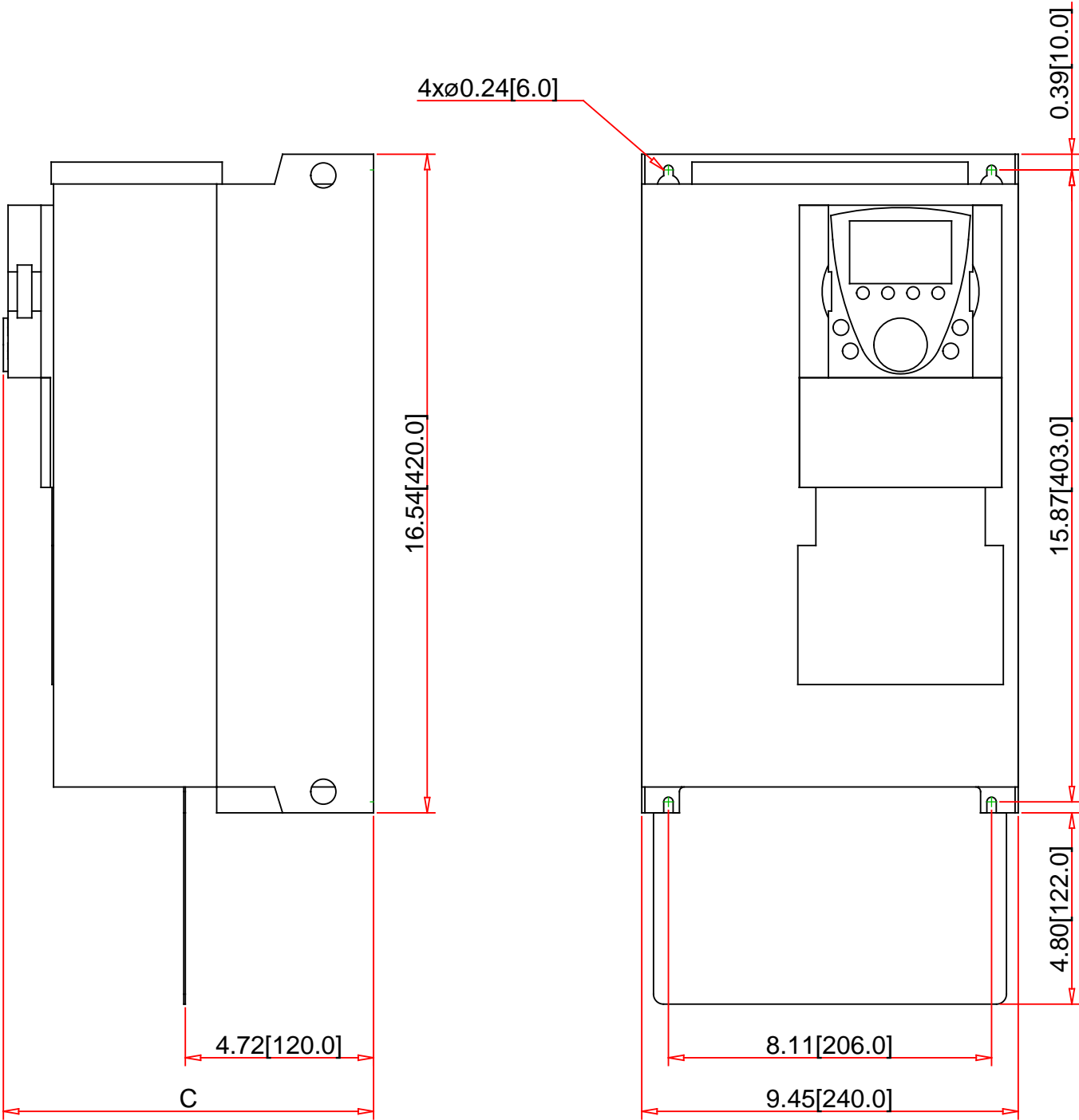

Optional EMC grounding plate is shown, it may be removed if not needed in the application.

Note:
- Drawings Not To Scale
- Drawings Subject to Change Without Notice
- Dimensions are inches next to [Millimeters]
- Inch Dimensions are derived from the metric.

Part No.:

ATV71HU22Y

Schneider Electric United States
North American Division
Boston One Campus
800 Federal Street
Andover, MA 01810, USA
Phone:+1 8773425173
Email: CCC@us.schneider-electric.com

Technical Information:	
Control Voltage:	24Vdc
Logic Input:	6
Analog Input:	2
Analog Output:	1
Communication:	Modbus and CANopen
Logic/Relay Output:	1 NO/NC, 1 NO
Weight [lb/kg]	66.14 / 30
UL File No.:	E116875
CSA File:	1650725
Other:	CE, ABS, DNV, GOST, RoHS, WEEE, C-Tick, NOM 117

Specification:	
Description:	
Family:	Altivar 71
Product Line:	AC Drive
Application:	Constant Torque
Voltage Rating:	575/690VAC
HP Rating / kW Rating:	2 / 2.2
Output Ampere Rating:	2.7A / 4A
Enclosure Rating:	IP20
Frame Size:	6
Input Phase / Output Phase:	3-Phase / 3-Phase