



### Main

Marketing Trade Name	QO
Product	Load Center
Enclosure type	Weatherproof enclosure
Cover type	Surface cover

### Complementary

Tightening torque	Main lugs 50 lb.in, AWG 8, aluminium/copper Main lugs 50 lb.in, AWG 6...AWG 1/0, aluminium/copper
Load Center Type	Main lugs
Line Rated Current	100 A
Number of spaces	8
Short Circuit Current Rating	10 kA
Maximum Number of Single Pole Circuits	16
Maximum Number of Tandem Breakers	8
Number of Phases	1 phase
Voltage Rating	120/240 V AC
Wire Size	AWG 8...AWG 1 aluminium/copper
Electrical Connection	Lugs
Grounding Bar	Grounding bar (ordered separately)
Electrical connection	Lugs
Wiring configuration	3-wire
Busbar Material	Tin plated aluminium busbar
Enclosure Material	Welded galvanized steel
Cover Finish	Baked enamel Gray
Box number	2R
Maximum Height	12.64 in (321 mm)
Maximum Width	8.90 in (226 mm)

### Environment

Enclosure Rating	NEMA 3R outdoor
Ambient air temperature for operation	23 °F (-5 °C) 104 °F (40 °C)
Product certifications	UL Listed

### Ordering and shipping details

Category	00101 - QO 1PH LC,2-8CKT,NEMA 1,3R
Discount Schedule	DE3A
GTIN	00785901785750
Nbr. of units in pkg.	1
Package weight(Lbs)	9.77 lb(US) (4.43 kg)

Returnability	Yes
Country of origin	MX

### Packing Units

Package 1 Height	5.20 in (13.208 cm)
Package 1 width	10.30 in (26.162 cm)
Package 1 Length	14.50 in (36.830 cm)

### Offer Sustainability

Sustainable offer status	Green Premium product
REACH free of SVHC	Yes
EU RoHS Directive	Compliant <a href="#">EU RoHS Declaration</a>
Toxic heavy metal free	Yes
Mercury free	Yes
RoHS exemption information	<a href="#">Yes</a>
China RoHS Regulation	<a href="#">China RoHS Declaration</a>
Environmental Disclosure	<a href="#">Product Environmental Profile</a>

### Contractual warranty

Warranty	18 months
----------	-----------

Approximate Dimensions

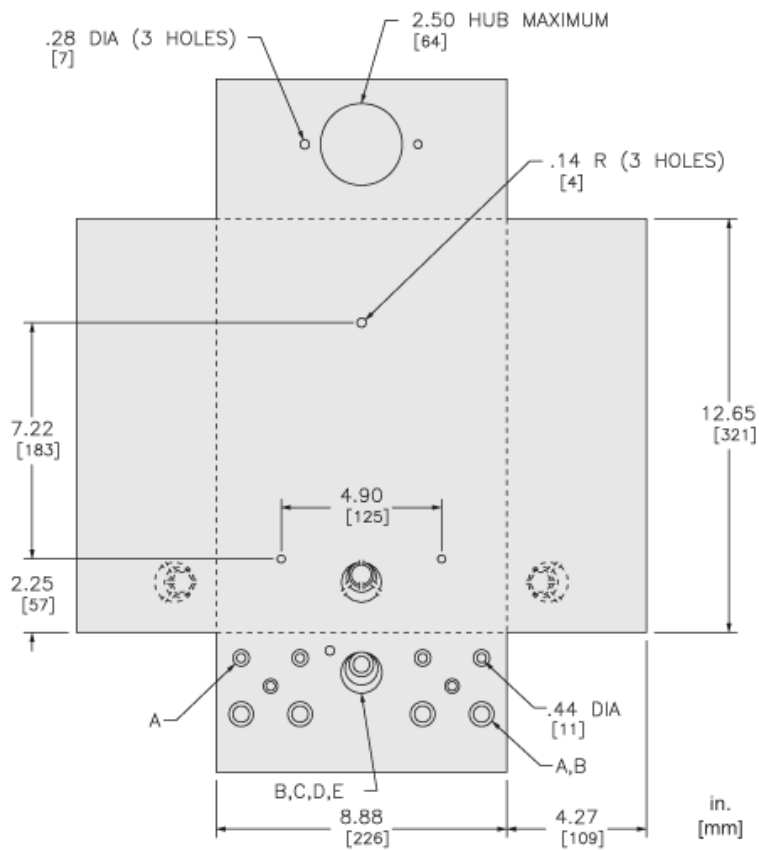

KNOCKOUTS					
SYMBOL	A	B	C	D	E
IN	.50	.75	1.00	1.25	1.50
MM	13	19	25	32	38

---

## Connections and Wiring Diagrams

---

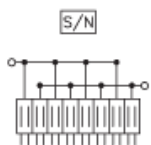

QO816L100RB  
QO816L100RBCU

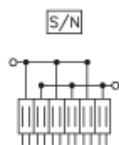

QO612L100RB  
QO612L100RBCU