

NOTES:

- INSTALLATION SHALL COMPLY WITH ALL APPLICABLE NATIONAL, STATE AND LOCAL CODES.
- REFER TO PRODUCT DOCUMENTATION FOR ADDITIONAL DETAILS PRIOR TO INSTALLATION AND SITE PREPARATION WORK.
- ALL DIMENSIONS ARE IN INCHES [MILLIMETERS]. ALL DIMENSIONS ARE TO OUTSIDE EDGE OF THE CABINET, EXCLUDING DOOR LOCK AND ALL HARDWARE.
- FRONT ACCESS REQUIRED FOR SERVICE. MINIMUM REQUIRED FRONT CLEARANCE IS 31.5 [800]. REAR CLEARANCE 4.0 [100] REQUIRED FOR VENTILATION. NO SIDE CLEARANCE REQUIRED. RECOMMENDED CLEARANCE IS SUBJECT TO NATIONAL AND LOCAL CODES.
- INPUT POWER CABLE ENTRY IS THROUGH TOP OR BOTTOM OF IN/OUT CABINET.
- FOR WEIGHT AND CENTER OF GRAVITY OF THE UNIT REFER TO THE TABLE-1 & TABLE-2.
- OPERATING TEMPERATURE: 32°F TO 104°F [0°C TO 40°C].
- DOOR SWING-ROTATES FREELY 180°.
- COLOR: GRAY RAL7035.
- A TORX (T-30) TYPE SCREW DRIVER IS REQUIRED TO REMOVE PANELS.
- POWER CABLES SHALL BE IN SEPARATE CONDUITS FROM CONTROL AND COMMUNICATION CABLES.
- ALL CABLE CONNECTIONS ARE BASED ON CUSTOMER SUPPLIED COPPER WIRE RATED 167°F [75°C].
- FOR NEMA 12 CONFIGURATIONS, REAR FILTERS REQUIRED. TO INSTALL FILTER KIT, GUPXC100F (QTY.-2), OPEN EACH REAR VENTILATION GRILL TO ADD THE FILTER (ALL FILTERS FOR REAR OF THE UPS ARE INCLUDED IN THE KIT).
- PROPER GASKETING FOR NEMA 12 APPLICATION REQUIRED, NOT PROVIDED BY SCHNEIDER ELECTRIC.

TABLE-1

| SYSTEM WEIGHT DETAILS | | |
|-----------------------|--------------|---------------|
| UPS Rating (kVA/kW) | SKU NUMBER | Weight lb[kg] |
| 75 | GUPXC75GFDI | 3900 [1757] |
| 75 | GUPXC75LFDI | 3900 [1757] |
| 100 | GUPXC100GFDI | 4650 [2095] |
| 100 | GUPXC100LFDI | 4650 [2095] |

TABLE-2

| UPS CABINET - CENTER OF GRAVITY DETAILS | | | |
|---|---------------------|---------------------|---------------------|
| UPS Rating kVA/kW | X-Distance inch[mm] | Y-Distance inch[mm] | Z-Distance inch[mm] |
| 75 | 24 [610] | 38 [965] | 15 [381] |
| 100 | 23 [584] | 42 [1067] | 15 [381] |

| TRANSFORMER CABINET-CENTER OF GRAVITY DETAILS | | | |
|---|---------------------|---------------------|---------------------|
| UPS Rating (kVA/kW) | X-Distance inch[mm] | Y-Distance inch[mm] | Z-Distance inch[mm] |
| 75 | 12 [305] | 32 [813] | 18 [457] |
| 100 | 12 [305] | 31 [787] | 18 [457] |

THIS DRAWING AND SPECIFICATIONS HEREIN ARE THE PROPERTY OF SCHNEIDER ELECTRIC AND SHALL NOT BE COPIED, REPRODUCED OR USED IN WHOLE OR IN PART, AS THE BASIS FOR THE MANUFACTURE OR SALE OF ITEMS WITHOUT WRITTEN PERMISSION FROM SCHNEIDER ELECTRIC. THIS DRAWING IS BASED UPON LATEST AVAILABLE INFORMATION AND IS SUBJECT TO CHANGE WITHOUT NOTICE.



TITLE: GUTOR PXC
 UPS 75kW & 100kW WITH INPUT & BYPASS TRANSFORMERS
 Input: 480/600V, 3PH, 60Hz, Dual Mains
 Output: 208, 3PH, 60Hz
 GENERAL ARRANGEMENT
PROJECT: DRAWINGS **SHEET** 1 OF 7

DWG NO: GUPXC75K100FDI **REV.** 0
DRAWN BY: K.NAGENDRA 16-OCT-17 **THIRD**
ENGINEER: I KENNEDY 16-OCT-17 **ANGLE**
APPROVED BY: W WATKINS 16-OCT-17 **PROJECTION**

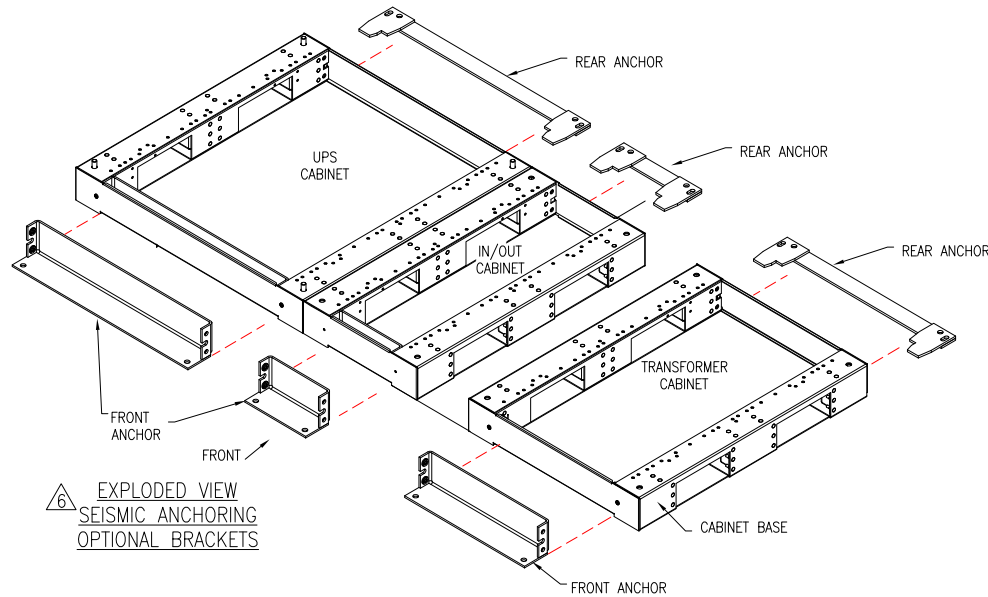
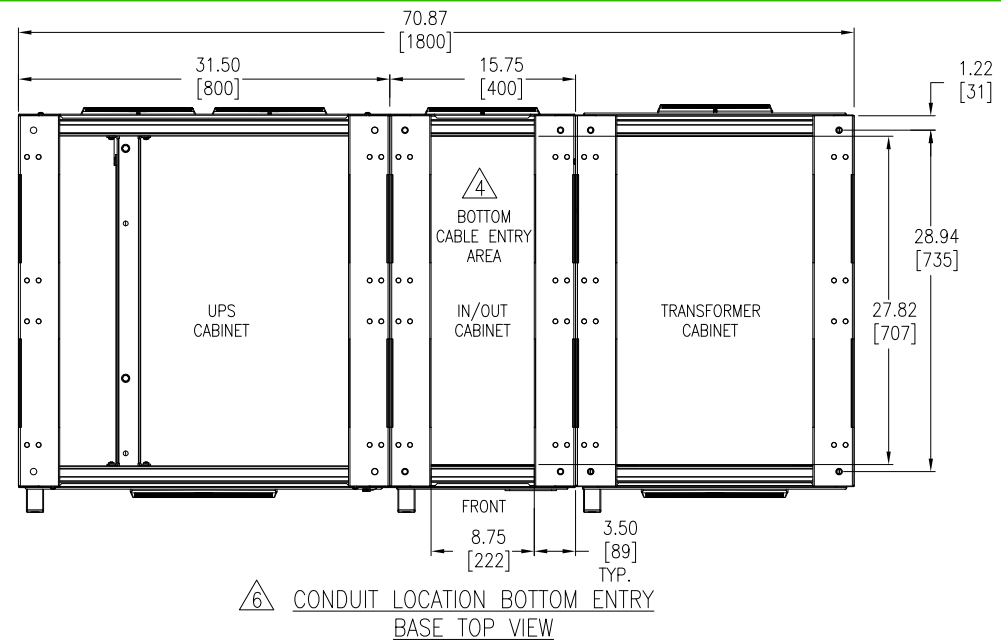
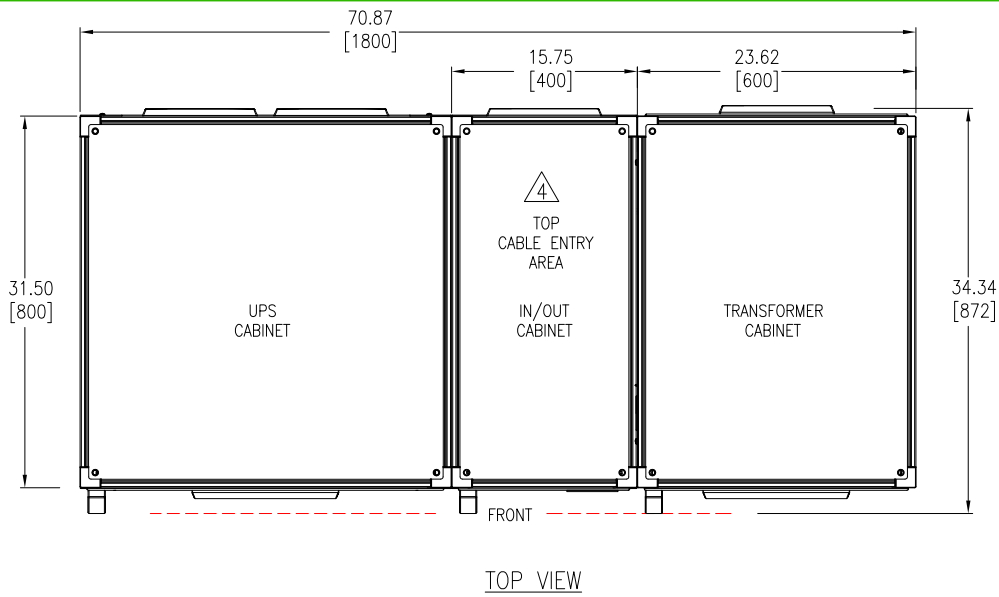

- NOTES:
 1. INSTALLATION SHALL COMPLY WITH ALL APPLICABLE NATIONAL, STATE AND LOCAL CODES.
 2. REFER TO PRODUCT DOCUMENTATION FOR ADDITIONAL DETAILS PRIOR TO INSTALLATION AND SITE PREPARATION WORK.
 3. ALL DIMENSIONS ARE IN INCHES [MILLIMETERS].
 4. DRILL/PUNCH HOLES IN PLATE AS PER THE REQUIREMENT.
 REMOVE PLATE FROM CABINET BEFORE DRILLING/PUNCHING.
 5. FLOOR ANCHORING BOLTS NOT PROVIDED.
 6. SEISMIC ANCHORING WITH OPTIONAL BRACKETS.

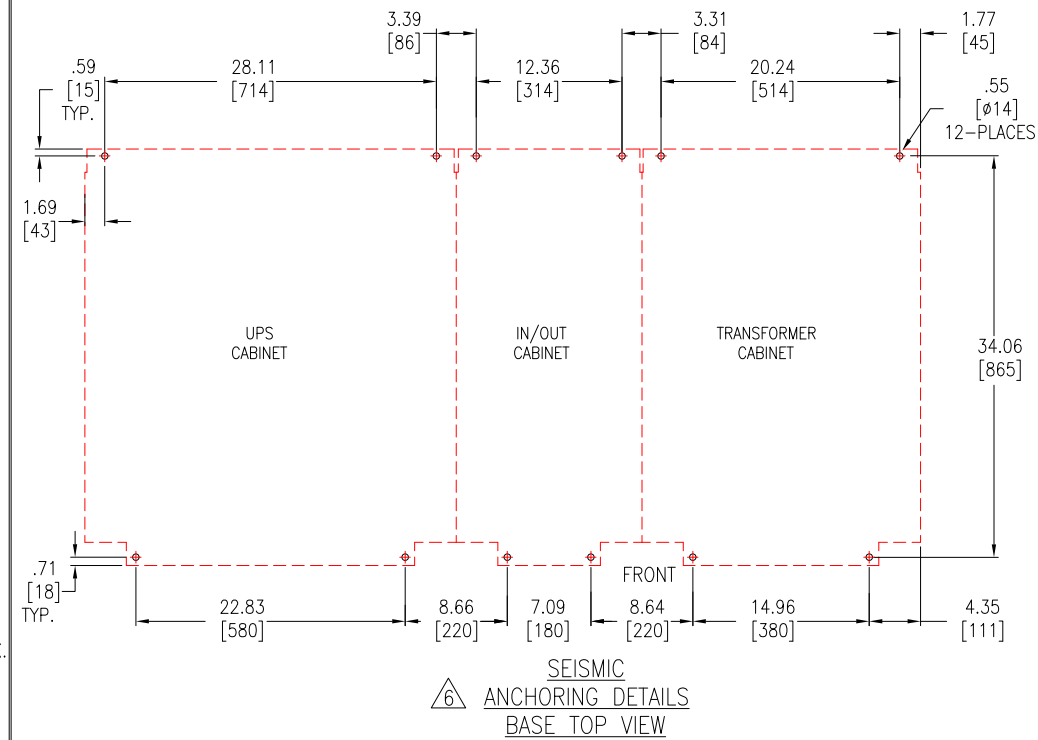

THIS DRAWING AND SPECIFICATIONS HEREIN ARE THE PROPERTY OF SCHNEIDER ELECTRIC AND SHALL NOT BE COPIED, REPRODUCED OR USED IN WHOLE OR IN PART, AS THE BASIS FOR THE MANUFACTURE OR SALE OF ITEMS WITHOUT WRITTEN PERMISSION FROM SCHNEIDER ELECTRIC. THIS DRAWING IS BASED UPON LATEST AVAILABLE INFORMATION AND IS SUBJECT TO CHANGE WITHOUT NOTICE.

Schneider Electric

TITLE: GUTOR PXC
 UPS 75kW & 100kW WITH INPUT & BYPASS TRANSFORMERS
 Input: 480/600V, 3PH, 60Hz, Dual Mains
 Output: 208, 3PH, 60Hz
 TOP & BOTTOM VIEW, ANCHORING
 PROJECT: DRAWINGS SHEET 2 OF 7

| | | | |
|--------------|----------------|-----------|------------|
| DWG NO: | GUPXC75K100FDI | REV. | 0 |
| DRAWN BY: | K.NAGENDRA | 16-OCT-17 | THIRD |
| ENGINEER: | I KENNEDY | 16-OCT-17 | ANGLE |
| APPROVED BY: | W WATKINS | 16-OCT-17 | PROJECTION |

TYPICAL 100kW CONFIGURATION
 {NUMBER OF POWERBLOCKS IS 4 (EACH 25kVA)}

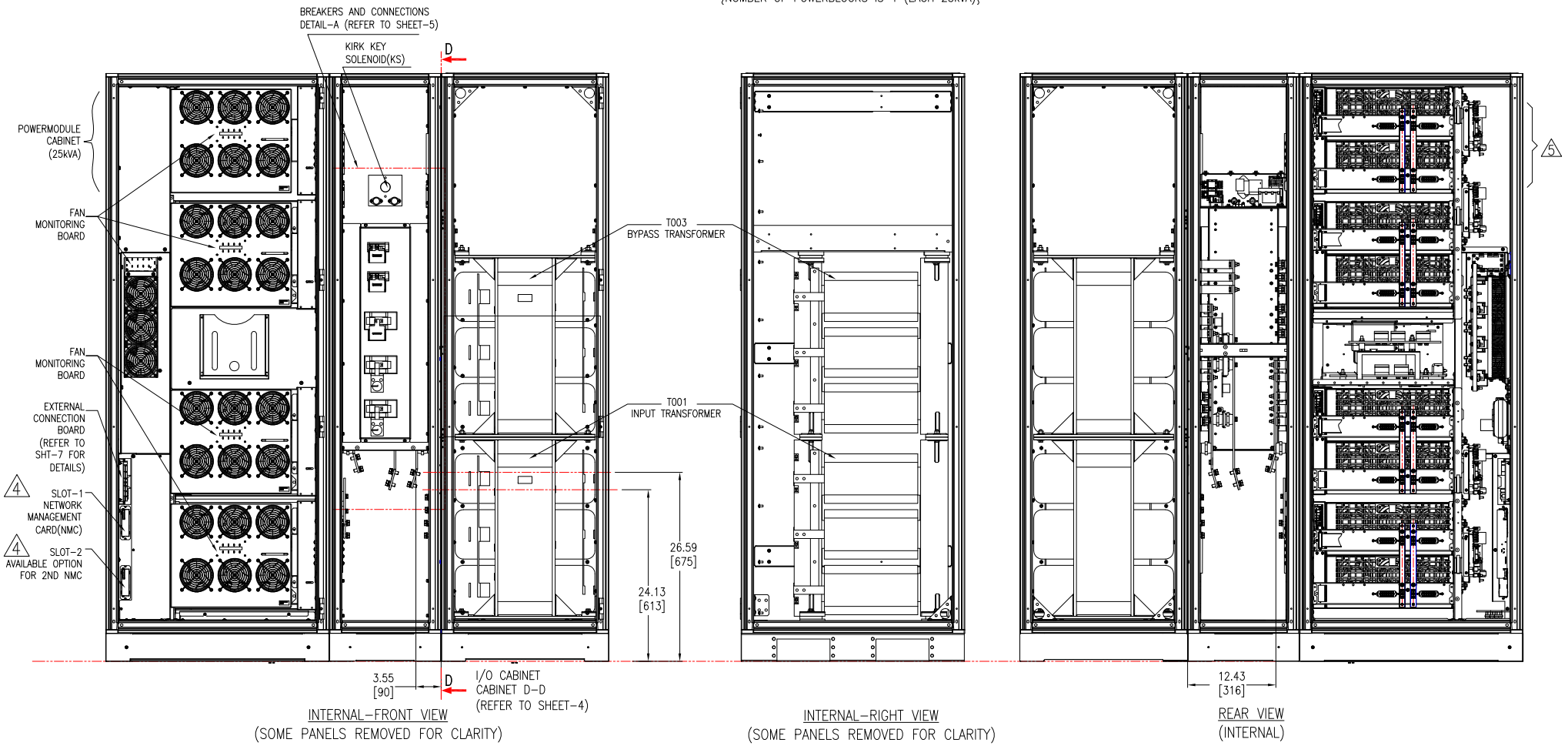

- NOTES:**
1. INSTALLATION SHALL COMPLY WITH ALL APPLICABLE NATIONAL, STATE AND LOCAL CODES.
 2. REFER TO PRODUCT DOCUMENTATION FOR ADDITIONAL DETAILS PRIOR TO INSTALLATION AND SITE PREPARATION WORK.
 3. ALL DIMENSIONS ARE IN INCHES [MILLIMETERS]
 - △ 4. SMART SLOT-1 IS POPULATED WITH A NETWORK MANAGEMENT CARD (NMC) 0M-9635CHGUTOR FROM THE FACTORY. THE SECOND SMART SLOT CAN BE POPULATED WITH ANOTHER NMC AP9635. CONFIGURE BY DOWNLOADING THE LATEST GUTOR PXC FIRMWARE ON THE SCHNEIDER ELECTRIC WEBSITE. FOR DETAILS, REFER TO THE INSTALLATION MANUAL.
 - △ 5. NOT PROVIDED FOR 75kW CONFIGURATION.

| 100kW, 480V-208V | | | UPS BREAKER RATINGS | | |
|------------------|-----------|-------------|---------------------|-----------|-------------|
| DEVICE | RATING | TYPE | DEVICE | RATING | TYPE |
| BIB/UIB | 225A,480V | 3 POLE MCCB | BIB/UIB | 175A,600V | 3 POLE MCCB |
| SSIB/MBB/UOB | 350A,240V | 3 POLE MCCB | SSIB/MBB/UOB | 350A,240V | 3 POLE MCCB |

| 100kW, 600V-208V | | | UPS BREAKER RATINGS | | |
|------------------|-----------|-------------|---------------------|-----------|-------------|
| DEVICE | RATING | TYPE | DEVICE | RATING | TYPE |
| BIB/UIB | 175A,600V | 3 POLE MCCB | BIB/UIB | 175A,600V | 3 POLE MCCB |
| SSIB/MBB/UOB | 350A,240V | 3 POLE MCCB | SSIB/MBB/UOB | 350A,240V | 3 POLE MCCB |

THIS DRAWING AND SPECIFICATIONS HEREIN ARE THE PROPERTY OF SCHNEIDER ELECTRIC AND SHALL NOT BE COPIED, REPRODUCED OR USED IN WHOLE OR IN PART, AS THE BASIS FOR THE MANUFACTURE OR SALE OF ITEMS WITHOUT WRITTEN PERMISSION FROM SCHNEIDER ELECTRIC. THIS DRAWING IS BASED UPON LATEST AVAILABLE INFORMATION AND IS SUBJECT TO CHANGE WITHOUT NOTICE.



TITLE: GUTOR PXC
 UPS 75kW & 100kW WITH INPUT & BYPASS TRANSFORMERS
 Input: 480/600V, 3PH, 60Hz, Dual Mains
 Output: 208, 3PH, 60Hz
 INTERNAL DETAILS-1

PROJECT: DRAWINGS **SHEET** 3 OF 7

DWG NO: GUPXC75K100FDI **REV.** 0

| | | |
|-------------------------------|-----------|------------|
| DRAWN BY: K.NAGENDRA | 16-OCT-17 | THIRD |
| ENGINEER: I KENNEDY | 16-OCT-17 | ANGLE |
| APPROVED BY: W WATKINS | 16-OCT-17 | PROJECTION |

TYPICAL 75kW CONFIGURATION

{FRONT VIEW SHOWN ONLY FOR REFERENCE. NUMBER OF POWERBLOCKS IS 3 (EACH 25kVA), ALL OTHER DETAILS SAME AS 100kW EXCEPT WHERE NOTED}

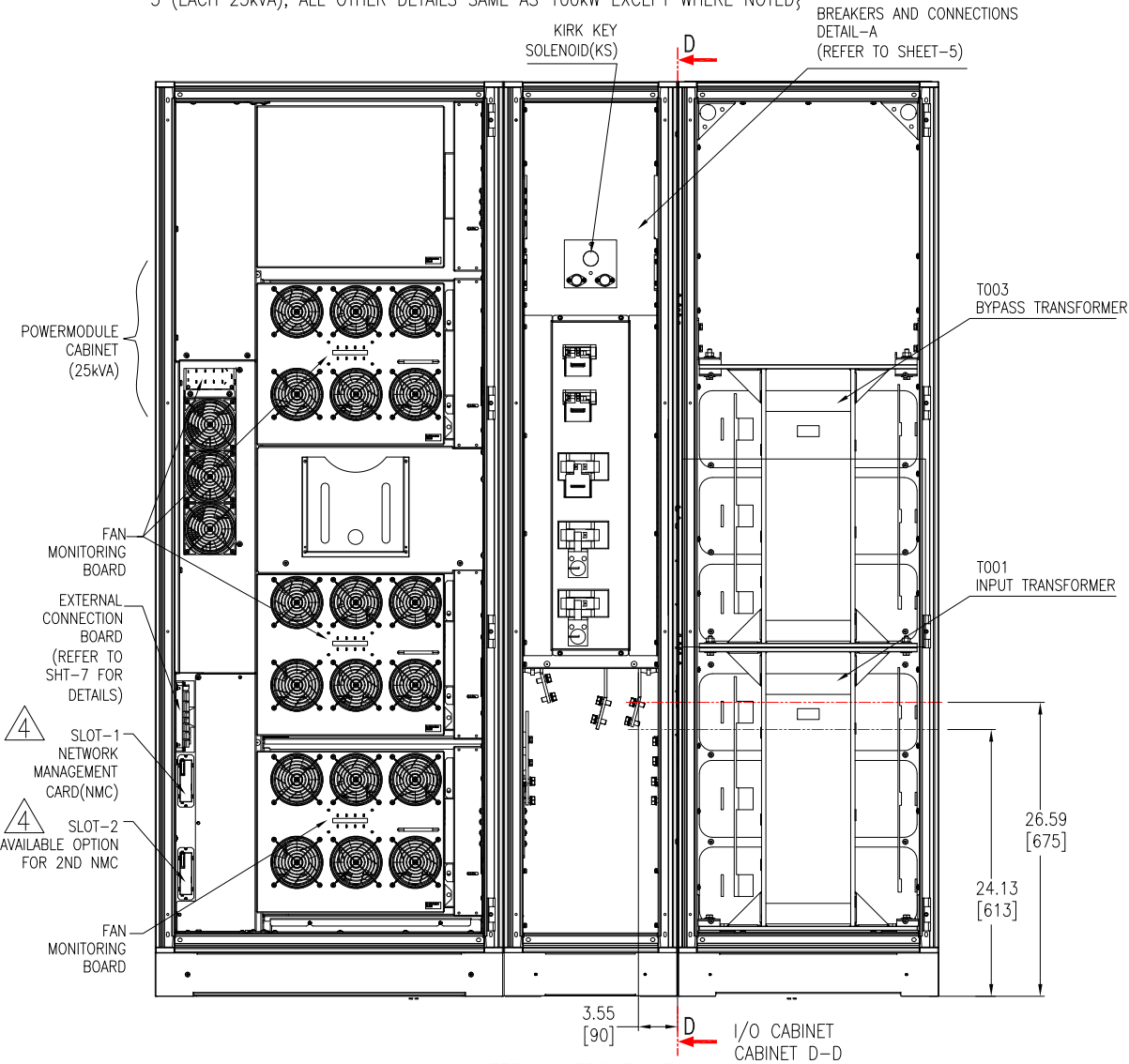

INTERNAL-FRONT VIEW
(SOME PANELS REMOVED FOR CLARITY)

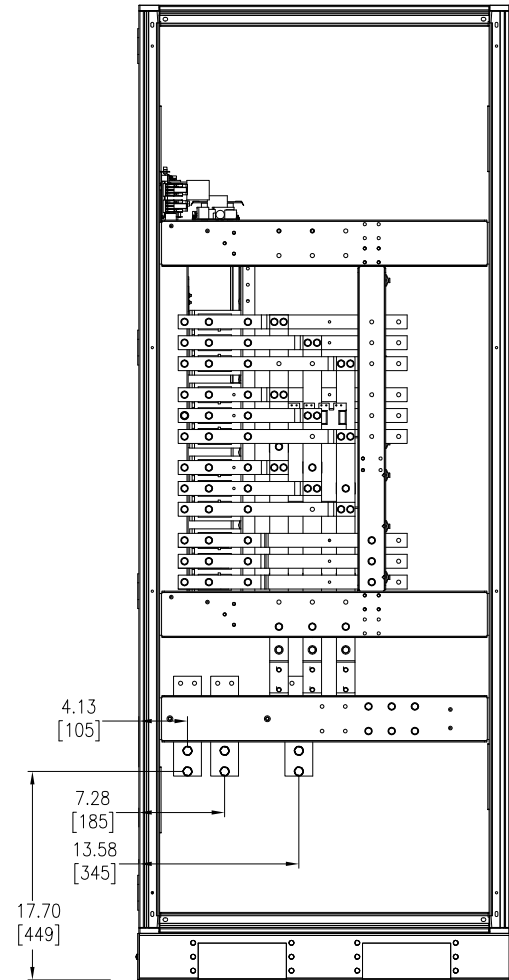

DD-CABINETAL VIEW
(INTERNAL)

NOTES:

1. INSTALLATION SHALL COMPLY WITH ALL APPLICABLE NATIONAL, STATE AND LOCAL CODES.
2. REFER TO PRODUCT DOCUMENTATION FOR ADDITIONAL DETAILS PRIOR TO INSTALLATION AND SITE PREPARATION WORK.
3. ALL DIMENSIONS ARE IN INCHES [MILLIMETERS]
4. SMART SLOT-1 IS POPULATED WITH A NETWORK MANAGEMENT CARD (NMC) 0M-9635CHGUTOR FROM THE FACTORY. THE SECOND SMART SLOT CAN BE POPULATED WITH ANOTHER NMC AP9635. CONFIGURE BY DOWNLOADING THE LATEST GUTOR PXC FIRMWARE ON THE SCHNEIDER ELECTRIC WEBSITE. FOR DETAILS, REFER TO THE INSTALLATION MANUAL.

| 75kW, 480-208V | | UPS BREAKER RATINGS | |
|----------------|-----------|---------------------|--|
| DEVICE | RATING | TYPE | |
| BIB/UIB | 175A,480V | 3 POLE MCCB | |
| SSIB/MBB/UOB | 300A,240V | 3 POLE MCCB | |

| 75kW, 600-208V | | UPS BREAKER RATINGS | |
|----------------|-----------|---------------------|--|
| DEVICE | RATING | TYPE | |
| BIB/UIB | 150A,600V | 3 POLE MCCB | |
| SSIB/MBB/UOB | 300A,240V | 3 POLE MCCB | |

THIS DRAWING AND SPECIFICATIONS HEREIN ARE THE PROPERTY OF SCHNEIDER ELECTRIC AND SHALL NOT BE COPIED, REPRODUCED OR USED IN WHOLE OR IN PART, AS THE BASIS FOR THE MANUFACTURE OR SALE OF ITEMS WITHOUT WRITTEN PERMISSION FROM SCHNEIDER ELECTRIC. THIS DRAWING IS BASED UPON LATEST AVAILABLE INFORMATION AND IS SUBJECT TO CHANGE WITHOUT NOTICE.



TITLE: GUTOR PXC
UPS 75kW & 100kW WITH INPUT & BYPASS TRANSFORMERS
Input: 480/600V, 3PH, 60Hz, Dual Mains
Output: 208, 3PH, 60Hz
INTERNAL DETAILS-2
PROJECT: DRAWINGS SHEET 4 OF 7

DWG NO: GUPXC75K100FDI REV. 0
DRAWN BY: K.NAGENDRA 16-OCT-17 THIRD
ENGINEER: I KENNEDY 16-OCT-17 ANGLE
APPROVED BY: W WATKINS 16-OCT-17 PROJECTION

DUAL MAINS CONNECTION DETAILS

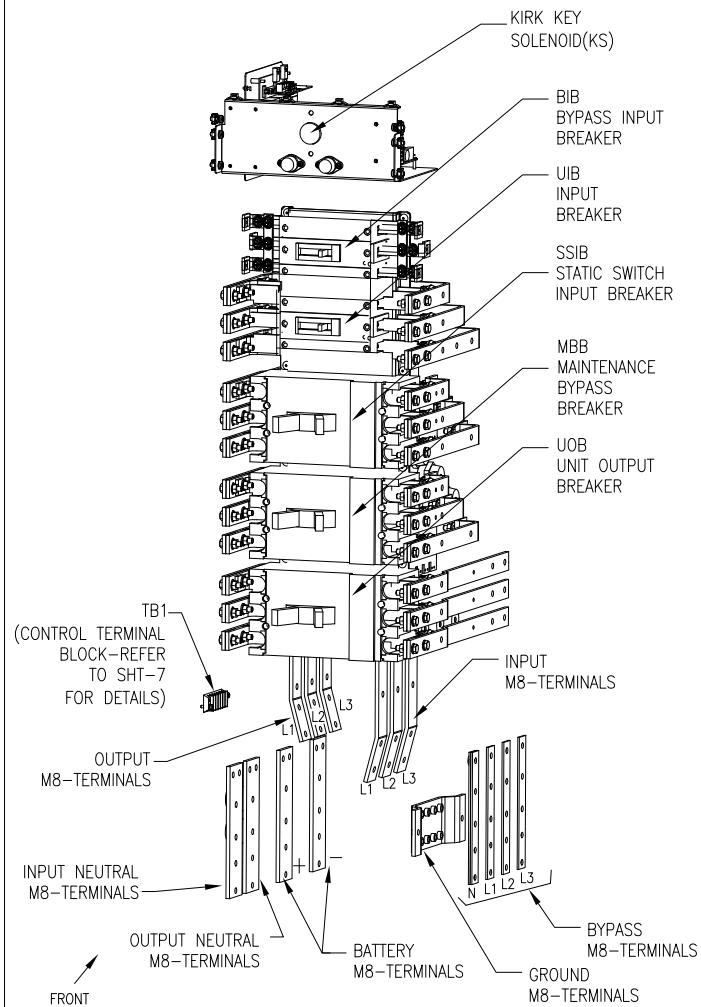

DETAIL-A
BREAKER & CONNECTIONS DETAIL
(ENLARGED ISO-VIEW)

NOTES:

1. INSTALLATION SHALL COMPLY WITH ALL APPLICABLE NATIONAL, STATE AND LOCAL CODES.
2. REFER TO PRODUCT DOCUMENTATION FOR ADDITIONAL DETAILS PRIOR TO INSTALLATION AND SITE PREPARATION WORK.

THIS DRAWING AND SPECIFICATIONS HEREIN ARE THE PROPERTY OF SCHNEIDER ELECTRIC AND SHALL NOT BE COPIED, REPRODUCED OR USED IN WHOLE OR IN PART, AS THE BASIS FOR THE MANUFACTURE OR SALE OF ITEMS WITHOUT WRITTEN PERMISSION FROM SCHNEIDER ELECTRIC. THIS DRAWING IS BASED UPON LATEST AVAILABLE INFORMATION AND IS SUBJECT TO CHANGE WITHOUT NOTICE.



TITLE: GUTOR PXC
UPS 75kW & 100kW WITH INPUT & BYPASS TRANSFORMERS
Input: 480/600V, 3PH, 60Hz, Dual Mains
Output: 208, 3PH, 60Hz
INTERNAL DETAILS-3
PROJECT: DRAWINGS SHEET 5 OF 7

| | | | | |
|--------------|----------------|-----------|------------|---|
| DWG NO: | GUPXC75K100FDI | | REV. | 0 |
| DRAWN BY: | K.NAGENDRA | 16-OCT-17 | THIRD | |
| ENGINEER: | I KENNEDY | 16-OCT-17 | ANGLE | |
| APPROVED BY: | W WATKINS | 16-OCT-17 | PROJECTION | |

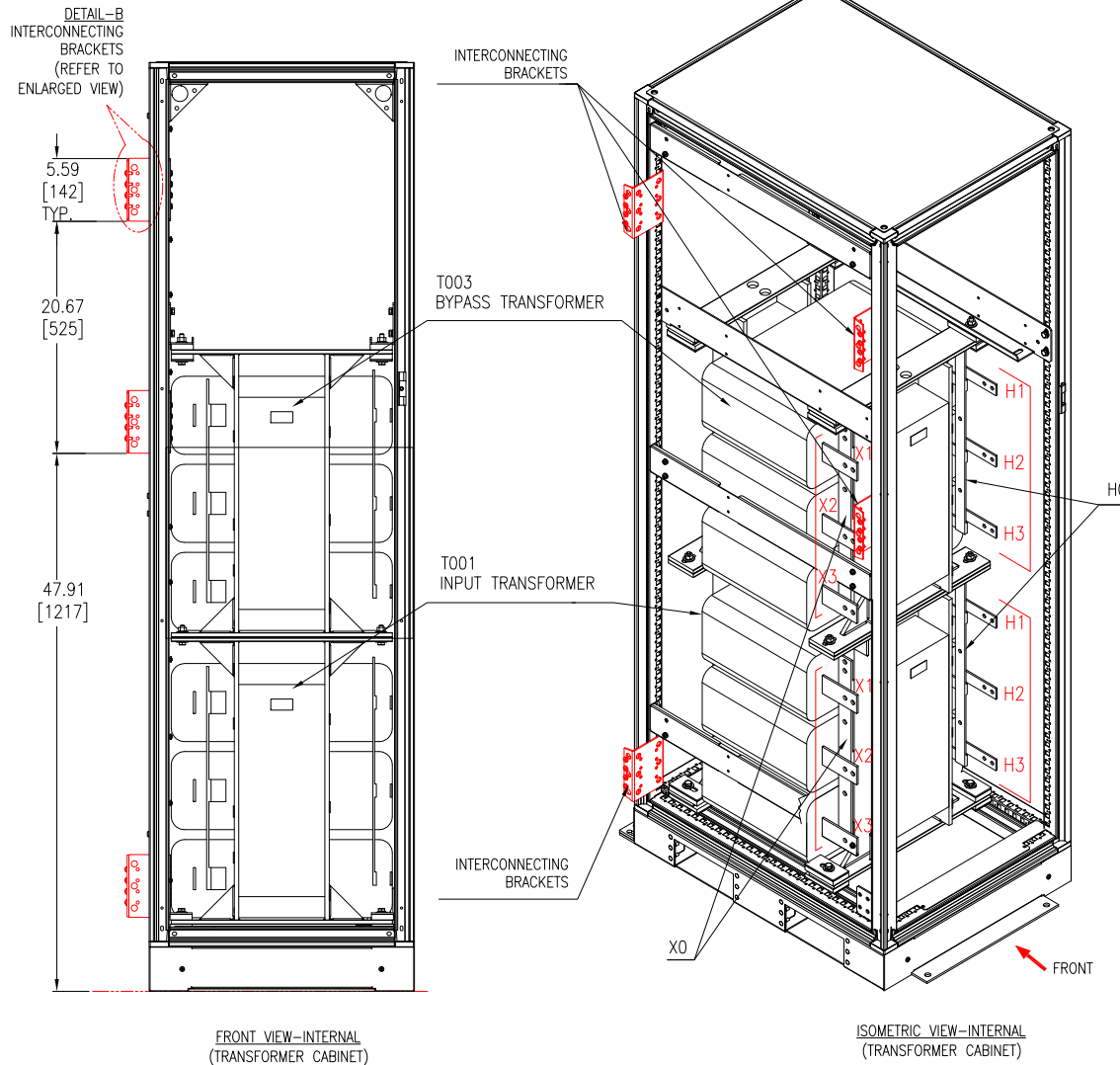

Cabinet Interconnection Detail for Dual Input Transformer

1. REMOVE UPS RIGHT SIDE PANEL AND GROUND STRAP, THEN LINE-UP CABINETS WITH TRANSFORMER CABINET ON THE RIGHT.
2. REMOVE REAR PANEL FROM EACH OF THE CABINETS.
CAUTION: GROUND STRAP MUST BE DISCONNECTED TO REMOVE PANEL.
3. REMOVE DEAD FRONT PANELS FROM UPS AND TRANSFORMER CABINETS.
4. INSTALL CABINET INTERCONNECT BRACKETS, TWO IN FRONT AND TWO IN REAR WHERE SHOWN. USE C-CLAMPS TO HOLD CABINETS TOGETHER. THIS WILL ENABLE THE BRACKETS TO BE INSTALLED MORE EASILY. USE FOUR SCREWS ON EACH SIDE OF THE BRACKETS TO SECURE TO FRAME.
5. CONNECT CABLES FROM UPS CABINET TO INPUT TRANSFORMER (ON BOTTOM)

| | |
|---------------------------------------|--|
| UPS TO INPUT TRANSFORMER-LEFT BUSBARS | UPS TO INPUT TRANSFORMER-RIGHT BUSBARS |
| W001-L1 TO T001-X1 | UIB-LOAD-L1 TO T001-H1 |
| W001-L2 TO T001-X2 | UIB-LOAD-L2 TO T001-H2 |
| W001-L3 TO T001-X3 | UIB-LOAD-L3 TO T001-H3 |
| OUTPUT-N TO T001-X0 | INPUT-N TO T001-H0 |

 CONNECT CABLES FROM UPS CABINET TO BYPASS TRANSFORMER (ON TOP)

| | |
|--|---|
| UPS TO BYPASS TRANSFORMER-LEFT BUSBARS | UPS TO BYPASS TRANSFORMER-RIGHT BUSBARS |
| SSIB-LINE-L1 TO T003-X1 | BIB-LOAD-L1 TO T003-H1 |
| SSIB-LINE-L2 TO T003-X2 | BIB-LOAD-L2 TO T003-H2 |
| SSIB-LINE-L3 TO T003-X3 | BIB-LOAD-L3 TO T003-H3 |
| | BYPASS-N TO T003-H0 |
6. RE-INSTALL REAR PANELS. INSTALL SIDE PANEL AND GROUND STRAP ON THE TRANSFORMER CABINET.
7. REMOVE UPS BOTTOM OR TOP ENTRY CONDUIT PANEL FOR KNOCKOUT. INSTALL KNOCKOUTS AND RE-INSTALL PANEL.
8. REFER TO DETAIL-A TO CONNECT THE CABLES TO THE UPS CABINET.
9. RE-INSTALL DEAD FRONTS.

DETAIL-B INTERCONNECTING BRACKET (ENLARGED VIEW)

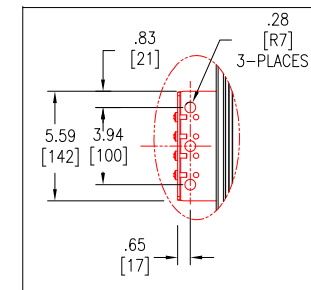

NOTES:

1. INSTALLATION SHALL COMPLY WITH ALL APPLICABLE NATIONAL, STATE AND LOCAL CODES.
2. REFER TO PRODUCT DOCUMENTATION FOR ADDITIONAL DETAILS PRIOR TO INSTALLATION AND SITE PREPARATION WORK.

THIS DRAWING AND SPECIFICATIONS HEREIN ARE THE PROPERTY OF SCHNEIDER ELECTRIC AND SHALL NOT BE COPIED, REPRODUCED OR USED IN WHOLE OR IN PART, AS THE BASIS FOR THE MANUFACTURE OR SALE OF ITEMS WITHOUT WRITTEN PERMISSION FROM SCHNEIDER ELECTRIC. THIS DRAWING IS BASED UPON LATEST AVAILABLE INFORMATION AND IS SUBJECT TO CHANGE WITHOUT NOTICE.

**Schneider
Electric**

TITLE: GUTOR PXC
UPS 75kW & 100kW WITH INPUT & BYPASS TRANSFORMERS
Input: 480/600V, 3PH, 60Hz, Dual Mains
Output: 208, 3PH, 60Hz
INTERNAL DETAILS-4

PROJECT: DRAWINGS SHEET 6 OF 7

DWG NO: GUPXC75K100FDI REV. 0

| | | |
|------------------------|-----------|------------|
| DRAWN BY: K.NAGENDRA | 16-OCT-17 | THIRD |
| ENGINEER: I KENNEDY | 16-OCT-17 | ANGLE |
| APPROVED BY: W WATKINS | 16-OCT-17 | PROJECTION |

EXTERNAL CONNECTION BOARD

THE DIGITAL INPUTS IN THE EXTERNAL CONNECTED BOARDS ARE DESIGNED FOR CONNECTION TO EQUIPMENT INSIDE THE CABINET AND SIGNAL CABLES FROM THESE BOARDS MUST NOT BE ROUTED OUT OF THE CABINET.

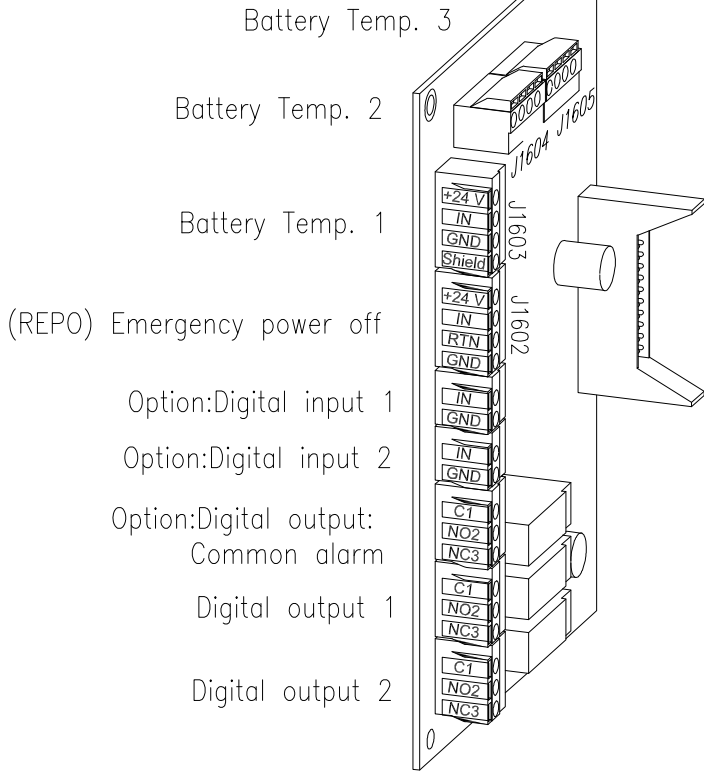

REPO AND SHUNT TRIP DETAILS

REPO WITH INTERNAL SUPPLY UPS

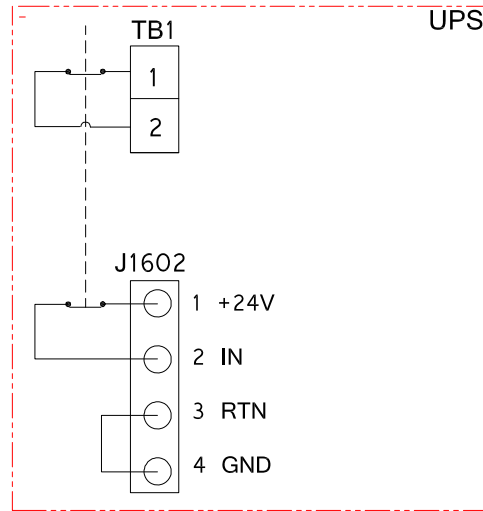

REPO WITH EXTERNAL SUPPLY UPS

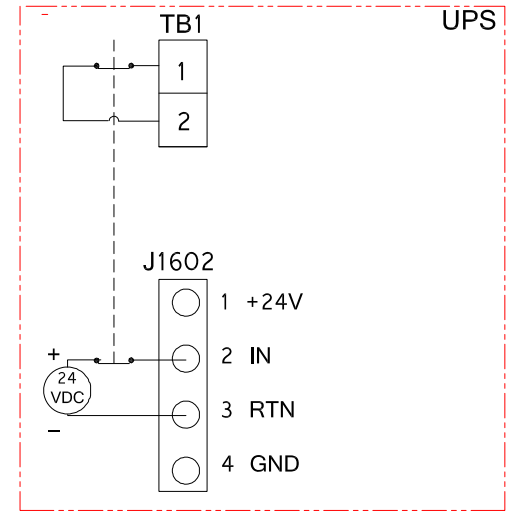

CABLE CONNECTIONS FOR TEMPERATURE SENSORS IN BATTERY CABINETS

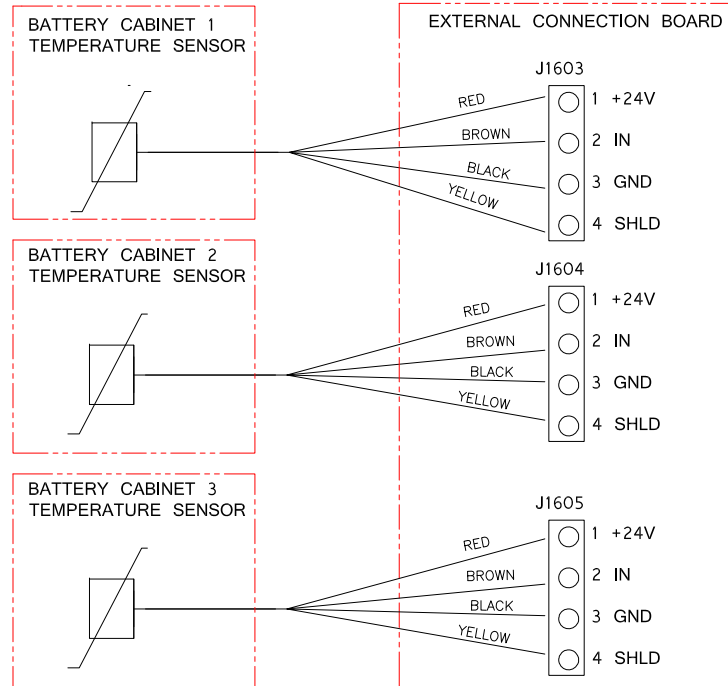

BATTERY BREAKER WIRING DETAILS

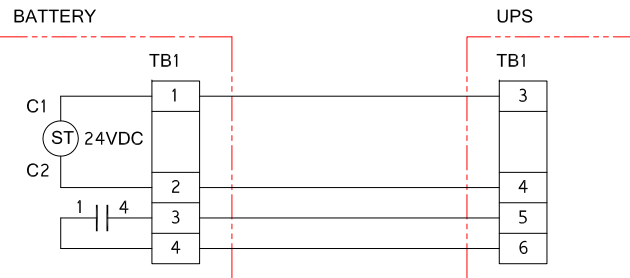

NOTES:

1. INSTALLATION SHALL COMPLY WITH ALL APPLICABLE NATIONAL, STATE AND LOCAL CODES.
2. REFER TO PRODUCT DOCUMENTATION FOR ADDITIONAL DETAILS PRIOR TO INSTALLATION AND SITE PREPARATION WORK.
- △ 3. FOR MORE THAN ONE BATTERY CABINET, REFER TO THE BATTERY CABINET DRAWINGS GUPXCB-1 AND GUPXCB-2.

THIS DRAWING AND SPECIFICATIONS HEREIN ARE THE PROPERTY OF SCHNEIDER ELECTRIC AND SHALL NOT BE COPIED, REPRODUCED OR USED IN WHOLE OR IN PART, AS THE BASIS FOR THE MANUFACTURE OR SALE OF ITEMS WITHOUT WRITTEN PERMISSION FROM SCHNEIDER ELECTRIC. THIS DRAWING IS BASED UPON LATEST AVAILABLE INFORMATION AND IS SUBJECT TO CHANGE WITHOUT NOTICE.

Schneider Electric

TITLE: GUTOR PXC
UPS 75kW & 100kW WITH INPUT & BYPASS TRANSFORMERS
Input: 480/600V, 3PH, 60Hz, Dual Mains
Output: 208, 3PH, 60Hz
EXTERNAL CONNECTIONS, REPO & SHUNT TRIP DETAILS

DWG NO: GUPXC75K100FDI **REV.** 0

| | | |
|-------------------------------|-----------|------------|
| DRAWN BY: K.NAGENDRA | 16-OCT-17 | THIRD |
| ENGINEER: I KENNEDY | 16-OCT-17 | ANGLE |
| APPROVED BY: W WATKINS | 16-OCT-17 | PROJECTION |

PROJECT: DRAWINGS **SHEET 7 OF 7**