

# ENTRA™ 12 INSTALLATION INSTRUCTIONS

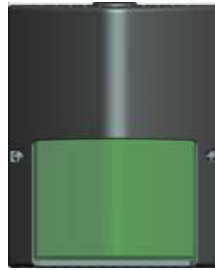

Thank you for buying RAB lighting fixtures. Our goal is to design the best quality products to get the job done right. We'd like to hear your comments. Call the Marketing Department at 888-RAB-1000 or email: [marketing@rabweb.com](mailto:marketing@rabweb.com)



## IMPORTANT

**READ CAREFULLY BEFORE INSTALLING FIXTURE. RETAIN THESE INSTRUCTIONS FOR FUTURE REFERENCE.**

Fixtures must be wired in accordance with the National Electrical Code and all applicable local codes. Proper grounding is required for safety. THIS PRODUCT MUST BE INSTALLED IN ACCORDANCE WITH THE APPLICABLE INSTALLATION CODE BY A PERSON FAMILIAR WITH THE CONSTRUCTION AND OPERATION OF THE PRODUCT AND THE HAZARDS INVOLVED.

**WARNING: Make certain power is OFF before installing or maintaining fixture. No user serviceable parts inside.**

## FIXTURE MOUNTING

To ensure weatherproof seal, apply weatherproof silicone sealant around the edge of the **Housing** and/or **Junction Box**. This is especially important with an uneven wall surface. Silicone all plugs and unused conduit entries.

### MOUNTING TO JUNCTION BOX

1. Loosen **Door Screws** and open the **Door**. Screws will remain in place with **Silicone Washers**.
2. Loosen **Reflector Screws** and slide the **Reflector** down from the **Housing**.
3. Knock out appropriate **Slots** when mounting to junction box (not supplied) and secure to **Junction box**.
4. Feed supply wires through **Junction Box**. Check the **Gasket** is fully sealed.
5. Make sure all gaskets are properly seated. Place the **Reflector** and tighten the **Reflector Screws**. Close and tighten the **Door Screws**. Silicone all **Plugs** and unused conduit entries.

### MOUNTING TO WALL

1. Loosen **Door Screws** and open the **Door**. Screws will remain in place with **Silicone Washers**.
2. Loosen **Reflector Screws** and slide the **Reflector** down from the **Housing**.
3. Knock out appropriate **Slots** when mounting to the wall surface.
4. Secure **Housing** to a sturdy wall. Use appropriate mounting hardware such as lag bolts and anchors with washers suitable for the mounting surface. Check the **Gasket** is fully sealed.
5. Make sure all gaskets are properly seated. Place the **Reflector** and tighten the **Reflector Screws**. Close and tighten the **Door Screws**. Silicone all **Plugs** and unused conduit entries.
6. If outdoor surface is irregular, use caulk to seal any gaps around the **Housing**.

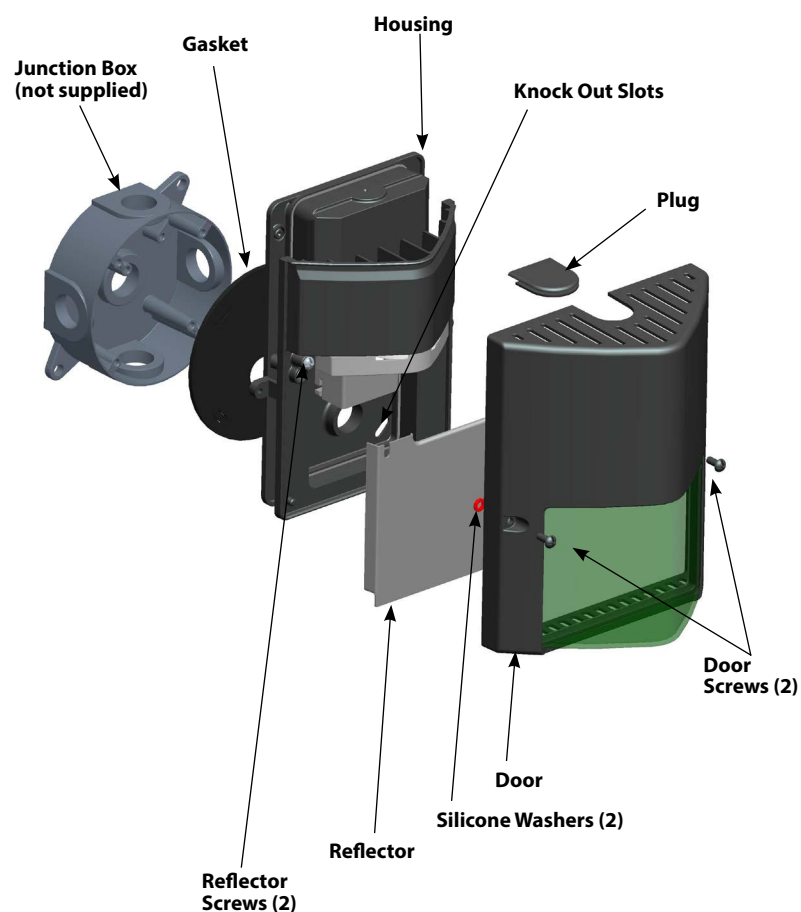

# ENTRA™ 12 INSTALLATION INSTRUCTIONS



Thank you for buying RAB lighting fixtures. Our goal is to design the best quality products to get the job done right. We'd like to hear your comments. Call the Marketing Department at 888-RAB-1000 or email: [marketing@rabweb.com](mailto:marketing@rabweb.com)

## WIRING

Universal voltage driver permits operation at 120V to 277VAC, 50 or 60 Hz **except fixtures factory ordered with a (PC) 120V photocell or (/PC2) 277V photocell.**

1. Connect the black fixture lead to the (+) LINE supply lead.
2. Connect the white fixture lead to the (-) COMMON supply lead.
3. Connect the GROUND wire from fixture to supply ground.

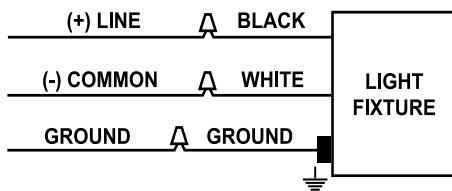

## CLEANING & MAINTENANCE

**CAUTION: Be sure fixture temperature is cool enough to touch. Do not clean or maintain while fixture is energized.**

1. Clean lens & fixture with non-abrasive glass cleaning solution.
2. Do not open fixture to clean the LED. Do not touch the LED.

## TROUBLESHOOTING

1. Check that the line voltage at fixture is correct. Refer to wiring directions.
2. Is the fixture grounded properly?

*Note: These instructions do not cover all details or variations in equipment nor do they provide for every possible situation during installation operation or maintenance.*

### ENTRA12 COOL



Light Output (Lumens)	1284
Watts	14.3
Lumens per Watt (Efficacy)	89
Color Accuracy Color Rendering Index (CRI)	70
Light Color Correlated Color Temperature (CCT)	5033 (Daylight)

All results are according to IESNA LM-79-2008: Approved Method for the Electrical and Photometric Testing of Solid-State Lighting. The U.S. Department of Energy (DOE) verifies product test data and results.

Visit [www.lightingfacts.com](http://www.lightingfacts.com) for the Label Reference Guide.

Registration Number: WVMA-WRVQK4 (6/27/2013)  
Model Number: ENTRA12  
Type: Outdoor wall pack

### ENTRA12N NEUTRAL



Light Output (Lumens)	982
Watts	13.9
Lumens per Watt (Efficacy)	70
Color Accuracy Color Rendering Index (CRI)	88
Light Color Correlated Color Temperature (CCT)	4027 (Bright White)

All results are according to IESNA LM-79-2008: Approved Method for the Electrical and Photometric Testing of Solid-State Lighting. The U.S. Department of Energy (DOE) verifies product test data and results.

Visit [www.lightingfacts.com](http://www.lightingfacts.com) for the Label Reference Guide.

Registration Number: WVMA-MS27G8 (6/27/2013)  
Model Number: ENTRA12N  
Type: Outdoor wall pack

### ENTRA12Y WARM



Light Output (Lumens)	876
Watts	14.2
Lumens per Watt (Efficacy)	61
Color Accuracy Color Rendering Index (CRI)	84
Light Color Correlated Color Temperature (CCT)	3007 (Bright White)

All results are according to IESNA LM-79-2008: Approved Method for the Electrical and Photometric Testing of Solid-State Lighting. The U.S. Department of Energy (DOE) verifies product test data and results.

Visit [www.lightingfacts.com](http://www.lightingfacts.com) for the Label Reference Guide.

Registration Number: WVMA-78RXXMW (6/27/2013)  
Model Number: ENTRA12Y  
Type: Outdoor wall pack



## Easy Installation & Product Help

**Tech Help Line**  
Call our experts 888 RAB-1000

**rabweb.com**  
Visit our website for product info

**email**  
Answered promptly [sales@rabweb.com](mailto:sales@rabweb.com)