

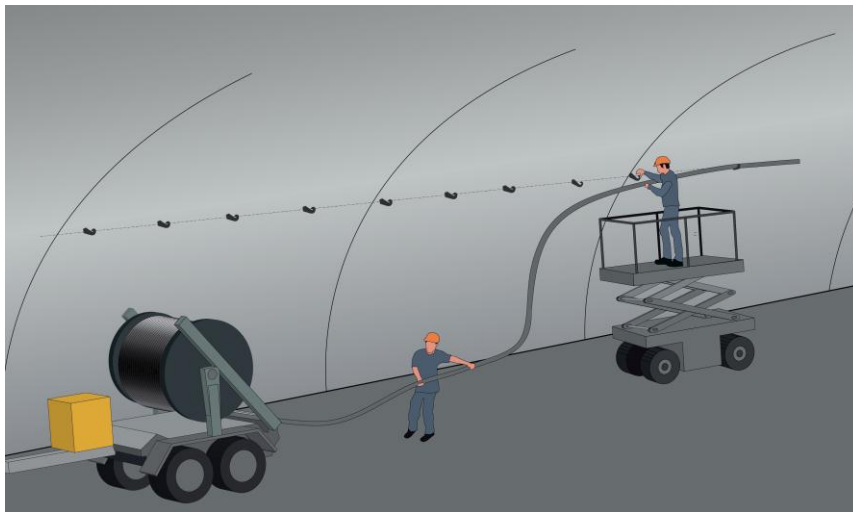

Where Automation Connects.



Radiating Cables

RCL/RCH

March 6, 2014

INSTALLATION GUIDE

Your Feedback Please

We always want you to feel that you made the right decision to use our products. If you have suggestions, comments, compliments or complaints about our products, documentation, or support, please write or call us.

How to Contact Us

ProSoft Technology

5201 Truxtun Ave., 3rd Floor
Bakersfield, CA 93309
+1 (661) 716-5100
+1 (661) 716-5101 (Fax)
www.prosoft-technology.com
support@prosoft-technology.com

Copyright © 2014 ProSoft Technology, Inc., All Rights Reserved.

Radiating Cables Installation Guide
March 6, 2014

ProSoft Technology[®], ProLinX[®], inRAX[®], ProTalk[®], and RadioLinX[®] are Registered Trademarks of ProSoft Technology, Inc. All other brand or product names are or may be trademarks of, and are used to identify products and services of, their respective owners.

ProSoft Technology[®] Product Documentation

In an effort to conserve paper, ProSoft Technology no longer includes printed manuals with our product shipments. User Manuals, Datasheets, Sample Ladder Files, and Configuration Files are provided from our web site: **www.prosoft-technology.com**

Disclaimer

This installation manual is provided to help assist in part selection and Radiating Cable installation. Please contact ProSoft Technology Technical Support to review and assist with your application.

Contents

Your Feedback Please	3
How to Contact Us	3
ProSoft Technology® Product Documentation	3
Disclaimer	3
1 Start Here	7
1.1 Safety	7
2 Slot Orientation for Radiating Cables	9
3 Installing Radiating Cable	11
3.1 Installing the Clip Hanger	12
3.2 Installing the Clic Clamp	12
4 Cable Termination	13
5 Cable Hanging and Fixing	15
5.1 Bending RF Cables	15
5.2 Connector Installation for Radiating Cables ½-inch	16
5.3 Radiating Cable Positioning in Tunnels	17
6 Support, Service & Warranty	19
6.1 Contacting Technical Support	19
6.2 Warranty Information	20

1 Start Here

1.1 Safety

Please use proper safety guidelines when installing Radiating Cable. This can be achieved by:

Cordoning-off the Working Area using:

- Warning Signs
- Warning Cones
- Warning Lights
- Warning Tape

Keeping Emergency Access and Emergency Routes Clear of:

- Materials
- Tolls
- Vehicles

Taking proper Fire Precautions by ensuring that easily inflammable materials should be:

- Kept to a minimum
- Disposed of immediately if not necessary
- Brought into the area only in the amount required



Caution: You must be able to complete the application without exposing personnel or equipment to unsafe or inappropriate working conditions.

2 Slot Orientation for Radiating Cables

Radiating Cable is constructed with slots. These slots must be oriented toward the area requiring coverage. The slots are located 180° opposite to an embossed line on the jacket.

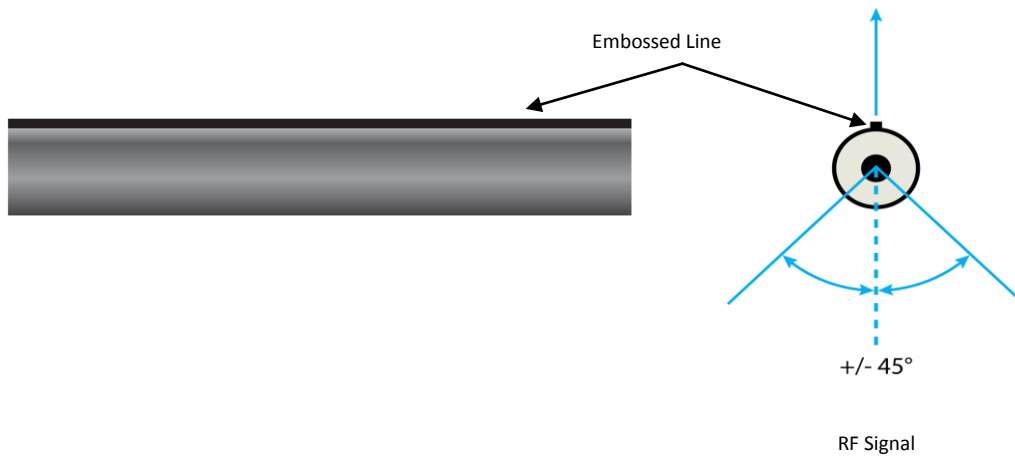

The diagram below shows the electric field lines in various installations.

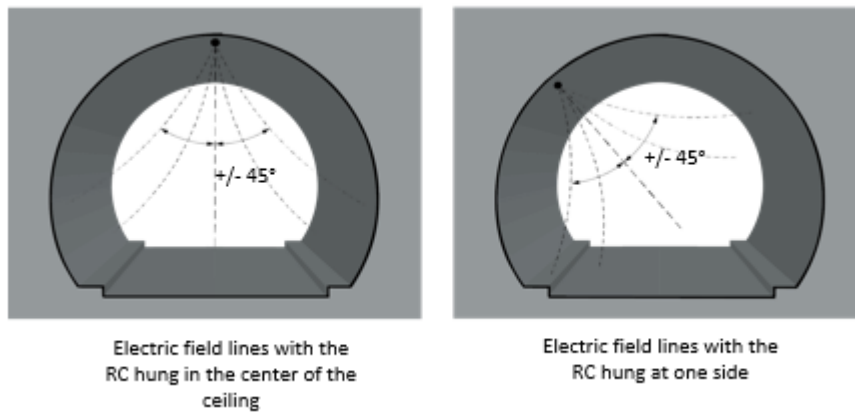

3 Installing Radiating Cable

The RC cable is mounted with hangers. A hanger should be mounted every 3 feet (1 meter). Every 33 feet (10 meters), the hanger should be fire resistant.

The recommended hangers are the Clip Handler (fire resistant) and Clic Clamp.

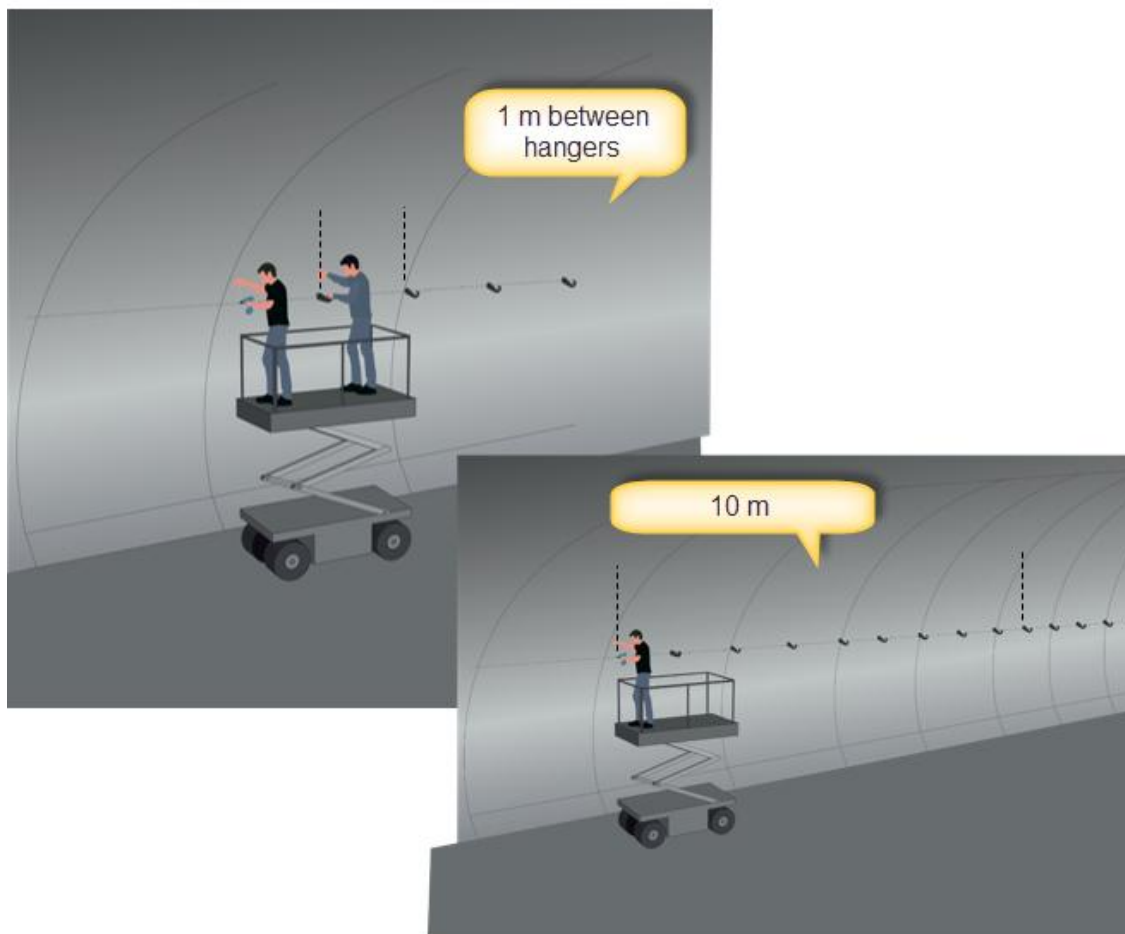

There are multiple installation options for the Clip Hanger and Clic Camp possible, depending on your environment. Contact ProSoft Technology for more information.

3.1 Installing the Clip Hanger



3.2 Installing the Clic Clamp

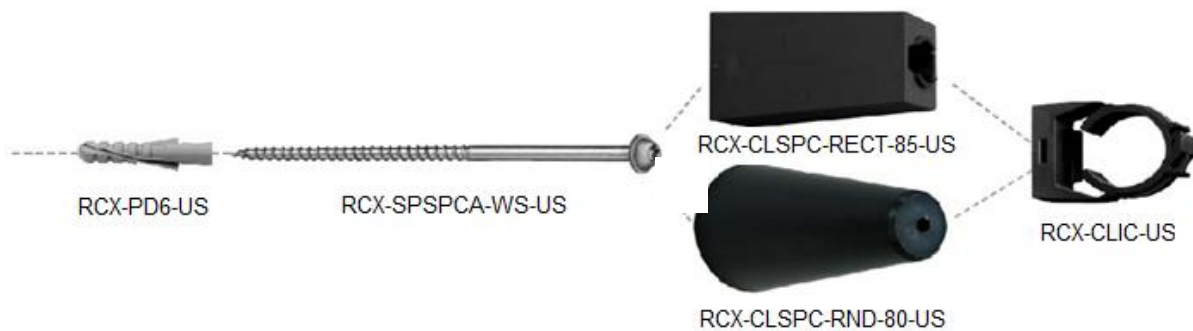

- 1 Drill a 6mm hole in insert the nylon plug into the wall.
- 2 Connect the Clic Clamp to the Spacer as shown.

4 Cable Termination

Radiating Cable must be terminated. Use ProSoft Technology part number RLX-LFTR-40 to terminate the cable.

5 Cable Hanging and Fixing

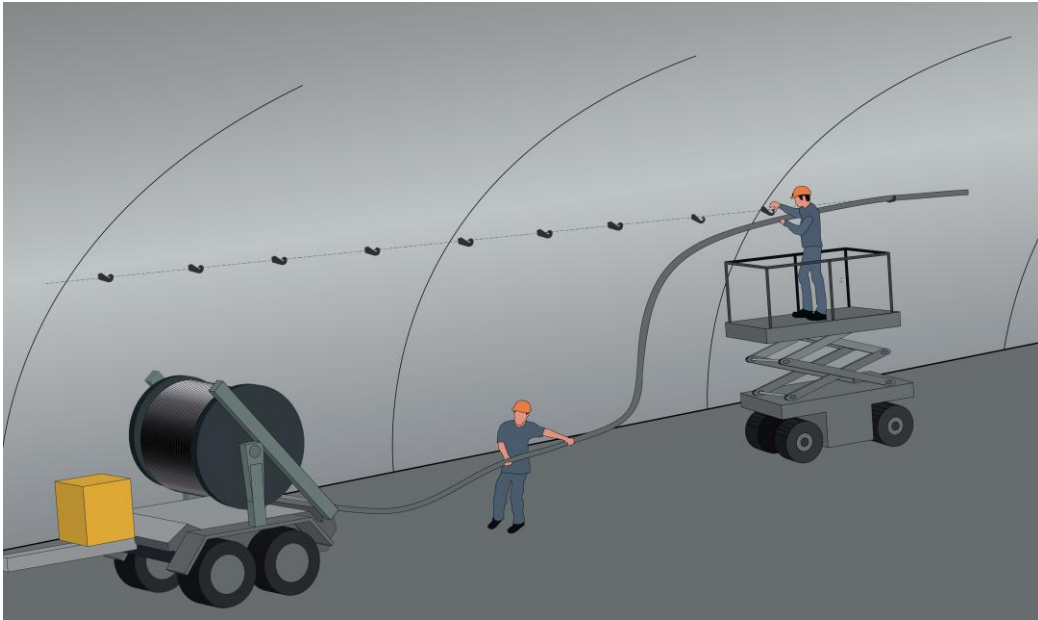

5.1 Bending RF Cables

Care should be taken when bending RF cables. The following diagram shows the right and wrong way to bend cable. Bending the wrong way may cause damage to the cable.

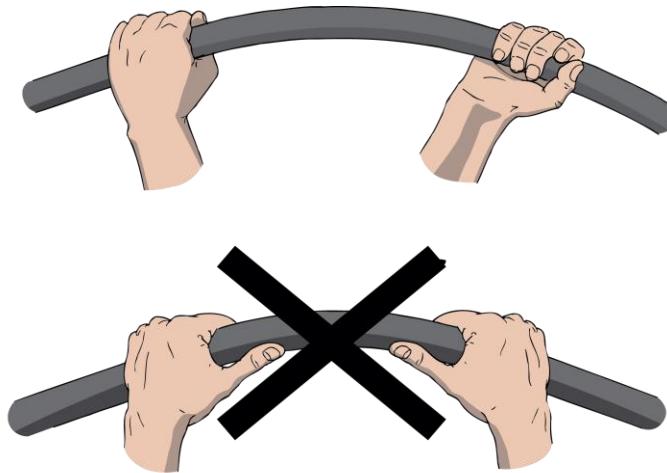

5.2 Connector Installation for Radiating Cables ½-inch



5.3 Radiating Cable Positioning in Tunnels

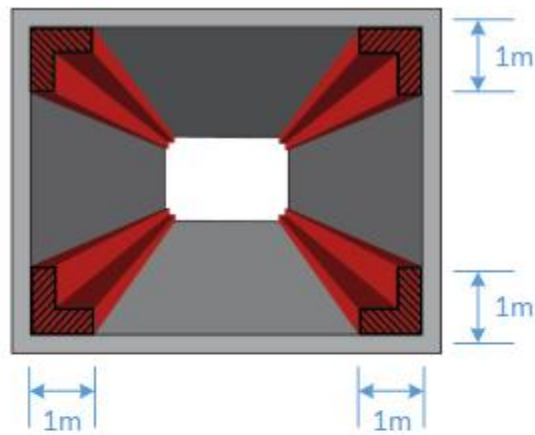

 No radiating cable in these areas

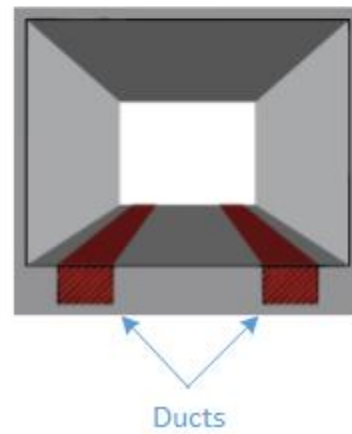
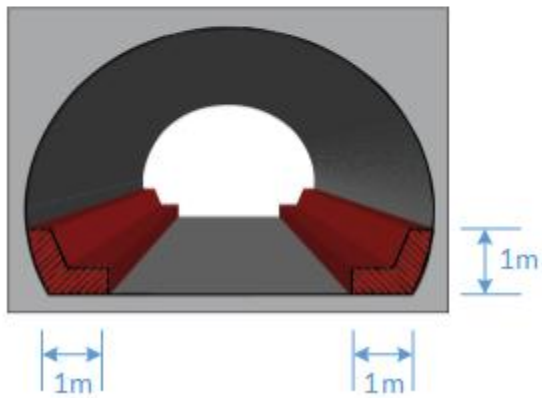

6 Support, Service & Warranty

6.1 Contacting Technical Support

ProSoft Technology, Inc. (ProSoft) is committed to providing the most efficient and effective support possible. Before calling, please gather the following information to assist in expediting this process:

- 1 Product Version Number
- 2 System architecture
- 3 Network details

If the issue is hardware related, we will also need information regarding:

- 1 Module configuration and associated ladder files, if any
- 2 Module operation and any unusual behavior
- 3 Configuration/Debug status information
- 4 LED patterns
- 5 Details about the serial, Ethernet or fieldbus devices interfaced to the module, if any.

Note: For technical support calls within the United States, an after-hours answering system allows 24-hour/7-days-a-week pager access to one of our qualified Technical and/or Application Support Engineers. Detailed contact information for all our worldwide locations is available on the following page.

Internet	Web Site: www.prosoft-technology.com/support E-mail address: support@prosoft-technology.com
Asia Pacific (location in Malaysia)	Tel: +603.7724.2080, E-mail: asiapc@prosoft-technology.com Languages spoken include: Chinese, English
Asia Pacific (location in China)	Tel: +86.21.5187.7337 x888, E-mail: asiapc@prosoft-technology.com Languages spoken include: Chinese, English
Europe (location in Toulouse, France)	Tel: +33 (0) 5.34.36.87.20, E-mail: support.EMEA@prosoft-technology.com Languages spoken include: French, English
Europe (location in Dubai, UAE)	Tel: +971-4-214-6911, E-mail: mea@prosoft-technology.com Languages spoken include: English, Hindi
North America (location in California)	Tel: +1.661.716.5100, E-mail: support@prosoft-technology.com Languages spoken include: English, Spanish
Latin America (Oficina Regional)	Tel: +1-281-2989109, E-Mail: latinam@prosoft-technology.com Languages spoken include: Spanish, English
Latin America (location in Puebla, Mexico)	Tel: +52-222-3-99-6565, E-mail: soporte@prosoft-technology.com Languages spoken include: Spanish
Brasil (location in Sao Paulo)	Tel: +55-11-5083-3776, E-mail: brasil@prosoft-technology.com Languages spoken include: Portuguese, English

6.2 Warranty Information

For complete details regarding ProSoft Technology's TERMS & CONDITIONS OF SALE, WARRANTY, SUPPORT, SERVICE AND RETURN MATERIAL AUTHORIZATION INSTRUCTIONS please see the documents on the Product DVD or go to www.prosoft-technology.com/warranty

Documentation is subject to change without notice.