

A. System Overview

## Fanning Strip System

- Holds wires in a specific orientation
- No sharp edges to damage wire insulation
- Will accept wires up to 18 AWG
- Fanning strip can remain as part of completed harness

B1. Cable Ties

B2. Cable Accessories

B3. Stainless Steel Ties



FS156

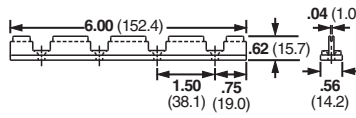

FSH40

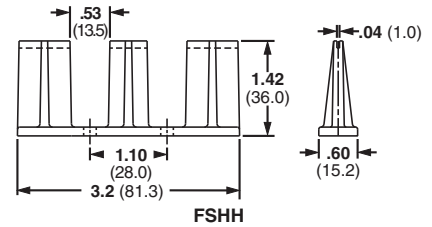

FSHH

C1. Wiring Duct



| Part Number | Material  | Color   | Mounting Method     | Std. Pkg. Qty. | Std. Ctn. Qty. |
|-------------|-----------|---------|---------------------|----------------|----------------|
| FS156-C     | Nylon 6.6 | Natural | FSH Holder          | 100            | 1000           |
| FSH40-X     | ABS       | Black   | Four #8 (M4) Screws | 10             | 100            |
| FSHH-X      |           |         | Two #8 (M4) Screws  | 10             | 100            |

C2. Surface Raceway

C3. Abrasion Protection

C4. Cable Management

## Spring Wire Breakout System

- Harness board spring and spring holder holds wire ends secure while harness is being fabricated
- Wires simply pull out from spring when harness is removed
- Each SHH Spring Holder is supplied with one rigid wire piece to hold the spring laterally and two #8 (M4), 2" (50.8mm) hex head wood screws; purchase spring separately

D1. Terminals

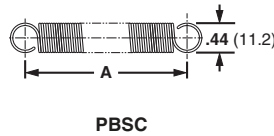
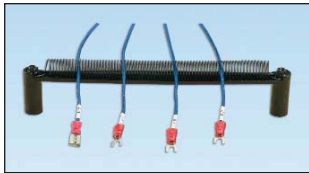

PBSC

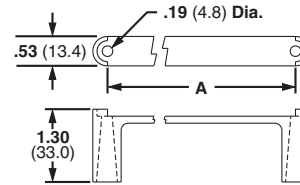

SHH

D2. Power Connectors

D3. Grounding Connectors

| Part Number | Hole Spacing A |       | Material  | Color   | Mounting Method    | Std. Pkg. Qty. | Std. Ctn. Qty. |
|-------------|----------------|-------|-----------|---------|--------------------|----------------|----------------|
|             | In.            | mm    |           |         |                    |                |                |
| PBSC1-X     | 1.00           | 25.4  | Steel     | —       | SHH1 Spring Holder | 10             | 100            |
| PBSC3-X     | 3.00           | 76.2  |           | —       | Two #8 (M4) Screws | 10             | 100            |
| PBSC6-X     | 6.00           | 152.4 |           | —       | SHH3 Spring Holder | 10             | 100            |
| PBSC12-X    | 12.00          | 304.8 |           | —       | Two #8 (M4) Screws | 10             | 100            |
| SHH1-S8-X   | 1.85           | 47.0  | Nylon 6.6 | Natural | Two #8 (M4) Screws | 10             | 100            |
| SHH3-S8-X   | 6.80           | 172.7 |           |         | Two #8 (M4) Screws | 10             | 100            |

E1. Labeling Systems

E2. Labels

E3. Pre-Printed & Write-On Markers

E4. Permanent Identification

E5. Lockout/Tagout & Safety Solutions

F. Index