

THIS COPY IS PROVIDED ON A RESTRICTED BASIS AND IS NOT TO BE USED IN ANY WAY DETRIMENTAL TO THE INTERESTS OF PANDUIT CORP.

PANDUIT P/N	WEIGHT
P24D30M-XYZ	SEE SHEET 2

SPECIFICATION:

1. STANDARD:
 UNIT TYPE: MONITORED INPUT
 ORIENTATION: VERTICAL, 0U HALF, 2-SIDED
 OUTLET QTY & TYPE: (18)C13, (6)C19
 INPUT VOLTAGE: 200-240VAC
 INPUT CURRENT: 50A (40A DERATED)
 BREAKER QTY & TYPE: (6) 20AMP, DOUBLE-POLE
 INPUT PHASE: THREE-PHASE, DELTA
 RATED POWER: 14.4kVA
 INPUT PLUG: CS8365C
 INPUT POWER CORD: SEE SHEET 2 FOR PART NUMBER TABLE
 REGULATORY STANDARD: RoHS COMPLIANT
2. ADDITIONAL:
 NONE
3. ACCESSORIES:
 (1) QUICK-START GUIDE

NOTES:

- PRIMARY DIMENSIONS ARE IN MILLIMETERS. SECONDARY DIMENSION ARE IN [INCHES] .
- INSTALLATION SHALL COMPLY WITH ALL APPLICABLE NATIONAL, STATE, AND LOCAL CODES .
- VISIT OUR ON-LINE CATALOG AT WWW.PANDUIT.COM FOR A CURRENT LIST OF PRODUCTS APPLICABLE FOR USE WITH THIS PART .
- FOR FULL PRODUCT FUNCTIONALITY REFER TO USER MANUAL .
- DRAWING VIEWS SHOW THE INPUT CORD IN THE "TOP END FED" CONFIGURATION

IDENTIFICATION

FOR FINISHED GOOD PART NUMBER & DESCRIPTION TABLE SEE SHEET 2 CONFIGURABLE PART NUMBERS: P24D30M-XX Y Z

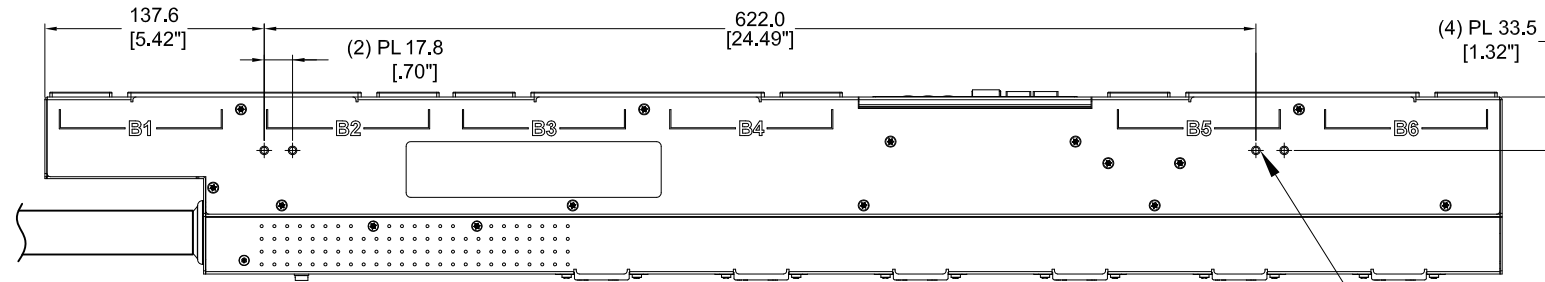

LEFT VIEW

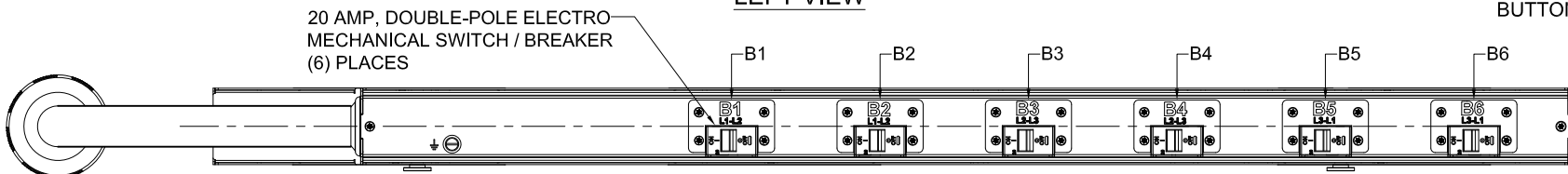

REAR VIEW

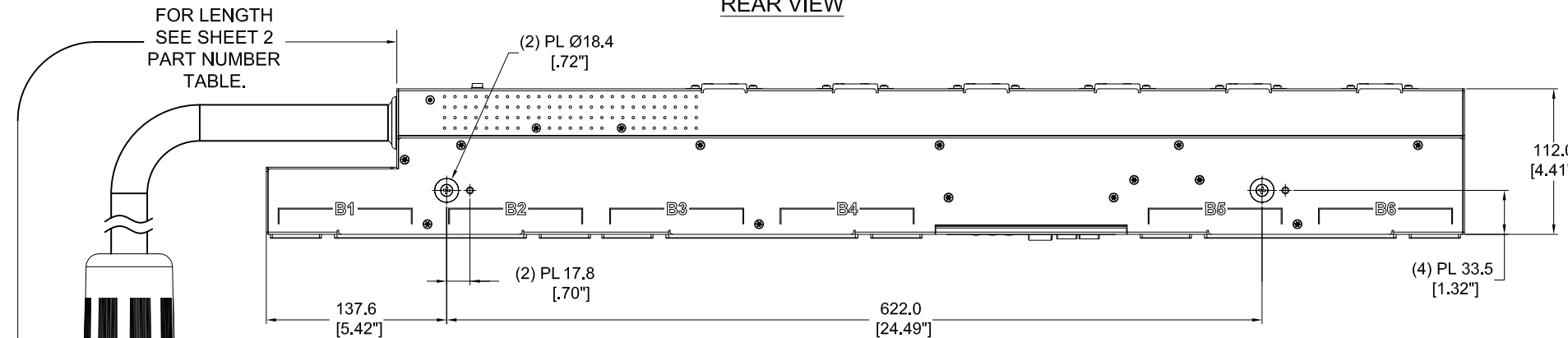

RIGHT VIEW

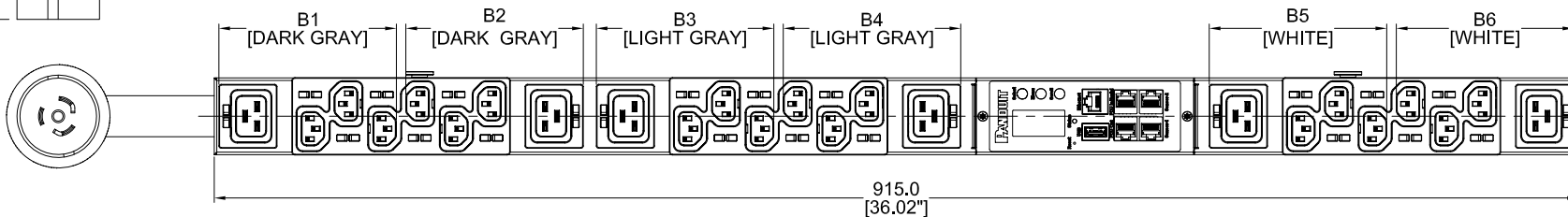

FRONT VIEW

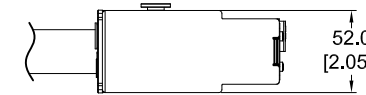

BOTTOM VIEW

XX: FINISHED GOOD COLOR BL=BLACK YL=YELLOW RD=RED BU=BLUE WH=WHITE GN=GREEN	Y: INPUT FEED TYPE 1=TOP-END FED 2=BOTTOM-END FED	Z: INPUT CORD LENGTH A=1 METER B=2 METER C=3 METER
--	---	---

PLUG/RECEPTACLE BLOCK



PLUG
CS8365C, 3P 4W
50A, 250V, 3 - PHASE DELTA MAX RATED INPUT
40A DERATED



RECEPTACLES
IEC 60320/C19
16A, 250V MAX RATED OUTPUT



RECEPTACLES
IEC 60320/C13
10A, 250V MAX RATED OUTPUT

REV	DATE	BY	CHK	APR	DESCRIPTION	ECN
02A	06/07/2018	JF.YU	MIM	JAWI	ADDED SHEET 2 WITH CONFIGURABLE PART NUMBER TABLE AND DESCRIPTION UPDATED IDENTIFICATION TO INCLUDE CONFIGURABLE OPTION DE-CODER UPDATED CIRCUIT BREAKER LABELS WITH ROTATED TEXT	P24D30M
01B	12/15/2017	WSJ	MIM	EDM	UPDATED DESCRIPTION AND ADDED VIEW	P24D30M
01A	08/25/2017	WSJ	MIM	EDM	INITIAL RELEASE	P24D30M

WE ASK THAT YOU CHECK FULLY THE DIMENSIONS, NOTES, AND SIGN THE CLIENT SIGNATURE BOX. THE JOB WILL NOT PROGRESS WITHOUT SIGNED APPROVAL. PLEASE DO NOT DELAY IN RETURNING PROOF AS IT WILL AFFECT DELIVERY		SIGN
		DATE
		PRINT
TITLE INTELLIGENT SERIES PDU P24D30M-XYZ CUSTOMER DRAWING		
ITEM REVISION NAME		
DATASHEET FILE NAME:		
UNLESS OTHERWISE SPECIFIED DIMENSIONAL TOLERANCE ARE: mm [IN]		MATERIAL/COLOR: N/A
THIRD ANGLE PROJECTION		DRAWING NUMBER: P24D30M_DC
DRAWN BY WSJ	DATE 08/25/2017	SCALE NONE
CHK SEAN	SCALE NONE	SHT 1 OF 2
		SCALE B

2



1

THIS COPY IS PROVIDED ON A RESTRICTED BASIS AND IS NOT TO BE USED IN ANY WAY DETRIMENTAL TO THE INTERESTS OF PANDUIT CORP.

FINISHED GOOD PART NUMBER	FINISHED GOOD DESCRIPTION	COLOR	INPUT CORD LENGTH	WEIGHT
P24D30M	VERTICAL,(18) C13,(6) C19,MONITORED INPUT,200-240V/50A/THREE-PHASE DELTA , TOP-END FED, 3 METER INPUT CORD, BLACK	BLACK (RAL 9005)	3M(+254MM-127MM) 10'(+10"/-5")	12.8kg
P24D30M-BL1A	VERTICAL,(18) C13,(6) C19,MONITORED INPUT,200-240V/50A/THREE-PHASE DELTA , TOP-END FED, 1 METER INPUT CORD, BLACK	BLACK (RAL 9005)	1M(+178MM-89MM) 3.3'[+7"/-3.5"]	10.2kg
P24D30M-BL1B	VERTICAL,(18) C13,(6) C19,MONITORED INPUT,200-240V/50A/THREE-PHASE DELTA , TOP-END FED, 2 METER INPUT CORD, BLACK	BLACK (RAL 9005)	2M(+178MM-89MM) 6.5'[+7"/-3.5"]	11.5kg
P24D30M-RD1A	VERTICAL,(18) C13,(6) C19,MONITORED INPUT,200-240V/50A/THREE-PHASE DELTA , TOP-END FED, 1 METER INPUT CORD, RED	RED (RAL 3020)	1M(+178MM-89MM) 3.3'[+7"/-3.5"]	10.2kg
P24D30M-RD1B	VERTICAL,(18) C13,(6) C19,MONITORED INPUT,200-240V/50A/THREE-PHASE DELTA , TOP-END FED, 2 METER INPUT CORD, RED	RED (RAL 3020)	2M(+178MM-89MM) 6.5'[+7"/-3.5"]	11.5kg
P24D30M-RD1C	VERTICAL,(18) C13,(6) C19,MONITORED INPUT,200-240V/50A/THREE-PHASE DELTA , TOP-END FED, 3 METER INPUT CORD, RED	RED (RAL 3020)	3M(+254MM-127MM) 10'(+10"/-5")	12.8kg
P24D30M-WH1A	VERTICAL,(18) C13,(6) C19,MONITORED INPUT,200-240V/50A/THREE-PHASE DELTA , TOP-END FED, 1 METER INPUT CORD, WHITE	WHITE (RAL 9003)	1M(+178MM-89MM) 3.3'[+7"/-3.5"]	10.2kg
P24D30M-WH1B	VERTICAL,(18) C13,(6) C19,MONITORED INPUT,200-240V/50A/THREE-PHASE DELTA , TOP-END FED, 2 METER INPUT CORD, WHITE	WHITE (RAL 9003)	2M(+178MM-89MM) 6.5'[+7"/-3.5"]	11.5kg
P24D30M-WH1C	VERTICAL,(18) C13,(6) C19,MONITORED INPUT,200-240V/50A/THREE-PHASE DELTA , TOP-END FED, 3 METER INPUT CORD, WHITE	WHITE (RAL 9003)	3M(+254MM-127MM) 10'(+10"/-5")	12.8kg
P24D30M-YL1A	VERTICAL,(18) C13,(6) C19,MONITORED INPUT,200-240V/50A/THREE-PHASE DELTA , TOP-END FED, 1 METER INPUT CORD, YELLOW	YELLOW (RAL 1023)	1M(+178MM-89MM) 3.3'[+7"/-3.5"]	10.2kg
P24D30M-YL1B	VERTICAL,(18) C13,(6) C19,MONITORED INPUT,200-240V/50A/THREE-PHASE DELTA , TOP-END FED, 2 METER INPUT CORD, YELLOW	YELLOW (RAL 1023)	2M(+178MM-89MM) 6.5'[+7"/-3.5"]	11.5kg
P24D30M-YL1C	VERTICAL,(18) C13,(6) C19,MONITORED INPUT,200-240V/50A/THREE-PHASE DELTA , TOP-END FED, 3 METER INPUT CORD, YELLOW	YELLOW (RAL 1023)	3M(+254MM-127MM) 10'(+10"/-5")	12.8kg
P24D30M-BU1A	VERTICAL,(18) C13,(6) C19,MONITORED INPUT,200-240V/50A/THREE-PHASE DELTA , TOP-END FED, 1 METER INPUT CORD, BLUE	BLUE (RAL 5005)	1M(+178MM-89MM) 3.3'[+7"/-3.5"]	10.2kg
P24D30M-BU1B	VERTICAL,(18) C13,(6) C19,MONITORED INPUT,200-240V/50A/THREE-PHASE DELTA , TOP-END FED, 2 METER INPUT CORD, BLUE	BLUE (RAL 5005)	2M(+178MM-89MM) 6.5'[+7"/-3.5"]	11.5kg
P24D30M-BU1C	VERTICAL,(18) C13,(6) C19,MONITORED INPUT,200-240V/50A/THREE-PHASE DELTA , TOP-END FED, 3 METER INPUT CORD, BLUE	BLUE (RAL 5005)	3M(+254MM-127MM) 10'(+10"/-5")	12.8kg
P24D30M-GN1A	VERTICAL,(18) C13,(6) C19,MONITORED INPUT,200-240V/50A/THREE-PHASE DELTA , TOP-END FED, 1 METER INPUT CORD, GREEN	GREEN (RAL 6001)	1M(+178MM-89MM) 3.3'[+7"/-3.5"]	10.2kg
P24D30M-GN1B	VERTICAL,(18) C13,(6) C19,MONITORED INPUT,200-240V/50A/THREE-PHASE DELTA , TOP-END FED, 2 METER INPUT CORD, GREEN	GREEN (RAL 6001)	2M(+178MM-89MM) 6.5'[+7"/-3.5"]	11.5kg
P24D30M-GN1C	VERTICAL,(18) C13,(6) C19,MONITORED INPUT,200-240V/50A/THREE-PHASE DELTA , TOP-END FED, 3 METER INPUT CORD, GREEN	GREEN (RAL 6001)	3M(+254MM-127MM) 10'(+10"/-5")	12.8kg
P24D30M-BL2A	VERTICAL,(18) C13,(6) C19,MONITORED INPUT,200-240V/50A/THREE-PHASE DELTA , BOTTOM-END FED, 1 METER INPUT CORD, BLACK	BLACK (RAL 9005)	1M(+178MM-89MM) 3.3'[+7"/-3.5"]	10.2kg
P24D30M-BL2B	VERTICAL,(18) C13,(6) C19,MONITORED INPUT,200-240V/50A/THREE-PHASE DELTA , BOTTOM-END FED, 2 METER INPUT CORD, BLACK	BLACK (RAL 9005)	2M(+178MM-89MM) 6.5'[+7"/-3.5"]	11.5kg
P24D30M-BL2C	VERTICAL,(18) C13,(6) C19,MONITORED INPUT,200-240V/50A/THREE-PHASE DELTA , BOTTOM-END FED, 3 METER INPUT CORD, BLACK	BLACK (RAL 9005)	3M(+254MM-127MM) 10'(+10"/-5")	12.8kg
P24D30M-RD2A	VERTICAL,(18) C13,(6) C19,MONITORED INPUT,200-240V/50A/THREE-PHASE DELTA , BOTTOM-END FED, 1 METER INPUT CORD, RED	RED (RAL 3020)	1M(+178MM-89MM) 3.3'[+7"/-3.5"]	10.2kg
P24D30M-RD2B	VERTICAL,(18) C13,(6) C19,MONITORED INPUT,200-240V/50A/THREE-PHASE DELTA , BOTTOM-END FED, 2 METER INPUT CORD, RED	RED (RAL 3020)	2M(+178MM-89MM) 6.5'[+7"/-3.5"]	11.5kg
P24D30M-RD2C	VERTICAL,(18) C13,(6) C19,MONITORED INPUT,200-240V/50A/THREE-PHASE DELTA , BOTTOM-END FED, 3 METER INPUT CORD, RED	RED (RAL 3020)	3M(+254MM-127MM) 10'(+10"/-5")	12.8kg
P24D30M-WH2A	VERTICAL,(18) C13,(6) C19,MONITORED INPUT,200-240V/50A/THREE-PHASE DELTA , BOTTOM-END FED, 1 METER INPUT CORD, WHITE	WHITE (RAL 9003)	1M(+178MM-89MM) 3.3'[+7"/-3.5"]	10.2kg
P24D30M-WH2B	VERTICAL,(18) C13,(6) C19,MONITORED INPUT,200-240V/50A/THREE-PHASE DELTA , BOTTOM-END FED, 2 METER INPUT CORD, WHITE	WHITE (RAL 9003)	2M(+178MM-89MM) 6.5'[+7"/-3.5"]	11.5kg
P24D30M-WH2C	VERTICAL,(18) C13,(6) C19,MONITORED INPUT,200-240V/50A/THREE-PHASE DELTA , BOTTOM-END FED, 3 METER INPUT CORD, WHITE	WHITE (RAL 9003)	3M(+254MM-127MM) 10'(+10"/-5")	12.8kg
P24D30M-YL2A	VERTICAL,(18) C13,(6) C19,MONITORED INPUT,200-240V/50A/THREE-PHASE DELTA , BOTTOM-END FED, 1 METER INPUT CORD, YELLOW	YELLOW (RAL 1023)	1M(+178MM-89MM) 3.3'[+7"/-3.5"]	10.2kg
P24D30M-YL2B	VERTICAL,(18) C13,(6) C19,MONITORED INPUT,200-240V/50A/THREE-PHASE DELTA , BOTTOM-END FED, 2 METER INPUT CORD, YELLOW	YELLOW (RAL 1023)	2M(+178MM-89MM) 6.5'[+7"/-3.5"]	11.5kg
P24D30M-YL2C	VERTICAL,(18) C13,(6) C19,MONITORED INPUT,200-240V/50A/THREE-PHASE DELTA , BOTTOM-END FED, 3 METER INPUT CORD, YELLOW	YELLOW (RAL 1023)	3M(+254MM-127MM) 10'(+10"/-5")	12.8kg
P24D30M-BU2A	VERTICAL,(18) C13,(6) C19,MONITORED INPUT,200-240V/50A/THREE-PHASE DELTA , BOTTOM-END FED, 1 METER INPUT CORD, BLUE	BLUE (RAL 5005)	1M(+178MM-89MM) 3.3'[+7"/-3.5"]	10.2kg
P24D30M-BU2B	VERTICAL,(18) C13,(6) C19,MONITORED INPUT,200-240V/50A/THREE-PHASE DELTA , BOTTOM-END FED, 2 METER INPUT CORD, BLUE	BLUE (RAL 5005)	2M(+178MM-89MM) 6.5'[+7"/-3.5"]	11.5kg
P24D30M-BU2C	VERTICAL,(18) C13,(6) C19,MONITORED INPUT,200-240V/50A/THREE-PHASE DELTA , BOTTOM-END FED, 3 METER INPUT CORD, BLUE	BLUE (RAL 5005)	3M(+254MM-127MM) 10'(+10"/-5")	12.8kg
P24D30M-GN2A	VERTICAL,(18) C13,(6) C19,MONITORED INPUT,200-240V/50A/THREE-PHASE DELTA , BOTTOM-END FED, 1 METER INPUT CORD, GREEN	GREEN (RAL 6001)	1M(+178MM-89MM) 3.3'[+7"/-3.5"]	10.2kg
P24D30M-GN2B	VERTICAL,(18) C13,(6) C19,MONITORED INPUT,200-240V/50A/THREE-PHASE DELTA , BOTTOM-END FED, 2 METER INPUT CORD, GREEN	GREEN (RAL 6001)	2M(+178MM-89MM) 6.5'[+7"/-3.5"]	11.5kg
P24D30M-GN2C	VERTICAL,(18) C13,(6) C19,MONITORED INPUT,200-240V/50A/THREE-PHASE DELTA , BOTTOM-END FED, 3 METER INPUT CORD, GREEN	GREEN (RAL 6001)	3M(+254MM-127MM) 10'(+10"/-5")	12.8kg

B

B

A

A

WE ASK THAT YOU CHECK FULLY THE DIMENSIONS, NOTES, AND SIGN THE CLIENT SIGNATURE BOX. THE JOB WILL NOT PROGRESS WITHOUT SIGNED APPROVAL. PLEASE DO NOT DELAY IN RETURNING PROOF AS IT WILL AFFECT DELIVERY		SIGN
		DATE
		PRINT
TITLE INTELLIGENT SERIES PDU P24D30M-XXYZ CUSTOMER DRAWING		
ITEM REVISION NAME		
DATASHEET FILE NAME:		
UNLESS OTHERWISE SPECIFIED DIMENSIONAL TOLERANCE ARE: mm [IN]		MATERIAL/COLOR: N/A
Tolerance(mm) 0-4<50 ±0.5 50-4<250 ±1.0 250-4<500 ±1.5 500-4<1000 ±2.5 1000-4<2000 ±4.0		DRAWING NUMBER: P24D30M_DC
THIRD ANGLE PROJECTION	DRAWN BY: WSJ	DATE: 08/25/2017
	CHK: SEAN	SCALE: NONE
		SHT 2 OF 2
		SCALE: B

REV	DATE	BY	CHK	APR	DESCRIPTION	ECN
02A	06/07/2018	JF.YU	MIM	JAWI	ADDED SHEET 2 WITH CONFIGURABLE PART NUMBER TABLE AND DESCRIPTION UPDATED IDENTIFICATION TO INCLUDE CONFIGURABLE OPTION DE-CODER UPDATED CIRCUIT BREAKER LABELS WITH ROTATED TEXT	P24D30M
01B	12/15/2017	WSJ	MIM	EDM	UPDATED DESCRIPTION AND ADDED VIEW	P24D30M
01A	08/25/2017	WSJ	MIM	EDM	INITIAL RELEASE	P24D30M

2



1