

## 90VO Vertical Outside 90° Elbow

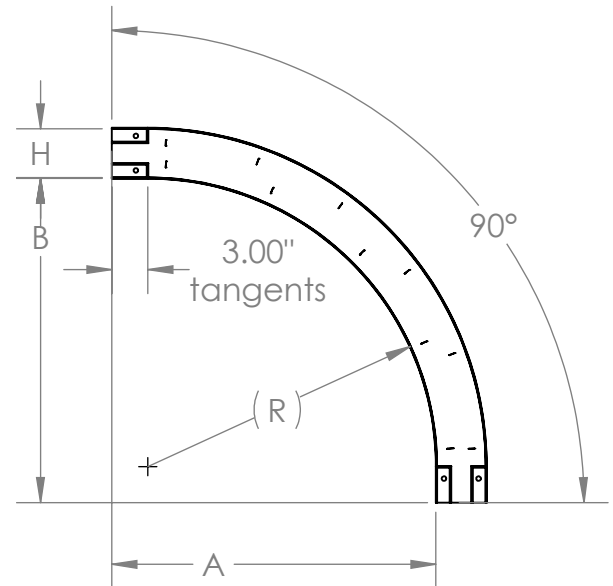
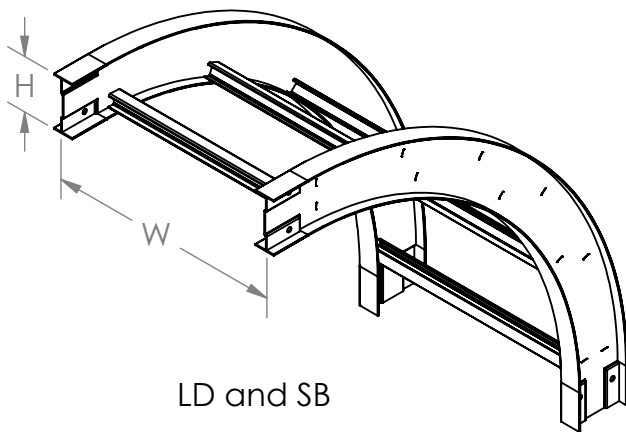

Radius R	Rail Height H	A	B
12	4-7	15	15
24		27	27
36		39	39

ITRAY VERTICAL INSIDE ELBOW CATALOG NUMBERING EXAMPLE:					
BOTTOM TYPE		LD - 6	A	- 90VO	12 - 06
VENTED					
LD - Ladder Rung					
NON-VENTED					
SB - Solid Bottom					
RAIL HEIGHT		4 - 4"			
		5 - 5"			
		6 - 6"			
		7 - 7"			
MATERIAL		A			
FITTING CODE					
RADIUS		12 - 12"			
		24 - 24"			
		36 - 36"			
WIDTH		06 - 6"			
		09 - 9"			
		12 - 12"			
		18 - 18"			
		24 - 24"			
		30 - 30"			
		36 - 36"			

- **Material:** Aluminum Alloy 6063 and 5052
- **Finish:** Plain
- **Bottom:** LD: 1" wide rung  
SB: Flat sheet over Rung
- **Construction:** Welded
- **Tray Design:** Tray construction and markings are per the latest edition of NEMA Standards Publication VE1, CSA C22.2 No. 126
- **Connectors:** All fittings are supplied with necessary connectors and fasteners
- **Fitting heights (H):** 4", 5", 6", 7"