

## SURFACE WIRING

# METAL RACEWAY

Extra Durable Surface Wiring

Add or extend power, phone, or data lines.

Wiremold Metal Raceway is the raceway of choice for heavy-duty applications including brick walls, concrete, or garages. Available in standard and high capacity to accommodate most uses. Makes running power a snap wherever you need it. Paintable to accent your décor.



BWH1

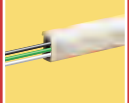

60" L x 3/4" W x 1 1/32" H

1542mm L x 19.1mm W x 13.5mm H

### TOOLS YOU'LL NEED:

- Standard and long-nose pliers
- Standard and Phillips head screwdrivers
- Tape measure • Wire snips
- Fine tooth hacksaw • Metal file

## METAL RACEWAY parts checklist:

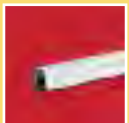

### Wire Channel

Carries wire from starter box to downstream outlet boxes, switches, and fixtures.  
BWH1(5') 700WH+(10') White  
B1(5') V500+(10') Ivory



### Starter Box

Fits over existing single-gang outlet box to feed power as the starting point for your system (1" deep).  
BW5 White, B5 V5751 Ivory



### Outlet Box

For most residential wiring devices (1" deep).  
BW2 White, B2 V5748S Ivory



### Deep Outlet Box

For standard or oversized switches or outlets – dimmers or GFCIs (1 3/8" deep).  
BW3 White, B3 V5747 Ivory



### 2-Gang Outlet Box

Expanded capacity for extra outlets or outlet/switch combinations (1 3/8" deep).  
BW32 White, B32 V5747-2 Ivory



### Extra Deep Outlet Box

For oversized wiring devices such as fan speed controls, dimmer switches, and GFCIs (1 3/4" deep).  
BW35 White, B35 V5748 Ivory



### Circular Fan Box

Bring power to fans and other round based fixtures. Maximum fixture weight 50 lbs.  
BW4F White, B4F V5738AF Ivory

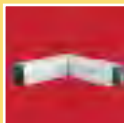

### Flat Elbow

For making a left or right 90° turn on a flat surface.  
BWH6 White, B6 Ivory



### Inside Elbow

For making a 90° turn around an inside corner from wall-to-wall or wall-to-ceiling.  
BWH7 White, B7 Ivory



### Outside Elbow

For making a 90° turn around an outside corner.  
BWH8 White, B8 Ivory



### Accessory Pack

Mounting components for wire channel, including metal clips, straps, and fittings.  
BWH9-10-11 White  
B9-10-11 Ivory



### Twist Elbow

For making a 90° turn around an outside corner while changing channel orientation.  
BW13-14 White, B13-14 Ivory



### T-Fitting

For installations requiring 3-way branching including 90° angle.  
BW16 White, B16 Ivory



### Fitting

For transitioning from metal raceway to 1/2" conduit or from any steel box with 1/2" knockout.  
BW17 White, B17 Ivory

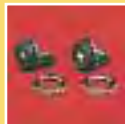

### 1/2" Box Connector

For connecting raceway to conduit boxes with 1/2" knockout.  
B81

## Easy to install:

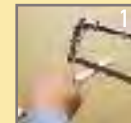

After installing starter box, cut metal raceway to size.

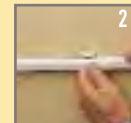

Mount raceway to wall using clips/couplings.

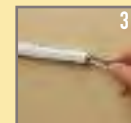

Fish wire through raceway. Connect fittings and devices as required.

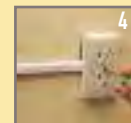

Attach covers and install faceplates.