

# Champ® Pro PVM Series LED Luminaires

UL/cUL Listed  
Type 4X  
IP66

2L

Ideal for general high bay/low bay illumination

## The Champ® Pro PVM LED Family:

Champ Pro PVM Series LED Luminaires are designed to provide full-spectrum, crisp, white light with custom IES Type I, III and V distribution. Nine versions of the VMV LED are available, providing ideal solutions for a wide range of applications.

Model	Typical Lumens (Type V) <sup>Ⓐ</sup>	Watts	Lumens per Watt	Equivalent HID Luminaire	Typical Energy Savings/Lifetime
PVM3L	3,531	29	122	70W-100W	Up to 77%
PVM5L	5,335	43	124	100W-150W	Up to 67%
PVM7L	7,195	62	116	150W-175W	Up to 67%
PVM9L	9,266	85	109	250W-320W	Up to 74%
PVM11L	11,440	113	101	320W-400W	Up to 74%
PVM13L	13,226	130	102	400W	Up to 68%
PVM17L	18,793	168	112	400W-600W	Up to 72%
PVM21L	22,110	196	113	600W-750W	Up to 74%
PVM25L	26,531	232	114	750W-1000W	Up to 77%

## Applications:

- Ordinary non-hazardous locations with mounting heights up to 60 feet
- Heavy industrial, mine site processing areas, platforms, loading docks, tunnels, indoor/outdoor spotlighting, outdoor wall and stanchion mounted general area lighting, and areas requiring frequent on-and-off of lights
- Locations requiring continuous and consistent light levels in extreme ambient temperatures
- Where extremely corrosive, wet, dusty, hot and/or cold conditions exist
- Type 4X, marine, wet locations and hose down environments

## Features:

- Instant illumination and restrike
- Better visibility with crisp, white light
- Cold temperature operation/no warm-up required
- Option for redundancy in drivers with multiple series circuits connected to each driver to avoid complete loss of illumination
- Easy installation – compact modular fixture attaches onto existing Champ mounting module
- Energy-efficient technology – up to 64% energy savings over HID fixtures
- Contains no mercury or other hazardous substances
- Shock- and vibration-resistant solid-state luminaires have no filaments or glass components that could break – greatly reduces the risk of premature failure
- Operating ambient: -40°C to 65°C (PVM3L-PVM11L models); -40°C to 55°C (PVM13L-PVM25L models)
- Full cut-off with no wasted light above the fixture
- 5 year fixture warranty<sup>Ⓑ</sup>

## Certifications and Complies:

- DesignLights Consortium® Qualified (some models are not DLC qualified)<sup>Ⓒ</sup>

### NEC/CEC:

- Wet locations, Type 4X, IP66

### UL Standards:

- UL1598 – Luminaires; UL1598A – Marine

### CSA Standard:

- cUL Listed to CSA Standard CSA C22.2 No. 250

### IEC Standard:

- CE

## Standard Materials:

- Lamp housing and adapter – die cast aluminum with Corro-free™ epoxy powder coat
- Lens – heat- and impact-resistant glass
- Gaskets – silicone
- External hardware – stainless steel
- Factory sealed, no external seals required

## Photometrics:

- Complete photometrics can be found at [www.crouse-hinds.com/photometrics](http://www.crouse-hinds.com/photometrics)

<sup>Ⓐ</sup>Tolerance +/- 10%.

<sup>Ⓑ</sup>Refer to page 2 of the most current authorized distributor price book for Eaton's Crouse-Hinds Division's standard Terms and Conditions.

<sup>Ⓒ</sup>Approved models include: PVM3L/UNV1; PVM5L/UNV1; PVM7L/UNV1; PVM9L/UNV1; PVM11L/UNV1; PVM13L/UNV1; PVM17L/UNV1; PVM21L/UNV1; PVM25L/UNV1; PVM3L/UNV34; PVM5L/UNV34; PVM7L/UNV34; PVM9L/UNV34; PVM11L/UNV34. Refer to [www.designlights.org](http://www.designlights.org) Qualified Products List under family models for full listing details. Not all models are approved for all application categories.



2L

## LED System:

- High intensity discrete power emitters
- Cool white (5000K, 70 CRI) (standard); warm white, (3000K, 80 CRI) (optional)
- Custom Type I, III and V optics available
- Optics clocking in field to align Type I and Type III light patterns to illumination path for PVM13L-PVM25L

## Drivers:

Option	Voltage
/UNV1	120-277 VAC, 50/60 Hz; 108-250 VDC, 50/60 Hz
/UNV34	347-480 VAC, 50/60 Hz

# Champ® Pro PVM Series LED Luminaires

UL/cUL Listed  
Type 4X  
IP66

2L

Ideal for general high bay/low bay illumination

2L

## Custom Optics:

Three optical options to maximize light distribution and intensity:



### TYPE I

Long and rectangular for hallways, walkways, loading docks, catwalks.

Ideal for:

- Mining conveyor belts
- Aisleways and hallways
- Catwalks and walkways
- Ramps and loading docks
- Tunnels with overhead mounts



### TYPE III

Wall mount light distribution, minimizing spillover on the wall.

Ideal for:

- Narrow crosswalks or passages with wall mounted fixtures
- Tunnels with wall mount
- Wall or stanchion mount requiring 180° forward throw beam patterns

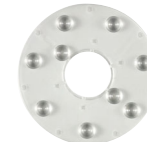

### TYPE V

Regular circular distribution pattern for high/low bay indoor and outdoor ceiling or pendant mount lighting.

Ideal for:

- Pendant, ceiling or stanchion mount overhead building mounts
- Processing mills, industrial plants, large buildings, warehouses, etc.



## Colored LED Options:

- Available in red, blue, green and amber<sup>Ⓛ</sup>
- Reduction in light pollution for night space observation and sky glow due to isolating blue wavelength in red and amber colors
- Wildlife-friendly
- Improves visibility for telescopes in observatories during night sky space exploration

## Electrical Ratings:

	PVM3L	PVM5L	PVM7L	PVM9L	PVM11L	PVM13L	PVM17L	PVM21L	PVM25L
Voltage Range, VAC	120-277	120-277	120-277	120-277	120-277	120-277	120-277	120-277	120-277
Frequency	50/60 Hz	50/60 Hz	50/60 Hz	50/60 Hz	50/60 Hz	50/60 Hz	50/60 Hz	50/60 Hz	50/60 Hz
Input Power (Watts)	29	43	62	85	113	131	168	196	232
Input Amps at 120-277 VAC	0.24 - 0.11	0.35 - 0.16	0.52 - 0.23	0.71 - 0.31	0.95 - 0.41	1.08 - 0.48	1.40 - 0.62	1.64 - 0.73	1.94 - 0.87
Voltage Range, VDC	108-250	108-250	108-250	108-250	108-250	108-250	108-250	108-250	108-250
Power Factor	>0.90	>0.90	>0.90	>0.90	>0.90	>0.90	>0.90	>0.90	>0.90
Total Harmonic Distortion (THD)	<20%	<20%	<20%	<20%	<20%	<20%	<20%	<20%	<20%
Nominal Lumens (Type V) <sup>Ⓜ</sup>	3,531	5,335	7,195	9,266	11,440	13,226	18,793	22,110	26,531

## Occupancy Sensor (Ordered Separately):

### Description

- ¾" NPT entry, 100-277 VAC ..... **ORDC/UNV1**
- M20 entry, 100-277 VAC ..... **ORDC20/UNV1**
- M25 entry, 100-277 VAC ..... **ORDC25/UNV1**

### Cat. #

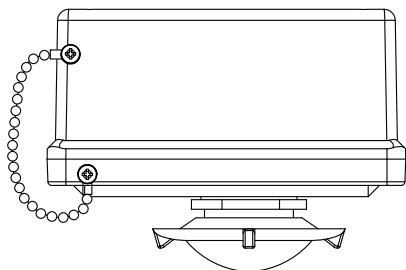

## Occupancy Sensor Accessories (Ordered Separately):

### Description

- TECK non-armoured cable (5 ft.) with TECK glands (¾") ..... **Cable Kit Ord 1**
- Type P non-armoured cable (5 ft.) with ADE 1F glands (¾") ..... **Cable Kit Ord 2**
- Metal-clad non-armoured cable (5 ft.) with TMC glands (¾") ..... **Cable Kit Ord 3**
- SO cable (5 ft.) with ADE 1F glands (¾") ..... **Cable Kit Ord 4**
- Wall mount kit ..... **ORDC WKIT**
- Pendant mount kit ..... **ORDC PKIT**
- Stanchion mount kit ..... **ORDC SKIT**
- Remote control for programming sensor ..... **REMOTE CONTROL 1**

### Cat. #

<sup>Ⓛ</sup> Custom optics not available with colored LEDs. One model per color; see catalog numbering system on next page.

<sup>Ⓜ</sup> Tolerance +/- 10%.

# Champ® Pro PVM Series LED Luminaires

Ideal for general high bay/low bay illumination

UL/cUL Listed  
Type 4X  
IP66

2L

2L

## Catalog Numbering System:

Part number example

PVM17LW2AR1G/UNV1 S890

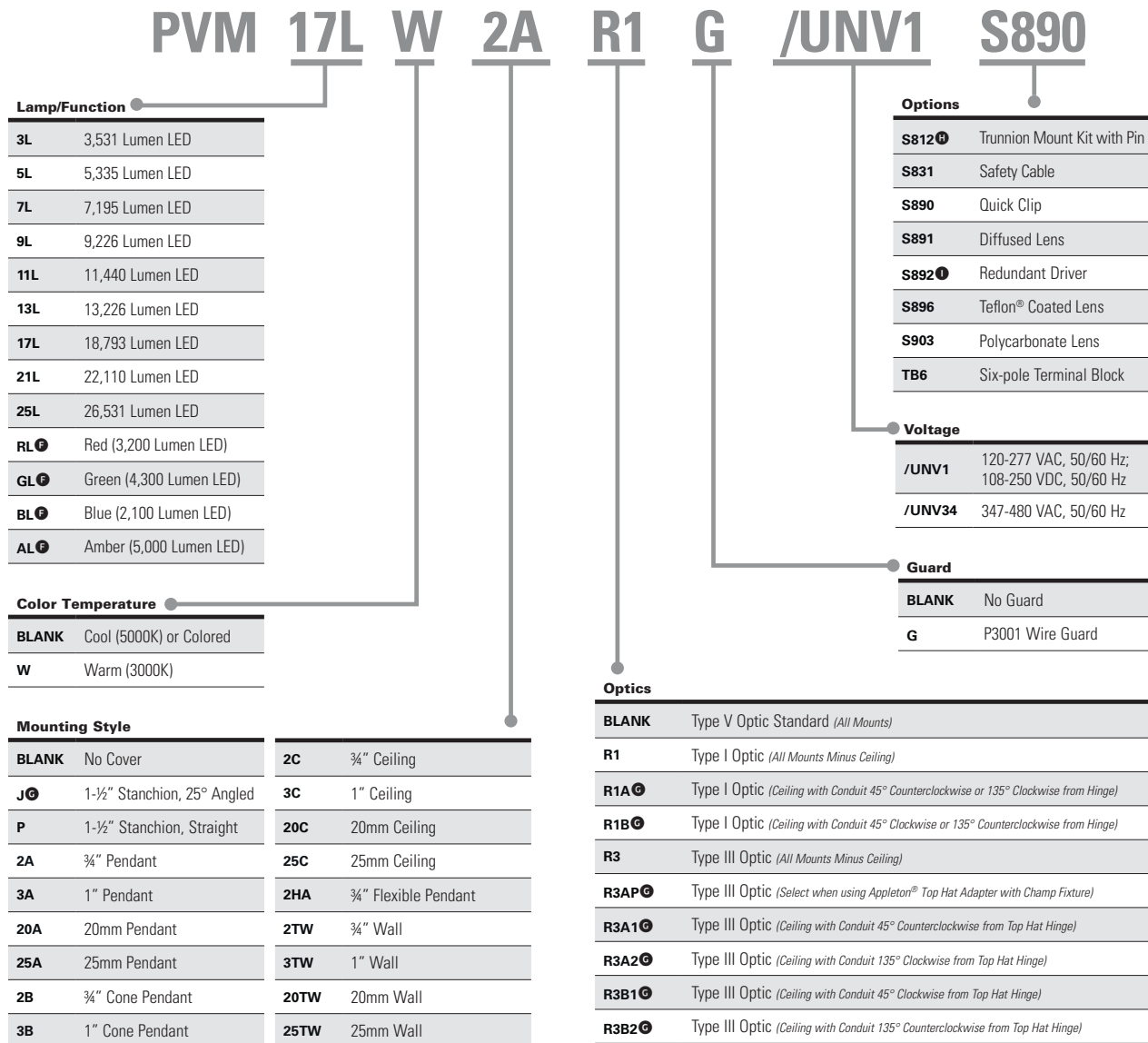

## Accessories (Ordered Separately):

Description	Cat. #
• Photocell, 120V, 50/60 Hz	D2S20
• Photocell, 208-277V	D2S208 277
• Trunnion mount kit with pin	VMVL S812 K1 <sup>H</sup>
• Wire guard with captive mounting hardware	P3001
• Top hat adapter	CHMM1

For retrofitting Appleton® MercMaster III top hats to Champ Pro PVM Luminaires

<sup>F</sup> Custom optics not available with colored LEDs.

<sup>G</sup> For PVM3L-PVM11L only.

<sup>H</sup> Order with ceiling mount only.

<sup>I</sup> Available for PVM5L and PVM7L only. Redundant driver standard on PVM9L-PVM25L models. 7L = 6,616 lumens with S892 suffix.

Teflon® is a registered trademark of E. I. duPont Co.



CHMM1

# Champ® Pro PVM Series LED Luminaires

UL/cUL Listed  
Type 4X  
IP66

2L

Ideal for general high bay/low bay illumination

2L

## Dimensions:

### Stanchion - 25° Angled

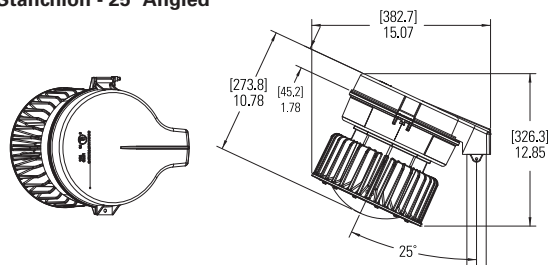

### Stanchion - Straight

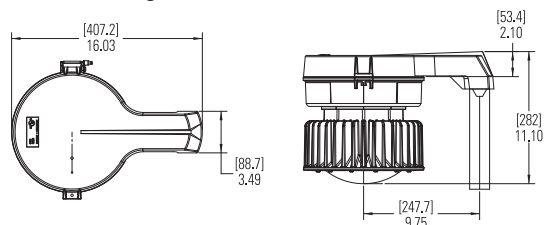

### Pendant

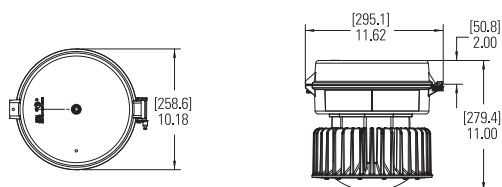

### Ceiling

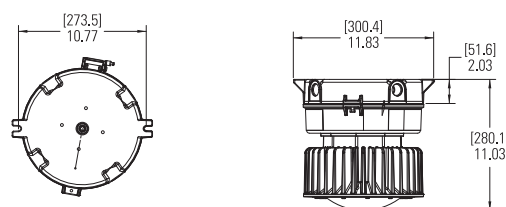

### Wall

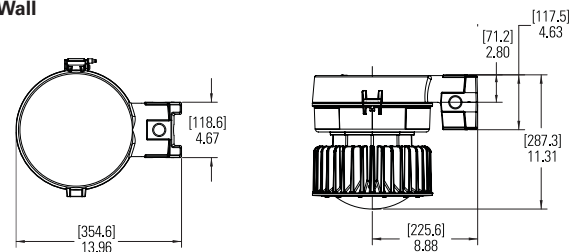

### Cone Pendant

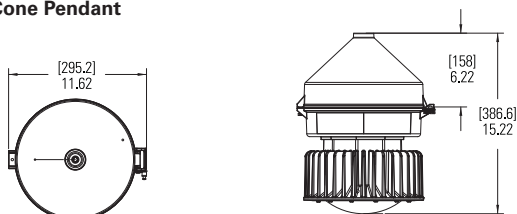

### Trunnion

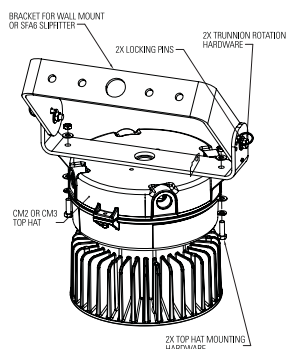

## Net Luminaire Weights:

Model	Lbs.	Kg.
PVM3L-PVM11L	21.80	8.07
PVM13L & PVM17L	36.00	16.32
PVM21L & PVM25L	44.00	19.95
<b>Add Mounting Modules:</b>		
Pendant	1.25	0.57
Cone Pendant	4.00	1.81
Flexible Pendant	1.50	0.68
Ceiling	2.75	1.25
Wall	4.50	2.04
Angled Stanchion <sup>1</sup>	3.50	1.59
Straight Stanchion	4.50	2.04

<sup>1</sup> Angled stanchion for PVM3L-PVM11L models only.