

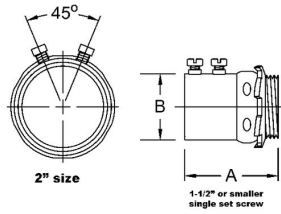

RIGID SET SCREW CONNECTORS - STEEL

Set Screw Connector, Steel

B24



Catalog #: 3006

APPLICATIONS

For use in dry locations to bond unthreaded rigid/IMC conduit to a box or enclosure. RACO steel set screw connectors provide concrete-tight connections when taped.

PRODUCT FEATURES

All steel construction ensures mechanical protection for the raceway
All components are zinc electroplated for corrosion protection

UL LISTED

Standard 514B, UL Listed E195969

COMPLIANCES

MSDS
www.hubbell-rtb.com/certifications/Hubbell-RACO_MSDS_for_WP_Boxes_and_Fittings_January_2015.pdf

GENERAL PRODUCT INFORMATION

Sub Class: Uninsulated
Trade Size: 1-1/2 in.

DRAWING DIMENSIONS

Dimension A: 1-7/8 in.
Dimension B: 2-1/4 in.
Thread Spec. B: 1-1/2 in. - 11-1/2 NPS

PACKAGING

Package Type: Carton
Ship Carton Qty.: 5
Product UPC-A Labeled: No
Weight (Lbs. Per/C): 80.50
Ship Carton Length (in.): 6.25
Ship Carton Width (in.): 4.50
Ship Carton Height (in.): 4.25
Ctn Weight (Lbs.): 4.03
UPC Number: 050169030066
I2of5: 50050169030061