

HUBBELL® EDUCATION

Application Guide



HUBBELL

The Education Connection



Hubbell – The Education Connection



Table of Contents

Hubbell Knows Education

Overview 3
 Primary Education Facilities 4-5
 Continuing Education Facilities 6-7

Classrooms and Learning Spaces 8-9

Hubbell X-END Plug-n-Play System, Flat Panel Connection Enclosures, H-MOSS® Ceiling Sensors, AV Ceiling Enclosures and Raceway

Administration Offices 10-11

H-MOSS® Wall Sensors, Hubbell SystemOne Fire-Rated Poke-Throughs, Hubbell iSTATION Frames and Modules, Category Rated Jacks and Patch Cords

Residence Halls 12-13

Tamper-Resistant GFCI Receptacles, SNAPConnect® Receptacles, H-MOSS® Sensors, F-Type Connectors and Faceplates

Food and General Services 14-15

Flat Panel Connection Enclosures, Disconnect Switches, Hi-Impact Enclosures and Watertight Safety-Shroud® Twist-Lock®

Auditorium and Performing Arts 16-17

Hubbell Twist-Lock® Devices, Single Pole, QuadCab® and Kellems® Grips

Science and Research Laboratories 18-19

Pre-Wired Raceway, Extra Heavy-Duty Tamper-Resistant GFCI Receptacles, Surface Mount Boxes and Extra Heavy-Duty Receptacles

Data Centers 20-21

XXL Organizers, Racks, Bonding and Grounding, High Density Patch Panels, Fiber Solutions and IEC Pin & Sleeve Devices

Athletic Facilities and Outdoor Recreation 22-23

SPIDER®, TrukTrak®, TredTrak® and AccessTrak®, QuadCab Cabinets and Watertight Wiring Devices

Medical Centers and Health Services 24-25

Hospital Grade Receptacles, Hospital Grade GFCI Receptacles, Shielded CAT 6A Jacks and Hospital Grade Plugs and Connectors

Mechanical and Maintenance Facilities 26-27

IEC Mechanical Interlocks, Cord Reels, Ceiling Enclosures and Portable GFCI



Watertight Wiring Devices



Raceway & Sensors



SystemOne Boxes & FRPT

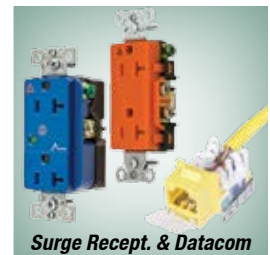

Surge Recept. & Datacom



Cable Protection

Hubbell Solutions for Education Facilities

The need for technologically advanced, cost-effective, safe and long-lasting facilities has today's schools and universities faced with a new reality in planning and carrying out new and retrofit facility projects. Today's education facilities must take into account several factors during construction and renovation. From classrooms and learning spaces, to administration and facility operations, Hubbell Wiring Systems has the solutions to help education facilities meet these key challenges.



Effectively Delivering Power, Data and Audio/Video (AV)

Today's education facilities need to ensure effective power, data and AV delivery to support everything from online e-learning, interactive audio/video and multimedia video presentations, to real-time delivery of the latest research information and enhanced communication—all of which has become vital to modern teaching, learning and decision making.

Reducing Upfront and Long-term Facility Costs

When updating inadequate facilities, schools and universities need to reduce initial upfront and long-term costs by ensuring that projects are completed quickly and efficiently. At the same time, planning new and retrofit projects requires solutions that enable lower maintenance and operating costs over the life of the facility.

Maintaining Energy Efficiency and Sustainability

To further reduce operating costs, education facilities administrators and designers are thinking long-term, striving for energy efficiency. The use of energy-saving technologies including open space environments that increase daylight and data center designs for improving airflow are just some of the ways education facilities can ensure more energy efficient, sustainable facilities.

Ensuring Maximum Safety and Durability

Education facilities are demanding environments where maintaining safety for both students and staff is critical. New and retrofit projects therefore require devices that ensure safety, are durable and impact resistant to withstand everyday use, and provide reliable, long-lasting performance.

For more than 100 years, Hubbell has provided high-performance, reliable solutions for primary, secondary and higher education facilities. Only Hubbell has the comprehensive line of wiring devices to help today's educational facilities effectively deliver power and technology, reduce costs and ensure maximum safety.



Audio/Visual



Safety



Energy Savings



Sustainability



Durability

Primary and Secondary Education Facilities



Power, Data and Audio/Video Delivery

Technology is helping engage students, improve teaching, and facilitate communication. Hubbell's power, data and AV delivery solutions support everything from smartboards and projector systems, to computers and networking equipment.



- Multimedia Audio/Video connections and enclosures
- Copper and fiber network cable and connectivity
- Data center and cable management solutions

Installation Efficiency

Hubbell has a wide range of solutions specifically designed to provide efficient installation, deployment and replacement that ultimately help schools complete new and retrofit projects faster while reducing overall costs.



- Pre-connectorized wiring devices
- Plug-n-play AV assemblies
- Pre-wired raceway systems



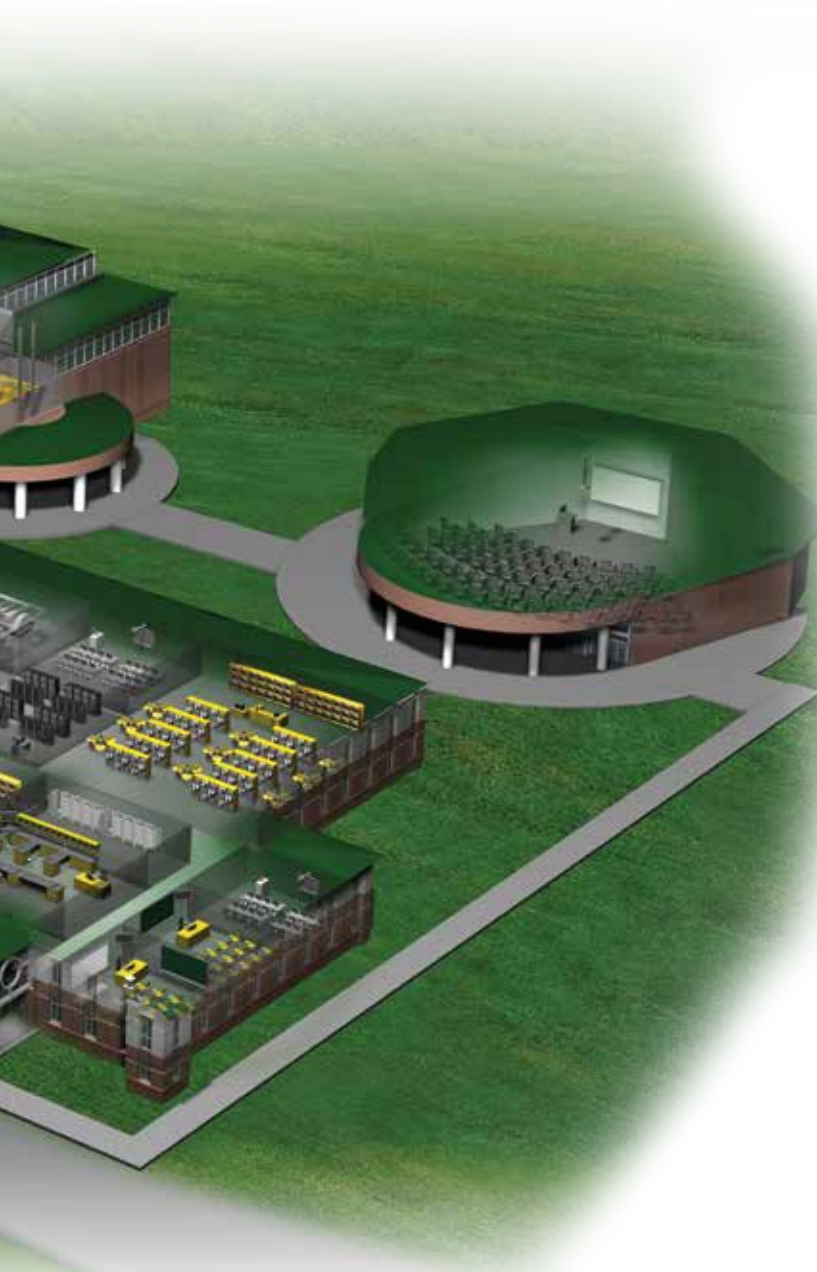

Energy Efficiency

Modern education facilities incorporate new technologies such as energy efficient lighting controls, reducing energy consumption and costs.



- Wired and wireless ceiling and wall-mount occupancy sensors
- Daylight harvesting sensors
- Data center airflow management solutions

Safety and Durability

Students and personnel need to be protected from the hazards of electricity, while secondary educational facilities may encounter intentional or unintentional damage. To reduce risk, solutions need to provide reliable safety, protection and durability.



- Impact and tamper-resistant solutions
- GFCI, isolated ground and surge protection devices
- Weatherproof, watertight and locking devices

Universities and Continuing Education Facilities



Power, Data and Audio/Video Delivery

At the university level, advanced high-speed technology is broadening access through online courses, facilitating research, improving administrative operations, attracting and retaining students.



- High-speed copper and fiber network solutions
- Advanced data center and cable management solutions
- Multimedia and audio/video systems

Installation Efficiency

With solutions that offer fast, efficient installation of power, data and AV connections, Hubbell enables today's college and university facility departments to maximize investments in building infrastructure during new and retrofit construction projects.



- Pre-fabricated, pre-terminated wiring solutions
- Pre-wired metallic raceway
- Plug-n-play data center solutions





Energy Efficiency

Many colleges and universities are striving for maximum energy savings and sustainability, as evidenced by the growing number of institutions acquiring various levels of LEED certification.



- Occupancy and daylight harvesting sensors
- Data center space savings and airflow management

Safety and Durability

Residence halls and public spaces require solutions that prevent electrical shock and trip hazards, while harsh outdoor stadium environments, food service, medical and science facilities require durable, reliable devices.



- Harsh environment and watertight devices
- Surge protection and motor disconnects
- Safe temporary power solutions

Classrooms and Learning Spaces



Today's classroom offers a new type of learning environment with educators using state-of-the-art smartboards, video conferencing, and multimedia technologies to engage students. At the same time, these frequently-used spaces require solutions that enable fast, efficient installations and provide cost-effective, safe learning environments for educators and students.

Power, Data and Audio/Video Delivery

Classrooms and learning spaces require comprehensive wall, ceiling and in-floor solutions that deliver power, data and AV to a variety of technology devices and equipment.

Installation Efficiency

When it comes to upgrading or installing new devices in classrooms, contractors and maintenance personnel need to get in and out of these spaces as quickly and efficiently as possible.

Class Rooms • Libraries • Lecture Halls • Computer Labs • Restrooms



Hubbell X-END AV Plug-n-Play System

- Four inch connector tail
- Swap out application patch cords and tails utilizing the same horizontal cable



AV Plug-n-Play X-END Horizontal Cable Runs, Male, Black

Description	Catalog No.
Non-plenum, 8-pin	VGA6xxBK
Plenum, 8-pin	VGA6PxxBK
Non-plenum, 8-pin, with 3.5mm	VGA36xxBK
Plenum, 8-pin, with 3.5mm	VGA36PxxBK

xx = Length: **15** (15 ft), **25** (25 ft), **35** (35 ft), **50** (50 ft), **75** (75 ft), and **100** (100 ft)
Contact Hubbell customer service for custom lengths, minimum quantities and lead times may apply.



VGA Plug-n-Play X-END Connections



Quantity	15-Pin (F) to 8-Pin (F)				15-Pin (M) to 8-Pin (M) 8" Tail	
	Straight 180°	Angled 45°	Angled 90°	8" Tail	Non-Plenum	Plenum
1-Pack	15S6P1	15A6P1	15N6P1	15T6P1	15M6P1	15MP6P1
10-Pack	15S6P10	15A6P10	15N6P10	15T6P10	15M6P10	15MP6P10

Classrooms and Learning Spaces

Data and Audio/Video Connectivity

Hubbell's netSELECT® FPTV connection enclosure delivers high-density connectivity and power in the wall. In-wall connections allow flat panel displays and interactive smartboards to sit flush without dangling cords. It quickly installs to studs or sheetrock without additional components or hardware.



FPTV Connection Enclosure

2-gang in-wall enclosure, white
Steel cover for NSAV6 series, white

NSAV62M
NSAV6C



Power Kits

Standard power kit, white
Surge protected power kit, blue

NSOKP
NSOKPS



Hubbell iSTATION HDMI 110 UTP Extenders

110 UTP HDMI extender (pair), Decorator 5 Volt DC, 2 4-pair Module
ISFH110xx
IMH1102xx
xx = Color: **BK** (Black), **EI** (Electric Ivory), **GY** (Gray), **OW** (Office White), and **W** (White).

Unloaded 1-Gang Plates and Frames

Hubbell iSTATION adapter frame
Blank plate, white
Decorator plate, white
iSTATION plate, white
4-port keystone plate, white

NSAVIMFW
NP14W
NP26W
IMF1W
NSP14W

Energy Efficiency

Lighting classrooms consumes a substantial amount of the education budget. However, significant savings can be realized by turning off lights when they are not needed. Occupancy sensors provide an inexpensive way to guarantee that energy waste is kept to a minimum.

H-MOSS® Ceiling Sensors



Adaptive Dual Technology

2000 sq. ft. **ATD2000C**
1000 sq. ft. **ATD1000C**
500 sq. ft. **ATD500C**

Adaptive Ultrasonic Technology

2000 sq. ft. **ATU2000C**
1000 sq. ft. **ATU1000C**
500 sq. ft. **ATU500C**

Ceiling Accessories

Infrared NEMA 4X Enclosure **ACIPE**
Ceiling Mount Wire Guard **ACMG**
Raceway Adapter **ACMRA**

All ceiling sensors must use a control unit.

Control Unit

120/277V AC, 50/60 Hz for use with ATD, ATU and ATP series ceiling/wall mount sensors
Same as CU300A above, manufactured in U.S.A.

CU300A

CU300AU



Additional Products of Interest

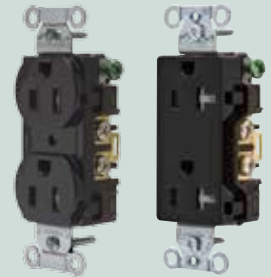

Tamper-Resistant Receptacles

Hubbell offers a variety of tamper-resistant receptacles that comply with NEC requirements that all 15A and 20A 125V receptacles shall be "tamper-resistant" in child care facilities and residencies.



RE-BOX® Remote Equipment Cabinet

RE-BOX® provides an efficient and organized enclosure to house patch panels and active equipment in classrooms to a remote telecom room.

Power and Multimedia Delivery

The AV Ceiling Enclosure is designed to work with active AV devices to integrate AV distribution, data connections and power in one location, providing a direct connection to a projector or a display device.

AV Ceiling Enclosure

White enclosure 24"x12"x 8", 2-20 Amp duplex receptacles & 2-gang back box
Non-Plenum **AVCE1**
Plenum Rated **AVCE1P**
Data Kit **AVCE1KIT**



Non-Metallic Raceway

Two channel raceway, 5 ft., 7 ft. or 10 ft. lengths.

Description	5 ft.	7 ft.	10 ft.
Base & Cover	PW2BC5	PW2BC7	—
With Adhesive	PW2ABC5	PW2ABC7	—
Base	PB2B5	—	PB2B10
Cover	PB2C5	—	PB2C10
Split Cover	PB2SPL5	—	PB2SPL10

For full offering of Raceways and fittings, please visit our online catalog.

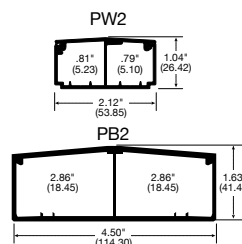

HDMI 110 UTP Extenders

Designed to provide aesthetically-pleasing access to video and audio, the 110 style connections transport 1080p video and flawless audio.

Administration Offices



Administration offices have similar technology needs to classrooms, but are more focused on ensuring maximum productivity. Faculty and staff are using technology to improve communication, productivity and organizational development. These spaces also strive to conserve energy and are designed to be more aesthetically pleasing while offering a modern, more productive working environment for staff.

Offices • Conference Rooms • Break Rooms • Restrooms



Energy Efficiency

Energy saving H-MOSS® wall switches automatically turn OFF lights in vacant offices and conference rooms to reduce energy consumption on campus.

Power, Data and Audio/Video Delivery

Reliable surge strips and receptacles keep equipment up and running while the delivery of power and data supports the proliferation of computers, access to systems and information, and enhanced communication.

H-MOSS® Wall Switches

Dual (Ultrasonic and Passive Infrared)

1000 square foot coverage with photocell, 800W Incandescent, 1000W Fluorescent at 120V AC, 1800W Fluorescent at 277V AC, 50/60Hz

Description	Ivory	White
Single Circuit; 1 Button for manual/auto control	AD2000I1	AD2000W1
Single Circuit; Auto control with no button	AD2000I1N	AD2000W1N
Dual Circuit; 2 Buttons for manual/auto control	AD2000I2	AD2000W2
Dual Circuit; Auto control with no button	AD2000I2N	AD2000W2N

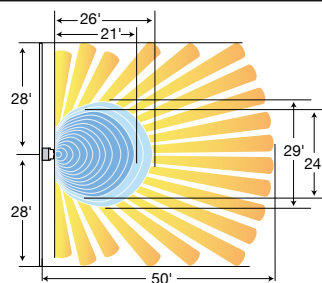
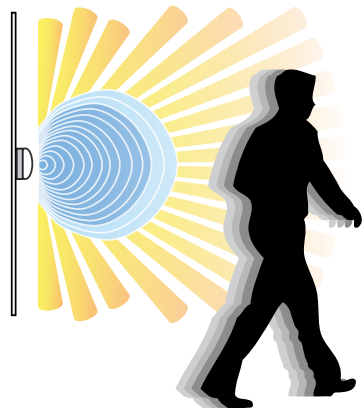

Minor Motion: ■ Ultrasonic ■ PIR Major Motion: ■ Ultrasonic ■ PIR



Two Button



One Button



No Buttons



Administration Offices

Power and Multimedia Delivery

Hubbell SystemOne features a unique universal cover assembly and a wide variety of application sub-plates that install on Hubbell SystemOne Fire-Rated Poke-Throughs and floor boxes. Hubbell SystemOne delivers a consistent, aesthetic and functional solution for applications in the floor or through the floor.

Hubbell SystemOne



Fire-Rated Poke-Throughs

Description	Assembled Units*	Through Floor Fittings
(4) 20A; (4) keystone	S1PT4X4xx	S1PT4X4FIT
Dual Style Line®	S1PTxx	S1PTFIT
Modular AV	S1PT3IMxx	S1PTAVFIT
Furniture Feed	S1PTFFxx	—

*Factory assembled units include through floor fitting, cover and sub-plate.

For full offering of SystemOne sub-plates and accessories, please visit our online catalog.

Sub-Plates

Style Line® Decorator/ GFCI for power and/or AV	S1SP	
(4) 20A and (4) keystone openings	S1SP4X4	
StyleLine® Decorator/ Duplex for power and/or AV	S1SPDUSL	

Covers

Cast aluminum Carpet construction with Tile	S1CFCxx S1TFCxx	
a durable powder coat finish		

xx = Color/Finish: **AL** (Aluminum Finish), **BRS** (Brass Finish), **BL** (Black) and **GY** (Gray).

AV Connections

Hubbell iSTATION products provide a consistent and practical solution for delivering all types of connections where you need them — in the wall, floor or table. Hubbell iSTATION's modular design allows users to custom configure plate solutions to their requirements.

Modular Face Plate Frames

Front Loading Frames	1-Gang	IMF1xx
	2-Gang	IMF2xx

Modules

RCA Component, Video, Solder, 1 Unit	IMCRS1xx
RCA Component, Video, Gold, Pass-Through, F/F Coupler, 1 Unit	IMCRF1
HDMI Feed-Through Coupler	HDMIC14
Keystone HDMI Feed-Through	SFHC14xx

xx = Color: **AL** (Almond), **BK** (Black), **EI** (Ivory), **GY** (Gray), **OW** (Office White) and **W** (White).

Unloaded Modules

Keystone; 1-Port; 1 Unit	IM1K1xx
Keystone; 2-Port; 1 Unit	IM2K1xx
SC Angled; 1-Duplex; 1.5 Unit	IM1SCA15xx
SC Angled; 2-Duplex; 2 Unit	IM2SCA2xx

Blank 15-Pin/9-Pin HDMI

HD15/9-pin or HDMI; 1 Unit w/ 3.5mm Stereo Jack; 1.5 Unit w/ 3.5mm SJ+AV Conn; 2 Unit	IMBDS1xx IMBDSA15xx IMB153X2xx
---	---

Data and Audio/Video Connectivity

Hubbell's category rated modular jacks and patch cords provide leading edge performance and innovative designs to support today's Ethernet protocols, IP devices and high bandwidth audio video applications.

Data Jacks

Description	Category 6A	Category 6	Category 5e
1 per Bag/Carion of 25	HJ6Axx	HXJ6xx	HXJ5Exx
25 per Bag/Carion of 1	HJ6Axx25	HXJ6xx25	HXJ5Exx25

xx = Color: **AL** (Almond), **B** (Blue), **BK** (Black), **EI** (Electric Ivory), **GL** (Gold), **GY** (Gray), **GN** (Green), **LA** (Light Almond), **OW** (Office White), **OR** (Orange), **P** (Purple), **R** (Red), **TI** (Telco Ivory), **W** (White) and **Y** (Yellow).

Patch Cords

Description	Category 6A	Category 6	Category 5e
Snagless Design	HC6Axxyy	HC6xxyy	HC5Exxxy

xx = Color: **B** (Blue), **BK** (Black), **GY** (Gray), **GN** (Green), **OR** (Orange), **P** (Purple), **R** (Red), **W** (White) and **Y** (Yellow).
yy = Standard Length: **01** (1ft), **03** (3ft), **05** (5ft), **07** (7ft), **10** (10ft), **15** (15ft), **20** (20ft).

Additional Products of Interest



SystemOne Recessed 6" and 8" Fire-Rated Poke-Throughs

Designed to handle today's increasing data and AV requirements while providing the highest quality finish with greater durability than paint. Available in the following plated finishes: brass, nickel & oil rubbed bronze, recessed SystemOne products are easily installed with a standard 6 or 8 inch core hole, or with our available pre-pour tubes.



Energy Efficiency

Adaptive Technology is a Hubbell breakthrough that delivers benefits to both building owners and occupants. The building owner achieves reduced energy costs, fewer adjustments and less maintenance, and the building occupant experiences fewer false-OFFs and disturbances.



Hubbell Surge Protective Devices (SPDs)

A cascading approach is encouraged for optimal protection that includes surge protection at the service entrance, branch panel and the point-of-use. Hubbell offers a comprehensive offering of panel surge products, innovative surge strips, and the broadest surge receptacle offering in the industry.

Residence Halls



With more information, classes and entertainment being delivered online, technology has become an integral component of student life. In fact, advanced technology is one of the most vital components for continuing educational facilities to attract students. At the same time, safe living environments are paramount to protecting students and reducing risk.

Power, Data and Audio/Video Delivery

Hubbell's wide range of voice, data and video connectors and plates are ideal for delivering internet access, entertainment, phone service and security systems to residence halls.

Safety and Durability

Frequent plugging in of electronics in these spaces requires durable wiring devices, while bathrooms, kitchenettes and other potentially damp areas need tamper and weather resistant GFCI receptacles to ensure protection of students.

Dorm Rooms • Common Areas • Kitchens • Restrooms



Tamper-Resistant GFCI Receptacles



The combination of GFCI protection and tamper-resistant safety provides an ideal "one-stop" Hubbell solution. Hubbell tamper-resistant GFCI devices also include a weather resistant rating per NEC® 406.8, providing UV and corrosion resistance.



AUTOGUARD® GFCI Receptacles Tamper-Resistant, Weather Resistant



15A 125V
NEMA 5-15R



20A 125V
NEMA 5-20R

Description	Color	15A 120 V AC	20A 125V AC
Flush, nylon face, back and side wired, multiple drive screws, automatic grounding clip 	Almond	GFTWRST15AL	GFTWRST20AL
	Black	GFTWRST15BK	GFTWRST20BK
	Brown	GFTWRST15	GFTWRST20
	Gray	GFTWRST15GY	GFTWRST20GY
	Ivory	GFTWRST15I	GFTWRST20I
	Light Almond	GFTWRST15LA	GFTWRST20LA
	Red	GFTWRST15R	GFTWRST20R
	White	GFTWRST15W	GFTWRST20W



Residence Halls

Installation Efficiency

Hubbell's SNAPConnect receptacles make installation fast, easy and consistent so you can complete projects sooner — saving more than three minutes per device!

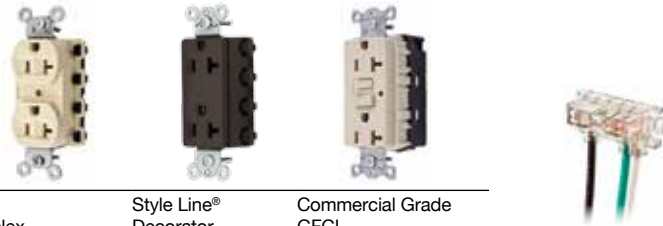

SNAPConnect® Receptacles and GFCI

Config.	NEMA	Color	Duplex	Style Line® Decorator	Commercial Grade GFCI
	15A 125V	Black	SNAP5262BKA	SNAP2152BKA	GFR15SNAPBKNA
		Ivory	SNAP5262IA	SNAP2152IA	GFR15SNAPINA
		White	SNAP5262WA	SNAP2152WA	GFR15SNAPWNA
		Other	SNAP5262xx	SNAP2152xx	GFR15SNAPxxNA
	20A 125V	Black	SNAP5362BKA	SNAP2162BKA	GFR20SNAPBKNA
		Ivory	SNAP5362IA	SNAP2162IA	GFR20SNAPINA
		White	SNAP5362WA	SNAP2162WA	GFR20SNAPWNA
		Other	SNAP5362xxA	SNAP2162xxA	GFR20SNAPxxNA

SNAPConnect® Right Angle Pigtailed Connector

Clear right angle terminal with 6 inch leads #12 AWG THHN/THWN-2, 600V wire

Solid wire **SNAP1RA**
Stranded wire **SNAP2RA**

xx = Color: **AL** (Almond), **No Suffix** (Brown), **GY** (Gray), **LA** (Light Almond) and **R** (Red).

Energy Efficiency

Significant savings can be realized by turning off lights when they are not needed. Occupancy sensors provide an inexpensive way to guarantee that energy waste is kept to a minimum.

Adaptive Passive Infrared Technology Wall Switches

1-Circuit, 1-button	AP2000xx1
1-Circuit, no button	AP2000xx1N
2-Circuit, 2-buttons	AP2000xx2
2-Circuit, no buttons	AP2000xx2N

xx = Color: **BK** (Black), **GY** (Gray), **I** (Ivory), **LA** (Light Almond) and **W** (White).



Control Units

120/277V AC, 50/60Hz for use with ATP series ceiling/wall mount sensors **CU300A**

Same as CU300A above, manufactured in U.S.A. **CU300AU**



Ceiling Sensors

1500 sq. ft.	ATP1500C
450 sq. ft.	ATP600C



Accessories Ceiling

Infrared NEMA 4X Enclosure **ACIPE**
Ceiling Mount Wire Guard **ACMG**
Raceway Adapter **ACMRA**



Wall Mount Sensors

1600 sq. ft.	ATP1600W
--------------	-----------------



Wall Mount and Switch

Wall Switch Wire Guard **AWSG**
Wall Mount Wire Guard **AWMG**

Data and Audio/Video Connectivity

Requiring no solderin, these connectors install with a snap and provide quick, easy "screw-on" termination. Compatible with TV, CATV and CCTV, home theater and entertainment systems, satellite, security and surveillance systems, VCR/DVD applications.

F-Type Connectors



F-Type Coupler Bulkhead F/F	F-Type Coupler Bulkhead F/F Gold	F-Type to RCA Bulkhead F/F Gold	F-Type Recessed
SFFxxX	SFFGxx	SFRFGxx	SFGRFxx

xx = Color: **AL** (Almond), **BK** (Black), **GY** (Gray), **EI** (Ivory), **LA** (Light Almond), **OW** (Office White) or **W** (White).
SFRFG Series not available in Almond or Light Almond. **SFGRF** Series not available in Light Almond.

IFP Faceplates

Delivery	Single Gang				Double Gang		
	1-Port	2-Port	3-Port	4-Port	6-Port	9-Port	12-Port
1/bag, Carton/25	IFP11xx	IFP12xx	IFP13xx	IFP14xx	—	—	—
1/bag, Carton/10	—	—	—	—	IFP26xx	IFP29xx	IFP212xx

xx = Color: **AL** (Almond), **BK** (Black), **EI** (Electric Ivory), **GY** (Gray), **LA** (Light Almond), **OW** (Office White) or **W** (White).

Additional Products of Interest



SNAPConnect® Switches

Hubbell SNAPConnect® Switches offer a modular design that improves installation efficiency and simplifies change-outs. Available in 15A and 20A, single-pole and three way devices.



Wireless Sensors

Start saving immediately with Hubbell's new wireless lighting controls. They require no additional wiring and install quickly — perfect for rapidly changing environments or areas with difficult access.



SpikeShield® Surge Strips

Hubbell SpikeShield surge protective devices feature a wide range of products to handle every application or need. A good-better-best approach to surge protection levels offers products at every price point; this allows customers to choose the proper protection level for their application.

Food and General Services



Cafeterias • Kitchens • Book Stores • Student Lounge



Both primary and continuing education facilities include food preparation areas, requiring easy-to-use, safe and durable power connections that accommodate a variety of appliances. Today's education facilities also strive to deliver advanced technology to food service areas for Internet access, digital signage for displaying menus, entertainment systems, and point-of-sale registers.

Safety and Durability

Hubbell offers an array of ground fault and watertight devices that are ideal for use in kitchen and food service areas, as well as disconnect switches to safely shut-down larger machinery like dishwashers and exhaust systems.

Power, Data and Audio/Video Delivery

Flat panel TV enclosures are ideal for keeping cords hidden behind digital signage systems in cafeterias while HI-Impact enclosures protect equipment needed to deliver power, data and multimedia.

Flat Panel TV Enclosures

Hubbell's netSELECT® FPTV in-wall connection enclosure allows flat panel displays and interactive smartboards to sit flush without dangling cords. It quickly installs to studs or sheetrock without additional components or hardware.

FPTV Connection Enclosure

2-gang in-wall enclosure, white **NSAV62M**
Steel cover for NSAV6 series, white **NSAV6C**



Power Kits

Standard power kit, white **NSOKP**
Surge protected power kit, blue **NSOKPS**



Power Connections

Large equipment like back-up generators, compactors, loading dock equipment, HVAC units and air handlers all need high-capacity, safe and reliable power. These enclosures are non-metallic Type 4X Rated for washdown.



Circuit-Lock® Unfused Disconnect Switches

Description	Catalog No.
30A disconnect switch	HBLDS3*
60A disconnect switch	HBLDS6*
100A disconnect switch	HBLDS10*
Auxiliary contacts, "break after main break" ¹ set of n/o & n/c contacts	HBLAC1
Auxiliary contacts, "break before main break" ¹ set of n/o contacts	HBLAC2

¹Add suffix "AC" for disconnect with one HBLAC1 aux. contact.



Circuit-Lock® Fused Disconnect Switches

Description	Catalog No.
30A disconnect switch	FDS30*
60A disconnect switch	FDS60*
Auxiliary contacts, normally open, A600 pilot duty	ACFSNO
Auxiliary contacts, normally closed, A600 pilot duty	ACFSNC

*Class "J" fuses not included.

30A Units supplied with (2) 1 in. N.P.T. raintight conduit fittings.

60A Units supplied with (2) 1 1/4 in. N.P.T. raintight conduit fittings.

Additional Products of Interest



Watertight Devices

When it comes to safety, most everyone knows that water and electricity can create a dangerous environment. Ensuring a watertight seal for electrical devices is critical to ensuring maximum safety of personnel in any wet environment. Hubbell Watertight Twist-Lock® devices have become the industry standard for maintaining a watertight seal.

Power and Multimedia Delivery

Hubbell's HI-Impact enclosures are available in NEMA 3R, 4, 4X, 12 and 13 ratings, providing a mini telecom room for harsh environments.

User-Configurable Version

Description	Height		
	24" (610)	36" (914.4)	48" (1219.2)
Cold Rolled Steel, Gray Powder Coat, NEMA 3R	IR2U3RG	IR3U3RG	—
Cold Rolled Steel, Gray Powder Coat, NEMA 4/12/13	IR2UG	IR3UG	IR4UG
Stainless Steel, Brushed, Unpainted, NEMA 4X	IR2USS	IR3USS	—



Pre-Configured Version

Description	Height	
	36" (914.4)	48" (1219.2)
Cold Rolled Steel, Gray Powder Coat, NEMA 4/12/13 Contents: 1 enclosure; 1 bottom-hinged patch panel bracket, 4U (REK19); and 1 equipment mounting bracket, 5U (REKZ).	IR3PG	IR4PG



HI-Impact™ Copper Connectors

HI-Impact connectors provide a rugged, durable IP67 Rated connection in a standard configuration for Hubbell Category 6 and 5e rated connectivity.

Power Connections

Watertight Safety-Shroud® Twist-Lock® devices are constructed of highly impact-resistant thermoplastic for a UL Type 4X rating in heavy duty environments. The integral Safety-Shroud virtually eliminates bent and broken plug blades, leading to longer equipment life while providing extra protection for personnel.

Watertight Safety-Shroud® Twist-Lock®

NEMA Rating	Color	Coded by Voltage	Poles/Wires	Plug	Connector	Receptacles
20A	Yellow	125V	L5-20	2P/3W	HBL2311SW	HBL2313SW HBL2310SW
20A	Blue	250V	L6-20	2P/3W	HBL2321SW	HBL2323SW HBL2320SW
20A	Gray	277V AC	L7-20	2P/3W	HBL2331SW	HBL2333SW HBL2330SW
20A	Blue	3Ø 250V	L15-20	3P/4W	HBL2421SW	HBL2423SW HBL2420SW
30A	Blue	3Ø 250V AC	L15-30	3P/4W	HBL2721SW	HBL2723SW HBL2720SW
30A	Red	3Ø 480V AC	L16-30	3P/4W	HBL2731SW	HBL2733SW HBL2730SW



Stainless Steel Data Plates

Stainless steel plates are designed for flush mounting of Hubbell connectivity providing corrosion resistance from frequent washdown.

Auditorium and Performing Arts



Education facilities typically include auditoriums and performing arts centers for a variety of learning and entertainment activities including band performances, plays and general assemblies, or large-scale seminars, theatre productions and award ceremonies. These spaces must accommodate the latest audio-visual technology for presentations while providing maximum reliability to ensure that the show goes on.

Power, Data and Audio/Video Delivery

From access to multimedia applications at the presenter's podium on stage, to projection, lighting, curtain and sound systems, these spaces require a variety of power and low-voltage systems.

Safety and Durability

Twist-Lock® devices and single-pole plugs maintain reliable power connections to prevent performance interruptions while wire mesh grips and cable protection systems maintain the integrity of electrical cords, cables and conduit.

Lecture Halls • Conference Rooms • Gymnasiums • Auditoriums



Twist-Lock® Devices

Insulgrip® Twist-Lock® devices available in 20A and 30A maintain Hubbell's classic integrity, solid construction and safety features that make these the "Industry Standard". The plug and connector feature a powerful cord grip, and nylon body and housing for impact resistance.



Twist-Lock® Locking Devices

NEMA Rating	Color Coded by Voltage	Poles/Wires	Plug	Connector	Receptacle
15A 125V		L5-15	2P/3W	HBL4720C	HBL4729C HBL4710
20A 125V		L5-20	2P/3W	HBL2311	HBL2313 HBL2310
20A 250V		L6-20	2P/3W	HBL2321	HBL2323 HBL2320
20A 3Ø 250V		L15-20	3P/4W	HBL2421	HBL2423 HBL2420
20A 3Ø 480V		L16-20	3P/4W	HBL2431	HBL2433 HBL2430
30A 3Ø 250V		L15-30	3P/4W	HBL2721	HBL2723 HBL2720
30A 3Ø 480V		L16-30	3P/4W	HBL2731	HBL2733 HBL2730



Auditorium and Performing Arts

Safety and Security

Single pole devices are the right choice for supplying temporary electrical power distribution to numerous applications. Single pole devices have been designed with ease of assembly and disassembly in mind, no special tools are required.

Single Pole Plugs

Thermoplastic elastomer

Description	Male	Female
300 Amp, cable sizes #4 - 2/0	HBL300Mxx	HBL300Fxx
400 Amp, cable sizes 2/0 - 4/0	HBL400Mxx	HBL400Fxx



Single Pole Receptacles

Thermoplastic elastomer

	Through Hole Mounting	Female	Male
400 Amp Panel Mount, mates with 300 and 400 Amp plugs.	HBLFRSxx	HBLMRSxx	

xx = Color: **BK** (Black), **BL** (Blue), **BN** (Brown), **GN** (Green), **O** (Orange), **R** (Red), **W** (White) and **Y** (Yellow).

Single Pole "T's" and Tri-Taps

Tapping "T" (F-F-M)	HBLTxx
Paralleling "T" (F-M-M)	HBLPTxx
Tri-Tap (M-F-F-F)	HBLM3Fxx
Tri-Tap (F-M-M-M)	HBLF3Mxx



Single Pole Distribution Block

1 Male, 6 Females	HBL7DBxx
-------------------	-----------------



Additional Products of Interest



Pro-Audio

Hubbell's pro-audio connectors including XLR, quarter inch, SPEAKON®, data USB and 1394. Type S connectors mate with Hubbell iSTATION modules allowing each device to mount into Hubbell delivery, workstation and panel solutions.

Data/Audio Wall Mount Enclosure

QUADCAB® wall mount enclosures are an ideal solution for remote audio/video and data applications.

QUADCAB® Wall Mount Enclosure

Contents: (1) Rear section (arrives disassembled facilitating installation)
 (1) Front door; (2) 19" mounting angles; (1) Center section with
 (2) CH751 locks; (2) Top/bottom cover plates; (2) Hinge pins;
 (2) Security cotter pins

Height	Depth	Rack Units	Rear Wall Unit	Color*	Window Door	Solid Door
24" (609)	20" (508)	12	2	Black	HSQ24	HSQ24S
24" (609)	26" (660)	12	2	Black	HSQ2426	HSQ24S26
24" (609)	36" (914)	12	2	Black	HSQ2436	HSQ24S36
36" (914)	20" (508)	19	4	Black	HSQ36	HSQ36S
36" (914)	26" (660)	19	4	Black	HSQ3626	HSQ36S26
36" (914)	36" (914)	19	4	Black	HSQ3636	HSQ36S36
48" (1219)	20" (508)	26	6	Black	HSQ48	HSQ48S
48" (1219)	26" (660)	26	6	Black	HSQ4826	HSQ48S26
48" (1219)	36" (914)	26	6	Black	HSQ4836	HSQ48S36

*For Office White, add "W" to the end of the Catalog No.



High Amp Straight Blade

Hubbell offers a complete line of heavy duty 30, 50 and 60 Amp devices. Captive Allen head terminal screws permit high torque and clamping pressure required for larger size conductors used in copier, range and dryer applications.

Wire Securedness and Strain Relief

Hubbell wire mesh grips are designed to prevent strain from being transmitted to joints and terminals on electrical cords, cables and conduit. This provides greater security than using a fitting alone, making electrical systems safer by preventing cable pull-out and controlling cable arc-of-bend.

Kellems® Grips

Single Eye, Closed Mesh**

For permanent support when cable end is available to be installed through grip.

Cable Diameter Range Inches (cm)	Approx. Breaking Strength Lb. (N)	Catalog No.
.50"- .62" (1.27-1.57)	530 (2,357)	02201013
.63"- .74" (1.60-1.88)	790 (3,514)	02201014
.75"- .99" (1.90-2.51)	1,020 (4,537)	02201015
1.00"- 1.24" (2.54-3.15)	1,610 (7,161)	02201017
1.25"- 1.49" (3.17-3.78)	1,610 (7,161)	02201018
1.50"- 1.74" (3.81-4.42)	1,610 (7,161)	02201019

**Change catalog number from 022 to 024 for stainless steel. Consult factory for availability.



Single Eye, Split Mesh, Rod Closing**

For support when cable end is not available.

Cable Diameter Range Inches (cm)	Approx. Breaking Strength Lb. (N)	Catalog No.
.50"- .62" (1.27-1.57)	790 (3,514)	02203013
.63"- .74" (1.60-1.88)	790 (3,514)	02203014
.75"- .99" (1.90-2.51)	1,020 (4,537)	02203015
1.00"- 1.24" (2.54-3.15)	1,610 (7,161)	02203017
1.25"- 1.49" (3.17-3.78)	1,610 (7,161)	02203018
1.50"- 1.74" (3.81-4.42)	1,610 (7,161)	02203019

**Change catalog number from 022 to 024 for stainless steel. Consult factory for availability.



IEC Pin & Sleeve

Provide safe and dependable performance in the most demanding environments. Heavy duty non-conductive nylon construction provides impact and corrosion protection. Pin & Sleeve devices are available in 20A 600V to 100A 600V.

Science and Research Laboratories



Computer Labs • Science Labs • Research Labs



Whether it's the typical high-school science lab, or a more sophisticated university research facility, science and research laboratories require an array of solutions to deliver power and technology where it's needed. These spaces can also be exposed to corrosive chemicals and wash downs, requiring extremely durable product solutions designed to withstand harsh environments.

Power, Data and Audio/Video Delivery

Hubbell's complete line of metal and non-metallic raceway is optimal for delivering power and technology to the point of use in laboratories while offering maximum flexibility for changing needs.

Safety and Durability

Hubbell's complete line of GFCI and duplex receptacles maintain reliable power and safety in harsh laboratory environments, while stainless steel plates resist oxidation and corrosion.

Pre-Wired Raceway Systems



- Hubbell Pre-Wired Raceway saves time and money by completing the job quicker and on schedule
- Local and factory support available to assist in defining bills of material
- Raceway ducts are kitted, labeled and shipped by room, area or floor locations

Aluminum Pre-Wired Raceway

Satin Anodized Finish

Description	Dimension*
HBLALU3800 Series Single Channel	A: 2.25" (57.15) B: 3.00" (76.20)
HBLALU4800 Series Two Channel	A: 2.25" (57.15) B: 6.00" (152.40)
HBLALU5000 Series Two Channel	A: 1.75" (44.45) B: 5.08" (129.03)
HBLALU7620 Series Three Channel	A: 2.25" (57.15) B: 7.62" (193.55)



Steel Pre-Wired Raceway

Ivory or Gray Finish

Description	Dimension*
HBL3000 Series Single Channel	A: 1.53" (38.86) B: 2.75" (69.85)
HBL4750 Series Single or Two Channel (with Divider)	A: 1.75" (44.45) B: 4.75" (120.65)
HBL6750 Series Two Channel (w/1 divider) Three Channel (w/2 dividers)	A: 2.22" (56.39) B: 6.75" (171.45)



Non-Metallic Pre-Wired Raceway

Office White Color

Description	Dimension*
PB2 BaseTrak® Series Single Channel	A: 1.63" (41.40) B: 4.50" (114.30)
PS3 Super BaseTrak® Series, Three Channel	A: 1.97" (50.04) B: 6.70" (170.18)

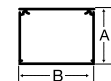



*Dimensions:
A= Height, B= Width



Safety and Security

Hubbell's top-of-the-line Ground Fault receptacles are available with or without Hubbell's patented Self Test technology which requires no user interface to test the device. Both versions feature Hubbell's exclusive tamper-resistant design. The Hubbell TR design employs an electro-mechanical switching mechanism to obtain the tamper-resistant safety feature.

AUTOGUARD® Self Test GFCI Receptacles			
Description	Color	15A 125V	20A 125V
Flush, polyester face, back and side wired, multiple drive screws	Black	GFR5262SGBK	GFR5362SGBK
	Brown	GFR5262SG	GFR5362SG
	Gray	GFR5262SGGY	GFR5362SGGY
	Ivory	GFR5262SGI	GFR5362SGI
	Red	GFR5262SGR	GFR5362SGR
	White	GFR5262SGW	GFR5362SGW
Circuit Guard® GFCI Receptacles			
Description	Color	15A 125V	20A 125V
	Black	GFR5262BKTR	GFR5362BKTR
	Brown	GFR5262TR	GFR5362TR
	Gray	GFR5262GYTR	GFR5362GYTR
	Ivory	GFR5262ITR	GFR5362ITR
	Red	GFR5262RTR	GFR5362RTR
	White	GFR5262WTR	GFR5362WTR



Additional Products of Interest



Cat 6A UTP and Shielded Jacks

Hubbell Category 6A component compliant UTP/FTP jacks provide significant bandwidth to support 10GbE, PoE and other emerging applications. Shielded versions provide enhanced EMI/ANEXT protection.

Data and Audio/Video Connectivity

Hubbell's Surface Mount Boxes are designed to facilitate today's most demanding workstation needs. Available in five sizes to accommodate 1, 2, 4, 6 and 12 Hubbell jacks and Audio/Video connectors, each box encompasses the right combinations of features and density for UTP, audio, video and fiber optic applications.



ISB Surface Mount Boxes	12-Port	6-Port	4-Port	2-Port	1-Port
	ISB12xx	ISB6xx	ISB4xx	ISB2xx	ISB1xx

xx = Color: BK (Black), EI (Electric Ivory), GY (Gray), OW (Office White) and W (White).

POLYTRAK® Raceway Compatibility Chart

Series	PP	PL	PW	PB
ISB1	✓	✓	✓	✓*
ISB2	✓	✓	✓	✓*
ISB4	✓	✓	✓	✓*
ISB6	✓	—	—	✓*
ISB12	✓	—	—	✓*

*Use #PB3REDA transition fitting.

Non-Metallic Raceway

	w/o Adhesive	with Adhesive
PP1 PremiseTrak (Latching)	PP1BCxx	PP1ABCxx
PL1 LANTrak (Latching)	PL1BCxx	PL1ABCxx
PW2 WallTrak (Latching)	PW1BCxx	PW1ABCxx
PB2 BaseTrak Base	PB2Bxx	—
PB2 BaseTrak Cover	PB2Cxx	—



xx = Length: 5 (5 ft) or 7 (7 ft).

Power Connections

Hubbell Extra Heavy Duty Industrial Series receptacles demonstrate a commitment to building quality devices and continually reinforce a philosophy of unrivaled performance. The deep nylon body design delivers increased impact resistance and the exclusive bypass contact design results in greater contact force and reduced heat build up.



HBL® Extra Heavy Duty Industrial Series

NEMA	Rating	Color	Duplex	Weather Resistant	Single
	15A 125V	Brown	HBL5262	HBL5262WR	HBL5261
		Black	HBL5262BK	HBL5262BKWR	HBL5261BK
		Ivory	HBL5262I	HBL5262IWR	HBL5261I
		Other	HBL5262x	HBL5262xWR	—
	20A 125V	Brown	HBL5362	HBL5362WR	HBL5361
		Black	HBL5362BK	HBL5362BKWR	HBL5361BK
		Ivory	HBL5362I	HBL5362IWR	HBL5361I
		Other	HBL5362x	HBL5362xWR	HBL5361xx

x = Color: GY (Gray), R (Red) and W (White). xx = Color: GRY (Gray), and W (White).

Stainless Steel Wallplates

Hubbell's corrosion resistant, stainless steel wallplates provides solutions for a variety of applications with environments subjected to heavy abuse. Stainless steel wallplates are available in a variety of power and data configurations.

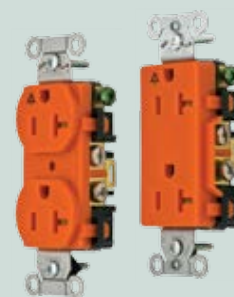

Isolated Ground Receptacles

Isolated ground devices provide protection for sensitive electronics and test equipment in areas with high levels of network connectivity.



Data centers are the very core of education facilities, supporting all the applications needed for daily communications and Internet access, management and storage of administration and student records, and the delivery of advanced learning technologies. These spaces house a wide range of highly critical networking equipment, yet are also faced with increased power consumption and cooling challenges.

Power, Data and Audio/Video Delivery

From efficient power distribution and network cable management, to advanced copper and fiber cable and connectivity, Hubbell has the solutions to support the latest high-density networking applications.

Energy Efficiency

Hubbell cabinets and cable management optimize airflow for more efficient cooling and reduced energy consumption while pre-terminated solutions save space and reduce waste.

Data Centers • Racks • Data Closets • Communication Rooms



XXL Organizers Vertical Cable Management



- The hinged door is designed to open left, right or swing out of the way
- Mounting plates for power strips on the rear of the organizer
- Cable management spools ensure proper bend radius, and are vertically placed where needed along the channel



XXL Series Vertical Organizers

Door Insert	Channel Depth*	6" Wide	10" Wide	15" Wide
Silver	14 1/8"	XS0610	XS1010	XS1510
Silver	18 7/8"	XS0615	XS1515	XS1515
Black	14 1/8"	XS0610BK	XS1010BK	XS1510BK
Black	18 7/8"	XS0615BK	XS1515BK	XS1515BK

*Channel depth does not include rear cable organizer. Rear cable organizer depth is 7 3/4". Contents: Front and rear vertical organizer, door, 16 - 3" black cable management spools.



NEXTFRAME® 3" and 6" Equipment Racks

Black Finish*	19" Wide	23" Wide
24 Rack Units, Depth: 3", Height: 48" (1219)	HPW48RR19	HPW48RR23
45 Rack Units, Depth: 6", Height: 84" (2134)	HPW84RR19D	—

*For mill (aluminum) finish rack, add "ML" to catalog number.



Cable Management

Hubbell Premise Wiring offers a full line of networking enclosures featuring enhanced cable management. Security features include locking split side doors.

H2 Series Network Cabinets

Height	Depth	Color	Rack Units	Catalog No.
84.00"	36.00"	Black	45	H2N8436
84.00"	32.00"	Black	45	H2N8432
80.00"	36.00"	Black	43	H2N8036
80.00"	32.00"	Black	43	H2N8032



Angled Panels

Category	24 Port	48 Port
6A	HP6A24AU	HP6A48AU
Shielded 6A	PSJ24AU	PSJ48AU
6	P624AU	P648AU
5e	P5E24AU	P5E48AU

Bonding

Telecom Bonding Conductor	MCCGBAR
Bonding Connector	BC285SB100



Grounding

Telecom Grounding Bar	RKTGB
19" Rack Mount Ground Bar	MCCGBAR
Wall Mount Cabinet Ground Kit	REKGB
Economy Ground Strap Kit	REKEGS



Efficiency

OptiChannel is a comprehensive system of end-to-end fiber products supporting high bandwidth datacenter applications including 10/40/100 Gigabit Ethernet. OptiChannel's pre-terminated, high density, modular design promotes efficiency, flexibility and maximum space utilization without compromising accessibility.

PROclick® Connectors

12 LC 10G – OM3 Multimode	FCLC900K50GM12
12 SC 10G – OM3 Multimode	FCSC900K50GM12



Standard LC-MPO Cassettes

10G-OM3	
SC Duplex, 12-Port, 10G-OM3	OCSC50G
LC Duplex, 12-Port, 10G-OM3	OCLC50G
LC Duplex, 24-Port, 10G-OM3	OCLC24P50G
LC Quad, 24-Port, 10G-OM3	OCLCQ50G



High Density 144-Port 1U Enclosure

Black	FCRHD1UBK
Gray	FCRHD1UGY



Ultra Compact 12-Port LC Cassette

10G-OM3	OCLCHD50G3
---------	-------------------



OptiChannel High Density Uni-Boot LC Patch Cords OFNR Riser

LC to LC, OM3, Aqua	HDPCLC50G3Mxx
LC to SC, OM3, Aqua	HDPCLCSC50G3Mxx

xx = Length: 1, 2, 3, 4, 5, 6, 8, 10 meters.



Additional Products of Interest



50 Amp Locking

An exclusive Hubbell design delivering Insulgrip® features, including insulated housing and superior strain relief. They are ideal for the most demanding high amperage applications.



BIDnet

All BIDnet pre-terminated cable assemblies are made-to-order items. BIDnet is available in Category 5e, 6 and 6A plenum and riser versions. To help reduce on-site labor and eliminate waste, BIDnet is available in 10 foot through 295 foot lengths. Please call our Inside Sales team at (800) 626-0005 for lead-time and availability.

Power Connections

IEC Watertight Pin & Sleeve Devices provide safe and dependable performance in the most demanding environments. Heavy duty non-conductive nylon construction provides impact and corrosion protection. Thermoset polyester contact carriers withstand extreme temperatures and provide resistance to electrical tracking.

20A and 30A Plug, Connector, Receptacle

Rating Color Coded by Voltage	Poles/Wires	Plug, Connector, Receptacle
20A 120/240V	3P/4W	HBL420xx12W
20A 3Ø 480V	3P/4W	HBL420xx7W
30A 120/240V	3P/4W	HBL430xx12W
30A 3Ø 480V	3P/4W	HBL430xx7W
30A 3Ø 600V	3P/4W	HBL430xx5W



60A and 100A Plug, Connector, Receptacle

Rating Color Coded by Voltage	Poles/Wires	Plug, Connector, Receptacle
60A 120/240V	3P/4W	HBL460xx12W
60A 3Ø 480V	3P/4W	HBL460xx7W
60A 3Ø 600V	3P/4W	HBL460xx5W
100A 120/240V	3P/4W	HBL4100xx12W
100A 3Ø 480V	3P/4W	HBL4100xx7W
100A 3Ø 600V	3P/4W	HBL4100xx5W



xx = Device: P (Plug), C (Connector) and R (Receptacle).



Branch Panel Surge Protection

Hubbell SpikeShield® service entrance and branch panel surge protection devices reliably handle peak amperage capacity of 40kA to 320kA. They can be easily installed next to the panel to prevent over voltage that can impact sensitive data center equipment and mechanical systems.

Athletic Facilities and Outdoor Recreation



Delivering safe, convenient power and multimedia to rugged indoor athletic arenas or harsh outdoor stadium environments poses a challenge for both primary and continuing education facilities. From maintaining spectator safety to providing power and voice, data, and video connections, Hubbell's winning combination is essential to maintaining state-of-the-art athletic facilities with real-time transmission of sporting events.

Power, Data and Audio/Video Delivery

Hubbell's SPIDER® Temporary Power Distribution system incorporates the latest devices for reliably delivering safe, temporary power to a variety of equipment and lighting systems needed for outdoor events.

Safety and Durability

Hubbell's watertight devices maintain safe, reliable power at outdoor events, even when it's raining. In the event of pedestrian and vehicular traffic, Hubbell cable and hose protection systems prevent trip or shock hazards.

Indoor Gymnasium • Outdoor Field • Playgrounds • Concessions



SPIDER® Temporary Power Distribution



Outdoor events need to ensure maximum safety when providing temporary electrical power for equipment and lighting, especially since these applications involve frequent plug-ins and disconnects.



Temporary Power Boxes

Max Rating	Type	Receptacle Rating	Protection Overload/GFI	Receptacle Type	
				Straight Blade	Twist-Lock®
Spider® II 30A, 120/240V AC	(7) Receptacles (1) Twist-Lock®*	20A, 125V 30A, 120/240V	Yes/Yes No/No	SDSB1A	SDTL1A
Spider® II 50A, 120/240V AC	(7) Receptacles (1) Twist-Lock®*	20A, 125V 50A, 125/250V	Yes/Yes No/No	SBSB1A	SBTL1A
Spider® II 60A, 3Ø 120/208V	(6) Receptacles (1) Pin & Sleeve*	20A, 125V 60A, 3ØY, 120/208V	Yes/Yes No/No	SCSB0	SCTL0
50A 120/240V AC	(6) Receptacles (1) Twist-Lock® (1) Twist-Lock®*	20A, 125V 30A, 250V 50A 125/250V	Yes/Yes Yes/No No/No	TPDS	TPDL

*Inlet and outlet.



Athletic Facilities and Outdoor Recreation

Safety and Security

Exposed cables, cords and hoses can be a trip hazard for pedestrians, as well as a potential shock hazard. Hubbell offers a variety of hose and cable protection systems that provide a safe ramping system for both pedestrian and vehicle traffic. Heavy-duty, medium-duty and ADAAG compliant systems are available.



TrukTrak® and TredTrak® Systems

Description	TrukTrak®	TredTrak®
5 Channel	HBLTT5B	HBLTRED5B
5 Channel 45° right turn	HBLTT545RB	—
5 Channel 45° left turn	HBLTT545LB	—
5 Channel "X" fitting	—	HBLTRED5XB
5 Channel "Y" fitting	—	HBLTRED5YB
3 Channel	HBLTT3B	—
2 Channel	HBLTT2B	—



AccessTrak® System

Description	Catalog Number
5 Channel AccessTrak kit*	HBLAT5KITA
5 Channel AccessTrak trough	HBLAT5A

*Contents: (1) trough; (1 set) end rails; (1 set) ramps; (2 sets) end rails.

Additional Products of Interest



Hubbell Copper Solutions

Designed to exceed all applicable standards for performance and reliability, Hubbell copper solutions offer a fully integrated system of copper cabling and components.

Audio/Video Enclosures

Optimizing Cabling in hospitality, entertainment venues and remote environments, the RE-BOX® Zone Cabling Infrastructure System offers comprehensive zone cabling solutions to meet the needs of any topology.

RE-BOX® – Commercial Equipment Cabinet Pre-Configured Version

Switch Cap.	Switch Depth	Height x Width x Depth	Catalog #
2U	14" (356)	32"(813) x 24.2"(615) x 7"(178)	RE2xx
5U	14" (356)	32" (813) x 24.2"(615) x 10"(254)	RE4xx
5U	22" (559)	42"(1067) x 24.2"(615) x 10"(254)	RE4Xxx

xx = Color: **B** (Black) and **no suffix** (Light Gray).
Contents: base/rear section with welded 19" brackets for 2 hubs, front door with 2 locks (NSQ tool), a set of 19" extension brackets for 3 additional hubs (RE4xx only) and a set 19" bottom hinge brackets for patch panels

User-Configurable Version Light Gray Color

Rack Width	Units	Height x Width x Depth	Catalog No.
2U	2U	24"(600) x 24.2"(615) x 10"(254)	IDF24
4U	4U	32"(813) x 24.2"(615) x 10"(254)	IDF32
6U	6U	42"(1067) x 24.2"(615) x 10"(254)	IDF42

Contents: 1 base/rear section and 1 front door with 2 locks (NSQ tool) (IDF24 has only 1 lock).



RE-BOX® 10GbE Cable Entry Pre-Configured Version

Switch Cap.	Height x Width x Depth	Catalog No.
2U	32"(813) x 24.2"(615) x 7"(178)	RE210G
5U	32"(813) x 24.2"(615) x 10"(254)	RE410G

Same as standard pre-configured RE-BOX® except top conduit knockouts replaced with adjustable, high cable capacity grommet plate.
Contents: base/rear section with welded 19" brackets for 2 hubs, front door with 2 locks (NSQ tool), a set of 19" extension brackets for 3 additional hubs (RE4xx only) and a set 19" bottom hinge brackets for patch panels.



Single Pole

Hubbell's Single Pole connectors are made from a specially formulated thermoplastic elastomer that resists cracking in cold, hot or oily conditions as well as any other harmful environments. The connectors have been designed so they are easy to assemble, requiring no special tools.

Power Connections

When it comes to safety, most everyone knows that water and electricity can create a dangerous environment. From outdoor applications to indoor wash downs, ensuring a watertight seal for electrical devices is critical to ensuring maximum safety of personnel in any wet environment.



Locking Devices

NEMA Rating	Poles/Wires	Locking Devices			Straight Blade Devices		
		Plug	Connector	Receptacle	Plug	Connector	Receptacle
15A 125V	2P/3W	24W47H	25W47H	65W47H	14W47H	15W47H	60W47H
15A 277V AC	2P/3W	24W34H	25W34H	65W34H	—	—	—
20A 125V	2P/3W	26W47H	27W47H	67W47H	14W33H	15W33H	60W33H
20A 250V	2P/3W	26W48H	27W48H	67W48H	14W48H	15W48H	60W48H
20A 277V AC	2P/3W	26W49H	27W49H	67W49H	—	—	—
20A 125/250V AC	3P/4W	26W74H	27W74H	67W74H	—	—	—
20A 3Ø 250V	3P/4W	26W75H	27W75H	67W75H	—	—	—
30A 3Ø 250V AC	3P/4W	28W75H	29W75H	69W75H	—	—	—
30A 3Ø 480V AC	3P/4W	28W76H	29W76H	69W76H	—	—	—

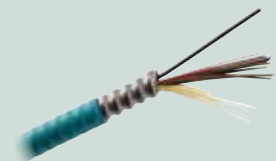

Fiber Cable

Hubbell's full line of indoor and outdoor fiber cables supports a variety of rugged deployment applications, delivering high speed fiber optic service to remote locations. Interlock armored indoor cable is available for direct building deployment without the need for inner duct tubing. Loose tube outdoor fiber cable, available in armored or non armored, is a rugged gel-free construction suitable for direct burial between facilities.

Medical Centers and Health Services



Secondary education facilities often have their own medical centers and health services for students, including on-site clinics and sports rehabilitation/physical therapy centers. Medical centers also require data connections to manage student medical records. In addition, many sports rehab/physical therapy centers use hydrotherapy, requiring nearby connections to have ingress protection against water.

Installation Efficiency

While Hubbell Hospital Grade and Tamper-Resistant Receptacles are put through comprehensive rigorous testing to accommodate abrupt plug removal and impact, they are also quick and easy to install.

Power, Data and Audio/Video Delivery

Hubbell's data, audio and video connectivity support digital imaging and electronic medical records while higher capacity 50 and 60 Amp power devices deliver power for diagnostic equipment.

Nurse's Office • Medical Centers • Imaging • Walk-In Clinics



Hospital Grade Receptacles

Hubbell understands that healthcare is where safety, reliability and performance matters the most. These devices feature exclusive nickel-plated bypass power contact design to ensure uninterrupted power and a four-point grounding system for low resistance to fault currents.



Hospital Grade • Receptacles

Type	Color	15A 125V	20A 125V
Duplex	Ivory	HBL8200I	HBL8300I
	Red	HBL8200RED	HBL8300RED
	White	HBL8200W	HBL8300W
	Blue	—	HBL8300BL
	Brown	HBL8200	HBL8300
	Gray	HBL8200GY	HBL8300GY
Tamper-Resistant	Light Almond	HBL8200LA	HBL8300LA
	Ivory	HBL8200SGIA	HBL8300SGIA
	Red	HBL8200SGRA	HBL8300SGRA
	White	HBL8200SGWA	HBL8300SGWA
	Brown	HBL8200SGA	HBL8300SGA
	Gray	HBL8200SGGYA	HBL8300SGGYA
	Light Almond	HBL8200SGLA	HBL8300SGLA



Medical Centers and Health Services

Personnel Protection

Outpatient healthcare facilities within an institution require the same level of performance as hospitals. Medical care centers and walk-in clinics require the safety and convenience of tamper-resistant receptacles. Hubbell tamper-resistant receptacles restrict improper access to energized contacts.

AUTOGUARD® Self Test

Hospital Grade • GFCI Receptacles

Description	Color	15A 125V	20A 125V
Flush, polyester face, back and side wired, multiple drive screws	Black	GFR8200SGBK	GFR8300SGBK
	Brown	GFR8200SG	GFR8300SG
	Gray	GFR8200SGGY	GFR8300SGGY
	Ivory	GFR8200SGI	GFR8300SGI
	Red	GFR8200SGR	GFR8300SGR
	White	GFR8200SGW	GFR8300SGW

Hospital Grade •

Tamper-Resistant GFCI Receptacles

Description	Color	15A 125V	20A 125V
Hospital Grade Flush, nylon face, back and side wired, multiple drive screws, automatic grounding clip	Brown	GFR8200HTR	GFR8300HTR
	Gray	GFR8200HGYTR	GFR8300HGYTR
	Ivory	GFR8200HITR	GFR8300HITR
	Light Almond	GFR8200HLATR	GFR8300HLATR
	Red	GFR8200HRTR	GFR8300HRTR
	White	GFR8200HWTR	GFR8300HWTR

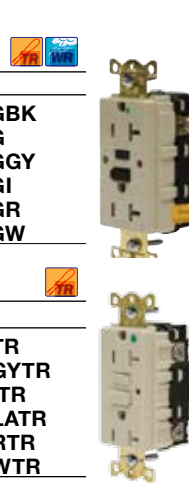

Additional Products of Interest



Wall/Ceiling Duct System

The Hubbell Wall/Ceiling Duct System is utilized in combination with Hubbell's Trench Duct product offering for the enclosure of wiring to X-Ray machines or MRI equipment. Hubbell's aluminum wall duct is used for applications that require non ferrous metal raceways. Wall Duct is available in flush mount and surface mount versions.



Trench Duct System

The Hubbell Trench Duct System is utilized as an in-floor feeder for the Hubbell Wall Duct product line in hospital and other radiology facilities. Trench Duct can also be utilized as a stand-alone wire management system in retail store and general commercial applications.

Data and Audio/Video Connectivity

Healthcare facilities contain a variety of high-tech imaging and diagnostic equipment to determine a patient's condition. Many of these require higher capacity power and data connections than traditional conventional outlets and connectors can provide.

NEXTSPEED® Shielded Jacks, Category 6/10GbE

Category	Pkg. Quantity	B-Wired Catalog No.	A-Wired Catalog No.
6	2	SJ62B	SJ62A
6	24	SJ624B	SJ624A
5e	2	SJ5E2B	SJ5E2A
5e	24	SJ5E24B	SJ5E24A



NEXTSPEED® Shielded Category 6A, Patch Cords

1 patch cord	PC6AxxYY
xx = Color: B (Blue), BK (Black), GY (Gray), Y (Yellow), OR (Orange), R (Red), GN (Green), P (Purple) or W (White)	
YY (Standard Length: 01 (1ft), 03 (3ft), 05 (5ft), 07 (7ft), 10 (10ft), 15 (15ft) or 20 (20ft))	



NEXTSPEED® Ascent Shielded Category 6A, Trunk Cable Assemblies

BIDnet Pre-Terminated Copper Trunk Assemblies improve air flow in the data center, decrease installation time and supply superior performance. All BIDnet pre-terminated cable assemblies are made-to-order items. Please call our Inside Sales team at (800) 626-0005 for lead-time and availability.



Shield Colored Dust Covers

Color	Catalog Number
Blue	IDCSB
Black	IDCSBK
Green	IDCSGN
Orange	IDCSOR
Yellow	IDCSY

Power Connections

Insulgrip® Hospital Grade Plugs and Connectors are engineered to provide a high degree of durability and feature ribbed nylon housing for impact and chemical resistance. The powerful cord grip prevents conductor slippage and strain on terminals and adjusts to a wide range of cord sizes.

Straight Blade Plugs and Connectors

Amps	NEMA Rating	Poles/Wires	Description	Plug	Angled Plug	Connector	
15A 125V		5-15	2-Pole	Black/White	HBL8215C	—	HBL8219C
			3-Wire	Transparent	HBL8215CT	HBL8215CAT	HBL8219CT
				Valise; white	HBL8115V	—	HBL8119V
20A 125V		5-20	2-Pole	Black/White	HBL8315C	—	HBL8319C
			3-Wire	Transparent	HBL8315CT	HBL8315CAT	HBL8319CT
				Valise®; white	HBL8364V	—	—



Hubbell Switches and Illuminated Switches

Hubbell Toggle Switch's heavy duty nylon toggle resists abuse while the Hubbell Decorator Switch's thermoplastic rocker assures quiet operation and precise timing. One piece rivetless copper alloy spring contact arm and terminal plate provides long life.

Mechanical and Maintenance Facilities



Every education facility includes mechanical and maintenance areas that typically encompass a wide range of equipment like back-up generators, HVAC units and air handlers that need high-capacity, safe, and reliable power. Without it, an entire school or university can shut down. Mechanical and maintenance personnel also strive to keep energy costs down throughout education facilities.

Safety and Durability

From CIRCUIT-LOCK® disconnect switches and interlock enclosures, to portable cords and cable management, Hubbell offers a variety of devices to provide safe, reliable power and control for mechanical equipment.

Power, Data and Audio/Video Delivery

With wireless and network communications now the norm, all personnel within an education facility require access to these services. Hubbell's Wireless Access Point Ceiling Boxes are ideal for delivering wireless service in remote mechanical and maintenance areas.

Maintenance Rooms • Boiler Rooms • HVAC • Trade Schools



IEC Mechanical Interlock Enclosures

Hubbell's revolutionary CIRCUIT-LOCK® interlock enclosure incorporates the disconnect switch and IEC receptacle in one compact unit. At the same time, it eliminates the possibility of making or breaking the circuit under load or making a casual or lazy connection.



20 and 30 Amp

Rating Color Coded by Voltage	Poles/Wires	Mechanical Interlock
20A 3Ø 480V	3P 4W	HBL420MI7W
30A 3Ø 250V	3P 4W	HBL430MI9W
30A 3Ø 480V	3P 4W	HBL430MI7W
30A 3Ø 600V	3P 4W	HBL430MI5W
30A 3ØY 277/480V	4P 5W	HBL530MI7W

For mating plug, replace MI with P. Ex. HBL420MI7W (mechanical interlock) to HBL420P7W (mating plug).

60 and 100 Amp

Rating Color Coded by Voltage	Poles/Wires	Mechanical Interlock
60A 3Ø 250V	3P 4W	HBL460MI9W
60A 3Ø 480V	3P 4W	HBL460MI7W
60A 3Ø 600V	3P 4W	HBL460MI5W
60A 3ØY 120/208V	4P 5W	HBL560MI9W
100A 250V	3P 4W	HBL4100MI9W
100A 3Ø 480V	3P 4W	HBL4100MI7W
100A 3Ø 600V	3P 4W	HBL4100MI5W
100A 3ØY 120/208V	4P 5W	HBL5100MI9W

Mechanical and Maintenance Facilities

Cable Management

Cable reels can help eliminate unmanaged cords and cables that would otherwise cause trip hazards or an increased potential of electric shock. Hubbell offers a wide range of cord reels that provide cable protection, including watertight, industrial, commercial and static discharge reels.

Industrial Power Cord Reels

125V AC, 45 Ft (13.7m) Cable, Cable Type 12/3 SJEO

Cord End	NEMA Style	Catalog Number
HBL5269C 15A connector	5-15R	HBL45123C
HBL5369C 20A connector	5-20R	HBL45123C20
Portable outlet box; 15A gray duplex w/GFCI protection	5-15R	HBL45123GF15
Portable outlet box; 20A gray duplex w/GFCI protection	5-20R	HBL45123GF20



Commercial Cord Reels

Cord End	Watts (Max)	Cable Feet (m)	Volts AC	Cable Type	Catalog Number
Triple tap outlet; 15A	1200	40 (12.2)	125	12/3 SJTW	HBLC40123TT
Metallic incandescent hand lamp with receptacle; 13A	1625	25 (7.6)	125	14/3 SJT	HBLC25143IN
Fluorescent hand lamp and inline receptacle; 10A	1200	40 (12.2)	120	16/3 SJT	HBLC40163FL

Data, Audio and Video Connectivity

Hubbell's innovative ceiling and wireless access enclosures support multiple Wireless Access Points (WAP) and IP devices in remote and high traffic areas. These rugged all metal lockable enclosures can be mounted on the wall or in the ceiling grid allowing for convenient location installation.



Wireless Access Point Ceiling Box

Delivery: Aluminum enclosure, (1) fire-rated foam kit for cable entries and exits, hinged door equipment mounting plate (factory installed), lockable knob assembly and cable entry port and cover (factory installed)

Description	Mounting Plate Dims. H x W	External Dimensions H x W x D	Weight Capacity Lb. Door (Total)	Cable Entry Dimensions	Catalog No.
Universal WAP Enclosure	9.7" x 5.25"	4"x10"x12.7"	15 (20)	6.5"x1.2"	WBC1
CISCO® Aironet 1200 Series N/A		10"x10.5"x13.2"	15 (20)	6.5"x1.2"	WBC12

WBC1 uses key no. 2233. **WBC12** uses key no. C346A.

Wall Box

Delivery: (1) aluminum enclosure, (4) plastic conical screw anchors for #10 screw, (1) drill template, (4) #10 x 1 pan head screws and (4) flat steel washers, size #10

Description	External Dimensions H x W x D	Weight Lbs	Office White	Black
Wall Box	8"x11"x3"	1.5	WBW10W	WBW1BK

Uses key no. 333. Spare Lock Key available, Catalog number **KEY333**.



Safety and Security

GFCIs are critical for protecting people when using portable line cords and outlets in a variety of indoor and outdoor applications. Portable GFCIs provide open-neutral protection for temporary power applications, this is required to meet OSHA requirements.

Circuit Guard® Portable GFCI Line Cords



Rating	Length	Single	Triple Tap
15A	2 ft.	GFP2Cxx	GFP2TTxx
120V AC	25 ft.	GFP25Cxx	GFP25TTxx

xx= A (Automatic) or M (Manual) Set.

Multiple Outlet Portable GFCI



Description	Rating	Cat. No.
4-Outlet;	15A 120V AC	GFP15M
2-Duplex;	20A 120V AC	GFP20M

Circuit Guard® In-Line GFCI

Rating	Type	Automatic Set	Manual Set
15A	Single	GFPI15125A	GFPI15125M
120V AC	Triple Tap	GFPI15125TRIA	GFPI15125TRIM
20A	Locking	GFPI120125LKA	GFPI120125LKM
120V AC			
20A	Locking	GFPI120250LKA	GFPI120250LKM
250V AC			



Additional Products of Interest



Portable Outlet Boxes

Portable non-metallic outlet boxes provide a safe, rugged, portable enclosure with an integral sealed cord connector fitting that also work well for pendant applications.

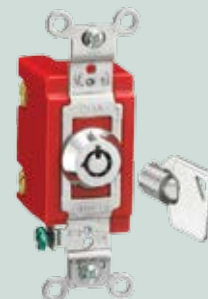

Barrel Key Switch

An ideal solution for applications that require authorized access only for a secure level of control.



Disconnect Switches for Use with Variable Frequency Drives

Hubbell's Disconnect Switch for Variable Frequency Drives (VFDs) prevents downtime from out of sequence equipment shutdowns. The HBLDS3VFD integrates a verified break before break auxiliary contact factory installed in the HBLDS3 30 Amp disconnect switch enclosure that interfaces directly with VFDs.

HUBBELL® EDUCATION

Application Guide



Scan to watch the Hubbell Education video.

Visit www.hubbell-wiring.com to access Hubbell's Education Solutions website.

Hubbell Installation Efficiency Product Solutions



Pre-Wired Raceway

Available in aluminum, steel and non-metallic versions, Hubbell's pre-wired raceway systems will keep your projects on schedule, reduce on-site labor and waste. Our local sales team is available to support your efforts.

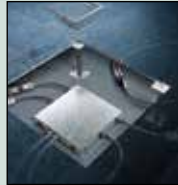

CONNEXION

Hubbell CONNEXION Zone Distribution System is a factory assembled modular plug-n-play system that delivers power and data to the workstation in raised floor installations.



Pre-Fab Solutions

Pre-fab solutions can reduce projects by as much as 30% while reducing on-site waste. The Rough in Ready Pre-Fab solution offered by Hubbell provides a variety of options from innovative bracket to cable-ready assemblies.



SNAPConnect® Modular Devices

Hubbell's SNAPConnect® offers the latest in innovative design, to save time and money, while delivering a safe, reliable and durable connection. SNAPConnect® reduces labor costs during the initial installation and also provides future labor savings if device replacement or upgrade is ever required.

Hubbell Energy Efficiency Solutions



Sensors

Reduce energy consumption in a wide variety of commercial, residential and industrial applications with Hubbell lighting controls and sensors.

Hubbell's sensors facilitate compliance with the latest building codes and standards, including ASHRAE/IESNA 90.1, CEC's Title 24, and help obtain LEED® points.



Wireless is Fast

The WL-Series sensors install and setup fast. A typical installation involves only replacing the existing wall switch and pairing the desired battery powered sensor. These controls utilize a simplified 2-button, 6-second press and hold, commissioning procedure.

There is no need for remotes, computers, smartphones, or any other device to setup the system.

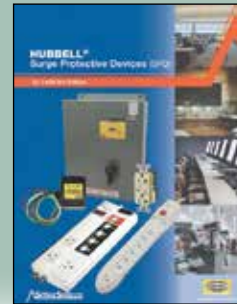

Power Strips

Hubbell's SpikeShield® Energy Saving Surge Protective Devices (ESPS Series) reduce power consumption by eliminating phantom power draw of unused electronics and appliances.

Hubbell offers a complete offering of power strips in various levels of outlet configurations and surge protection.

Literature Support

Hubbell offers an extensive literature library for product support. Downloadable PDFs are available online at www.hubbell-wiring.com under the media tab.

HUBBELL®
Wiring Systems

www.hubbell-wiring.com
www.hubbell-premise.com



Hubbell Wiring Device-Kellems
Hubbell Incorporated (Delaware)
40 Waterview Drive, Shelton, CT 06484
Phone (800) 288-6000 • FAX (800) 255-1031

Hubbell Premise Wiring
Hubbell Incorporated (Delaware)
23 Clara Drive, Suite 103, Mystic, CT 06355
Phone (800) 626-0005 • FAX (860) 535-8328