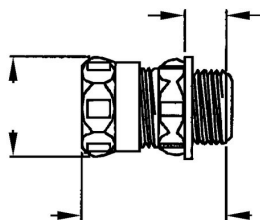

**EMT COMPRESSION CONNECTORS**

Compression Connectors, Steel

**B05**

Catalog #: 2944US

**APPLICATIONS**

For use to bond EMT conduit to a box or enclosure.  
RACO Compression connectors are suitable for applications above 600V.

**PRODUCT FEATURES**

1/2 in. to 4 in. connectors provide concrete-tight connections  
All steel construction ensures mechanical protection for the raceway  
All components are zinc electroplated for corrosion protection  
UPC bar coded fittings are individually polybagged with a preprinted UPC-A bar code, and packaged in pre-scored tear top cartons for an attractive presentation.

**CULUS**

Standard 514B, UL Listed E195970, C22.2 No. 1

**COMPLIANCES**

MSDS  
[www.hubbell-rtb.com/certifications/Hubbell-RACO\\_MSDS\\_for\\_WP\\_Boxes\\_and\\_Fittings,January 2015.pdf](http://www.hubbell-rtb.com/certifications/Hubbell-RACO_MSDS_for_WP_Boxes_and_Fittings,January 2015.pdf)

**GENERAL PRODUCT INFORMATION**

Sub Class: Uninsulated  
Trade Size: 3-1/2 in.  
Country of Origin: USA

**DRAWING DIMENSIONS**

Dimension A: 2.81 in.  
Dimension B: 1.00 in.  
Dimension C: 4.68 in.

**PACKAGING**

Package Type: Carton  
Ship Carton Qty.: 1  
Product UPC-A Labeled: No  
Weight (Lbs. Per/C): 390.00  
Ship Carton Length (in.): 5.75  
Ship Carton Width (in.): 5.75  
Ship Carton Height (in.): 4.75  
Ctn Weight (Lbs.): 2.77  
UPC Number: 050169570500  
I2of5: 50050169570505