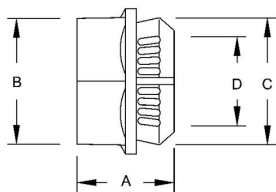

**TWO PIECE CONNECTORS AND EMT TO RIGID THREADED/COMPRESSION COMBINATION COUPLINGS****Two-Piece Connector Die Cast Zinc**  
N/A**B18**

Catalog #: 2702

**APPLICATIONS**

For use in dry locations to bond EMT conduit to a box or enclosure.  
RACO 1/2 in. and 3/4 in. two-piece connectors provide concrete-tight connections.

**PRODUCT FEATURES**

Rugged metallic construction insures mechanical protection for the raceway  
N/A

**UL LISTED**

Standard 514B

**GENERAL PRODUCT INFORMATION**

Trade Size: 1/2 in.  
Country of Origin: USA

**DRAWING DIMENSIONS**

Dimension A: 11/16 in.  
Dimension B: 1-3/64 in.  
Dimension C: 15/16 in.  
Dimension D: 39/64 in.

**PACKAGING**

Package Type: Carton  
Ship Carton Qty.: 100  
Product UPC-A Labeled: No  
Weight (Lbs. Per/C): 5.543  
Ship Carton Length (in.): 5.188  
Ship Carton Width (in.): 3.625  
Ship Carton Height (in.): 7.563  
Ctn Weight (Lbs.): 5.543  
UPC Number: 050169027028  
I2of5: 30050169027029