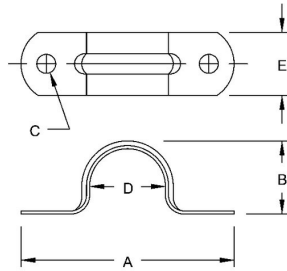

**EMT STRAPS - STEEL**
**Two Hole Straps Stamped Steel**  
 N/A

**B22**

Catalog #: 2095

**APPLICATIONS**

 For use in mounting EMT conduit  
 N/A

**PRODUCT FEATURES**

 All stamped steel construction insures mechanical protection  
 Oversized bolt holes make alignment of the fastener quick and easy  
 All straps are zinc electro plated for corrosion protection

**GENERAL PRODUCT INFORMATION**

Trade Size: 1-1/4 in.

**DRAWING DIMENSIONS**

 Dimension A: 3.520 in.  
 Dimension B: 1.540 in.  
 Dimension C: .250 in.  
 Dimension D: 1.510 in.  
 Dimension E: .750 in.

**PACKAGING**

 Package Type: Carton  
 Ship Carton Qty.: 50  
 Product UPC-A Labeled: No  
 Weight (Lbs. Per/C): 9.00  
 Ship Carton Length (in.): 9.20  
 Ship Carton Width (in.): 6.50  
 Ship Carton Height (in.): 4.70  
 Ctn Weight (Lbs.): 4.50  
 UPC Number: 050169020951  
 I2of5: 50050169020956