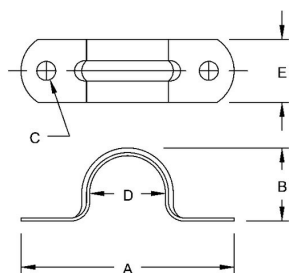

**EMT STRAPS - STEEL****Two Hole Straps Stamped Steel**  
N/A**B22**

Catalog #: 2093

**APPLICATIONS**For use in mounting EMT conduit  
N/A**PRODUCT FEATURES**All stamped steel construction insures mechanical protection  
Oversized bolt holes make alignment of the fastener quick and easy  
All straps are zinc electro plated for corrosion protection**GENERAL PRODUCT INFORMATION**

Trade Size: 3/4 in.

**DRAWING DIMENSIONS**Dimension A: 2.288 in.  
Dimension B: 1.015 in.  
Dimension C: .187 in.  
Dimension D: .922 in.  
Dimension E: .625 in.**PACKAGING**Package Type: Carton  
Ship Carton Qty.: 100  
Product UPC-A Labeled: No  
Weight (Lbs. Per/C): 3.00  
Ship Carton Length (in.): 9.40  
Ship Carton Width (in.): 6.30  
Ship Carton Height (in.): 4.70  
Ctn Weight (Lbs.): 3.00  
UPC Number: 050169020937  
I2of5: 50050169020932