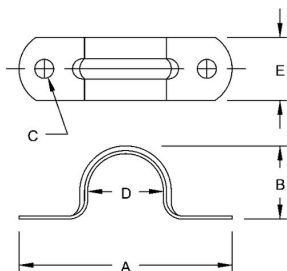

**EMT STRAPS - STEEL****Two Hole Straps Stamped Steel**  
N/A**B22**

Catalog #: 2092

**APPLICATIONS**For use in mounting EMT conduit  
N/A**PRODUCT FEATURES**All stamped steel construction insures mechanical protection  
Oversized bolt holes make alignment of the fastener quick and easy  
All straps are zinc electro plated for corrosion protection**GENERAL PRODUCT INFORMATION**

Trade Size: 1/2 in.

**DRAWING DIMENSIONS**Dimension A: 2.140 in.  
Dimension B: .750 in.  
Dimension C: .187 in.  
Dimension D: .706 in.  
Dimension E: .625 in.**PACKAGING**Package Type: Carton  
Ship Carton Qty.: 100  
Product UPC-A Labeled: No  
Weight (Lbs. Per/C): 2.30  
Ship Carton Length (in.): 9.20  
Ship Carton Width (in.): 6.40  
Ship Carton Height (in.): 4.70  
Ctn Weight (Lbs.): 2.30  
UPC Number: 050169020920  
I2of5: 50050169020925