

Single Pole Devices

**Temporary Power Connectors for the
Most Demanding Environments**

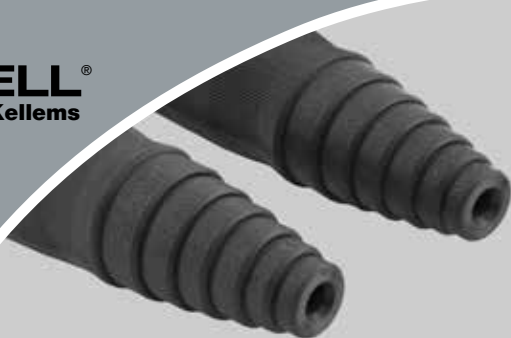



Series 15 and 16 - 150, 300 and 400 Amps, 600V AC/250V DC

Hubbell Wiring Device-Kellems offers a full line of innovative, high quality, Series 15 and Series 16 single pole plugs, receptacles and accessories for the most demanding environments.

Single pole devices are the right choice for supplying temporary electrical power distribution for entertainment, theme parks, carnival equipment, concerts, movie making and numerous other applications requiring temporary power.

Single pole devices have been designed with ease of assembly and disassembly in mind, no special tools are required. A high strength non-conductive retaining screw is all that is needed to securely lock the contacts to the insulated sleeve.

- UL Enclosure Types 3R, 4X and 12 Rating suitable for use in almost any environment



HBL15MBK



HBL15FBK



Housing Design

- Insulgrip® style housing for superior gripping conforms to the user's hand making it easy to connect and disconnect, even with gloves on
- Easily identifiable cable cut off points for secure fit allows you to easily customize and cut the housing to the required/correct cable size
- Accommodates wide range of cables



Contacts

- Provides high contact pressure and vibration resistant connection, which helps reduce operating temperatures and extends product life
- High conductivity brass contact provides improved performance by helping to reduce operating temperatures and extends life



Safety

- Rounded corners reduce the possibility of catching or snagging on structures or equipment
- Non-conductive retaining screw locks contacts in place and allows for easy installation; prevents contact movement within housing
- Recessed mounting screw minimizes screwdriver slippage



Assembly

- Special screw thread requires fewer turns than most competitors and reduces the risk of a conductive screw being substituted
- Extra long non-conductive inner sleeve reduces force required to install housing over contacts; easier to rotate contact in body for installing retaining screw



Identification

- Lock symbol aids in the mating of devices and provides a clear indication that the devices are properly connected
- With lock indicator symbol making mating clear and simple; devices can lock 180° to prevent unintended disconnects



Installation

- Engineered body design makes installation simple with no need for additional tools and the non-metallic retaining screw helps to make operation safe for all involved
- Strip gauge molded into every plug and receptacle housing; simplifies installation and saves time



Series 15 - 150 Amps, 600V AC/250V DC

- Enclosure Types 3R, 4X, 12
- Combo Head, Non-Metallic Safety Retaining Screw
- Insulgrip Body Design
- Accepts #8 AWG - #2 AWG Wire
- UL and cUL Listed



150A Plugs, Male

Description	Color	Male Plug
Thermoplastic elastomer, cable size #8 - #2 AWG.	Black	HBL15MBK
	White	HBL15MW
	Green	HBL15MGN
	Red	HBL15MR
	Blue	HBL15MBL
	Brown	HBL15MBN
	Orange	HBL15MO
	Yellow	HBL15MY
	Gray	HBL15MGY

150A Plugs, Female

Description	Color	Female Plug
Thermoplastic elastomer, cable size #8 - #2 AWG.	Black	HBL15FBK
	White	HBL15FW
	Green	HBL15FGN
	Red	HBL15FR
	Blue	HBL15FBL
	Brown	HBL15FBN
	Orange	HBL15FO
	Yellow	HBL15FY
	Gray	HBL15FGY



150A Receptacles, Stud Type $1\frac{1}{16}" \times \frac{3}{4}"$

Description	Color	Female	Male
Panel Mount, thermoplastic, cable size #8 - #2 AWG.	Black	HBL15FRSBK	HBL15MRSBK
	White	HBL15FRSW	HBL15MRSW
	Green	HBL15FRSGN	HBL15MRSGN
	Red	HBL15FRSR	HBL15MRSR
	Blue	HBL15FRSBL	HBL15MRSBL
	Brown	HBL15FRSBN	HBL15MRSBN
	Orange	HBL15FRSO	HBL15MRSO
	Yellow	HBL15FRSY	HBL15MRSY
	Gray*	—	—



150A Receptacles, Double Set Screw

Description	Color	Female	Male
Panel Mount, thermoplastic, cable size #8 - #2 AWG.	Black	HBL15FRBK	HBL15MRBK
	White	HBL15FRW	HBL15MRW
	Green	HBL15FRGN	HBL15MRGN
	Red	HBL15FRR	HBL15MRR
	Blue	HBL15FRBL	HBL15MRBL
	Brown	HBL15FRBN	HBL15MRBN
	Orange	HBL15FRO	HBL15MRO
	Yellow	HBL15FRY	HBL15MRY
	Gray	HBL15FRGY	HBL15MRGY



Note: *Gray is available upon request. Contact factory.

Protective Caps

Description	Color	Fits Male Devices	Fits Female Devices
Fits 150 amp plugs and receptacles.	Black	HBL15MCAPBK	HBL15FCAPBK
	White	HBL15MCAPW	HBL15FCAPW
	Green	HBL15MCAPGN	HBL15FCAPGN
	Red	HBL15MCAPR	HBL15FCAPR
	Blue	HBL15MCAPBL	HBL15FCAPBL
	**	—	—



Note: **Additional colors are available upon request. Contact factory.

Weather Protective Covers

Description	Color	Catalog Number
Use with stud type or double set screw receptacles.	Clear	HBL15NCC
	Black	HBL15NCBK
	White	HBL15NCW
	Green	HBL15NCGN
	Red	HBL15NCR
	Blue	HBL15NCBL
	**	—





Series 15 - 150 Amps, 600V AC/250V DC

Tees



Color	Tapping Tee (Female-Female-Male)	Paralleling Tee (Female-Male-Male)
Black	HBL15TBK	HBL15PTBK
White	HBL15TW	HBL15PTW
Green	HBL15TGN	HBL15PTGN
Red	HBL15TR	HBL15PTR
Blue	HBL15TBL	HBL15PTBL

Gender Reversing Devices



Color	Double Male (Male-Male)	Double Female (Female-Female)
Black	HBL15DMBK*	HBL15DFBK*
White	HBL15DMW	HBL15DFW
Green	HBL15DMGN	HBL15DFGN
Red	HBL15DMR*	HBL15DFR*
Blue	HBL15DMBL*	HBL15DFBL*

Note: *Not UL listed, consult factory for availability.

Replacement Bodies (25 Pack)



Color	Male Body	Female Body
Black	HBL15MBBK	HBL15FBBK
White	HBL15MBW	HBL15FBW
Green	HBL15MBGN	HBL15FBGN
Red	HBL15MBR	HBL15FBR
Blue	HBL15MBBL	HBL15FBBL

Note: **Additional colors are available upon request. Contact factory.

Replacement Contacts (25 Pack)



Description	Male Pin	Female Sleeve
Contact, 150 amp	HBL15RCM	HBL15RCF

Accessories

Description	Catalog Number
Accessory Kit, retaining screw, copper foil, terminal screws and brass wire.	HBL15PK
Replacement retaining screw (100 pack).	HBL15RS
Copper foil (100 pack).	HBL15CF
Brass wire (100 pack).	HBL15BW
Terminal screw - inline (100 pack).	HBL15TS25
Terminal screw - panel mount (100 pack).	HBL15TS375
Ferrule #2 AWG (100 pack).	HBL15F2
Ferrule #4 AWG (100 pack).	HBL15F4



HBL15PK



HBL15RS



HBL15CF



HBL15BW



HBL15TS25



HBL15TS375



HBL15F2
HBL15F4



Series 15 - 150 Amps, 600V AC/250V DC

Specifications

Electrical	Series 15
Voltage Ratings	600V AC Maximum 250V DC Maximum
Amperage Rating	150A Maximum
Mechanical	Series 15
Terminal	Plug: #8 AWG to #2 AWG Receptacle: #8 AWG to #2 AWG
Accommodation	Ratings are a permanent part of device
Product ID	Ratings are a permanent part of device
Base Compound	Plug: Thermoplastic Elastomer (TPE) Receptacle: Polybutylene Terephthalate (PBT)
Contact Material	Brass
Retaining Screw Material	Nylon

Certification / Environmental

Series 15
UL and cUL listed
UL Enclosure Types 3R, 4X, 12
UL 1691 standard for single pole locking-type separable connectors
National Electric Code (NEC®), ANSI/NFPA 70
Flammability: HB per UL94 or CSA 22.2. 0.17

Conductor Ampacity Chart (Type SC/PPC Wire)

Cable Size	Ampacity*
#8	80
#6	105
#4	140
#2	190

Note: *90°C column NEC Table 400.5(A)(2).

Dimensions Inches (mm)

In Line Plugs

Series 15		A	B	C	D
Series 15	Male	4.54" (115.3)	1.04" (26.4)	.86" (21.8)	3.22" (81.7)
	Female	4.60" (116.8)	1.11" (28.2)	.68" (17.3)	3.28" (83.2)

Weatherproof Cover

Series 15		A	B	C
Series 15	Cover	2.03" (51.5)	1.14" (29.0)	1.49" (37.9)

In Line Plug (Male Shown)

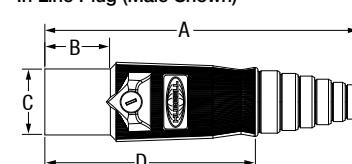

Panel Mount Receptacles

Series 15	Threaded Stud	A	B	C	D	E	F	G	Mounting Hole	Termination
	Male	1.86" (47.2)	1.37" (34.8)	N/A	2.82" (71.6)	.86" (22.0)	.80" (20.4)	1.20" (30.5)	Through 3x Ø .20"	5/16-18 Threaded stud
	Female	1.86" (47.2)	1.37" (34.8)	N/A	2.88" (73.1)	.86" (22.0)	.80" (20.4)	1.26" (32.0)	Through 3x Ø .20"	5/16-18 Threaded stud
	Double Set Screw	A	B	C	D	E	F	G	Mounting Hole	Termination
	Male	1.86" (47.2)	1.37" (34.8)	N/A	2.90" (73.6)	.86" (22.0)	.88" (22.2)	1.20" (30.5)	Through 3x Ø .20"	(2) 5/32 Socket Head set screws
	Female	1.86" (47.2)	1.37" (34.8)	N/A	2.95" (74.9)	.86" (22.0)	.87" (22.2)	1.26" (32.0)	Through 3x Ø .20"	(2) 5/32 Socket Head set screws

Weatherproof Cover

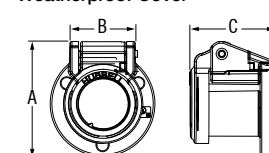

Tees

Series 15		A	B	C
Series 15	Tapping Tee	2.67" (67.9)	4.28" (108.7)	.865" (21.9)
	Paralleling Tee	2.67" (67.9)	4.22" (107.2)	.865" (21.9)

Gender Reversing Devices

Series 15		A	B	C
Series 15	Double Male	4.22" (107.2)	.86" (21.8)	—
	Double Female	4.22" (107.2)	1.05" (26.7)	.68" (17.3)

Tapping Tee

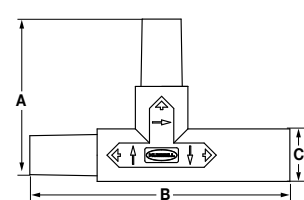

Paralleling Tee

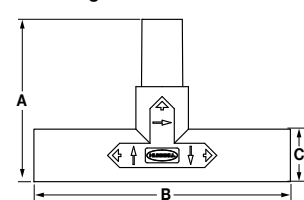

Gender Reversing - Double Male

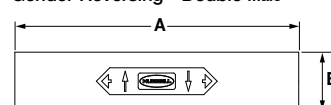

Threaded Stud (Male Shown)

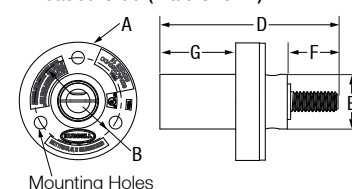

Double Set Screw (Male Shown)

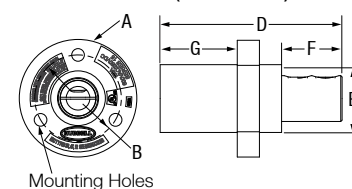

Gender Reversing - Double Female

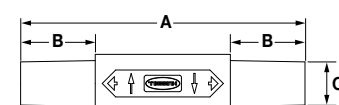



Series 16 - 300 and 400 Amps, 600V AC/250V DC

- Enclosure Types 3R, 4X, 12
- Non-Metallic Safety Retaining Screw
- Insulgrip Body Design
- Accepts #6 AWG - 4/0 Wire
- UL and cUL Listed
- Colors available: Black, Blue, Brown, Green, Gray, Orange, Red, White and Yellow



300A Plugs

Description	Color	Male Plug	Female Plug
Thermoplastic elastomer, cable size #6 - 2/0 AWG.	Black	HBL300MBK	HBL300FBK
	White	HBL300MW	HBL300FW
	Green	HBL300MGN	HBL300FGN
	Red	HBL300MR	HBL300FR
	Blue	HBL300MBL	HBL300FBL
	Brown	HBL300MBN	HBL300FBN
	Orange	HBL300MO	HBL300FO
	Yellow	HBL300MY	HBL300FY
	Gray*	—	—

Note: *Gray is available upon request. Contact factory.



Receptacles, Stud Type

Description	Color	Through Hole Mounting	
		Female	Male
400 amp Panel Mount, thermoplastic elastomer, mates with 300 and 400 amp plugs.	Black	HBLFRSBK	HBLMRSBK
	White	HBLFRSW	HBLMRSW
	Green	HBLFRSGN	HBLMRSGN
	Red	HBLFRSR	HBLMRSR
	Blue	HBLFRSBL	HBLMRSBL
	Brown	HBLFRSBN	HBLMRSBN
	Orange	HBLFRSO	HBLMRSO
	Yellow	HBLFRSY	HBLMRSY



Angled Receptacles, Stud Type

Description	Color	Female	Male
400 amp Panel Mount, thermoplastic elastomer, mates with 300 and 400 amp plugs.	Black	HBLFRASBK	HBLMRASBK
	White	HBLFRASW	HBLMRASW
	Green	HBLFRASGN	HBLMRASGN
	Red	HBLFRASR	HBLMRASR
	Blue	HBLFRASBL	HBLMRASBL
	Brown	HBLFRASBN	HBLMRASBN
	Orange	HBLFRASO	HBLMRASO
	Yellow	HBLFRASY	HBLMRASY



400A Plugs

Description	Color	Male Plug	Female Plug
Thermoplastic elastomer, cable size 2/0 - 4/0 AWG.	Black	HBL400MBK	HBL400FBK
	White	HBL400MW	HBL400FW
	Green	HBL400MGN	HBL400FGN
	Red	HBL400MR	HBL400FR
	Blue	HBL400MBL	HBL400FBL
	Brown	HBL400MBN	HBL400FBN
	Orange	HBL400MO	HBL400FO
	Yellow	HBL400MY	HBL400FY
	Gray	HBL400MGY	HBL400FGY



Receptacles, Stud Type

Description	Color	Threaded Hole Mounting	
		Female	Male
400 amp Panel Mount, thermoplastic elastomer, mates with 300 and 400 amp plugs.	Black	HBLFRSCBK	HBLMRSCBK
	White	HBLFRSCW	HBLMRSCW
	Green	HBLFRSCGN	HBLMRSCGN
	Red	HBLFRSCR	HBLMRSCR
	Blue	HBLFRSCBL	HBLMRSCBL
	Brown	HBLFRSCBN	HBLMRSCBN
	Orange	HBLFRSCO	HBLMRSCO
	Yellow	HBLFRSCY	HBLMRSCY



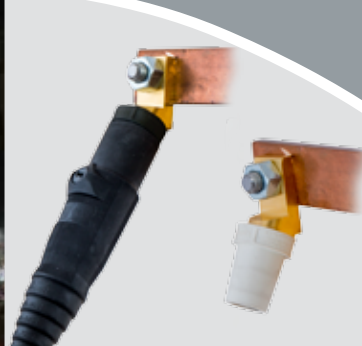

Series 16 - 300 and 400 Amps, 600V AC/250V DC

Receptacles, Double Set Screw



Description	Color	Female	Male
400 amp Panel Mount, thermoplastic elastomer, cable size #4 - 4/0 AWG, mates with 300 and 400 amp plugs.	Black	HBLFRBK	HBLMRBK
	White	HBLFRW	HBLMRW
	Green	HBLFRGN	HBLMRGN
	Red	HBLFRR	HBLMRR
	Blue	HBLFRBL	HBLMRBL
	Brown	HBLFRBN	HBLMRBN
	Orange	HBLFRO	HBLMRO
	Yellow	HBLFRY	HBLMRY
	Gray	HBLFRGY	HBLMRGY

Angled Receptacles, Double Set Screw



Description	Color	Female	Male
400 amp Panel Mount, thermoplastic elastomer, cable size #4 - 4/0 AWG, mates with 300 and 400 amp plugs.	Black	HBLFRABK	HBLMRABK
	White	HBLFRAW	HBLMRAW
	Green	HBLFRASGN	HBLMRAGN
	Red	HBLFRAR	HBLMRAR
	Blue	HBLFRABL	HBLMRABL
	Brown	HBLFRABN	HBLMRABN
	Orange	HBLFRAO	HBLMRAO
	Yellow	HBLFRAY	HBLMRAY
	Gray*	—	—

Note: *Gray is available upon request. Contact factory.

Receptacles, Bus Bar Mount



Description	Color	Female	Male
400 amp Panel Mount, thermoplastic elastomer, mates with 300 and 400 amp plugs.	Black	HBLFRBBK	HBLMRBBK
	White	HBLFRBW	HBLMRBW
	Green	HBLFRBGN	HBLMRBGN
	Red	HBLFRBR	HBLMRBR
	Blue	HBLFRBBL	HBLMRBBL
	Brown	HBLFRBBN	HBLMRBBN
	Orange	HBLFRBO	HBLMRBO
	Yellow	HBLFRBY	HBLMRBY

Angled Receptacles, Bus Bar Mount



Description	Color	Female	Male
400 amp Panel Mount, thermoplastic elastomer, mates with 300 and 400 amp plugs.	Black	HBLFRABBK	HBLMRABBK
	White	HBLFRABW	HBLMRABW
	Green	HBLFRABGN	HBLMRABGN
	Red	HBLFRABR	HBLMRABR
	Blue	HBLFRABBL	HBLMRABBL
	Brown	HBLFRABN	HBLMRABN
	Orange	HBLFRABO	HBLMRABO
	Yellow	HBLFRABY	HBLMRABY

Terminals, Offset Straight Style



Description	Color	Female	Male
400 amp Panel Mount, thermoplastic elastomer, mates with 300 and 400 amp plugs.	Black	HBLFOSBK	HBLMOSBK
	White	HBLFOSW	HBLMOSW
	Green	HBLFOSGN	HBLMOSGN
	Red	HBLFOSR	HBLMOSR
	Blue	HBLFOSBL	HBLMOSBL
	Brown	HBLFOSBN	HBLMOSBN
	Orange	HBLFOSO	HBLMOSO
	Yellow	HBLFOSY	HBLMOSY

Note: Terminals are UL Type 1 only.

Angled Terminals, Offset Straight Style



Description	Color	Female	Male
400 amp Mount, thermoplastic elastomer, mates with 300 and 400 amp plugs.	Black	HBLFOABK	HBLMOABK
	White	HBLFOAW	HBLMOAW
	Green	HBLFOAGN	HBLMOAGN
	Red	HBLFOAR	HBLMOAR
	Blue	HBLFOABL	HBLMOABL
	Brown	HBLFOABN	HBLMOABN
	Orange	HBLFOAO	HBLMOAO
	Yellow	HBLFOAY	HBLMOAY

Note: Angled terminals are UL Type 1 only.



Series 16 - 300 and 400 Amps, 600V AC/250V DC



Tees and 3-Fers

					
Color	Tapping Tee (Female-Female-Male)	Paralleling Tee (Female-Male-Male)	3-Fer (Male-Female-Female-Female)	3-Fer (Female-Male-Male-Male)	Soft 3-Fer (Male-Female-Female-Female)
Black	HBLTBK	HBLPTBK	HBLM3FBK	HBLF3MBK	HBLM3FSBK
White	HBLTW	HBLPTW	HBLM3FW	HBLF3MW	(Black only)
Green	HBLTGN	HBLPTGN	HBLM3FGN	HBLF3MGN	
Red	HBLTR	HBLPTR	HBLM3FR	HBLF3MR	Soft 3-Fer (Female-Male-Male-Male)
Blue	HBLTBL	HBLPTBL	HBLM3FBL	HBLF3MBL	
Brown	HBLTBN	HBLPTBN	HBLM3FBN	HBLF3MBN	HBLF3MSGN
Orange	HBLTO	HBLPTO	HBLM3FO	HBLF3MO	(Green only)
Yellow	HBLTY	HBLPTY	HBLM3FY	HBLF3MY	



Distribution Block

	
Color	(1-Male, 6-Females)
Black	HBL7DBBK
White	HBL7DBW
Green	HBL7DBGN
Red	HBL7DBR
Blue	HBL7DBBL
Brown	HBL7DBBN
Orange	HBL7DBO
Yellow	HBL7DBY

Gender Reversing Devices

		
Color	Double Male (Male-Male)	Double Female (Female-Female)
Black	HBLDMBK	HBLDFBK
White	HBLDMW	HBLDFW
Green	HBLDMGN	HBLDFGN
Red	HBLDMR	HBLDFR
Blue	HBLDMBL	HBLDFBL
Brown	HBLDMBN	HBLDFBN
Orange	HBLDMO	HBLDFO
Yellow	HBLDMY	HBLDFY

Protective Caps

		
	Fits Female Devices	Fits Male Devices
	HBLFCAPBK	HBLMCAPBK
	HBLFCAPW	HBLMCAPW
	HBLFCAPGN	HBLMCAPGN
	HBLFCAPR	HBLMCAPR
	HBLFCAPBL	HBLMCAPBL
	HBLFCAPBN	HBLMCAPBN
	HBLFCAPO	HBLMCAPO
	HBLFCAPY	HBLMCAPY

Weather Protective Lift Covers

		
Color	Catalog Number	All One Color Caps and Bodies
Clear	—	HBLNCC
Black	HBLNCBK	HBLNCABK
White	HBLNCW	HBLNCAW
Green	HBLNCGN	HBLNCAGN
Red	HBLNCR	HBLNCAR
Blue	HBLNCBL	HBLNCABL
Brown	HBLNCBN	HBLNCABN
Orange	HBLNCO	HBLNCAO
Yellow	HBLNCY	HBLNCAY

Replacement Bodies (10 Pack)

		
Color	Male Body	Female Body
Black	HBLMBBK	HBLFBBK
White	HBLMBW	HBLFBW
Green	HBLMBGN	HBLFBGN
Red	HBLMBR	HBLFBR
Blue	HBLMBBL	HBLFBBL
Brown	HBLMBBN	HBLFBBN
Orange	HBLMBO	HBLFBO
Yellow	HBLMBY	HBLFBY

Snap Back Covers (3R Only)

		
	Through Hole Mounting	Threaded Mounting Holes
	HBLSCBK	HBLSCCBK
	HBLSCW	HBLSCCW
	HBLSCGN	HBLSCCGN
	HBLSCR	HBLSCCR
	HBLSCBL	HBLSCCBL
	HBLSCBN	HBLSCCBN
	HBLSCO	HBLSCCO
	HBLSCY	HBLSCCY

Replacement Contacts (20 Pack)

		
Description	Male Pin	Female Sleeve
Contact, 300 amp	HBL300RCM	HBL300RCF
Contact, 400 amp	HBL400RCM	HBL400RCF

Accessories

Description	Catalog Number
Accessory Kit, retaining screw, copper foil, terminal screws and brass wire.	HBLPK
Replacement retaining screw (500 pack).	HBLRS
Copper foil (500 pack).	HBLCF

Accessories

Description	Catalog Number
Brass wire (500 pack).	HBLBW
Terminal screw - panel mount (500 pack).	HBLTSR
Terminal screw - in line (500 pack).	HBLTS





HUBBELL®
Wiring Device-Kellems



Series 16 - Specifications and Dimensions

Specifications

Electrical		Series 16	
Voltage Ratings		600V AC Maximum 250V DC Maximum	
Amperage Rating		400A Maximum	
Mechanical		300A	400A
Terminal Accommodation		Plug: #6 to 2/0 AWG	Plug: 2/0 to 4/0 AWG Recept.: #4 to 4/0 AWG
Product ID		Ratings are a permanent part of device	
Base Compound		Thermoplastic Elastomer (TPE)	
Contact Material		Brass	
Retaining Screw Material		Nylon	

Certification / Environmental

Series 16	
UL and cUL listed	
UL Enclosure Types 3R, 4X, 12	
UL 1691 standard for single pole locking-type separable connectors	
National Electric Code (NEC®), ANSI/NFPA 70	
Flammability: HB per UL94 or CSA 22.2. 0.17	

Conductor Ampacity Chart (Type SC/PPC Wire)

Cable Size	Ampacity•	Cable Size	Ampacity•
#6	105	2/0	300
#4	140	4/0	405
#2	190		

Note: •90°C column NEC Table 400.5(A)(2).

Dimensions Inches (mm)

In Line Plugs

Series 16		A	B	C	D
Male	Male	7.01" (178.0)	1.38" (35.1)	1.48" (37.6)	4.78" (121.4)
	Female	7.10" (180.5)	1.44" (36.6)	1.06" (27.0)	4.90" (121.3)

In Line Plug (Male Shown)

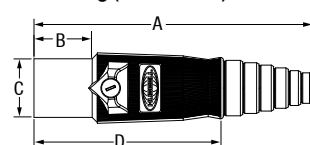

Weatherproof Cover

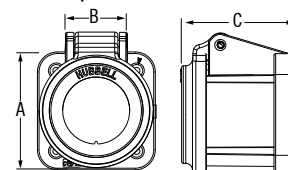

Threaded Stud (Male Shown)

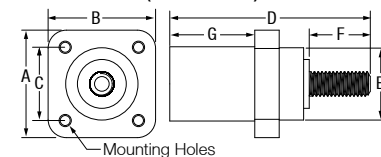

Mounting Holes

Double Set Screw (Male Shown)

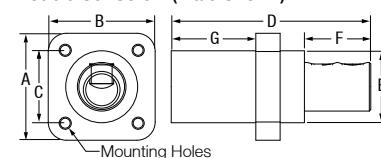

Mounting Holes

Busbar Type (Male Shown)

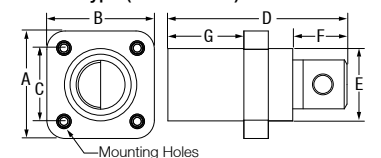

Offset Terminals (Male Shown)

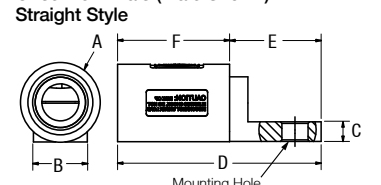

Mounting Hole

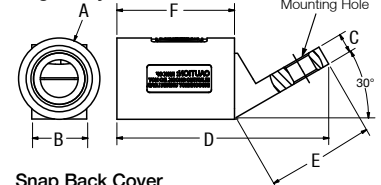

Mounting Hole

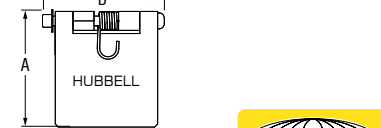

Series 16	Threaded Stud	A	B	C	D	E	F	G	Mounting Hole	Termination
	Male & Female with through hole mounting	2.20" (55.9)	2.20" (55.9)	1.50" (38.1)	4.10" (104.3)	1.48" (47.4)	1.25" (31.7)	1.74" (44.2)	Through 4x Ø .20"	1/2-13 UNC-2A Threaded stud
	Male & Female with threaded mounting holes	2.20" (55.9)	2.20" (55.9)	1.50" (38.1)	3.67" (93.2)	1.48" (47.4)	1.11" (28.2)	1.55" (39.4)	Threaded 4x #10-32	1/2-13 UNC-2A Threaded stud
	Double Set Screw	A	B	C	D	E	F	G	Mounting Hole	Termination
	Male & Female with threaded mounting holes	2.20" (55.9)	2.20" (55.9)	1.50" (38.1)	4.10" (104.3)	1.48" (47.4)	1.36" (34.5)	1.74" (44.2)	Threaded 4x #10-32	(2) 7/32 Socket Head set screws
	Busbar Type	A	B	C	D	E	F	G	Mounting Hole	Termination
	Male & Female with threaded mounting holes	2.20" (55.9)	2.20" (55.9)	1.50" (38.1)	3.57" (90.7)	1.48" (37.6)	1.01" (25.7)	1.55" (39.4)	Threaded 4x #10-32	(1) 5/16-18 UNC-2B Threaded hole
	Offset Terminals	A	B	C	D	E	F		Mounting Hole	Termination
	Male terminal straight style	Ø1.48" [37.6]	1.00" (25.4)	.38" (9.5)	3.89" (98.8)	1.75" (44.5)	2.14" (54.4)		Through .50" (12.7)	—
	Female terminal straight style	Ø1.48" [37.6]	1.00" (25.4)	.38" (9.5)	3.68" (93.3)	1.75" (44.5)	1.93" (48.9)		Through .50" (12.7)	—
	Male terminal angled style	Ø1.48" [37.6]	1.00" (25.4)	.38" (9.5)	3.98" (101.1)	2.06" (52.2)	2.14" (54.4)		Through .50" (12.7)	—
	Female terminal angled style	Ø1.48" [37.6]	1.00" (25.4)	.38" (9.5)	3.76" (95.6)	2.06" (52.2)	1.93" (48.9)		Through .50" (12.7)	—

Covers

Series 16	Description	A	B	C
Weatherproof Cover	Weatherproof Cover	2.20" (55.88)	1.16" (29.44)	2.03" (51.5)
	Snap Back Cover to be used with receptacles	2.26" (57.4)	2.37" (60.2)	—

Gender Reversing Devices

Series 16	Description	A	B	C
Double Male	Double Male	4.65" (118.1)	1.48" (37.6)	—
	Double Female	4.84" (122.9)	1.44" (36.6)	1.06" (27.0)

Gender Reversing - Double Male

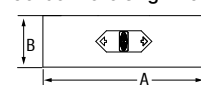

Gender Reversing - Double Female

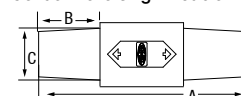

NEC® is a registered trademark of the National Fire Protection Association (NFPA).





Series 18 - 300 and 400 Amps, 600V AC/250V DC

Hubbell Wiring Device-Kellems Series 18, Ball Nose, Single Pole plugs and connectors are cULus listed for use in USA and Canada, and are compatible with all competitive products.

Series 18 Single Pole is a popular solution for welding connections and at shipyards. They are also widely used in the Canadian Broadcasting Industry.

- UL Type 4X environmental rating suitable for extreme outdoor conditions
- Replacement bodies available



HBL18300MBK



HBL18300FBK



Housing Design

- Ribbed thermoplastic elastomer body for a greater hold when plugging and unplugging the device
- Accommodates wide range of cables



Contacts

- One piece brass contact design
- Double set screw for the highest performance and coolest running connection



Safety

- Non-metallic retaining screw for user safety
- Recessed mounting screw minimizes screwdriver slippage



Assembly

- Keyed nylon interior for ease of assembly
- Special screw thread requires fewer turns than most competitors and reduces the risk of a conductive screw being substituted



HUBBELL®
Wiring Device-Kellems



Series 18 - 300 and 400 Amps, 600V AC/250V DC

300A Plugs



Description	Color	Male Plug	Female Plug
Thermoplastic elastomer, cable size #2 - 2/0 AWG.	Black	HBL18300MBK	HBL18300FBK
	White	HBL18300MW	HBL18300FW
	Green	HBL18300MGN	HBL18300FGN
	Red	HBL18300MR	HBL18300FR
	Blue	HBL18300MBL	HBL18300FBL
	Brown	HBL18300MBN	HBL18300FBN
	Orange	HBL18300MO	HBL18300FO
	Yellow	HBL18300MY	HBL18300FY

400A Plugs



Description	Color	Male Plug	Female Plug
Thermoplastic elastomer, cable size 3/0 - 4/0 AWG.	Black	HBL18400MBK	HBL18400FBK
	White	HBL18400MW	HBL18400FW
	Green	HBL18400MGN	HBL18400FGN
	Red	HBL18400MR	HBL18400FR
	Blue	HBL18400MBL	HBL18400FBL
	Brown	HBL18400MBN	HBL18400FBN
	Orange	HBL18400MO	HBL18400FO
	Yellow	HBL18400MY	HBL18400FY

Replacement Bodies (10 Pack)



Description	Color	Male Plug	Female Plug
Thermoplastic elastomer.	Black	HBL18MBBK	HBL18FBK
	White	HBL18MBW	HBL18FW
	Green	HBL18MBGN	HBL18FGN
	Red	HBL18MBR	HBL18FR
	Blue	HBL18MBBL	HBL18FBL
	Brown	HBL18MBBN	HBL18FBN
	Orange	HBL18MBO	HBL18FBO
	Yellow	HBL18MBY	HBL18FBY

Accessories



Description	Catalog Number
Series 18, replacement retaining screw (500 pack).	HBL18RS

Specifications

Electrical		Series 18	
Voltage Ratings		600V AC Maximum 250V DC Maximum	
Amperage Rating		400A Maximum	
Mechanical		300A	400A
Terminal Accommodation		Plug: #2 to 2/0 AWG	Plug: 3/0 to 4/0 AWG
Product ID		Ratings are a permanent part of device	
Base Compound		Thermoplastic Elastomer (TPE)	
Contact Material		Brass	
Retaining Screw Material		Nylon	

Certification / Environmental

Series 18	
UL and cULus listed	
UL Enclosure Types 3R, 4X, 12	
UL 1691 standard for single pole locking-type separable connectors	
National Electric Code (NEC), ANSI/NFPA 70	
Flammability: HB per UL94 or CSA 22.2. 0.17	

Conductor Ampacity Chart (Type SC/PPC Wire)

Cable Size	Ampacity•
#2	190
2/0	300
3/0	350
4/0	405

Note: •90°C column NEC Table 400.5(A)(2).

Dimensions

In Line Plugs

Description	A	B	C	D	E	F
Male	6.77" (172.0)	2.06" (52.3)	1.61" (40.9)	1.85" (47.0)	.73" (18.5)	.38" (TYP) (9.7)
Female	6.21" (157.7)	1.50" (38.1)	1.61" (40.9)	1.85" (47.0)	.73" (18.5)	.38" (TYP) (9.7)

In Line Plug (Male)

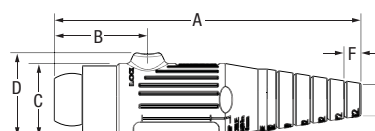

In Line Plug (Female)

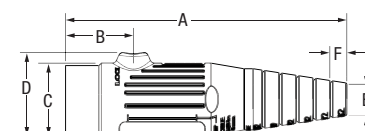

Single Pole Devices

**Temporary Power Designed for the
Most Demanding Environments**

More Industry Products from Hubbell

STRAIGHT BLADE DEVICES



Insulgrip® Plugs, Connectors, Receptacles and Inlets - the widest range of singularly rated NEMA devices available. Insulgrip products are synonymous with Hubbell's ongoing commitment to producing high quality electric products.

TWIST-LOCK® DEVICES



Twist-Lock® Insulgrip® Plugs, Connectors, Receptacles and Inlets - the widest range of singularly rated NEMA devices available. Designed to last from engineered thermoplastic materials and high performing alloys.

IEC PIN & SLEEVE DEVICES



IEC Watertight Devices provide safe and dependable performance in the most demanding environments. Heavy duty non-conductive nylon construction provides impact and corrosion protection.

Available Literature

Hubbell offers an extensive literature library for product support. Downloadable PDFs are available online at www.hubbell-wiring.com.

Hubbell Safety Brochure



Hubbell Safety Evaluation Brochure



Insulgrip® Wiring Devices Application Guide

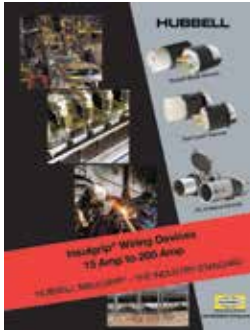

Hubbell Slide Charts



Twist-Lock®
Devices



Kellems®
Mesh Grips

Website Support

The Hubbell Wiring Systems website offers fast convenient information with our online virtual catalog, technical support, literature support and more. The website also offers landing pages for vertical markets and sustainable building. Visit www.hubbell-wiring.com.

