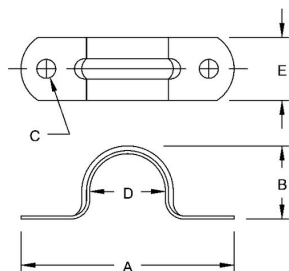

**EMT STRAPS - STEEL****Two Hole Straps Stamped Steel**
N/A**B22**

Catalog #: 2096

APPLICATIONSFor use in mounting EMT conduit
N/A**PRODUCT FEATURES**All stamped steel construction insures mechanical protection
Oversized bolt holes make alignment of the fastener quick and easy
All straps are zinc electro plated for corrosion protection**GENERAL PRODUCT INFORMATION**

Trade Size: 1-1/2 in.

DRAWING DIMENSIONSDimension A: 3.770 in.
Dimension B: 1.785 in.
Dimension C: .250 in.
Dimension D: 1.740 in.
Dimension E: .750 in.**PACKAGING**Package Type: Carton
Ship Carton Qty.: 50
Product UPC-A Labeled: No
Weight (Lbs. Per/C): 8.80
Ship Carton Length (in.): 9.30
Ship Carton Width (in.): 6.40
Ship Carton Height (in.): 4.70
Ctn Weight (Lbs.): 4.40
UPC Number: 050169020968
I2of5: 50050169020963