



# LIGHTING

## QUARTZ FLOODLIGHTS



QL-500K



QL-1505K

### FEATURES-SPECIFICATIONS

#### Applications

Provides maximum light output with low initial cost. Designed for instant turn-on and high illumination levels where H.I.D. costs are prohibitive. Used to illuminate construction sites, security areas, sports areas, sign lighting and other applications.

#### QL Series Features

- Tempered Glass Lens Assembly—Thermal shock-and impact-resistant glass lens mounted in a die cast aluminum door frame
- Cast Aluminum Housing—The cast aluminum body is designed with a specialized heat dissipating fin system for cooler operation
- Versatile Mounting—The standard unit has a 1/2 inch swivel knuckle with cast construction for strength and durability
- High Temperature Gasketing—A weathertight seal is provided by a high temperature silicone door gasket
- Exclusive Socket System—This two-piece, high temperature socket allows easy relamping and prevents socket from binding
- Reflector—Linear parabolic reflector system provides maximum light out
- High Temperature Gasketing—A weathertight seal is provided by a high temperature silicone gasket attached to the housing. Four lens clips positively seal the lens to the gasket with consistent pressure to assure a weathertight seal
- Versatile Mounting—The standard unit has a 1/2 inch swivel knuckle with cast construction for strength and universal aiming

QL QUARTZ FLOODLIGHTS				
CATALOG NUMBER	LAMP AND WATTAGE	BEAM SPREAD	WEIGHT	E.P.A. SQ. FT.
QL-500K ①	300/500	Wide	4 Lbs. (1.8)	0.53
QL-500K-WQ ②	300/500	Wide	4 Lbs. (1.8)	0.53
QL-1505K ③	1000/1500	Wide	6 Lbs. (2.7)	0.86
QL-1505K-WQ ②③	1000/1500	Wide	6 Lbs. (2.7)	0.86

- ① Lamps not included.
- ② Lamps supplied-shipped separately. 500W 120V, 1500 240V.
- ③ 1500W models must be aimed 10° or more below horizontal.

ACCESSORIES /REPLACEMENT PARTS		
DESCRIPTION	QL-500K	QL-1505K
Guard	QL-5G	QL-15G
Trunnion Box	TRNDB	
Lens ONLY	0461330B	0461331B
Socket (2 Required)	K800-2166-0108	0732016B
1/2" Knuckle	K20750110214	
Lens Gasket	K265-0481-0307	

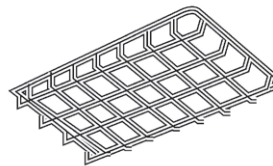

Guard

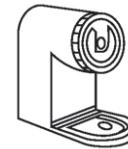

Trunnion Box

#### Dimensions

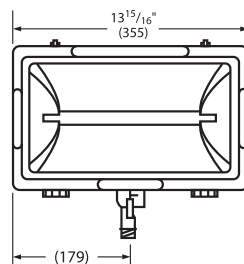

QL-1500 Watt

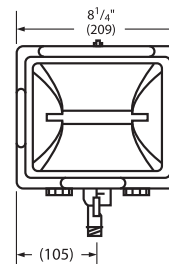

QL-500 Watt

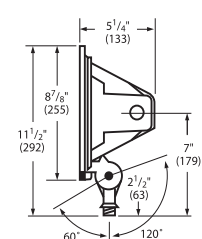

QL-1500 and QL-500 Watt