

FLUIDMASTER® 555C FLUSH VALVE REPAIR KIT WITH 502 PERFORMAX™ HIGH PERFORMANCE FLAPPER & DRAIN SEAT INSTALLATION INSTRUCTIONS

WARNING

DO NOT USE IN-TANK DROP-IN TOILET BOWL CLEANERS CONTAINING BLEACH OR CHLORINE. Use of such products will: (1) RESULT IN DAMAGE to tank components and MAY CAUSE FLOODING and PROPERTY DAMAGE and (2) VOID FLUIDMASTER WARRANTY. Fluidmaster Flush 'n Sparkle Toilet Bowl Cleaning System is recommended for those choosing to use in-tank bowl cleaners and WILL NOT VOID the FLUIDMASTER WARRANTY because it will not damage the components. **DO NOT** overtighten nuts or tank/bowl may crack. Always use quality Fluidmaster parts when installing or repairing. Fluidmaster will not be responsible or liable for use of non-Fluidmaster parts during installation or repair.

LIMITED FIVE-YEAR EXPRESS WARRANTY

Subject to the "Exclusions" set forth below, Fluidmaster Inc. promises to the consumer to repair, or at the option of Fluidmaster Inc. to replace any part of this plumbing product which proves to be defective in workmanship or materials under normal use for five years from the date of purchase. All costs of removal, transportation and reinstallation to obtain warranty service shall be paid by the consumer. During this "Limited Five Year Express Warranty," Fluidmaster Inc. will provide, subject to the "Exclusions" section set forth below, all replacement parts free of charge, necessary to correct such defects. This "Limited Five Year Warranty" is null and void if this plumbing product has not been installed and maintained in accordance with all written instructions accompanying the product, and if non-Fluidmaster Inc. parts are used in installation.

EXCLUSIONS: FLUIDMASTER INC. SHALL NOT BE LIABLE FOR INCIDENTAL OR CONSEQUENTIAL DAMAGES, INCLUDING COSTS OF INSTALLATION, WATER DAMAGE, PERSONAL INJURY OR FOR ANY DAMAGES RESULTING FROM ABUSE OR MISUSE OF THE PRODUCT, FROM OVERTIGHTENING OR FROM FAILURE TO INSTALL OR MAINTAIN THIS PLUMBING PRODUCT IN ACCORDANCE WITH THE WRITTEN INSTRUCTIONS, INCLUDING USE OF NON-FLUIDMASTER PARTS. DO NOT USE IN-TANK DROP-IN TOILET BOWL CLEANERS CONTAINING BLEACH OR CHLORINE. USE OF SUCH PRODUCTS WILL RESULT IN DAMAGE TO TANK COMPONENTS AND MAY CAUSE FLOODING AND PROPERTY DAMAGE. USE OF SUCH PRODUCTS WILL VOID THIS WARRANTY.

DO NOT USE



NO MESSY GLUE



NO TANK REMOVAL

TOOLS NEEDED

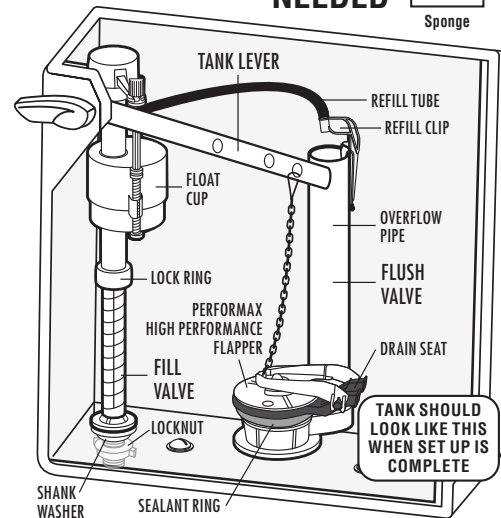

TANK SHOULD LOOK LIKE THIS WHEN SET UP IS COMPLETE

PARTS IN THIS FLUSH VALVE REPAIR KIT:

- (1) PerforMAX™ High Performance Flapper
- (1) New Drain Seat
- (1) Pre-applied Sealant Ring

PREPARATION

1 Remove Old Parts

Remove tank lid. Use pencil to mark water level of tank. Then proceed with the following steps.

A. Turn off water supply (Clockwise). Flush toilet and remove excess water from tank with sponge.

B. Disconnect flapper chain from tank lever arm & remove flapper from overflow pipe. See Step 2 for further details.

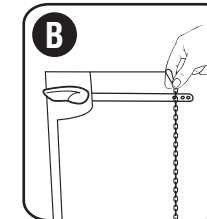
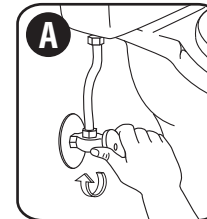

2 Preparing the Flush Valve Repair Kit for Installation

Flush Valve Repair Kit Assembly Parts

- A) PerforMAX™ High Performance Flapper
- B) New Drain Seat
- C) Pre-applied Sealant Ring

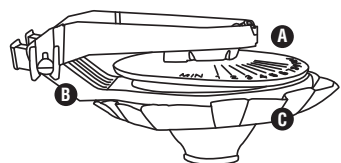

IF YOUR FLUSH VALVE ONLY HAS A FLAPPER:

Remove flapper or tank ball. Use scrub brush with warm soapy water to thoroughly clean old seat surface. Rinse and dry seat with hair dryer.

IF YOU ARE REMOVING AN OLDER FLUIDMASTER FLUSH VALVE REPAIR KIT:

Pull up firmly and slowly the edge of seat with fingers. **Do not** pry with a tool. Pull large sections of sealant if any remains. Use mineral oil with a cloth to remove remaining sealant from old seat. Use scrub brush and warm soapy water to thoroughly clean old seat surface. Rinse and dry seat with hair dryer. **CAUTION:** Do not hold hair dryer in one spot too long. This may crack the porcelain.

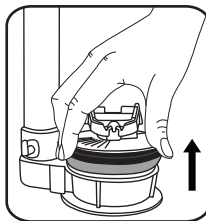

IF YOU HAVE A BRASS FLUSH VALVE:

Use sand paper, steel wool or emery cloth to thoroughly clean seat.

IF YOU ARE SEALING THE FLUSH VALVE REPAIR KIT TO PORCELAIN TANK:

A. Use scrub brush with warm soapy water to thoroughly clean around porcelain opening. Rinse with water.

B. Fluidmaster recommends to repeat Step A.

C. Dry seat using hair dryer. Once porcelain is dried, pour rubbing alcohol on surface and let dry. Proceed to Step 3A and then 3C.

INSTALLATION

3 Installing on a slanted or horizontal seat

A. Place the flush valve repair kit, with sealant paper attached, on your flush valve so the chain is closest to the tank lever.

B. The center line should be positioned ABOVE 3 o'clock or 9 o'clock (using overflow pipe at 12 o'clock,) when installed on an existing flush valve seat. Use the center line of the new seat for positioning. Position hinge section of seat in "OK" zone above 3 or 9 o'clock, located in areas marked "OK."

C. Once the desired position has been determined, lift flush valve repair kit, peel paper, and stick back in desired location. Apply firm pressure.

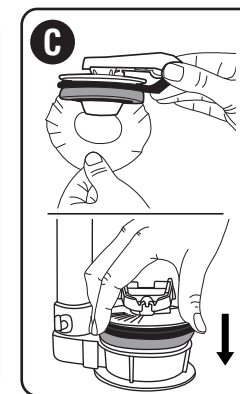
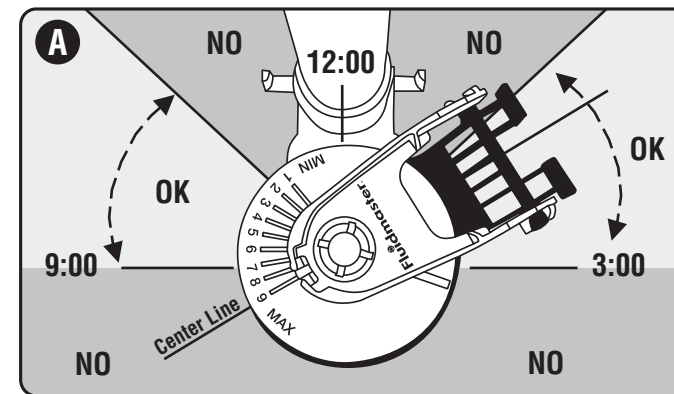

4 Connecting the Chain from Flapper to Tank Lever

With flapper in closed position and toilet tank lever in down position, connect chain clip to the hole of tank lever directly above where chain connects to flapper. Give chain about 1/2 inch of slack.

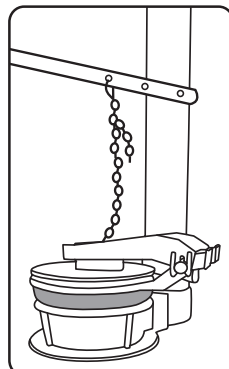

5 Turn On Water Supply

Inspect water supply connector. Replace it if it is worn or over 5 years old to prevent flooding and property damage. (Fluidmaster Click Seal® connector is recommended: A perfect seal every time without over tightening.)

Slowly turn on water supply and check for leaks. If you find leaking at bottom of tank, turn nut just enough to stop leaking. Then flush toilet to check.

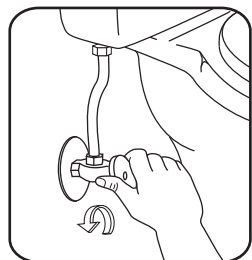

6 Set to Optimize the PerforMAX™ Flapper

The default setting for the PerforMAX™ flapper is preset at (9) for larger tanks.

Start with the dial in the default setting and flush your toilet.

If your toilet is able to flush, adjust the dial down to the next setting, number (8) and flush again.

Continue to adjust dial down one setting until your toilet is unable to flush properly. When the flapper dial is on a setting that does not allow for a proper flush, adjust the dial up one setting.

HINT: The higher the number set in front of the chain connection – the longer the flapper will stay open. Turn clockwise for greater flush volume. Turn counterclockwise for lower flush volume.

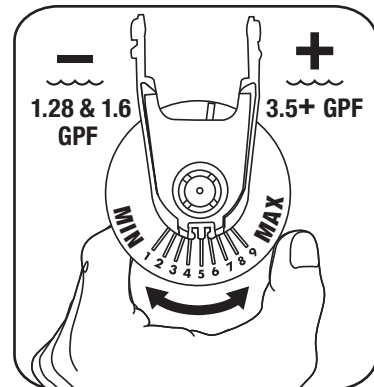

7 Code Compliance

Once fill valve is installed, ensure overflow pipe and water level of tank are correctly set.

1. THE TOP OF OVERFLOW PIPE (A) must be minimum of 1" below TANK LEVER HOLE (B).

2. WATER LEVEL (C) is set below top of Overflow Pipe (Fluidmaster recommends 1/2").

3. THE CRITICAL LEVEL MARK / C.L. Mark (D) identified by C.L. on fill valve must be positioned 1" above top of overflow pipe. This is a requirement of the Universal Plumbing Code.

Code Compliance helps protect your home & drinking water supply.

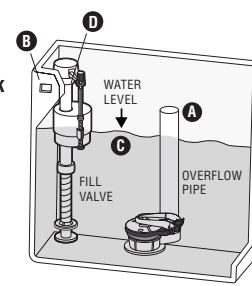

TROUBLESHOOTING

FLAPPER CLOSES TOO SOON

- The chain length should be about 1/2 in. slack. Lengthen or shorten chain until flapper stays open on its own.

WHEN TOILET WAS FLUSHED THE SEALANT RING SEPARATED FROM THE SEAT

- The surface was either not clean enough or wet. Purchase a new SEALANT RING # 2602.
- The replacement flapper for this kit is the 502 PerforMAX™ High Performance Flapper available at local hardware stores.

– Please keep a copy of these instructions on the property in which the product was installed.