

XJG EMT expansion couplings

Applications:

XJG EMT expansion couplings are used with EMT conduit:

- To couple together two sections of conduit subject to longitudinal movement
- In conduit runs to prevent damage to conduit supports such as in a building or on a bridge
- Indoors or outdoors in long conduit runs to permit linear movement caused by thermal expansion and contraction
- In conduit runs that cross structural joints
- On long conduit runs to prevent conduit from buckling and ensuing circuit failures

Features:

- Weatherproof and approved for use indoors or outdoors without an external bonding jumper
- Available in 1/2" through 4" trade sizes
- For use with EMT conduit
- Available in 4" maximum conduit movement
- Internal bonding springs and metallic bushings create high integrity internal ground connection and eliminate need for external bonding jumpers and clamps (up to 4" trade size)
- Optional redundant tinned copper bonding jumpers (BJ Series – ordered separately)
- UL Listed for use in wet locations
- Flat surface on gland nut provides smooth, flat surface for easy wrenching
- Distinct black gland nut provides quick identification as a wet location fitting
- Patented design

Certifications and compliances:

- UL Standard 514B
- CSA 22.2 No. 18 3-12
- NEMA FB1
- Wet locations

Options:

- | Description | Suffix |
|--|--------|
| • Available with redundant bonding jumper for visible indication of bonding (BJ Series) ⑤ (Order separately) | |



Standard materials and finishes:

Body

- Steel – electrogalvanized

Reducer & gland nut

- 1/2" through 1": steel – electrogalvanized
- 1 1/4" through 4": Feraloy® iron alloy – hot dip galvanized and aluminum paint

EMT Body

- EMT compression connector – raintight – steel electrogalvanized
- Coupling – steel electrogalvanized

Packing

- PTFE composite

Washer

- Steel – electrogalvanized

Gasket

- Vellum

Ground springs

- Phosphor bronze – electrogalvanized

Ground strap

- Braided tinned copper

U-bolts

- Malleable iron – electrogalvanized

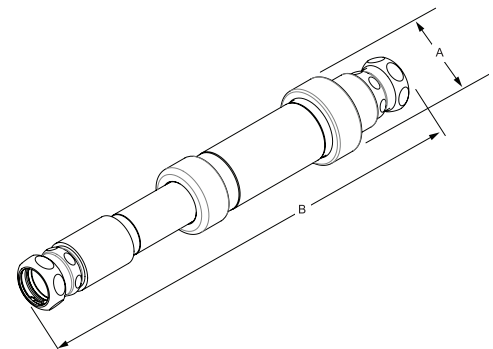

Dimensions (in inches):

Conduit size	Max. conduit movement	Cat. #	Optional bonding jumper ^⑤	A Dia.	B Length ^⑥
1/2"	4"	XJG14 EMT	BJ14	1.75"	11.36"
3/4"	4"	XJG24 EMT	BJ24	2.13"	11.54"
1"	4"	XJG34 EMT	BJ34	2.44"	11.89"
1 1/4"	4"	XJG44 EMT	BJ44	3.13"	12.31"
1 1/2"	4"	XJG54 EMT	BJ54	3.63"	13.37"
2"	4"	XJG64 EMT	BJ64	4.75"	15.42"
2 1/2"	4"	XJG74 EMT	BJ74	4.88"	19.05"
3"	4"	XJG84 EMT	BJ84	5.38"	19.11"
3 1/2"	4"	XJG94 EMT	BJ94	6.63"	19.64"
4"	4"	XJG104 EMT	BJ104	6.63"	19.75"

⑤ XJG expansion couplings use a metallic bushing and ground springs to create a high integrity internal ground connection. External ground straps offer a redundant ground path and easy visible indication of ground.

⑥ (B) Length in fully retracted position, add 2" for mid-point length.